

NiMH Battery Chargers

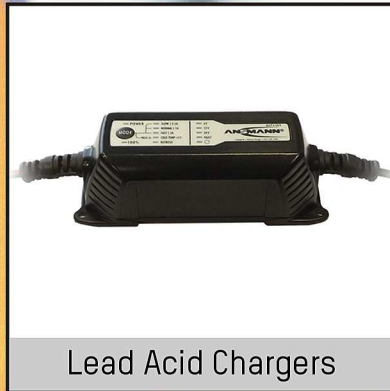

Lead Acid Chargers



Li-Ion/Li-Iron Chargers



Li-Ion Battery Packs



Li-Ion Single Cells

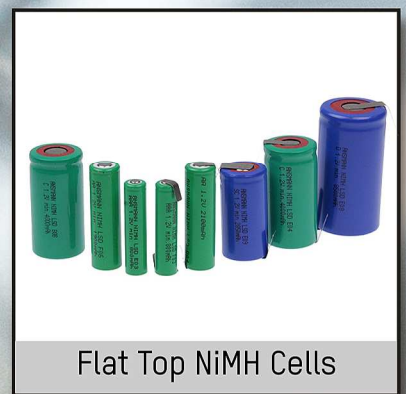

Flat Top NiMH Cells



Industrial Primary Cells



Power Supplies



Primary / Secondary Plugs

## Industrial Solutions Standard Products

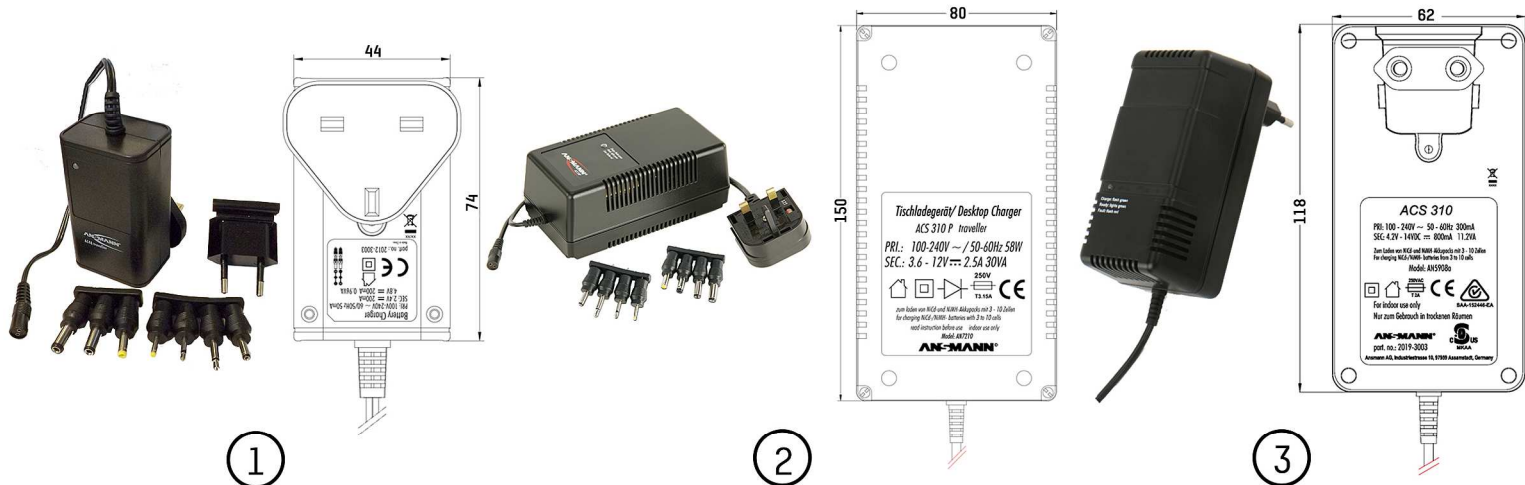

## NiMH Battery Chargers

Model	Image	Type	Charges	Current	Output	Part No:
AC 24	1	HT TRAVELLER UK/EU	2-4 CELLS	200mA	REV.SOC.+7PLUGS	2012-3003
AC 48	1	HT TRAVELLER UK/EU	4-8 CELLS	150-350mA	REV.SOC.+7PLUGS	2012-3004
ACS 310P	2	DESKTOP UK/EU	3-10 CELLS	2.5A (-ΔV)	REV.SOC.+8PLUGS	2012-3002
ACS 310	3	HT TRAVELLER UK/EU/US/AUS	3-10 CELLS	800mA (-ΔV)	REV.SOC.+8PLUGS	2019-3003

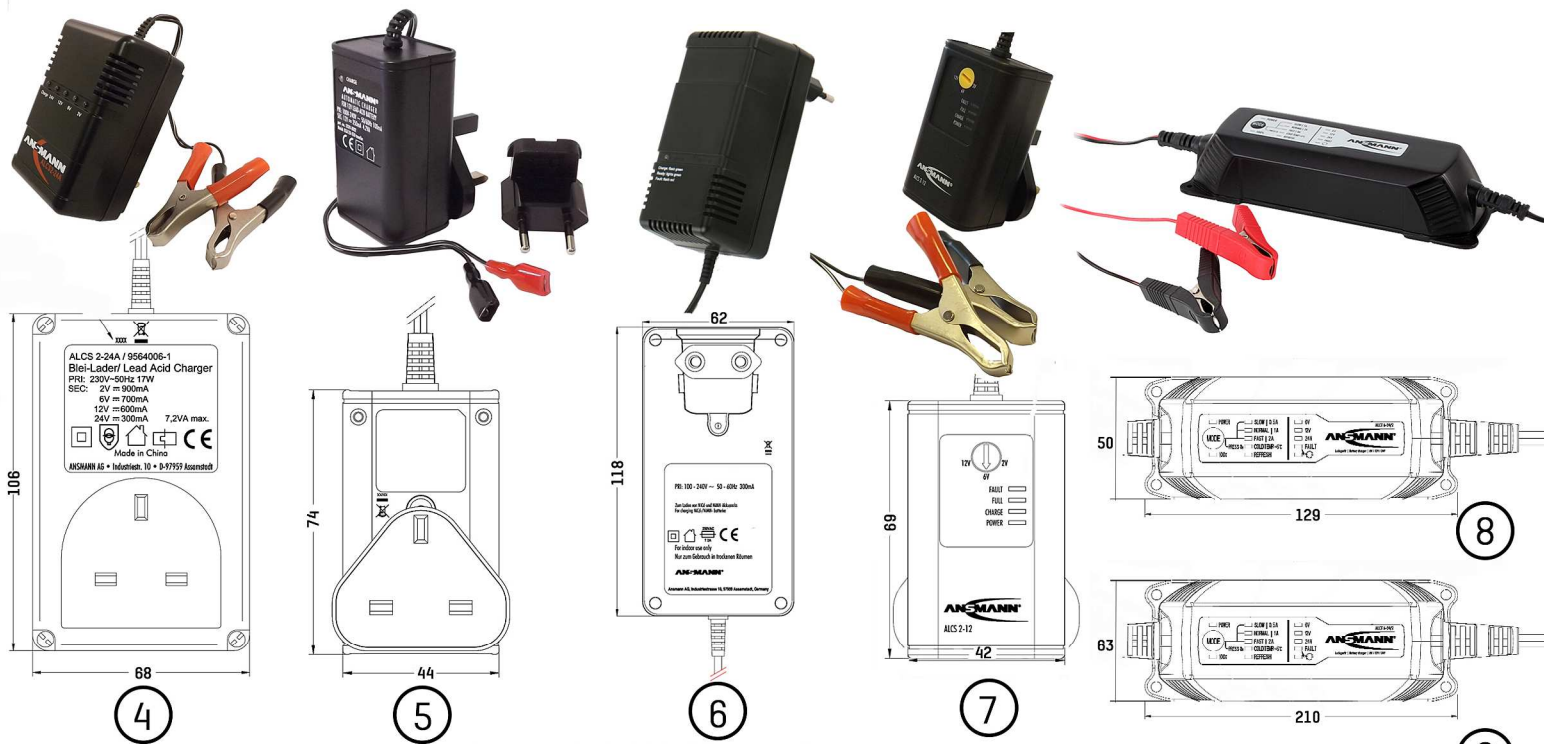

## Lead Acid Battery Chargers

Model	Image	Type	Charges	Current	Output	Part No:
ALCS 2-24A	4	PLUGTOP FIXED UK	2-24V	900mA MAX (IU)	CROCS	9564006-1
BCA 120-350	5	HT TRAVELLER UK/EU	12V	350mA MAX (IU)	6.35MM FASTONS	2039-3002
ALCT 12-2.5	6	HT TRAVELLER UK/EU/US/AUS	12V	2.5A (IUoU)	REV.SOC.+7PLUGS	9C94276-02
ALCT 24-1.5	6	HT TRAVELLER UK/EU/US/AUS	24V	1.5A (IUoU)	REV.SOC.+7PLUGS	9C94277-02
ALCS 2-12/0.4	7	HT TRAVELLER UK/EU	2-12V	400mA (IU)	CROCS	1001-0015-UK
ALCT 6-24/2	8	DESKTOP UK/EU	6-24V	2.0A MAX (IUoU)	CROCS	1001-0016-UK
ALCT 6-24/4	9	DESKTOP UK/EU	6-24V	4.0A MAX (IUoU)	CROCS	1001-0017-UK

Custom chargers available on request



### Li-Ion Battery Chargers

Type	Image	Charges/Current	Input	Output	Part No:
DESKTOP	1	3 CELLS / 2.5A	FIG 8 LEAD UK/EU	REVERSIBLE SOCKET	9C94141-UK
DESKTOP	1	4 CELLS / 2.2A	FIG 8 LEAD UK/EU	REVERSIBLE SOCKET	9C94140-UK
DESKTOP	1	5 CELLS / 1.8A	FIG 8 LEAD UK/EU	REVERSIBLE SOCKET	9C94139-UK
DESKTOP	1	6 CELLS / 1.5A	FIG 8 LEAD UK/EU	REVERSIBLE SOCKET	9C94138-UK
DESKTOP	1	7 CELLS / 1.2A	FIG 8 LEAD UK/EU	REVERSIBLE SOCKET	9C94137-UK
DESKTOP	2	4 CELLS / 5A	FIG 8 LEAD UK/EU	REVERSIBLE SOCKET	9294045-UK
DESKTOP	2	7 CELLS / 2.8A	FIG 8 LEAD UK/EU	REVERSIBLE SOCKET	9294046-UK
DESKTOP	2	10 CELLS / 2A	FIG 8 LEAD UK/EU	REVERSIBLE SOCKET	9294047-UK
DESKTOP	1	4 CELLS / 3A	FIG 8 LEAD UK/EU	REVERSIBLE SOCKET	9C94215-UK
DESKTOP	4	7 CELLS / 1.5A	FIG 8 LEAD UK/EU	NEUTRIK	2041-3019-01-UK

FT TRAVELLER	3	1 CELL / 1.5A	UK/EU/US	REV.SOC + 8PLUGS	9C94143-03
FT TRAVELLER	3	2 CELLS / 1.3A	UK/EU/US	REV.SOC + 8PLUGS	9C94142-04
FT TRAVELLER	3	3 CELLS / 0.7A	UK/EU/US	REV.SOC + 8PLUGS	9C94145-02
FT TRAVELLER	3	4 CELLS / 0.6A	UK/EU/US	REV.SOC + 8PLUGS	9C94144-01

NOTE: THE ABOVE CHARGERS HAVE cCSAus, MEDICAL APPROVAL IEC60601

PLUGTOP	5	1 CELL / 0.8A	FIXED EU	REVERSIBLE SOCKET	9194020
PLUGTOP	5	2 CELLS / 0.45A	FIXED EU	REVERSIBLE SOCKET	9194018
PLUGTOP	6	2 CELLS / 0.7A	FIXED EU	REVERSIBLE SOCKET	9194023
GT TRAVELLER	3	4 CELLS / 1.2A	UK/EU	REV.SOC + 8PLUGS	9C94131-01
GT TRAVELLER	3	4 CELLS / 2A	UK/EU	REV.SOC + 8PLUGS	9C94212-01
GT TRAVELLER	3	10 CELLS / 0.7A	UK/EU	REV.SOC + 8PLUGS	9C94214-02

### Lithium Iron Phosphate Battery Chargers

HT TRAVELLER	3	4 CELLS / 2.5A	EU	BARE ENDS	9C94242
HT TRAVELLER	3	8 CELLS / 1.5A	EU	BARE ENDS	9C94241

NOTE: THESE ARE ALSO AVAILABLE WITH UK, US AND AUS INPUT PLUGS

Custom chargers available on request



ANSMANN Industrial Solutions Division manufactures custom energy solutions, in particular battery systems.

The main focus at ANSMANN has always been customer satisfaction along with the highest product quality. As a logical step forward, ANSMANN now has been accredited with ISO 13485 certification. ISO 13485 requires a comprehensive management system for the design and manufacture of medical devices. The focus of this standard is the traceability and documentation of the production processes. ISO 13485 also ensures that the corresponding finished products are always following the highest quality standards. Regular audits also ensure that any legal requirements are complied with.

The state-of-the-art on-site UN Test Centre for battery systems is able to certify battery packs according to current applicable guidelines. This means that ANSMANN is now able to ensure the highest quality standards for battery systems in the medical sector, further strengthening its competitive edge.



### Standard Li-Ion Battery Packs

Type	Volts/Capacity	Part No:
1S1P	3.7V / 2600MAH	2347-3008-01
1S2P	3.7V / 5200MAH	2447-3033-01
1S3P	3.7V / 7800MAH	2447-3034-01
2S1P	7.4V / 2600MAH	2447-3030-01
2S2P	7.4V / 5200MAH IN-LINE	2447-3043-01
2S2P	7.4V / 5200MAH BLOCK	2447-3049-01
3S1P	11.1V / 2600MAH	2447-3031-01
3S2P	11.1V / 5200MAH	2447-3050-01
4S1P	14.8V / 2600MAH IN-LINE	2447-3032-01
4S1P	14.8V / 2600MAH BLOCK	2447-3036-01
4S2P	14.8V / 5200MAH	2447-3035-01
7S4P	25.9V / 10400MAH	2447-3055

**Custom battery packs available on request**

## Li-Ion 18650 Cells

Type	Capacity	M.Code	Part No:
MF1	2150MAH	LGI	2347-3013
S3	2200MAH	LGI	2347-3011
HE2	2500MAH	LGI	2347-3015
B4	2600MAH	LGI	2347-3009
MG1	2900MAH	LGI	2347-3014
D1	3000MAH	LGI	2347-3012
MH1	3200MAH	LGI	2347-3019
HD2	2000MAH	LGI	2347-3026
MF2	2200MAH	LGI	2347-3023
HG2	3000MAH	LGI	2347-3025
MJ1	3450MAH	LGI	2347-3020
ME1	2000MAH	LGI	2347-3022
22F	2200MAH	S - SDI	2347-3000
22P	2200MAH	S - SDI	2347-3004
26H	2600MAH	S - SDI	2347-3007
26F	2600MAH	S - SDI	2347-3001
29E	2900MAH	S - SDI	2347-3010



ONLY AVAILABLE TO AUTHORISED ASSEMBLERS



## Flat Top NiMH Cells

Type	Capacity	Style	Part No:
LSD AAA	800MAH	FLAT TOP	2311-3002
LSD AAA	800MAH	FLAT TOP TAGGED	2311-3003
LSD AA	2100MAH	FLAT TOP	2312-3003
LSD AA	2100MAH	FLAT TOP TAGGED	5035371-01
LSD SUB-C	3000MAH	FLAT TOP	2310-3004
LSD SUB-C	3000MAH	FLAT TOP TAGGED	5035391
LSD C	4000MAH	FLAT TOP	2310-3001
LSD C	4000MAH	FLAT TOP TAGGED	2310-3007
LSD D	8500MAH	FLAT TOP	2310-3002
LSD D	8500MAH	FLAT TOP TAGGED	2314-3003

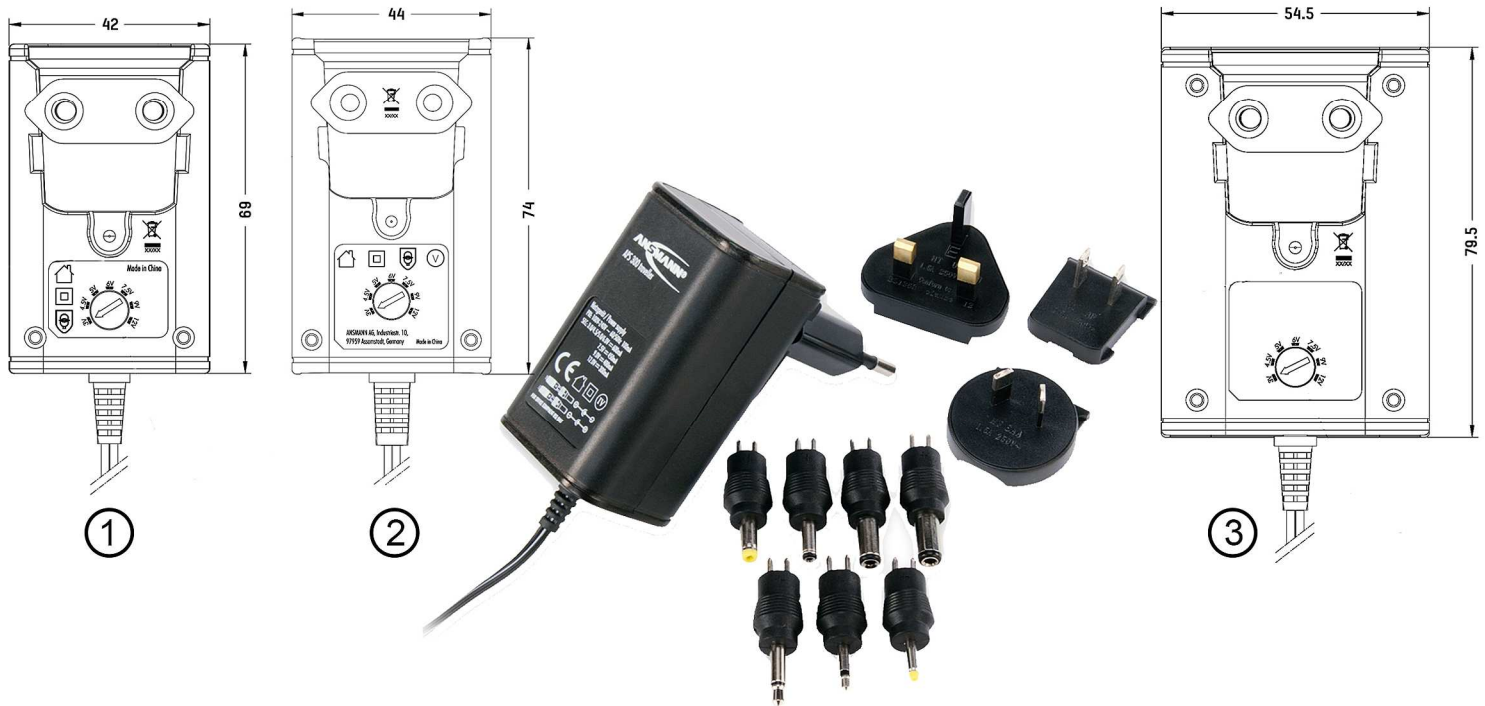

## Power Supplies

Product	Image	Type	Output Voltages	Current	Wattage	Part No:
APS300	1	HT TRAVELLER UK/EU/US/AUS	3 - 12V IN 7 STEPS	300MA AT 12V	MAX: 3.6W	5311103
APS600	1	HT TRAVELLER UK/EU/US/AUS	3 - 12V IN 7 STEPS	600MA	MAX: 7.2W	1209-0000
APS1000	2	HT TRAVELLER UK/EU/US/AUS	3 - 12V IN 7 STEPS	1000MA	MAX: 12W	5311113
APS1500	3	HT TRAVELLER UK/EU/US/AUS	3 - 12V IN 7 STEPS	1500MA	MAX: 18W	5311123
APS2250L	4	DESKTOP UK/EU	5 - 15V IN 7 STEPS	2250MA UP TO 12V	MAX: 27W	5311133-UK
APS2250H	4	DESKTOP UK/EU	12 - 24V IN 7 STEPS	2250MA AT 12V	MAX: 27W	5311143-UK



**Custom power supplies available on request**

## Industrial Alkalines

Product	Name	Type	Qty	Part No:
ANSMANN	INDUSTRIAL ALKALINE	AA	Box of 10	1502-0006
ANSMANN	INDUSTRIAL ALKALINE	AAA	Box of 10	1501-0009
ANSMANN	INDUSTRIAL ALKALINE	C	Box of 10	1503-0000
ANSMANN	INDUSTRIAL ALKALINE	D	Box of 10	1504-0000
ANSMANN	INDUSTRIAL ALKALINE	9V BLOCK	Box of 10	1505-0001

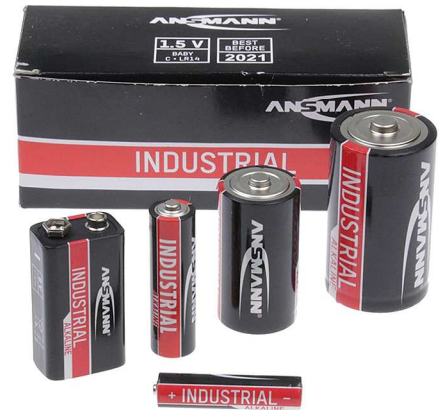

## Industrial Lithium

Product	Name	Type	Qty	Part No:
ANSMANN	INDUSTRIAL LITHIUM	AAA	Box of 10	1501-0010
ANSMANN	INDUSTRIAL LITHIUM	AA	Box of 10	1502-0005
ANSMANN	INDUSTRIAL LITHIUM	9V BLOCK	Box of 5	1505-0002

## Changeable Input Plugs (Traveller)

Country	Type	Part No:
EU	FT	10950081
UK	FT	10950082
US / JAPAN	FT	10950083
AUS	FT	10950084
EU	GT	10951342
UK	GT	10951343
US / JAPAN	GT	10951344
AUS	GT	10951345
DESKTOP FIG 8	GT	10951346
EU	HT	10951405
UK	HT	10951406
US / JAPAN	HT	10951407
AUS	HT	10951408



## Secondary Plugs

Style	Type	Size	Part No:
TYPE 2	JACK PLUG	3.5MM	10950250
TYPE 3	HOLLOW PLUG	2.5 x 5.5 x 12MM	10950253
TYPE 4	HOLLOW PLUG	2.1 x 5.5 x 12MM	10950252
TYPE 5	HOLLOW PLUG	1.35 x 3.5 x 10MM	10950036
TYPE 7	HOLLOW PLUG	DIN45323	10950254
TYPE 8	2 POLE TEXAS PLUG		10950200
SET	CONTAINING 8 PLUGS		10950964/01

# ANSMANN INDUSTRIAL SOLUTIONS

ANSMANN - CHINA



ANSMANN - GERMANY



ANSMANN UK LTD  
Units 11-12, R024,  
Harlow Business Park,  
HARLOW,  
Essex. CM19 5QB  
Tel: 0870 609 2233  
Fax: 0870 609 2234  
Email: [info@ansmann.co.uk](mailto:info@ansmann.co.uk)

# ANSMANN®

[www.ansmann.co.uk](http://www.ansmann.co.uk)

©2016 - Photos: ANSMANN AG, Martin Hahn - Peter Tümmel. Technical contents subject to change without notice. ANSMANN cannot be held responsible for errors, misprints or omissions - all trademarks are property of their owners.