

# MV range Centrifugal Fan Impellers



## MVS Model

Multi-bladed  
Forward curved

### Typical applications

Heating and ventilating.

Cooling systems.

Air recirculation.

### Features and benefits:

- High quality
- Rigid construction
- Taper lock hubs
- Mild & stainless steel
- Single & double widths
- Temperatures up to 300°c

### Specification

The impellers are constructed from high quality materials. Parts are punched and cut for consistent accuracy and quality. Taper lock hubs fitted as standard, other hub variations are also available.

All impellers are statically balanced before despatch.

Various finishes are available inc, paint, zinc plate, powder coat.

Right and left hand rotation available (as viewed from the drive side)



Lead time for standard models is usually 2 weeks

## Options

- Non standard diameter/width combinations
- Double width impellers
- Stiffening tie bars
- Fully machined hubs
- Special finishes
- Dynamic balancing (depending on size)

## Multivane impellers standard dimensions

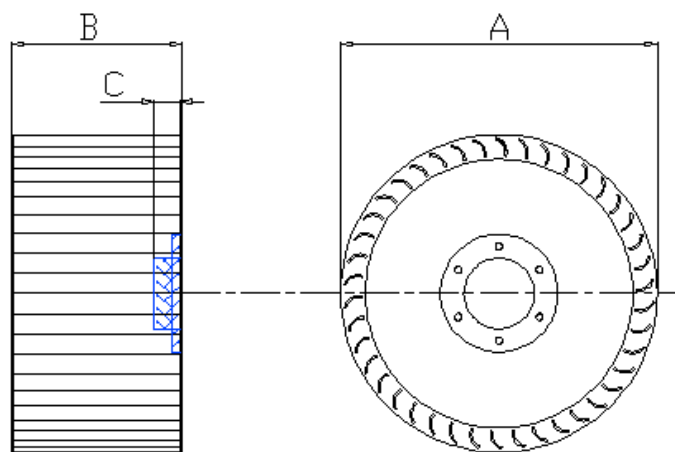

All dimensions in mm

Size	A	B	C	Max bore
150	155	86	23	28
190	190	105	23	28
230	232	127	23	28
270	270	146	23	28
300	308	171	25	42
335	340	165	25	42
370	375	180	25	42
410	415	185	33	50
450	460	223	33	50
500	505	240	33	50
550	555	260	33	50
610	615	295	33	50
670	677	325	45	60
740	747	362	45	60
820	830	395	45	60
900	910	440	45	60



Cadfan Ltd, Unit 8, Ladygrove Business Park, Gloucester Road, Mitcheldean, Gloucestershire

Tel: 01452-690035 Fax: 08702 889721 E-mail: sales@cadfan.co.uk

Visit us at [www.fanimpellers.co.uk](http://www.fanimpellers.co.uk)  
Sales line 01452-690035