

# General Purpose Sheathing Board

**Econic GPS board is a high quality, versatile, non combustible sheathing for timber frame, closed panels, SIPS, pre-insulated panels and off site modular systems.**

**UKAS tested and proven for fire, structure and hygrothermal performance**

## Key benefits

- Euroclass A1 rated for reaction to fire
- Excellent dimensional stability for airtightness
- Weather resistant – will not delaminate or bow
- Vapour permeable
- Mould and mildew resistant
- Severe Duty Rated for impact
- Good wind loadings
- High pull out strength – screw fix or nail
- 100% non hazardous material
- No risk of 'Off Gassing' – clean indoor air quality
- Exceeds Category I racking strength
- Easy to handle and cut on site
- Verified low embodied carbon

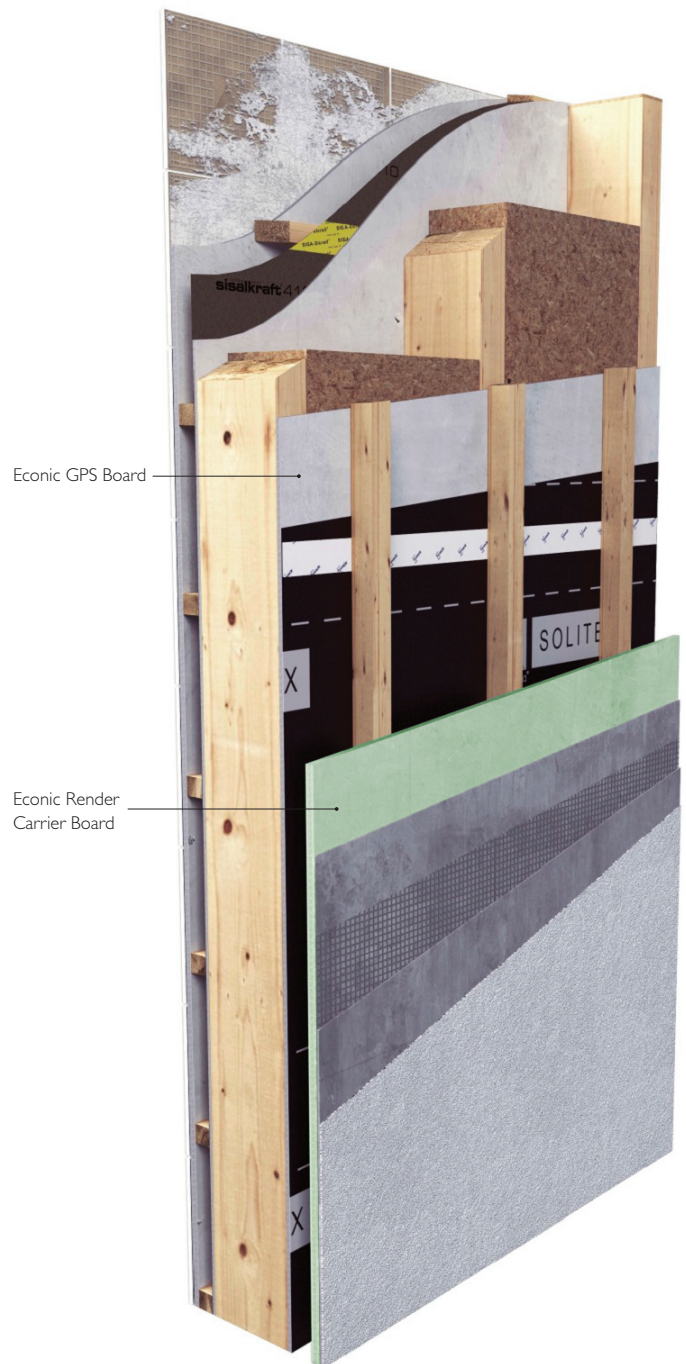

Typical build-up showing Econic GPS Board used in timber frame/rainscreen cladding system. Also ideal for timber systems. Cladding fixings to manufacturer's specification.

## Dimensions

Width (mm) (mm)	Length (mm)	Thickness (mm)	Weight (kg)	No. of sheets per pallet
1200	2400	3	12.2	135
1200	2400	6	18.9	98
1200	2400	9	26.6	65
1200	2400	12	35.2	49

Pre-cut sized panels and lengths up to 2700mm also available.

## Manufacture and composition

Econic GPS Board is manufactured to ISO 9001 using high quality materials. The principal constituent is Magnesium Oxide (MgO).

The board is non-toxic and free from formaldehyde, benzenes, solvents and oil-based chemicals.

## Appearance

Econic GPS Board has a polished surface on one side and a rough/keyed texture on the reverse.

## Testing

All our products are tested using UKAS accredited test houses.

**Airtightness:** Risk to airtightness is overcome due to exceptional dimensional stability.

For full details of test specifications and certification please contact us.

## Sustainability

A full life cycle analysis conducted by the Centre for Energy and Built Environment verifies that Econicboard has a carbon emission rating 20% of cement fibre boards.

## Sitework

**Storage:** Econic GPS Board can be stored outside with suitable protection.

**Cutting:** Can be cut using normal wood working tools. A tungsten carbide or diamond tipped blade is recommended. Dust extraction is advised for high volume cutting/machining.

**Fixings:** Stainless Steel or anti rust screws

## Performance data

Category	Method	Result
Robustness	BS EN 12467:2004	Category A
Durability	BS EN 12467:2004	Category A
Frost protection	BS EN 12467:2004	Category A
Dimensional stability	BS EN 318:2002	0.01% on length 0.18% on thickness
Wind loadings	BS 6399: Part 2	4.8kN/m <sup>2</sup>
Moisture content at 20°C - 65% at 20°C - 30%	BS EN 322: 1993	RH = 15% RH = 11%
Vapour resistivity	BS EN 12572:2001	1.2MNs/g
Thermal conductivity	ISO 8302: 1991 EN 12664:2001	0.4W/mK
Density (av.)	BS EN 12390-7	1130kg/m <sup>3</sup>
Impact strength	BS 5234	Severe Duty Rated
Tensile strength	BS EN 1608:997	4.20N/mm <sup>2</sup>
Bending strength	BS EN 12467:2004	Class I
Reaction to fire	BS EN 13501-1:2007	Euroclass A1
Modulus of rupture	BS EN 12467:2004	6.89N/mm <sup>2</sup>
Pull-out resistance	BS EN 845-1	>600N
Pull through strength	EN 1383: 1999	19.95N/mm <sup>2</sup>

**Joints:** Allow a 3 to 4mm gap left between the boards. When installing Econic GPS Boards the joints should be either filled with sealant or taped over.

## Availability

Econic GPS Boards are exclusively available from Duncryne through a national network of distributors. Please contact us at the address below to find your nearest supplier:

## Other products

Duncryne are exclusive suppliers of a range of buildings boards to meet various demanding applications:

- Econic Tile Backer Board
- Econic Fire Board
- Econic Render Carrier Board
- Econic Soffit Lining Board
- Econic Composite panel board

Please contact us at the address below for more information.

Exclusively available from:

**Duncryne** 0/1, 91 Hyndland Street, Hyndland, Glasgow G11 5PU  
Tel: +44 (0)141 576 0077 E: keithj@duncryne.com / david@duncryne.com  
[www.econicperformancesystems.com](http://www.econicperformancesystems.com)