

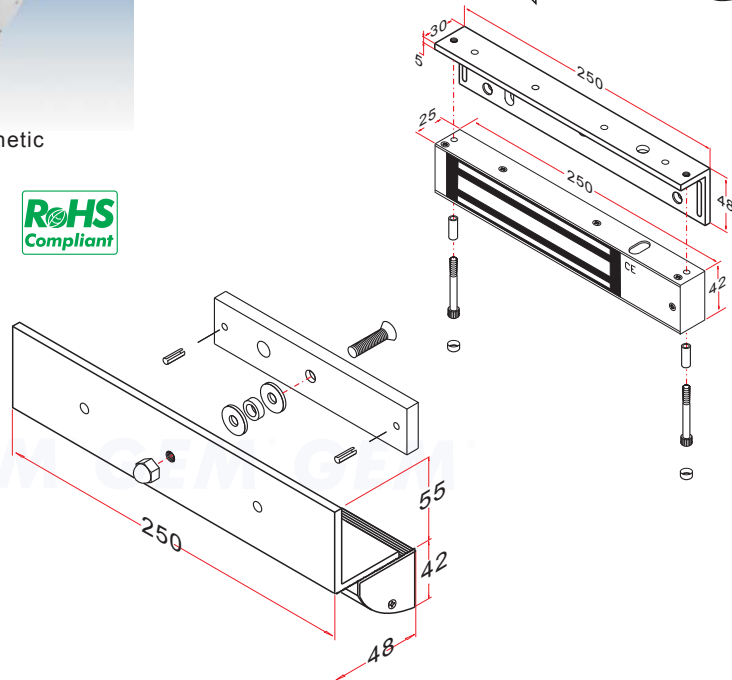

The new special styling bracket enables more aesthetic for the doors.

- Application for the Electromagnet: 10001, 10004(Double) Series

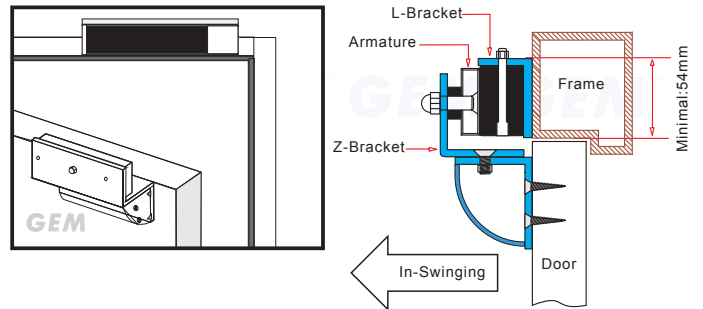

Unit:mm

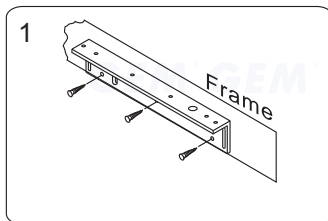

1 Find a mounting location on the door frame for the L bracket. Make sure that the door is still closeable.

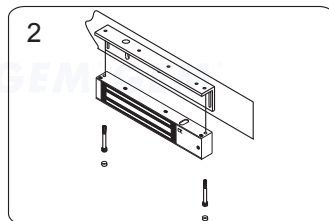

2 Tighten the electromagnetic lock on the L bracket by using the fixing screw.

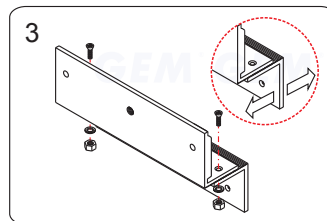

3 Assemble the Z bracket, and make sure that the Z bracket is adjustable.

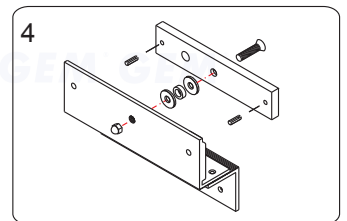

4 Insert the guide pins into the armature plate. Put one rubber washer between armature plate and the Z bracket.

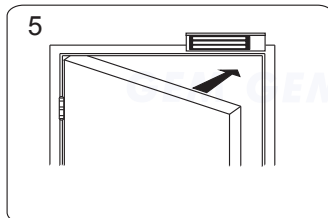

5 Close the door. Measure the correct position by bringing the armature plate close to the contact surface of the electromagnetic lock.

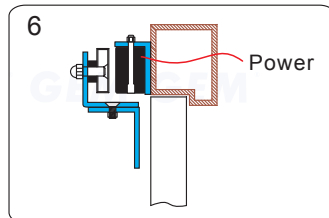

6 Turn on the power of EM-Lock, and let the armature plate bonds to the EM-lock. Adjust the position between the Z bracket and the door frame.

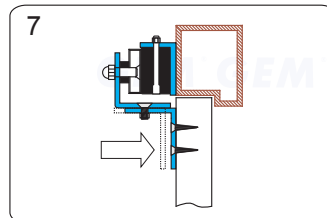

7 Once the position is correct, use the screws to permanently mount the Z bracket on the door frame.

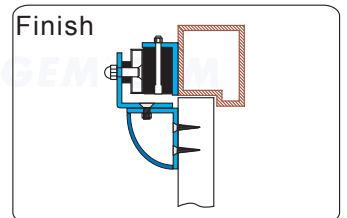

Finish Closing the cover on bracket.