

Wide Beam Boats

At Stoke on Trent Boat Building we offer a bespoke and standard wide beam construction service. All work is carried out in house from laying the steel base plate to the final paintwork. Our dedicated workforce ensures that every boat we produce is of the highest quality. And our policy of continuous improvement enables us to keep abreast of all the latest technical developments incorporating only the best equipment into our finished product.

"...a well chosen crew of very competent craftsmen whose work is top notch. I'll remember all of them when I run the boat. "

M A. Los Angeles

Wide beams allow great scope for varying layouts, lengths and beams, so a standard boat is unlikely to suit everybody. However, we provide 55ft by 10ft standard boat as detailed below.

Specifications

We believe that the below specification will provide a versatile and luxurious boat that will be a pleasure to be aboard. We realise it may not suit your particular requirements and will be pleased to discuss these with you. Variations to length and beam as well as general specification can be catered for.

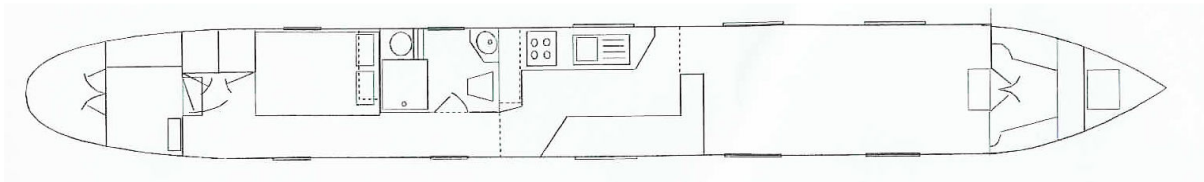

External

We construct our own steel shells which have been designed to give good looks matched by ease of handling - a hull shape that swims really well. In addition to these essentials our hulls are built to last with appropriate choice of steel thickness and paint specification.

- Plating thickness: 10/6/5/4mm certificated plate
- Fuel tank: Integral 300 ltrs
- Weed hatch: Quick release, stern deck access hatch
- Gas locker: Integral for 2no 13kg bottles
- Bow deck: Steel self draining
- Stern safety rail: With timber taff rail
- Bow deck lockers: Port and starboard

- Plank/pole brackets: Steel on roof
- Anodes: 4no 2.5kg
- Windows/Ports: Windows and ports to customers choice
- Navigation: Bow and stern fenders and ropes. Plank and pole

Internal

- Internal Lining: Sprayfoam insulation to internal space giving excellent thermal properties. Hardwood battening behind all cabin lining. Ceiling lined in quality tongue and groove boarding. Cabin sides lined in hardwood framed veneered plywood. Floor in 25mm exterior grade plywood.
- Furniture: All hand made by our craftsmen in solid hardwood and veneers.
- Double Bedroom: Fixed double bed with interior sprung mattress, drawers and storage under. Full height double wardrobe. Over bed cupboard with reading lights under. Two bedside cabinets. Under gunnel units. Wet locker. Radiator. Downlights. Windows or ports. Roof vent.
- Shower/Bathroom: Full size shower with glass door or bath option. Vanity unit with ceramic basin and mirror over. Macerator toilet with remote holding tank. Heated towel rail. Downlights. Window or port. Roof vent. Corridor opposite Airing cupboard. Downlight. Window or port.
- Dinette: U-shaped dinette with table converting to large double berth. Radiator opposite. Downlights. Window or port.
- Galley: All hardwood hand made units giving excellent storage and including space for a washing machine if required. Ample work surfaces. Raised oven unit, gas hob, five cu ft electric fridge, stainless steel sink and drainer. Wall units. Downlights. Windows or ports. Roof vent.
- Saloon: Open plan. Corner TV cupboard. Stove in tiled surround. Radiator. Windows or ports.
- Soft Furnishings: Flooring in quality carpet and underlay except galley and shower room in wood block laminate or vinyl tiles (timber floor optional). Interior sprung mattress to double bed. Curtain

Services

- Engine: Beta or Vetus 60hp diesel
- Gearbox: Hydraulic
- Transmission: Flexible coupling and stainless steel shaft
- Alternators: Twin 12v alternators
- Batteries: Five 110a/h sealed for life in diesel/acid proof box
- Instruments: De luxe instrument panel with tachometer, oil pressure and water temperature gauges and warning lights and buzzers. Services voltmeter.
- Steering: system Tiller - Wheel steering option
- 12v DC system: All circuits protected by trips
- 240v AC system: AC ring main with RCD, MCB's , 3no double sockets and immersion heater. Shore socket, isolator and polarity indicator, galvanic isolator
- Inverter: Sterling or Victron inverter charger
- Heating: Oil fired boiler to radiators, towel rail and calorifier
- Hot water: Calorifier with immersion heater from engine and boiler
- Cooker: Raised oven and 4 burner hob - LPG
- Fridge: Electric 12v 5cu ft

- Toilet: Macerator to remote holding tank (large tank options)
- Shower/Bath: Full size with glazed door - Bath option
- Water tank: Stainless steel