

Camloc

Motion Control

Camloc Hydraulic System

Compact motion control for your application

The Camloc Hydraulic System is the perfect self-contained solution when electro-hydraulic lifting is needed on your application. Each system is easy to install and built for a long, maintenance free life. The system's unique modular design enables you to select the best solution for your application whilst using standard parts. The Camloc Hydraulic System is compact so ideal for applications with limited space and can be mounted horizontally or vertically.

From tail lifts and access ramps on vehicles, to lift assist on medical and patient handling devices, the Camloc Hydraulic System does all the hard work for you. Using a 12v motor as standard (a 24v option is also available) the system is designed to lift up to 4710N per cylinder at temperatures from -20°C to +80°C.

The Camloc Hydraulic System is a self-priming 'plug & play' system with an in-built emergency release mode. Featuring an IP40 rated motor with 72 hour salt spray corrosion resistance and IP54 rated cylinders with 144 hour salt spray corrosion resistance, the Camloc Hydraulic System is as robust as it is powerful.



Benefits

- Compact design
- Easy to install
- Maintenance free
- Self priming
- Horizontal or vertical mounting
- Wide Range of end fittings available

Hydraulic Pump Unit

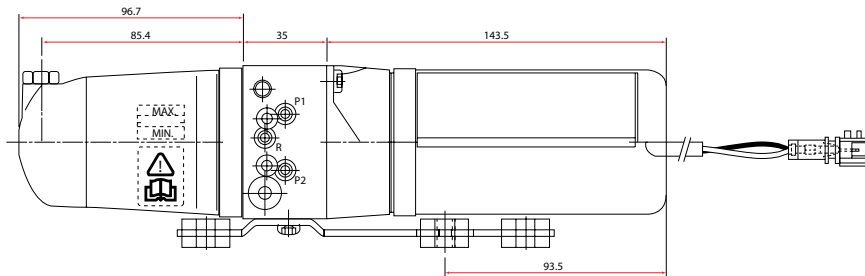

Hydraulic Pump Specifications	
Hydraulic Fluid	Pentosin CHF 202
Effective Reservoir Volume	150cc at horizontal position
Pump Radial Piston Type	4 piston (0.116cc per rotation)
Relief Valve Pressure Push	From 65 to 150 +10 / -5 Bar
Relief Valve Pressure Pull	From 65 to 150 +10 / -5 Bar
Motor Type	12v DC 2 pole motor
Voltage	12v DC Nom (9.5 – 14v DC)
Amperage	Max peak current 35A
Duty Cycle	3 minutes on / 27 minutes off
Protection Class	IP40 Acc. To DIN 40050

Cylinder

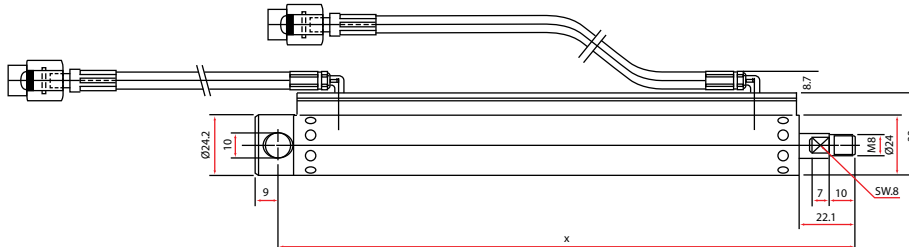

Cylinder Specifications	
Cylinder tube diameter (mm)	20
Cylinder rod diameter (mm)	10
Max. stroke (mm)	100 / 150 / 200
Max. tube length (mm) - shown as X on diagram	180 / 230 / 280
Extended length (mm)	(+2.5 / 0)
Retracted length (mm)	(0 / -2.5)
Max. Extending force per cylinder	4710N @ 150 Bar
Max. Retracting force per cylinder	3533N @ 150 Bar
End fitting – tube end	10mm hole for pin
End fitting – rod end	Various options available

For more information about the Camloc Hydraulic System or to discuss your gas spring needs please call +44 (0)116 274 3600

Camloc Motion Control Limited
 15 New Star Road, Leicester, LE4 9JD
 Tel: +44 (0)116 274 3600 Fax: +44 (0)116 274 3620
 Email: info@camloc.com Web: www.camloc.com

V1 DECEMBER 2011



FM00229

Camloc
 Gas Springs

Registered in England
 Reg No 7806748