

## VERTICAL PACKAGING MACHINES & SYSTEMS

### Machine specifications

The Cyclone 200 uses a combination of pneumatics and the sealing jaw mechanism to pull the film from the reel, form the tube and pull the correct bag length. The bag length is easily adjustable throughout its range.

The Cyclone 200B, 300 and 400 machines all use the belt draw-down system to pull the film from the reel. The operator can easily adjust the bag length through the interface unit. Bag length can be determined by a photocell registration mark, or by using a rotary encoder to measure the exact pack length.

Model	Pack styles	Size Range (Flat bag size)	Maximum speed	Power supply	Compressed air	Nett weight
Cyclone 200		Width: 60 - 200mm Length: 50 - 250mm	40 packs/min	Single phase 13 amp	0.6 m <sup>3</sup> /min.@6 BAR	400 kgs
Cyclone 200B		Width: 60 - 200mm Length: 50 - 280mm	80 packs/min	3 phase 0.375kw	0.6 m <sup>3</sup> /min.@6 BAR	600kgs
Cyclone 300		Width: 100 - 300mm Length: 100 - 400mm	50 packs/min	3 phase 0.55kw	0.6 m <sup>3</sup> /min.@6 BAR	1000 kgs
Cyclone 400		Width: 100 - 400mm Length: 100 - 500mm (Extended M / C: 600mm long)	45 packs/min	3 phase 0.75kw	0.7 m <sup>3</sup> /min.@6 BAR	1100 kgs

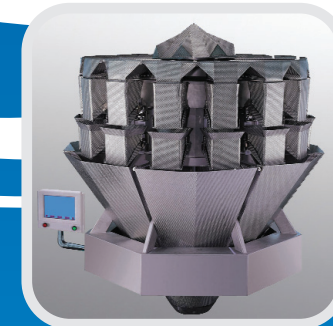

## The Company

Technosys PES Ltd. was formed in 1995 by a group of packaging engineers with years of experience in form, fill and seal machines and packaging systems. The equipment supplied by the company today reflects the knowledge and experience gained over the years and has resulted in a range of packaging machines, which are extremely reliable and user-friendly.

### The Machines

Technosys machines are engineered to exacting standards and use only the highest quality components. They are hand-built by skilled, experienced packaging machine engineers. The result is an extremely reliable, efficient machine. Maintenance and down-time are therefore kept to a minimum and this makes the machines cost-effective to own and operate.

The machines use a PLC and operator interface unit to store settings such as pack length, sealing temperatures, timings etc. The standard machine can store up to 10 programs, but this can be increased if required. The standard machine finish is in durable powder coating, with all product contact parts in stainless steel. If preferred the machine can be manufactured entirely from stainless steel, or other food-grade/non-corrosive materials.

The machines can be supplied to suit all types of packaging films, including laminates, polypropylene, polythene etc.

Complete packaging systems can be supplied including suitable feeding system, bucket elevator, rotary packing tables, check weighers etc

### Main advantages

- Large bag size range from a compact design
- Uses standard 'off the shelf' products, no special hardware/software
- Simple to operate with user-friendly controls
- Easy to clean and maintain
- Simple to size-change with minimal expenditure

### Pack styles

Machines can be supplied to produce various bag styles such as plain centre-sealed bags, gusseted bags, block-bottom and 'Quantum' type stand-up bags.

### Feeding systems

Products packed on Technosys machines include coffee, sugar, rice, sweets, snacks, powders, liquids, biscuits, pasta, hardware products etc. Feeding systems are supplied according to the product characteristics. These include;

- Multi-head and linear weighers
- Volumetric cup fillers
- Auger fillers
- Liquid fillers
- Counters

### Optional extras

The machines can be supplied with a variety of optional extras, for example;

- Date coders
- Label applicators
- One-way valve applicators
- Systems for sealing PE and soluble films
- Straight or 'zig-zag' style pack seals
- 'Euroslot' and hole-punching systems
- Chain packs
- Gas-flush device for product protection
- Static eliminator

**We have provided machines to market leaders in both the food and hardware industry...**



## After-sales service

The machines carry a comprehensive parts and labour warranty for 12 months after the initial supply. The company prides itself on having a fast and reliable after-sales service for machines already in the field. This can be on an as required basis, or form part of an annual service contract.



**CYCLONE 200**

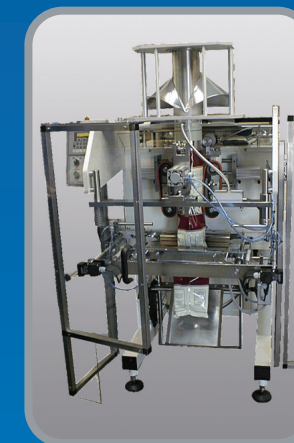
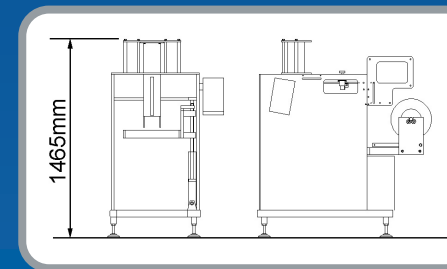
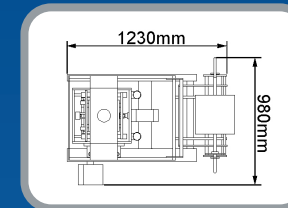

**CYCLONE 300**

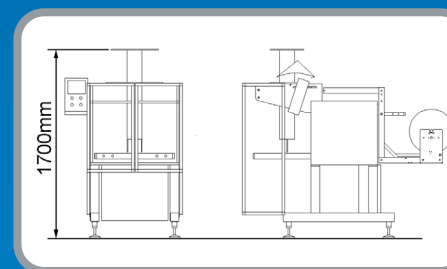
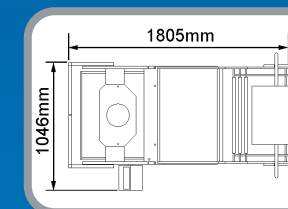

**CYCLONE 200B**

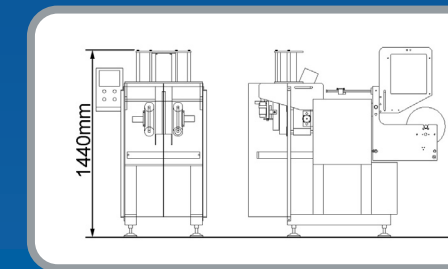
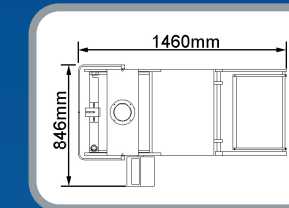

**CYCLONE 400**

