

SAFEGUARD Roller Shutter Systems

Designed and manufactured for building security



AC MAINTENANCE
LIMITED

New Doors, Repairs, Service & Maintenance

Shutter Curtain Specification

SAFEGUARD 76 SOLID

Constructed from 76mm galvanised cold rolled scroll sections of suitable gauge, each alternate lath is fitted with a steel endlock to prevent lateral movement and wind anchor locks on larger doors.

Visionguard 76 PERFORATED

The perforated version has multiple micro circular perforations.

SAFEGUARD 100 SOLID

100mm Flat Lath formed from galvanised steel of gauge to suit opening size. Each alternate lath is fitted with a nylon endlock and steel wind anchors on larger doors.

Roller Shutter Overall Specification

Bottom Rail

The base of the curtain is fitted with a steel angle reinforcing rail of adequate size forming an inverted 'T'.

Side Guides

Formed from cold rolled mild steel channel sections secured to the opening structure by full height mild steel fixing angles.

Roller Assembly

Constructed from mild steel tube fitted with counterbalance high tensile helical springs, mounted on bright steel shafts running in ball races, reduction drive gearing where applicable is by machine cut steel gears or chain drive to suit the size of the opening.

Endplates

The roller assembly is supported by mild steel endplates with mounting angles for fixing to the support structure.

Operation

Conventional electric motor with push button control and chain override. Tube motor within coil with toggle switch or keyswitch control and hand crank override. Manual haul chain operation or Automatic opening and closing.

Finish

All parts not galvanised are painted in one coat of grey protective primer. Consult with A&C Maintenance Ltd technical literature for further details.

Safeguard 76 Lath Profile (Solid & Perforated)

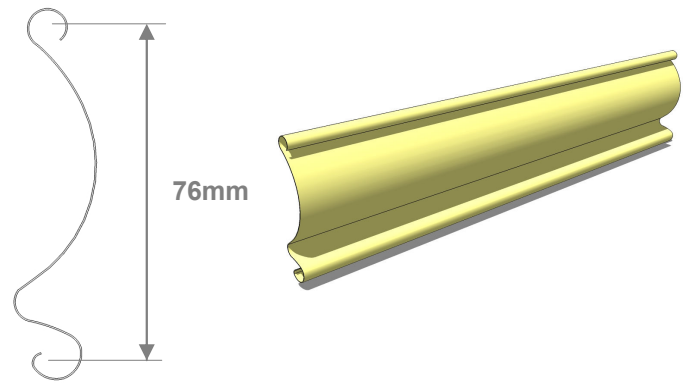

Visionguard 76 Perforated Lath Pitch Dimensions

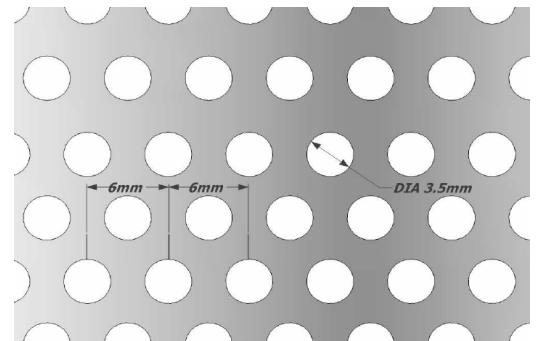

Safeguard 100 Lath Profile

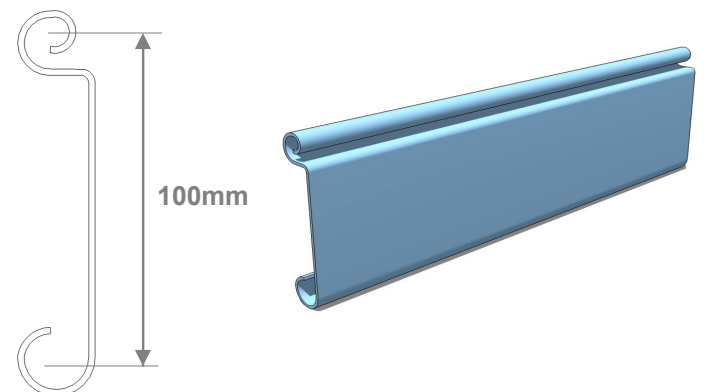

A comprehensive range
of high performance
shutter systems.



Safeguard Optional Extras

Operation Options:

- Handchain/handwheel operation
- Electric operation

Controls :

- Key switch control unit – flush mounted
- Key switch control unit – surface mounted
- External weatherproof push button
- Key lockable push button control
- Group control unit for up to 6 shutters simultaneously
- Auto open via internal induction loops with timed close facility
- Radio controlled
- Safety bottom edge
- Safety photo cell beam

Mechanical Items:

- Galvanised steel 3 sided coil cover
- Galvanised steel motor cover
- Galvanised steel fascia
- Galvanised steel soffit
- Security bullet locks to side guides
- Nylon brush or aluminium carrier to door head
- Nylon brush strips to side guides
- Rubber seal to bottom rail

Surface Mounted Keyswitch



- * Allows key holder to operate shutter
- * Added security in lieu of push button station
- * 2 pole available to control 2 shutters at a time
- * Hold to run operation for safety

Flush Mounted Keyswitch



- * Exactly the same functions and characteristics as the surface mounted but with the ability to be recessed flush with the structure.

Lockable Pushbutton



- * Up/down/stop modes
- * IP54 rated
- * Vandal resistant
- * Euro cylinder key lockable
- * Key removable in both positions

Pushbutton Station



- * Up/down/stop modes
- * IP54 rated

Bullet Lock & Housing



- * Additional security with lock housing mounted onto each guide
- * Euro pin passes through each guide channel into the shutter lath profile
- * 5 Lever anti-drill cylinder

Bullet Lock Interlock Box



- * For use in connection with bullet locks on electrically operated shutters
- * Shutters prevented from operating when engaged eliminating shutter damage.

Safety Photo Cell



- * Standard with any shutter where user does not have full control of the operation or is not in the line of sight.
- * Invisible beam across opening prevents shutter closing onto personnel or closing on obstructions preventing damage to the shutter.

Radio Control Operation



- * Single and multi channel transmitters
- * Operate up to 4 shutters at one time
- * Compact radio receiver with courtesy light

Roller Shutter Isometric View (Direct Drive)

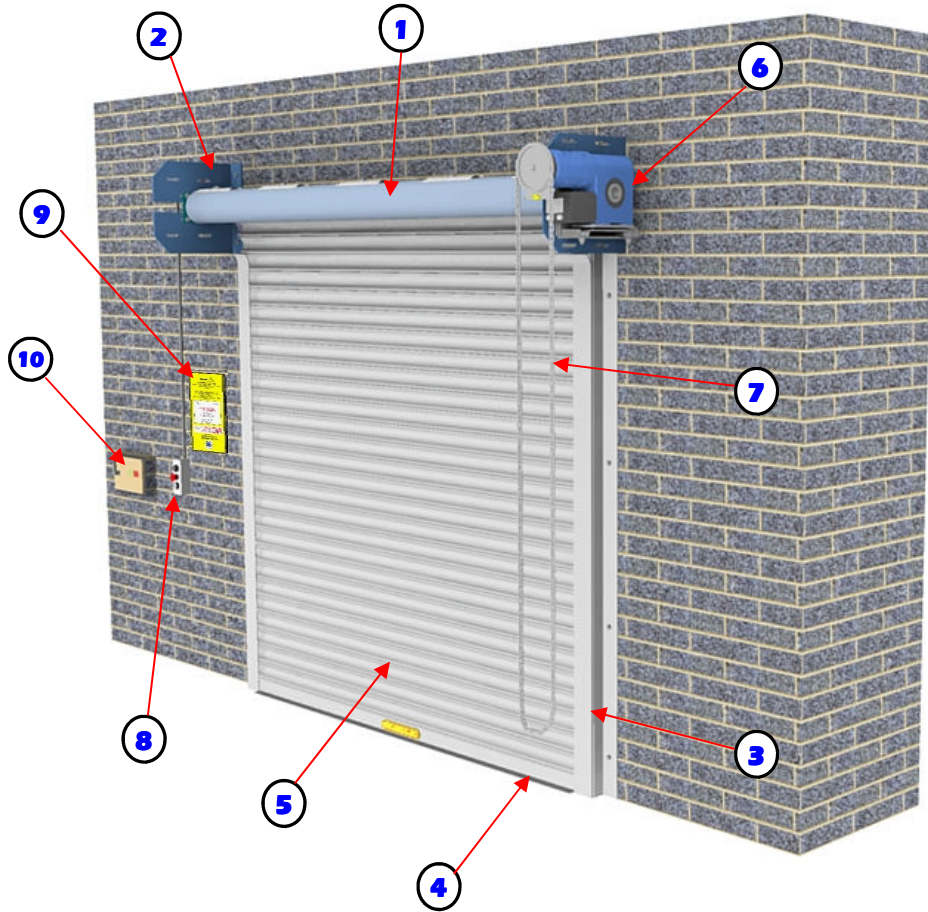

- (1) Roller Assembly
- (2) Endplate Brackets
- (3) Side Guides
- (4) Bottom Rail
- (5) Curtain
- (6) Motor Unit (Direct Drive)
- (7) Manual Override handchain
- (8) Push Button Control
- (9) Service & Maintenance Pocket
- (10) 3 Phz Power Supply (By Others)

Roller Shutter Isometric View (Tube Motor)

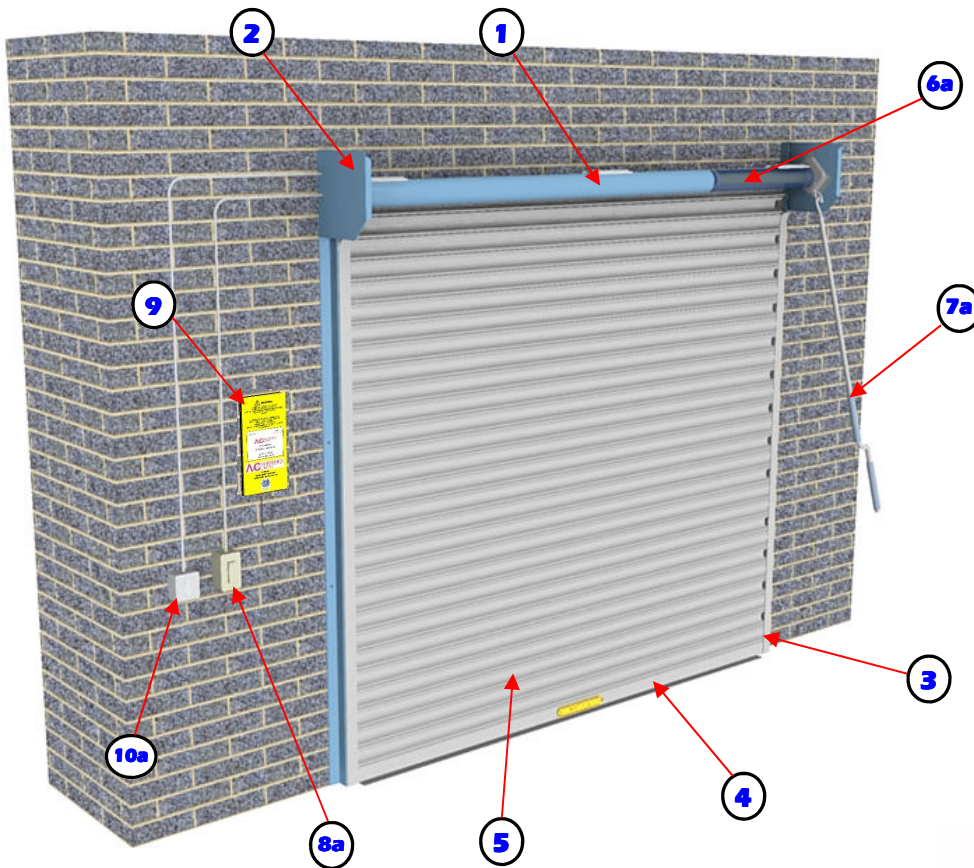

- (1) Roller Assembly
- (2) Endplate Brackets
- (3) Side Guides
- (4) Bottom Rail
- (5) Curtain
- (6a) Tubular Motor Unit
- (7a) Manual Handcrank Override
- (8a) Rocker Switch
- (9) Service & Maintenance Pocket
- (10a) 240V Power Supply (By Others)

Typical Installation Details

Face Fix to Masonry

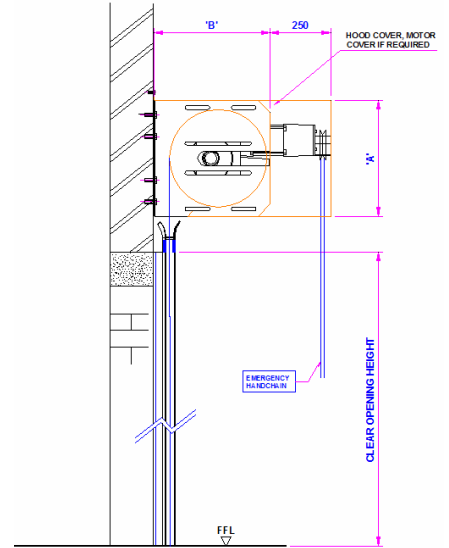
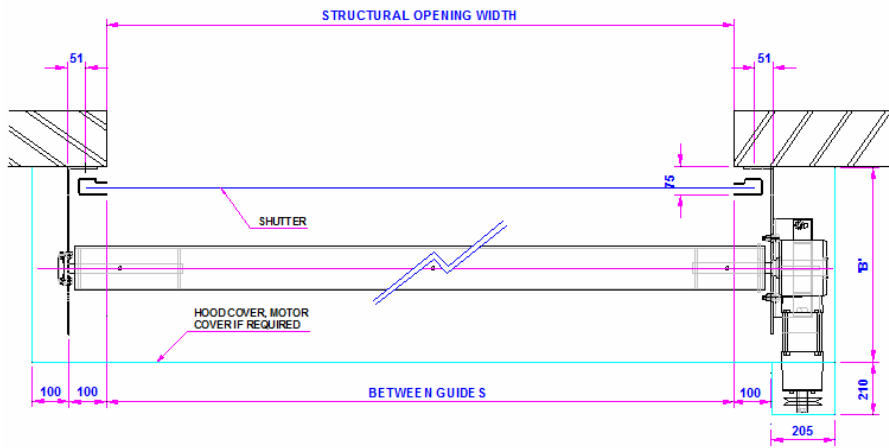

Face Fix to Steel

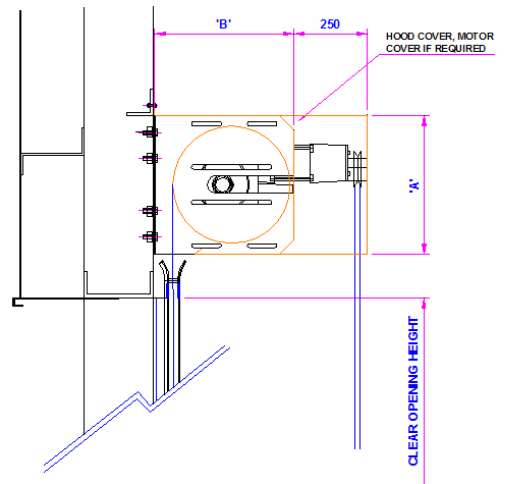
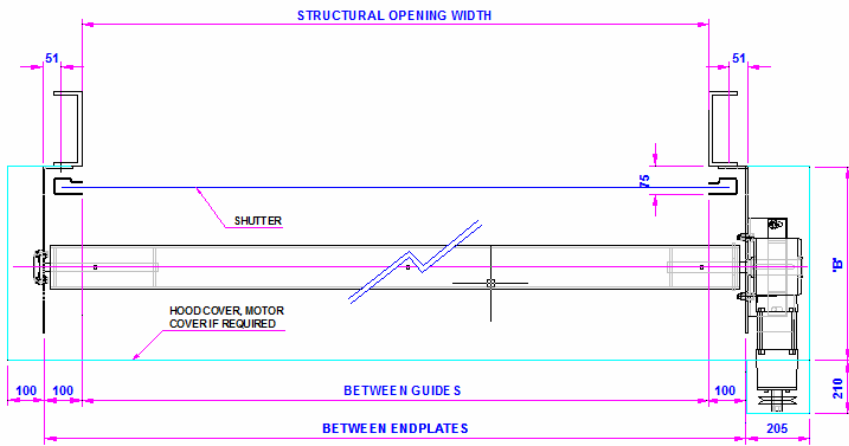

Between Fix to Steel

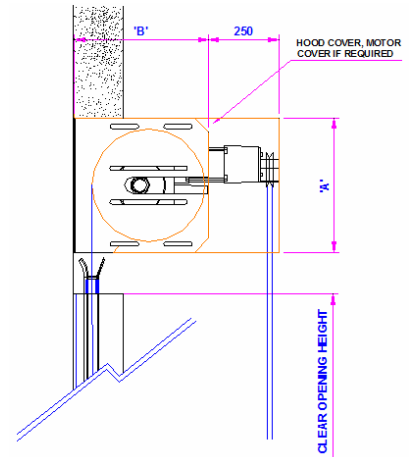
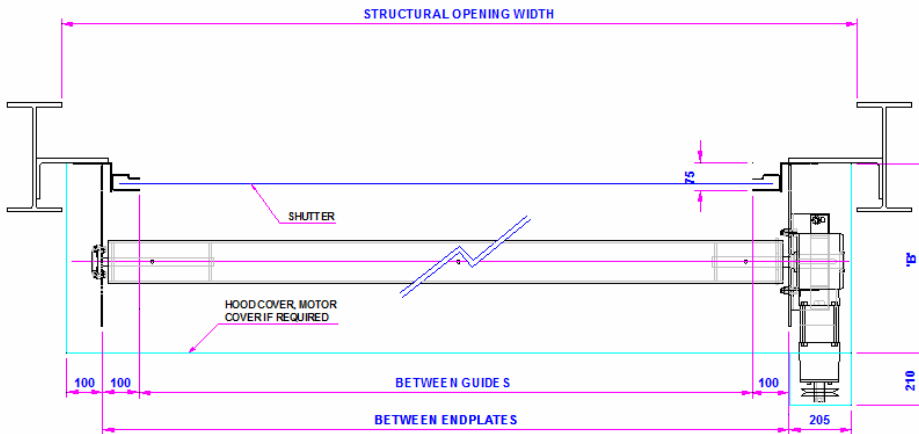

Table for 76mm Scroll Lath	Clear Opg. Height	A	B
	1000	300	300
1500	300	300	
2000	300	300	
2500	300	300	
3000	350	400	
3500	350	350	
4000	400	400	
4500	400	400	
5000	400	400	
5500	450	450	
6000	500	500	

Table for 100mm Scroll Lath	Clear Opg. Height	A	B
	1000	300	300
1500	300	300	
2000	300	300	
2500	400	400	
3000	400	400	
3500	400	350	
4000	400	400	
4500	450	400	
5000	450	400	
5500	450	450	
6000	500	500	