

---

# Slam Lock Handle

---

Technical Reference

---

Slideandtilt.com

---

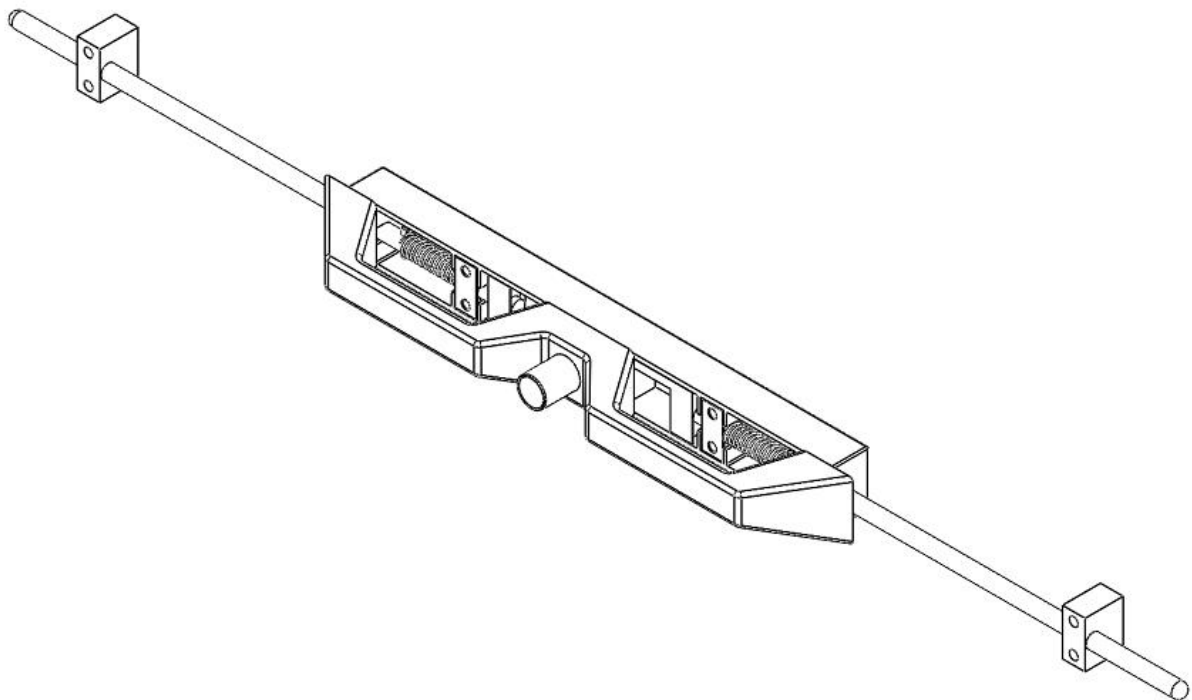

SlideandTilt.com  
Mile Oak Industrial Estate  
Maesbury Road  
Oswestry  
Shropshire  
SY10 8GA UK

sales@crollers.co.uk  
Tel: +44 (0) 1691 670 536  
Fax: +44 (0) 1691 670 538



Slideandtilt.com

## Contents:

---

Functionality

Working Parameters

Dynamics

Fixtures

Fixtures – Torque settings

Assembly

Installation Considerations

Sustainability



Slideandtilt.com

## Functionality

---

The mechanism is a series of plastic mouldings and stainless parts that make up a slam lock mechanism.

These are primarily used in the Emergency Vehicle industry that allows easy access to lockers that store various items required on Emergency Vehicles attending incidents.

These lockers can be easily and quickly opened/locked open and locked shut with the press of a button.

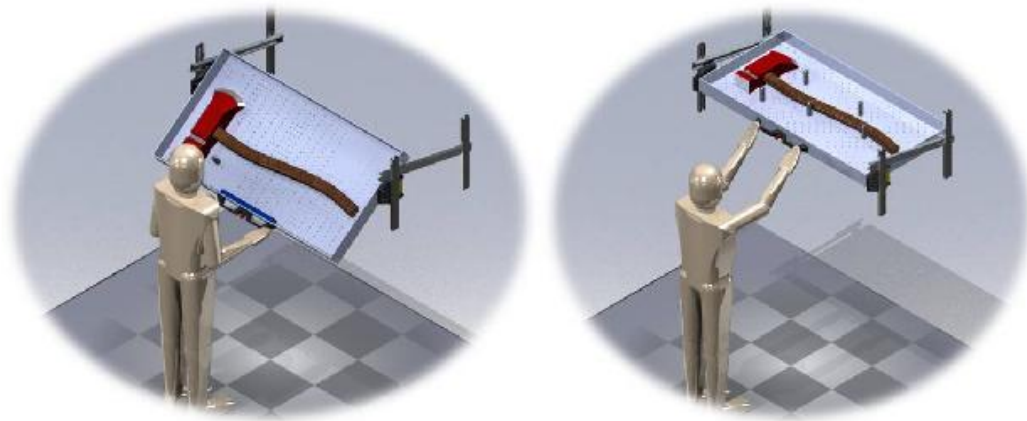



Slideandtilt.com

## Working Parameters

---

Following rigorous testing the following working parameters are recommended:-

- Working temperature range -40°C to +70°C
- Short term exposure -50°C to + 120°C
- 100% humidity / immersion in water
- 30,000 cycle life\*
- Loaded shock/vibration resistant
- Button push less than 7kgs of force.\*\*
- Patented easy click assembly

\*Equivalent to being operated over 8 times per day for 12 years.

\*\* If the lock ever becomes tight we recommend a quick jet wash/hose with clean water.



## Dynamics

---

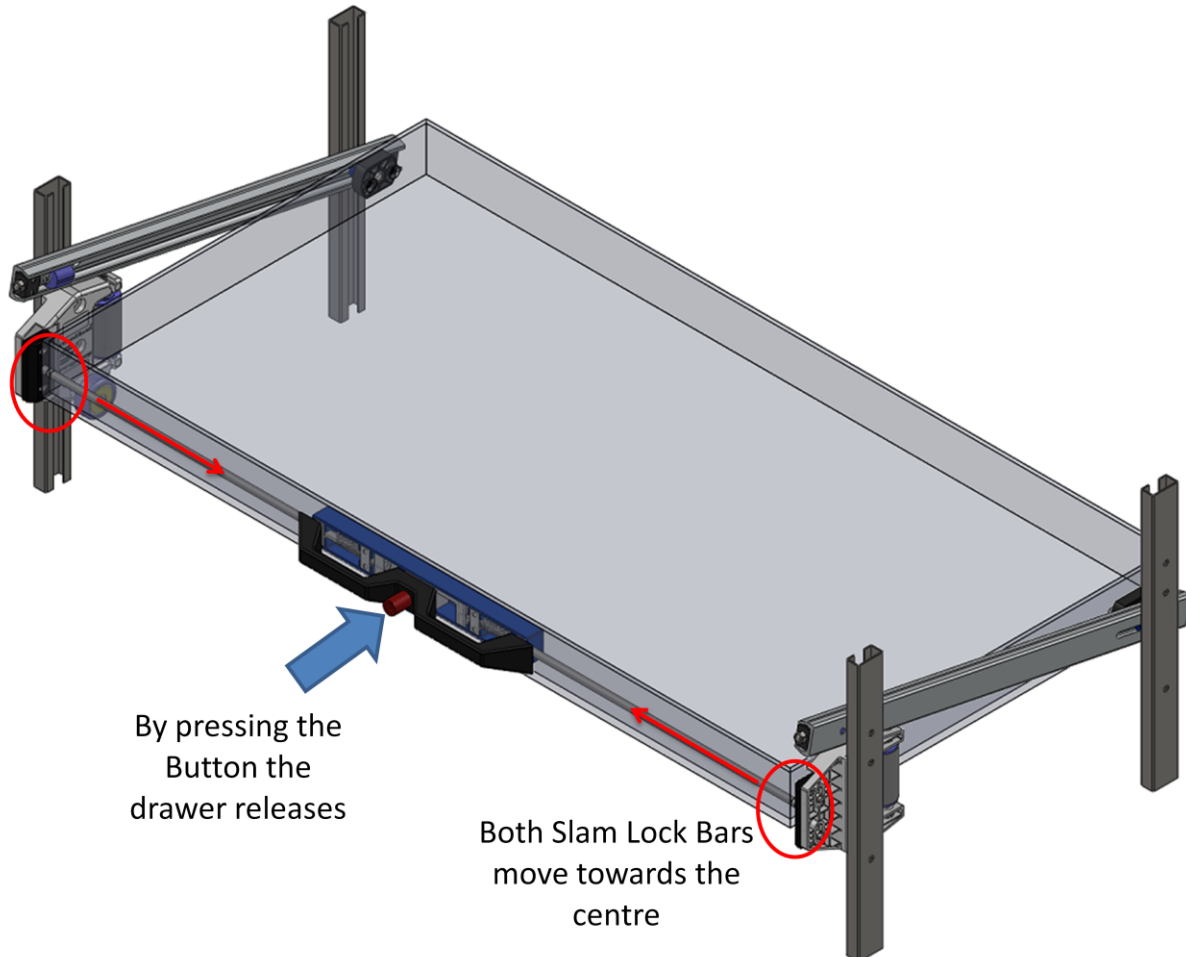

By pressing the Button the drawer releases

Both Slam Lock Bars move towards the centre

To open the drawer the operator presses the red button on the Front Handle.

This brings the Slam Lock Bars in towards the centre.

To lock the drawer shut the operator can push the drawer into place and the Slam Lock will lock back in place.



# Fixtures

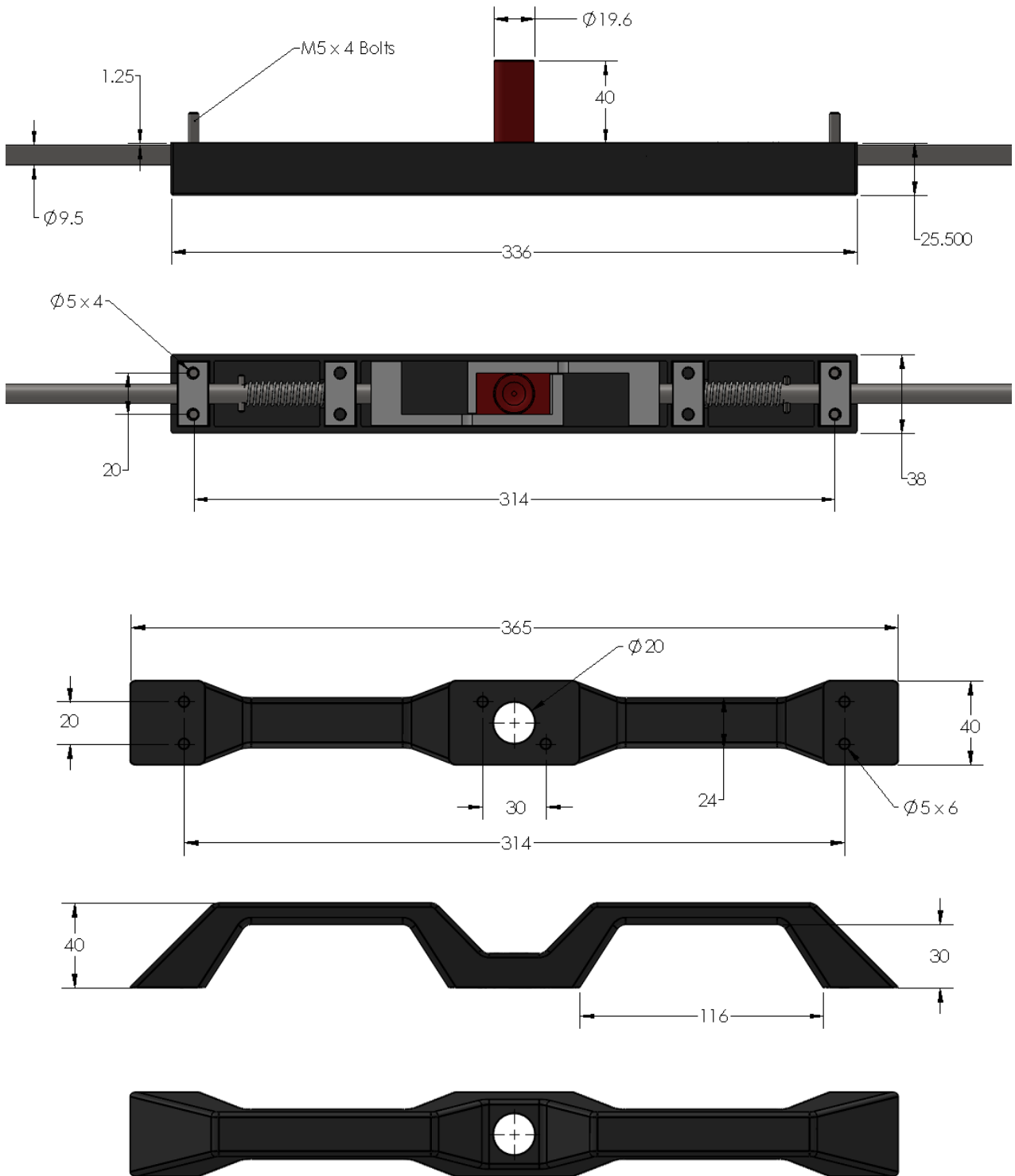



Slideandtilt.com

## Fixtures – Torque settings

---

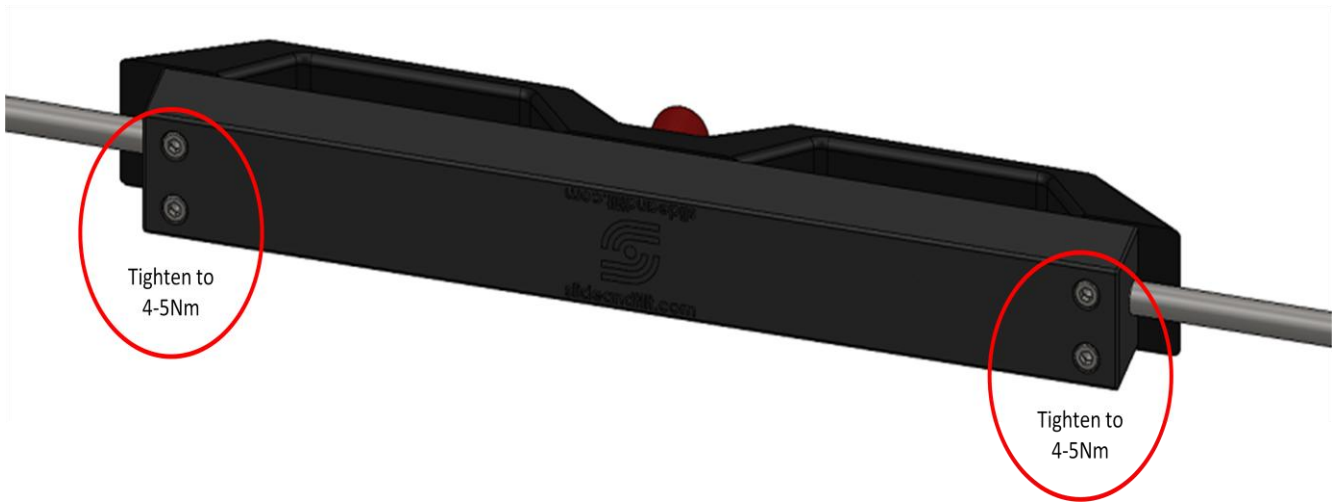

The above are recommended torque settings for fasteners.



# Assembly

The Slam Lock is sold in 3 ways:

- Fully assembled in 1500mm & 2000mm lengths
- Fully assembled and cut to customers length
- Part assembled ready for custom fitting

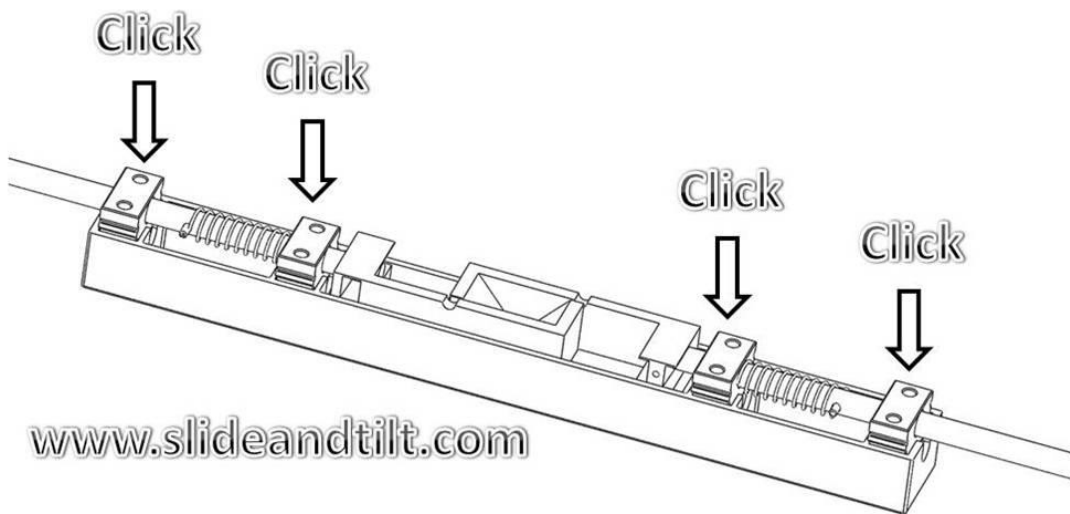

The above shows how the Part Assembled is 'clicked' together ready for final fitting. This process will take less than one minute to complete.

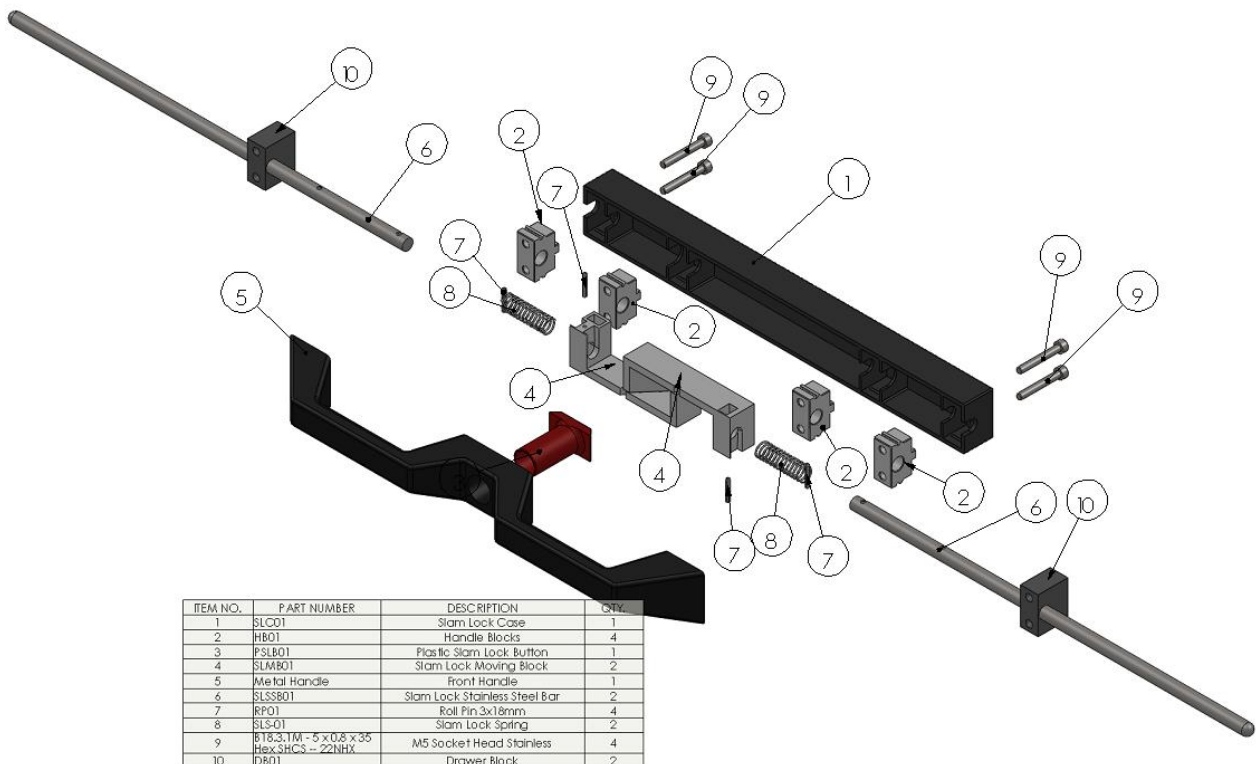





Slideandtilt.com

## Installation Considerations

---

Some considerations to take into account when installing the Slide and Tilt system are:-

- Locker Clearance – When installed is there clearance for the shutters.
- Locking Bars – When the Slam Lock Button is fully pressed the Locking Bars will retract in 15mm each side.
- Make sure all operators are clear from any possible pinch points around the drawer and lock.
- Training – Make sure all operators are fully aware of how the Slam Lock system operates.



Slideandtilt.com

## Sustainability

---

At the end of the systems working life all parts can be recycled.

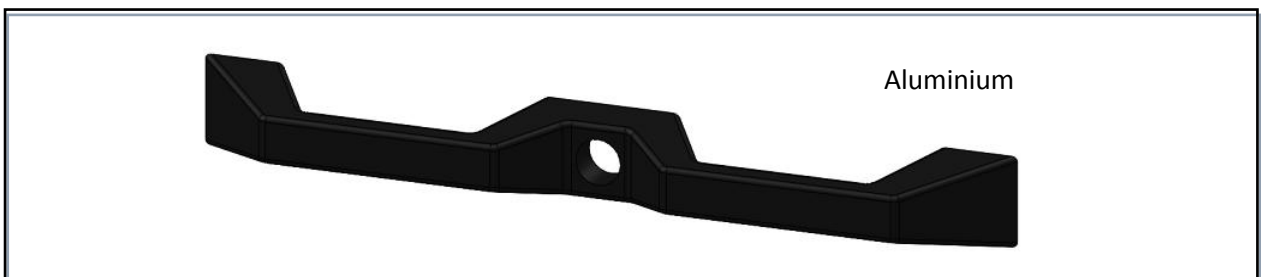
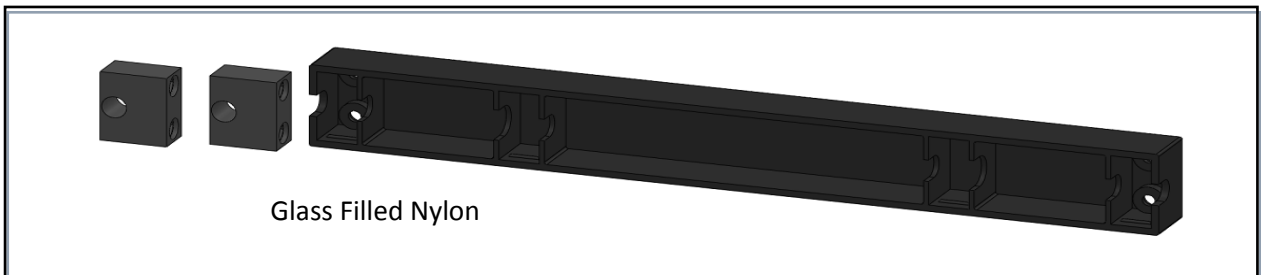
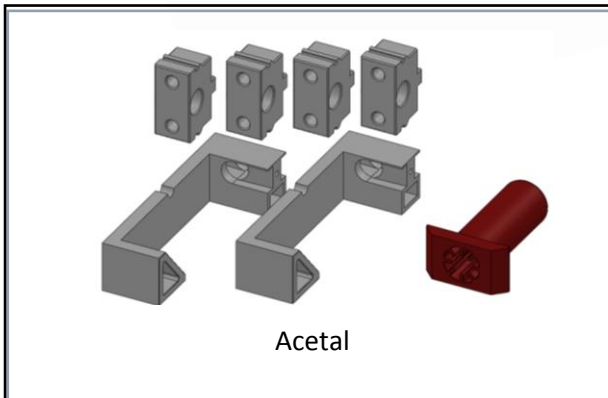



Slideandtilt.com

**UK Sales:**



Slideandtilt.com Ltd

Mile Oak Industrial Estate

Maesbury Road

Oswestry

Shropshire

SY10 8GA UK

Tel: 01691 679 516

Fax: 01691 670 536

Email: [sales@cvrollers.co.uk](mailto:sales@cvrollers.co.uk)

Web: [www.slideandtilt.com](http://www.slideandtilt.com)

**Italy:**



OTAR Srl

Lungobisagno Istria 29 M-R

16141 - GENOVA

Tel: 010/8356685

Fax: 010/8356695

Email: [otar@otar.it](mailto:otar@otar.it)

Web: [www.otar.it](http://www.otar.it)

**Rest of the World:**



Widney Manufacturing Limited

Plume Street

Aston

Birmingham

B6 7SA

Tel: +44 (0) 121 327 5500

Fax: +44 (0) 121 328 2466

Email: [roger@widney.co.uk](mailto:roger@widney.co.uk)

Web: [www.widney.co.uk](http://www.widney.co.uk)