

Insitu Concrete Ground Floor Solutions

(For Beam & Block floor solutions see overleaf)

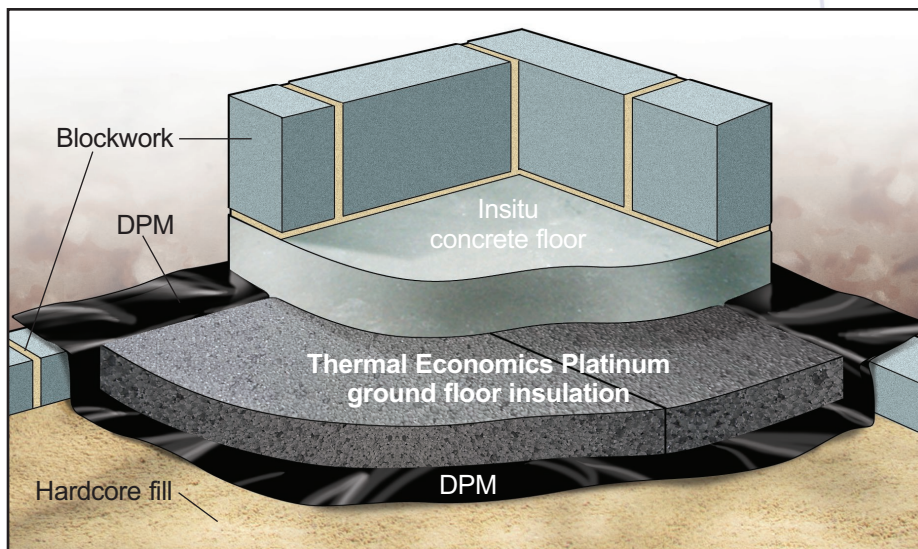

TE PLATINUM BOARDS UNDER INSITU CONCRETE FLOOR BEARING ON PERIMETER BLOCK WALLS (Typical Barratt, David Wilson detail.)

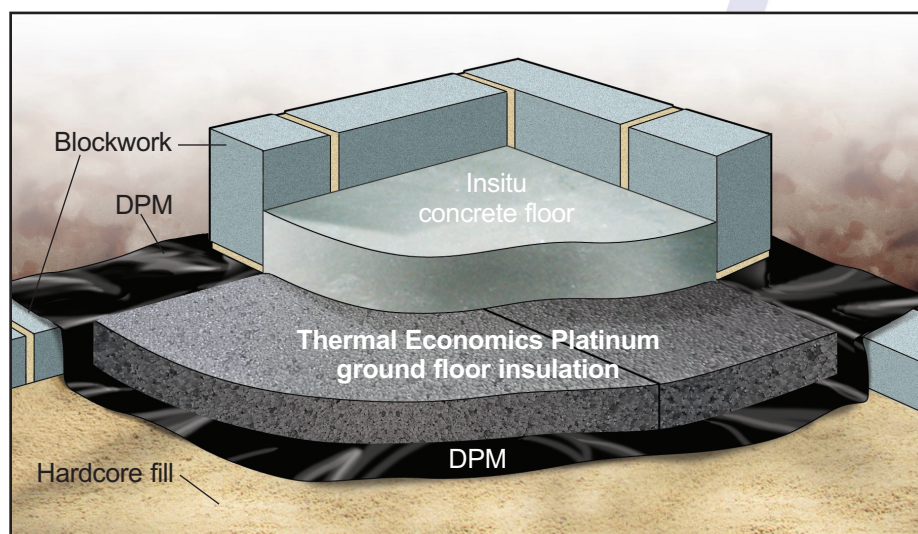

TE PLATINUM BOARDS UNDER INSITU CONCRETE FLOOR CAST ON GROUND.

Based on our extensive experience of providing SAP and Code Level calculations for our large UK house builder clients our Technical Department are confident on being able to provide you with the most cost-effective design solutions for your particular project.

Manufactured exclusively for Thermal Economics Ltd. by Springvale EPS Ltd. to BBA Certificate 91/2568

Thermal Economics Ltd, Thermal House,
8 Cardiff Road, Luton, Bedfordshire LU1 1PP

Tel:01582 450814 Fax:01582 429305

E-mail:info@thermal-economics.co.uk

Extremely cost-effective insitu ground floor insulation solution to Part L 2006/2010 and Section 6 Scottish Standards showing major cost savings against PUR/PIR boards with similar performance.

- ▶ A 100mm thickness of TE Platinum Ground Floor Insulation is equivalent to 75mm PUR and can achieve a U-Value of 0.20W/m²K.
 - ▶ A 130mm thickness of TE Platinum Ground Floor Insulation is equivalent to 100mm PUR and can achieve a U-Value of around 0.16W/m²K.
- N.B. All U-Values given are dependent on P/A ratios of Ground floor*
- ▶ Various thicknesses of TE Platinum can be supplied to achieve the better U-Values required for Code and Part L 2013/Section 6 2010 projects with values of 0.10W/m²K achievable.
 - ▶ TE Platinum is a BBA Certificated product for use with insitu concrete and beam & block ground floors. (N.B. SEE OVERLEAF)

Beam & Block Floor Solutions

(For Insitu Concrete Ground Floor solutions see overleaf)

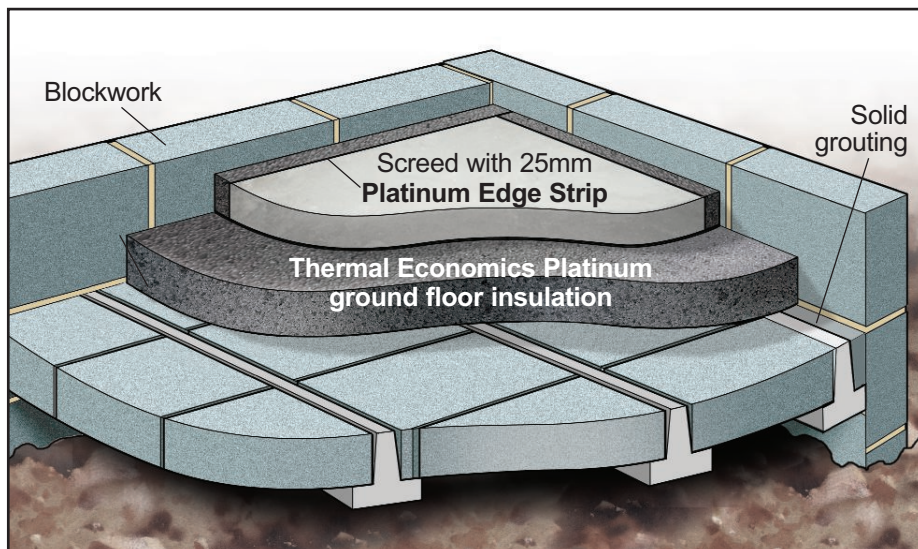

TE PLATINUM BOARDS ON TOP OF BEAM & BLOCK (OR INSITU CONCRETE) GROUND FLOOR

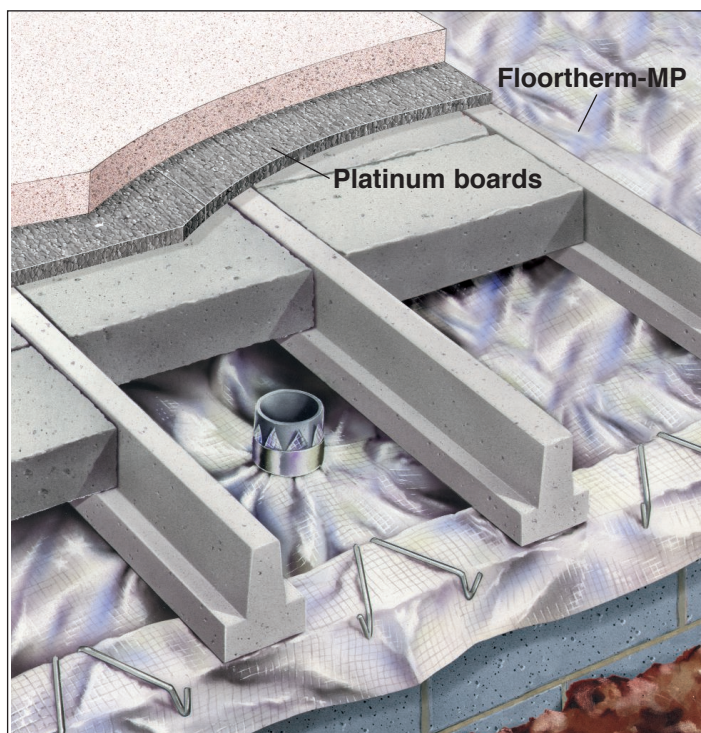

REDUCED THICKNESS OF 25-50mm PLATINUM BOARDS ON TOP OF BEAM AND BLOCK GROUND FLOOR WITH FLOORTHERM MP DETAIL BELOW.

Extremely Cost-effective Beam & Block Ground Floor insulation to Part L 2006/2010 showing major cost savings over PUR/PIR boards with equivalent performance

- ▶ A 100mm thickness of TE Platinum Ground Floor Insulation is equivalent to 75mm PUR and can achieve a U-Value of 0.20W/m²K.
- ▶ A 130mm thickness of TE Platinum Ground Floor Insulation is equivalent to 100mm PUR and can achieve a U-Value of around 0.16W/m²K.

N.B. All U-Values given are dependent on P/A ratios of Ground floor

- ▶ Various thicknesses of TE Platinum can be supplied to achieve the better U-Values required for Code and Part L 2013/Section 6 2010 projects with values of 0.10W/m²K achievable.
- ▶ Environmental Benefits: GWP = zero. ODP = zero. Boards are CFC,HCFC free and are 100% recyclable.
- ▶ Used by Major UK House Builders to achieve Part L 2006, 2010 Compliance plus Code for Sustainable Homes Standards.



ALL CALCULATIONS IN ACCORDANCE WITH BR443

PLEASE CONTACT OUR TECHNICAL DEPARTMENT ON 01582 544255 FOR THE SOLUTION TO YOUR PARTICULAR CONSTRUCTION

Please visit our website for the full range of Thermal and Sound Insulation products at www.thermal-economics.co.uk