



Thermatek

The Company To Warm To

Frost Heave & Condensation Prevention Systems

Application

The Thermatek low voltage Frost Heave Recovery system has been developed to assist cold stores that are already affected by frost-heave. A practical way to install a system that halts the process of frost heave and eventually eliminates it.

Abandoned buildings re-commissioned or cool rooms upgraded to cold store status.

The system also provides a cost-effective solution to the associated problems of ice formation or condensation in adjoining warehouses or offices.

Absolute minimum maintenance is required

Low Voltage

Frost -

Heave

Recovery

Vertical Element

Heating Systems

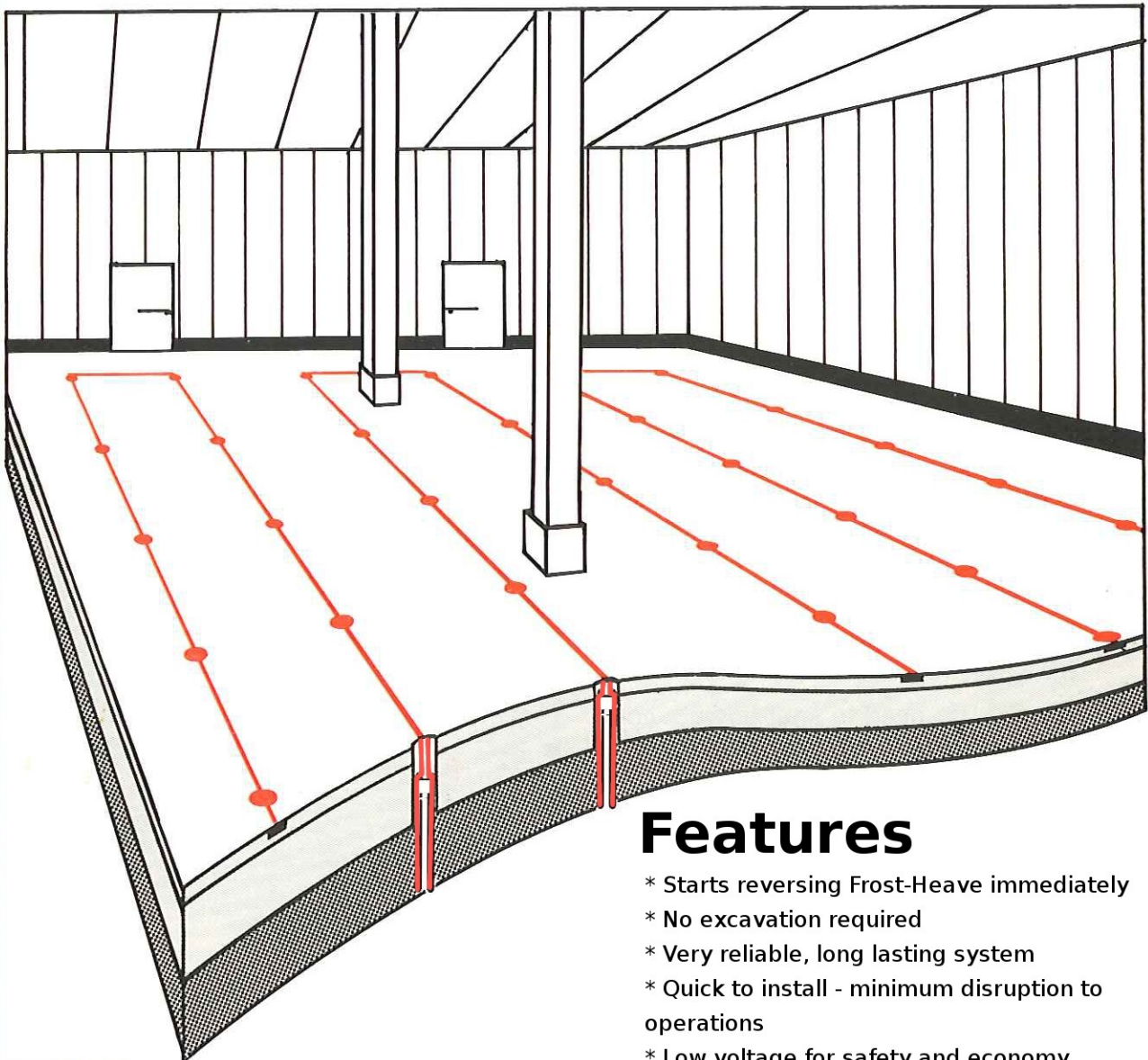

Features

- * Starts reversing Frost-Heave immediately
- * No excavation required
- * Very reliable, long lasting system
- * Quick to install - minimum disruption to operations
- * Low voltage for safety and economy
- * Quality materials used throughout
- * Systems customised to individual buildings



Thermatek Frost Heave recovery heating system to stop Frost-Heave development immediately....

The principle of the Frost Heave recovery system is based on the insertion through any concrete floor of fully insulated low voltage heating elements placed into the sub-soil over any floor size. No excavation is required other than drilled out floor cores.

Copper cold tail cables are laid in a connecting channel which link the heating elements in a series parallel combination. Simple and quick operating to infill the drilled holes and channels. The heating cables may be fitted in multiple circuits with the cold tails collected together at a busbar chamber which is connected to fully insulated low voltage transformers.

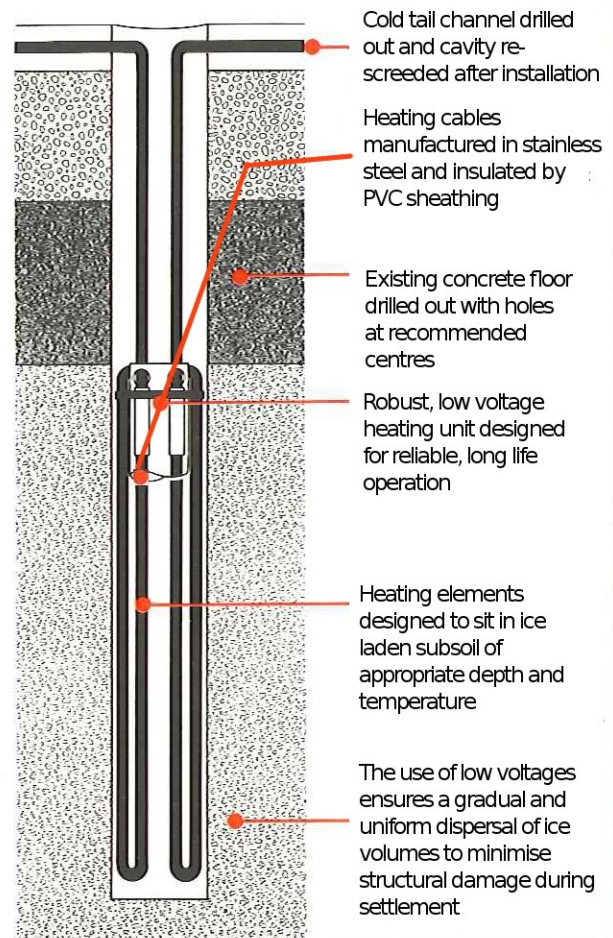

The system has three main advantages

1. The action of frost heave is immediately stopped, eventually reversed and finally eliminated. The period is dependent on the amount and depth of ice build-up.
2. The vertical heating elements are simple to install through a matrix of equally spaced holes drilled through the floor.
3. There is no need to shut-down a cold store as the system can be fitted in stages across the floor.

As with Thermatek's other Frost Heave prevention systems, the Vertical Heating equipment can be thermostatically controlled to operate at a temperature of a few degrees above freezing point. A safe and economical level of control ensures a controlled dispersal of the ice layer to avoid serious structural damage during settlement.

TYPICAL INSTALLATION LAYOUT

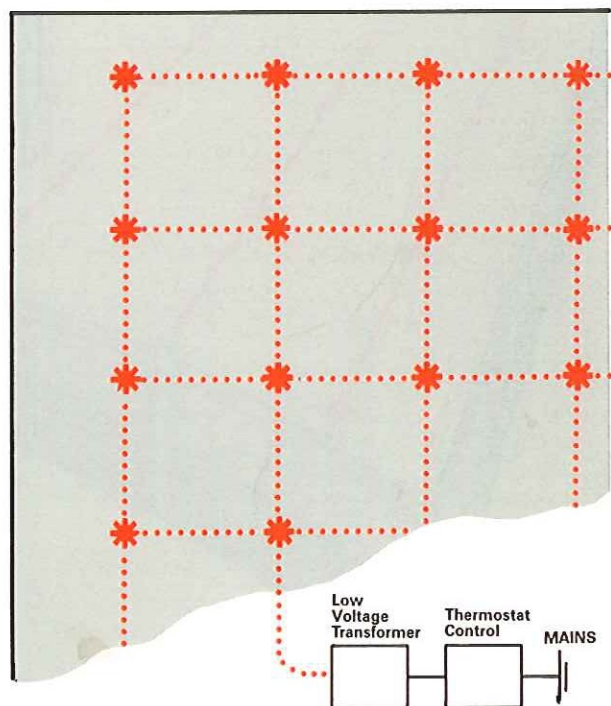

**Thermatek , Unit 5a Station Yard , Station Road, Hungerford,
West Berkshire, RG17 0DY , United Kingdom
For more information, contact Thermatek on -
Tel. 01488 684888**

**Email: sales@thermatek.co.uk
Website: www.thermatek.co.uk**