



## Lumiglas Luminaires Series USL05-Ex, II 2G EExdIIC T3/T4/T6

DATA SHEET 07.05

- **for mounting on sightglass fittings**

The unit is a versatile sightglass luminaire to Ex standard which is ideally suited for combined sight and light port (single flange version) as well as separate ports (2 flange version).

- **Extremely compact, high lighting power:**

Dazzle free illumination: suitable for circular sight glass fittings to DIN 28120/DIN 28121 standard or similar as well as for screwed sightglass fittings equivalent to DIN 11851 and flow indicators. Nominal sizes, depending on fitting: from DN 25.

- **Large light exit through appropriately designed screwed lens ring unit.**

- **Application:** For internal illumination of flow indicators, pipelines, laboratory plant and other normally totally enclosed vessels and reactors in **explosion hazardous areas designated Zone 1 as defined in IEC 79 -10**; suitable for use in food processing.

- **Protection index:**

dust and water jet tight IP65 to EN 60 529/DIN VDE 0470 part 1

- **Operating conditions:** independent of vessel internal pressure/vacuum

- **Lumiglas luminaires of this series may be used at ambient temperatures of up to 60° C.**

- **Certification:** EC-Type-Examination Certificate PTB 98 ATEX 2200.  IIG EEx d IIC T3/T4/T6 or 120° C

- **Ignition protection class:** EEx d 'pressure tight enclosure' to EN 50018

- **Explosion group:** IIC (all explosion classes)

- **Temperature class:** up to T6 (depending on power)

- **Easy electrical connection** (via works fitted cable trail)

- **Electrical data and parts:** in accordance with EC-Type-Examination Certificate

- **Electric supply:** alternating or direct current, depending on luminaire model

- **Operating voltage:**

without integral transformer: 12 V... halogen lamp 5 W or 20 W  
24 V... halogen lamp 20 W

with integral transformer: 120 V... halogen lamp 5 W  
230 V... halogen lamp 5 W

- **Screwed opening ideally suited for lamp change.**

- **Connecting cable:** works fitted cable resin cast in screwed cable gland for pressure tight cable entry; cable tail 2 m (standard), 5, 10 or 20 m long

- **Simple mounting by means of special bracket provides practical installation**

- **Accessories:**

- mounting supports/luminaire fixture:
- hinged bracket, part no. 0354.014.00<sup>1)</sup>
- adapter flange, part no. 1356.010.00<sup>1)</sup>



Lumiglas luminaire series USL05-Ex fitted with hinged bracket



Lumiglas luminaire series USL05-Ex (fitted to combined light and sight port)

- claw spanner for lens ring to open luminaire, part no. 6816.001.00<sup>1)</sup>
- EEx time delay actuator (external), see data sheet 09.02 (on request)

<sup>1)</sup> = Ordering code no.

## • Dimensions and electrical data for Lumiglas luminaires series USL05-Ex

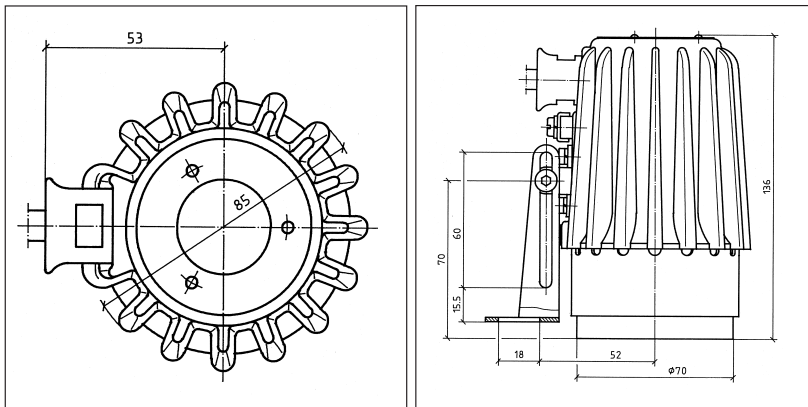

### • Parts, construction and materials:

- Luminaire body: corrosion resistant die cast aluminium alloy GK-ALSi10Mg
- Cable entry gland: with resin cast (potted) electric cable tail 2 m, e.g. (Sinothem 110 H05GG-F 3G 1,5 mm<sup>2</sup>).
- Ground conductor terminal: ready wired internally in luminaire body and connected to terminal on outer side of body
- Light outlet: integral unit comprising aluminium alloy ring and glass disc.
- Seal: Viton
- Fastening: see under 'Accessories'

### • Weight:

- 0.8 kg (without integral transformer)
- 1.0 kg (with integral transformer)

## • Light distribution (cd) and illuminating intensity (lx)

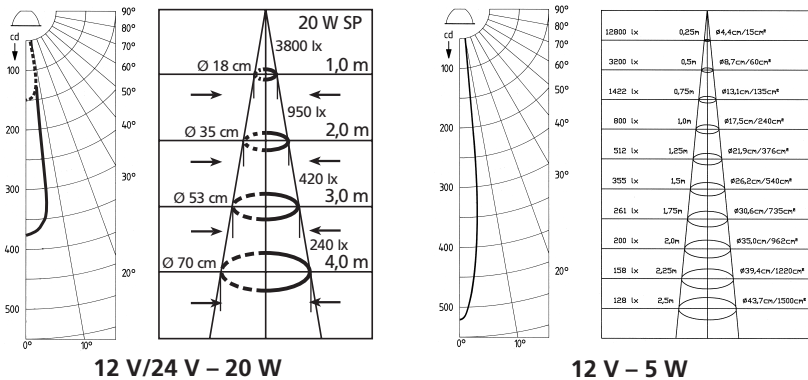

### • Ordering information, e.g.:

- Lumiglas luminaire model USL05-Ex 12 V/20 W, part no. 3540.035.00
- Luminaire fastening: hinged bracket, part no. 0354.014.00
- Claw spanner, part no. 6816.001

## • Electrical connection data:

Item	Lumiglas luminaire model USL05-Ex	part no.	net V	integral transformer	halogen lamp		temperature class		
					socket	voltage	part no.	at max. ambient temp. 40° C      60° C	
1	(12 V) 5 W	3540.031.00	12 ≈	–	G 4	12 V/5 W	3232.221.00	T 6	T 4
2	(120 V/12 V) 5 W	3540.032.00	115 ~	with	G 4	12 V/5 W	3232.221.00	T 6	T 4
3	(230 V/12 V) 5 W	3540.033.00	230 ~	with	G 4	12 V/5 W	3232.221.00	T 6	T 4
4									
5	(12 V) 20 W	3540.035.00	12 ≈	–	G 4	12 V/20 W	3232.229.00	T 4	T 3
6	(24 V) 20 W	3540.037.00	24 ≈	–	G 4	24 V/20 W	3232.222.00	T 4	T 3
7									
8	(24 V) 20 W	3540.038.00	24 ≈	–	G 4	24 V/20 W	3232.206.00	120° C	

## • Installation examples:



As lightport on sightglass fitting to DIN 28120 DN 50 using hinged bracket.



As lightport fitted to screwed sightglass fitting DN 65 using the adapter flange mounting.

All dimensions in mm unless stated otherwise. Subject to change without prior notice.  
WW 2x1000/08.03 3755.177