

# New frontiers



# Creating new frontiers

**M**ONOWA is a long-established manufacturer and supplier of operable, folding and sliding walls. We are proud of our heritage and for delivering imaginative, cost-effective solutions, together with our commitment to Quality, Health & Safety and high production and installation standards for our clients.

MONOWA's portfolio of projects spans several sectors: major public sector contracts including Health & Education; installations for Retail, Commerce, Industry & Professional firms; across Sport, Leisure, Conference and Hospitality venues here in the UK and overseas.

Our Head Office is based in Watford, and we have a dedicated, on-site manufacturing capability at our factory in Macclesfield, ensuring nationwide coverage. We specialise in the design and installation of movable wall and folding partition solutions for all buildings, working closely with architects, developers, leading construction firms, building contractors and directly on behalf of clients.

We are among the UK's most successful and respected manufacturing companies in the operable wall industry, and have a deserved reputation for service.

MONOWA has been designing and producing custom-made solutions to maximise usage of interior spaces since 1986.

We constantly look for ways to improve and develop our products in terms of design, operation and performance. Acoustic testing is carried out in UKAS accredited laboratories so as to comply with the latest recognised European standards and procedures.

Our products can be tailored to comply with current Disability Discrimination Act regulations (DDA).

“You can rely on MONOWA – it is the one aspect of any of my projects that I simply don't worry about!” GMI Construction



## Contents

PUBLIC SECTOR/ HEALTH / EDUCATION/ CULTURE .....	4
RETAIL/ COMMERCE/ INDUSTRY & PROFESSIONAL .....	10
SPORT/ LEISURE/ CONFERENCE/ HOSPITALITY .....	16
TECHNICAL SPECIFICATIONS .....	20-23
Series 100 .....	20
Series 75 .....	21
Series 50 .....	22
Series 10 .....	23

Why compromise on either durability or design? Our complete package is styled and delivered with the same philosophy, whatever your budget - guaranteeing stunning results. We believe that design is strongly connected to business success. How interior environments are shaped can have a profound effect on behaviours, organisational culture and individual performance. As a company, we strive to ensure best-practice environmental and energy-rating requirements are met and that our products reflect 21st century trends in design and engineering as well as standing the test of time.

We hold most leading construction industry and contracting accreditations including ISO 9001 (in Quality Management), ISO 14001 (in Environmental Management), CHAS, SAFEcontractor and Constructionline which demonstrates our commitment to delivering leading edge performance. We are also holders of 'Investors in People'.

Log on to our website [www.monowa.co.uk](http://www.monowa.co.uk) to discover more about our range and for further technical information. Or call our friendly, knowledgeable sales team now on +44 (0) 1923 244258 to discuss your project needs.



**Great service comes as standard from a first-rate team who are experienced in all aspects of design, manufacture and installation.**

**We invite you to sample our unrivalled end-to-end support throughout your project journey.**

**Our operations and expertise have taken us into the following markets: West Africa, Far East, Eastern Europe and Middle East**



# Intelligent spaces...

We are renowned for delivering practical, best-value solutions for leading-edge organisations across the whole public sector – including successful contracts on behalf of the Ministry of Defence, The Home Office and Criminal Justice System, Fire Services headquarters and for numerous Local Authorities. We have a particular track record of working successfully within the education and health arenas – where we are a preferred supplier to a number of main contractors on programmes such as Building Schools for the Future (BSF) and Private Finance Initiatives (PFI).

## University of Manchester

This institution of higher learning has a global reputation and tradition stretching back 180 years. It is known for its distinguished, pioneering research and innovation. It sits at the centre of one of the UK's most vibrant cities. Current goal: to be ranked in the top 25 universities world-wide, and, as part of such ambitions, it has recently embarked on a £650million capital investment programme – covering

state-of-the-art buildings, major refurbishments and public realm works.

Among these new facilities, the architects, John McAslan + Partners, were commissioned to build the flagship University Place which forms its cosmopolitan centrepiece.

On the one hand, here you will find superior educational facilities such as lecture theatres and the Visitors' Centre, on the other, a panoramic café reception area.



“I found the service that MONOWA provides is highly professional – delivered within the constraints of our client’s criteria and deadlines.”

Senior Contracts Manager, Taylor Woodrow

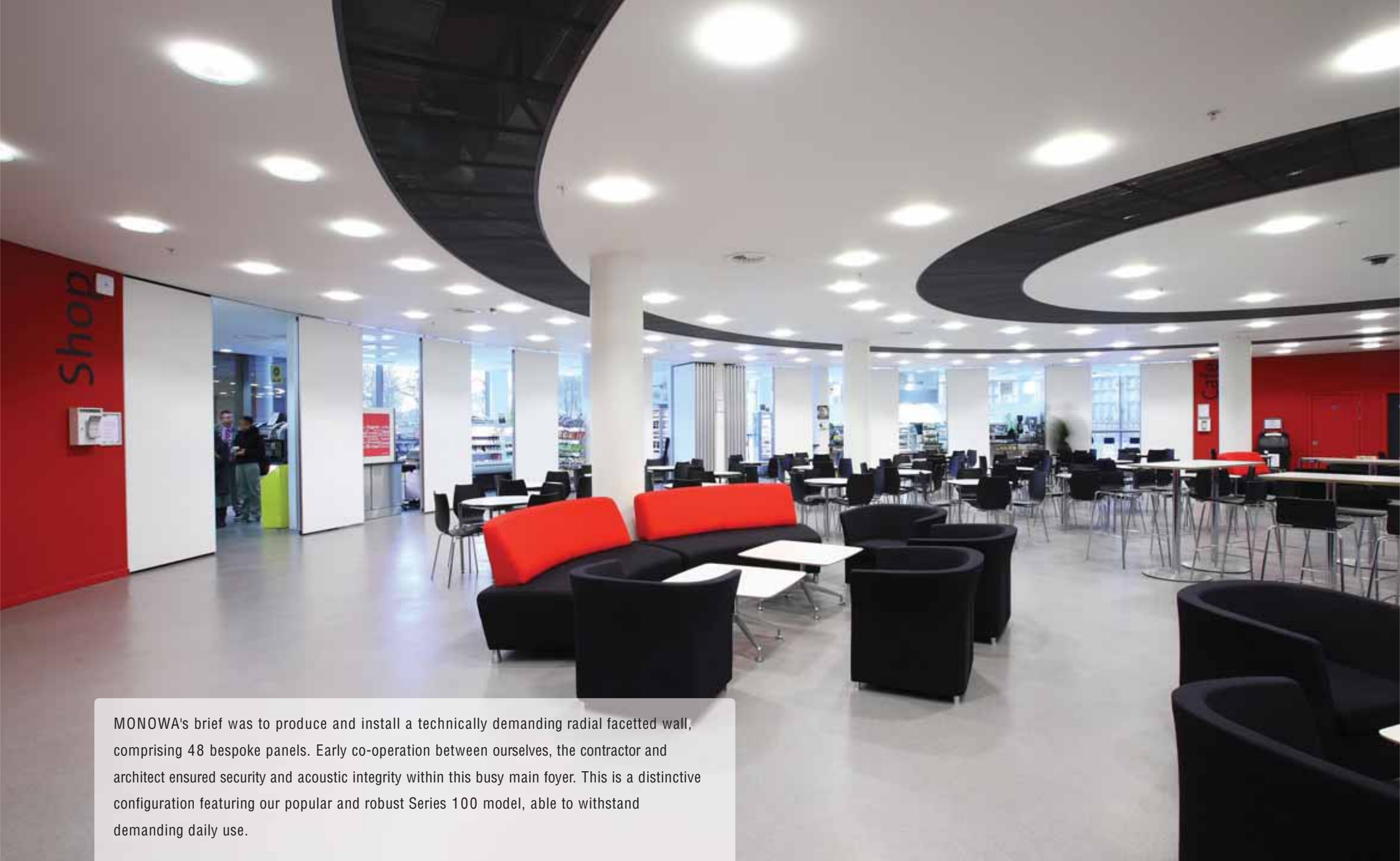

MONOWA's brief was to produce and install a technically demanding radial faceted wall, comprising 48 bespoke panels. Early co-operation between ourselves, the contractor and architect ensured security and acoustic integrity within this busy main foyer. This is a distinctive configuration featuring our popular and robust Series 100 model, able to withstand demanding daily use.

...for everyday flexibility

### The Christie NHS Foundation Trust, Manchester



Simple, versatile and effective. A stylish, steamed beech veneer finish applied to our Series 100 range was specified to match existing furniture in the conference rooms at one of Europe's leading cancer centres. Our system was installed to sub-divide meeting rooms within the hospital which has undergone a £35million fit-out - including the construction of a new-build treatment centre set to be the largest early clinical trials unit in the world.

*Simple* for medical staff to manoeuvre – *versatile* in terms of accommodating different sized groups – *effective* in blending and separating available space, whilst complementing adjacent furnishings.



### St. Helens and Knowsley PFI Hospital, Merseyside

Five Series 100 Top-hung panelled walls in white melamine finish were chosen by Taylor Woodrow Construction as part of this £338million PFI hospital construction project – the largest local health development scheme since the formation of the NHS.

The installation needed to reflect a welcoming, bright patient-focused environment within a disadvantaged community where it is hoped the hospital's overall design will bring improvements to health, recovery times and the general well-being of patients.

### The Beaumont Hospital, Dublin

This Series 50 vinyl concertina room divider provides a lightweight, quick operation alternative, ideal for environments where acoustic performance is not of great importance, but low-budget is!

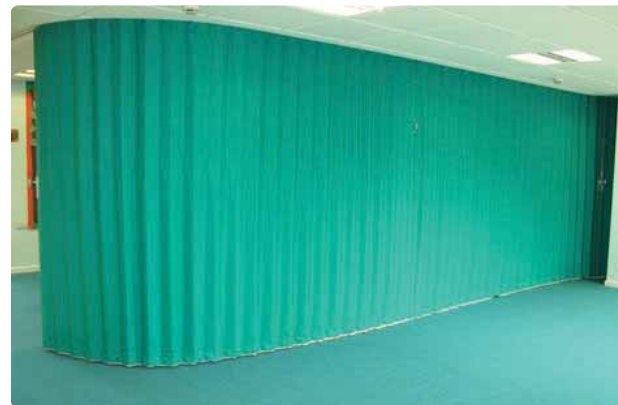

### St. James Church of England Primary, Tameside



Working in a town-centre school in an area with higher than average indices of social need, our task was to provide a flexible interactive Series 100 solution incorporating a high gloss, magnetic, dry-wipe whiteboard finish including a funky, blue Inset Pass Door with matching powder-coated profiles, contributing to a smoother, more uniform look and feel. This divides the older-style school hall from a classroom which is in daily use, permitting two rather different activities to run in parallel. Within the hall, the entire school can be treated to slide-shows and projections, while on the other side, there is a distinctive landscape for pupils and their teacher during lesson time.





Harrold Lower School, Bedford



A pleasing Top-hung solution (there are no floor tracks or guides) suitable for schools, church halls, community and conferencing venues. *Peace of mind* – the mechanical top and bottom retractable seals and our durable head track (seen here in an attractive village school setting) make this Series 100 model simple and easy to manoeuvre.

MONOWA introduced large double-glazed 'Vision Panels', which allow for light to flow between the newly-extended dining hall and a quiet, air-conditioned library next door.

*Pure flexibility* - you can choose from an almost infinite range of finishes, wood veneers, laminates, melamines and other finishes to complement your internal décor.



Community settings nationwide



Our Series 50 is in demand in situations such as nursery schools, hospital wards and community halls where budget or other practical considerations are often the determining factors. Finished in a heavy-duty, fabric-backed, flame-retardant vinyl, it resists the growth of mildew, mould, fungi and bacteria.

Both Wideline and Slimline stacking options are available. Easy and speedy to install, the Series 50 guarantees minimum fuss and offers a variety of vibrant colours to enhance your room setting.

Imperial College London



The Series 100 operable wall units are seen here in a bold, primary blue from the Polyrey Papago laminate range which provides colourful contrast, matched by smooth performance in another bustling university environment. Typically, such interlocking panels are constructed using 18mm outer-facing boards, mounted on steel framework. Internal cavities are filled with the latest sound-proofing materials – these can offer up to 56dB acoustic rating. We can even supply in magnetic dry-wipe, steel, pin board or acoustic board finish.



University of East London



The UEL Stratford Campus is on the doorstep of major regeneration works surrounding the Olympic Park and preparations for London 2012. MONOWA was commissioned to capitalise on mixed usage within a first floor space at the Sir John Cass School of Education.

We supplied three Top-hung, Bi-parting Series 75 walls in oak veneer within the building, which is a hub for teacher-training and development, as well as a community resource accessible to school children from across the region. The £8million scheme, designed by award-winning Richard Murphy Architects, is organised around a central

atrium with information and exhibition areas for students' work.



Series 75  
Recessed door handle

Kensington Neighbourhood Centre, Liverpool



Now more than ever, local councils require added functionality from their buildings – here is a fire station that also serves as community Neighbourhood Centre, fully maximising usage of modern facilities and catering for various needs.

Whilst a large meeting room is a necessity, it's great to incorporate a folding wall option - placed two thirds across, this easily divides the room when required, for small intimate groups. Extending panels from their parked area takes only a couple of minutes. It's so simple and quick to operate. This Bottom-rolling Series 75 model is finished in easy-to-clean

white melamine.  
Architect: Harrison Ince



Series 75  
operating handle

M Shed, Princes Wharf, Bristol



In the middle of Bristol's vibrant cultural scene is the new M Shed harbour-side museum. Having undergone complete restoration it now houses bright, world-class gallery and exhibition spaces.

The first floor is multi-functional – this means there is a requirement both for privacy and yet easy access for visitors, while still taking full advantage of the fantastic waterfront views. MONOWA installed various combinations of operable walls to overcome this challenge. We created a corridor by installing a Series 100-GP unit. This incorporates 'Vision Panels' together with magnetically-operated internal blinds.

Also, a Bi-parting Series 75 folding wall encloses the space inside – and its centre panels are finished in a veneer to match existing doors within the building. Two further Series 100 models have then been positioned so as to provide multi-size room options – again these feature veneered Pass Doors.



**Trinity Roman Catholic Primary School, Liverpool**

This thriving school, on the outskirts of the city, sets high standards of expectation for children's personal and educational development.

Our task involved the installation of 10 Series 100 panels, allowing a vast area to be subdivided into two rooms – one half for P.E. and games, the other, functioning as extra classroom or learning space. The client required a high-quality ash finish, with an Inset Pass Door and 54dB acoustic rating to limit sound migration.

The result: a completely bespoke, dramatic, low-maintenance, cost-effective, moving wall.

From concept to completion – working with architects, designers, contractors and fit-out specialists MONOWA delivers the ultimate in space innovation.



“MONOWA carried out the installation of the folding wall at Trinity School to a very high standard and this was delivered within timescales. I will most definitely be working with them again on future projects”

Senior Quantity Surveyor, John Turner & Sons

**Ministry of Defence, Essex**

Construction of the £560m Merville Barracks – one of the largest PFI defence accommodation projects to date – provides a new home for the Colchester Garrison & Headquarters to 16 Air Assault Brigade.

A lot is demanded of our troops in the modern world – this scheme marks a new standard in living and working accommodation for the Garrison's 3,500 military personnel and 700 civilian staff. Despite the enormity of the overall project, phase one was completed 10 weeks ahead of schedule. MONOWA was drafted in by Contractor RG Carter acting for Sir Robert McAlpine. Specification: eight operable walls of varying dimensions for the Education Centre – these were installed at ground and first floor levels mainly to divide classrooms but also to create flexible spaces in the band room. Architect: Capita Symonds.

**Home Office, Sheffield**

Vulcan House, the recently-completed Home Office HQ at Riverside Exchange, is setting the style for new, green workspace. Engineering Consultants Mott MacDonald worked alongside developer Wilson Bowden and local architect Hadfield, Cawkwell, Davidson to create a building with outstanding environmental ratings – low-energy, more efficient across the board – in fact, a test bed for the Government's aim to minimise its ecological footprint and measure CO<sub>2</sub> emissions right from design & construction phase, through operation and, ultimately, its demolition.

As a subcontractor, we were able to satisfy our client that we play our part in tackling climate change through our use of approved materials.

# Open your mind...

Open your mind...

For the past 25 years, MONOWA has retained core values of quality, service and choice whilst striving to keep pace with advances in technology and emerging trends. Think about it... increasingly, commercial offices in which we work and retail environments where we shop reflect our modern tastes. As buildings take on an increasingly sophisticated style, so we too respond, ensuring our designs and installations remain contemporary in this rapidly-changing world. As a company, we are very much aware that our products must achieve relevance, whatever the surroundings.

Adaptability is essential, and we work positively alongside businesses large and small, banks, professional firms, in industrial settings and with leading high street names, including Tesco, Waitrose and Marks & Spencer.

## **Decoma Sybex, Banbury**

Based near Oxford, Decoma is part of the multi-billion dollar Canadian-owned Magna Corporation – supplying exterior vehicle appearance systems (that's bumpers and stuff to you and me) to some of the world's largest car and vehicle manufacturers. They produce exterior trims for BMW, among others, within the UK.

Setting the pace: our Top-hung Series 10 system offers the latest in glass folding wall innovation.



Placing our products into such a highly-automated, performance-driven factory situation demands excellence. Our creative and technical teams recommended a Series 10 frameless glass wall, featuring eight sparkling panels installed within the main 'customer experience and discovery area'. It has proved a real winner – incorporating 10mm toughened safety glass and a bespoke vinyl decal or manifestation, bearing the company's distinctive brand identity.

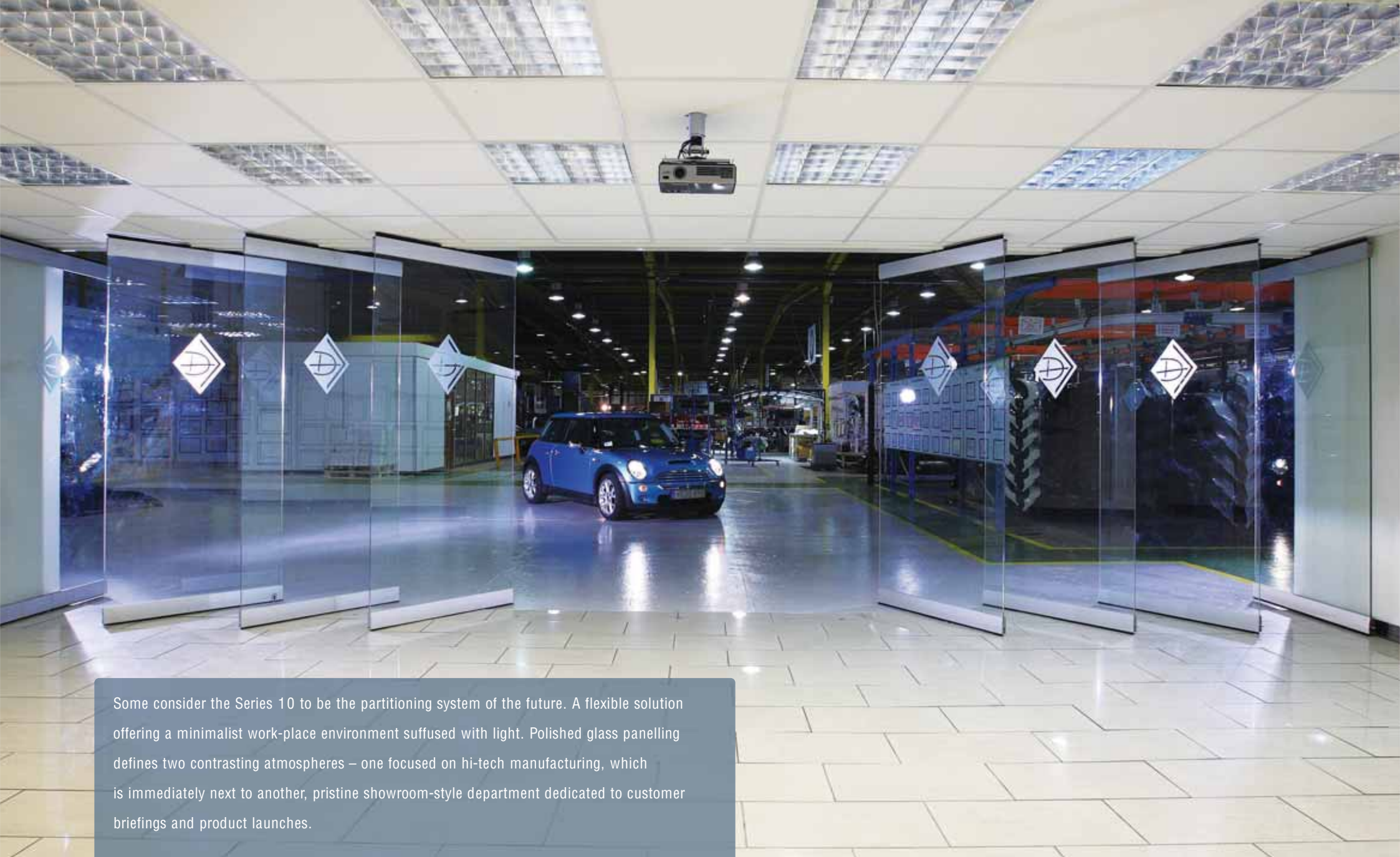

Some consider the Series 10 to be the partitioning system of the future. A flexible solution offering a minimalist work-place environment suffused with light. Polished glass panelling defines two contrasting atmospheres – one focused on hi-tech manufacturing, which is immediately next to another, pristine showroom-style department dedicated to customer briefings and product launches.

...to the spaces of the future





St. Philips Chambers, Birmingham



This landmark legal chambers epitomises all that is best in fluid, contemporary office interiors. When shaping the boardroom and meeting areas, off their impressive first floor Reception Zone, our client sought maximum use of space and a hi-spec solution. The result is a smart, professional yet welcoming place in which to conduct business. This project combines two of our best sellers working side-by-side – both the Series 10 and the Series 100. In tandem, they increase the range of possibilities for cleverly dividing space to cater for meetings of varying sizes and multiple usage.



Series 10 bottom clamps and shoot bolt



Series 100 standard panel operation



Series 100 telescopic panel operation

The Series 10 glazed panels encourage a sense of openness, clear communication and visual freedom – acting effectively as a transparent 'wall'. Located at right-angles are two sets of trendy, oak finished Series 100 panels, which perform as sliding, retractable room dividers. Inspired and truly adaptable, our operable walls, working in harmony together, enable the tenants to utilise the space within efficiently and according to their everyday requirements, in terms of aesthetics and acoustic performance.

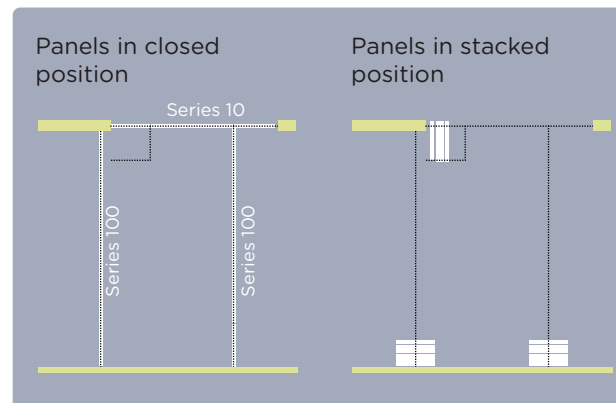

Regenda House, Bolton



A modern twist with designer wallpaper in a zesty shade imaginatively applied to MONOWA's standard Series 100, factory-finished in primed MDF, and decorated on site. This injects real vibrancy and energy for inter-connecting rooms, used both as a Learning & Resource centre and for Health & Safety training sessions. When panels are stacked away this reveals a generous open-plan suite. Seen here is a Full-height Pass Door which can be used as an alternative to an Inset Pass Door. Our client is a leading, independent North West housing and regeneration organisation. This shows how, with a choice of wallpaper or paint, you



can transform an otherwise bland interior and open up a world of opportunities.

Series 100 recessed door handle





Moore Stephens, Corby



Another professional working environment, this time new head offices for an independent Accountancy and Consulting practice. Yet more evidence of the imaginative features we can introduce to your work-place. Here is a novel treatment where a functional meeting room and a more formal, adjacent boardroom are linked by striking D-shaped portholes inset within Double Pass Doors. We can manufacture similar bespoke 'Vision Panels' in a wide range of shapes and sizes. The selected finish here is ash to match the room's internal décor.

Series 100 Vision Panels





BP Collins Solicitors, Gerrards Cross, Bucks



A sequence of fresh, white Series 100 folding doors with bespoke porthole 'Vision Panels' to the Inset Pass Door. The design highlights that less is more, and a contemporary look can present great results. This full-service law firm offers both commercial and private client services and is ranked among the top regional firms in the Thames Valley area.

Unilever, Leeds



Working in partnership with the design consultants, our brief was to deliver dividers in two sets of conference rooms on the ground floor, ensuring the all-important feature of limiting noise transfer together with 'remote parking' so that, when folded, our panels are tucked neatly out-of-sight. We supplied these Series 100 Top-hung panels as two walls in Formica laminate, each boasting bold, striped colours.

Leading Retailers

We are regular suppliers to several leading high street supermarkets. Our operable walls are a standard feature installed within staff training areas. We have worked in partnership with a variety of contractors including: BAM Construction, Bowmer & Kirkland, Costain, RG Carter Construction, Kier Group and Taylor Woodrow. Our practical partitioning can be found in more than 200 Tesco stores nationwide, and was recently applied within their Oldham superstore. We also work on behalf of Morrisons, Waitrose and Marks & Spencer.

“They undertook the project in a very efficient manner, on time and on budget – we would be happy to recommend them to other contractors.”

Bowmer & Kirkland Ltd

“MONOWA’s operable folding wall segregates two areas that require minimum sound transmission. The system fulfils this criteria and fits well into the surroundings while giving flexibility to the office suite.”

Building Standards Manager, Waitrose, for John Lewis Partnership



Panels deliver impact in conference facilities located at Morrisons Head Office in Bradford

# Designed to be adaptable...

DESIGNED TO BE ADAPTABLE...

Here at MONOWA, we pride ourselves on our ability to create walls which fit seamlessly into any surrounding. Whether your venue is a major sports arena hosting thousands of people on a match day, or a characterful, country house hotel, you can count on our expertise to ensure that your installation will represent the best possible fit for both practical and aesthetic needs.

You can choose to make a statement with your operable wall, or just keep it subtle – it is entirely up to you. The sky's the limit in terms of the shades, textures and imagery you can apply in order to enhance the impact of your building's interior. We simply provide the canvas for your creative flair!

From a commercial point-of-view, the space within banqueting and conference rooms needs to be easily reconfigured.

An ability to cater for events ranging in size from small meetings to large-scale business conventions, and where guest or delegate numbers vary from day-to-day, is essential.

Hoteliers with an eye to repeat bookings can count on our products being both durable, with a long life expectancy, and easy for staff to manage and operate. Often, we dove-tail our installations with complex fit-out processes which can involve multiple contractors and working to tight time schedules. This comes naturally to MONOWA.



“MONOWA’s good communication brought about ‘On time delivery’. I’d be happy to work with them any day!”  
Senior Project Manager, Carillion



Whitley Hall Hotel, Grenoside nr Sheffield

This 31-bedroom Tudor property overlooks a lake and is situated within beautifully-kept gardens. It combines a traditional welcome and idyllic setting with comfortable design – receiving the accolade Yorkshire Life Hotel of the Year for its appealing ambience and fine cuisine.

The hotel recently underwent refurbishment and our Series 100 wall was introduced to enable the larger function room and a smaller, more intimate dining area to be linked on those occasions where sizeable parties are to be accommodated. Our cue here was to deliver something charming and understated.





A rich, dark walnut treatment is shown to which colour-coded, powder-coated edge profiles have been added, resulting in a subtle, appropriate backdrop, in keeping with the hotel's warm and luxurious interior.

...for events of all sizes



Select from: real wood veneer, melamine, plain MDF – so you can add your own wallpaper finish and designer touches. We can even supply in magnetic dry-wipe, steel, pin board or acoustic slotted board finish.

#### Radisson and leading hotels



Radisson, Holiday Inn, Q Hotels, Center Parcs, Ramada, Future Inns and Cosmopolitan Hotels are among leading operators who have adopted our wall systems. To match their brand, look and feel we need to ensure our operable walls blend into these highly trafficked environments.

“We have found the MONOWA system to be extremely reliable and on the rare occasion that there has been a problem since the 10 walls were installed in 1989, MONOWA were there quickly to rectify things.”

Property Manager, Park Avenue Hotel, Belfast

#### Lodge on Loch Lomond, Scotland



This picturesque Highland hotel required an individual and stylish approach. The two walls we supplied here almost a decade ago remain in vigorous daily use, so don't just listen to us when we say our products are durable!

“These walls are used at least five times a week – sometimes two-to-three times a day”, hotel staff confirm. “Since the operable walls were installed, they have required only one service – now that's reliability!”

Our client opted for two Series 100 panels with walnut veneer finish, echoing the natural surroundings and matching the hotel's smart interior. However, on top of this, it was essential for our design team to come up with an inventive solution for the location of a third head track – in order to give added choice for the positioning of the two walls. This avoided the cost to our client of building a permanent extra wall. We included an Inset Pass Door for easy access.

### The Brit Oval, Kennington, London



Renowned not only for its fixtures and heart-stopping moments, as England squares up to the cream of world cricket in another thundering test match on the pitch, The Oval is also a premier sports stadium venue; home to Surrey Cricket Club, it delivers an action-packed year-round conferencing and events programme. We installed our operable walls in the new crescent-shaped Hospitality and Viewing Box areas, as well as in a series of conference spaces located on the first and third floor levels. In total, seven walls, each with a 50dB rating, allow for multiple configurations. Finished in MDF, these were painted on site according to the client's wishes.

### Lammas Leisure Centre, Sutton-in-Ashfield, Notts

From health and fitness suites to an exercise studio, squash courts, 25m swimming pool and a rink used by the National Ice-skating Association, this is a winning, keep-fit environment. The centre was opened by Dame Kelly Holmes, and built as a partnership between Ashfield District Council and a private sport and health company, with a view to improving local leisure amenities.

We understand such situations do require careful acoustic planning. 56dB panels were chosen as high-energy dance and aerobics sessions occur alongside more sedate yoga classes and club meetings.

The walls were required to operate with ultimate ease.

We opted for two identical Series 100 walls in oak effect melamine finish.

MONOWA products have been used in numerous sports and leisure venues, from golf and tennis clubs to football grounds and athletic venues, as well as installations within Center Parcs holiday villages.



“MONOWA met all of the design team’s technical requirements, and were also flexible enough in their approach complying with the main contractors’ programme and site access constraints. We believe the finished product gives this Centre a truly creative space which fully meets the client’s expectations. I can’t see any reason why my firm would not be happy to work with or propose MONOWA on any future projects.” GLR Architects





# Series 75

Bottom-rolling or Top-hung Folding Walls  
 Primarily floor supported, but can also be Top-hung. Panels are hinged together and slide and fold to one side (Single wing) or both sides (Bi-parting) of the opening

Acoustic Performance	Rw30dB – Rw45dB
Panel Weight	35kg/m <sup>2</sup> - 45 kg/m <sup>2</sup> (dependent upon acoustic rating)
Maximum Opening Width	Unlimited, although wider openings may be constructed using floating units
Maximum Panel Height	4000mm
Panel Width	500mm – 900mm
Panel Thickness	80mm (nominal)
Fire Rating	Class 1 and Class 0 surface spread of flame are available
Head Track and Floor Track System and Configurations	<b>Bottom-rolling</b> - heavy duty aluminium floor tracks with concealed fixings, 100mm x 10mm, finished in SAA. Designed for screed or raised floors and incorporating a top guide track <b>Top-hung</b> - heavy-duty aluminium head track with integral ceiling support trim 120mm x 75mm finished as standard to RAL 9010, but can be powder-coated to any RAL or BS colour. Usually without floor tracks or guides
Mechanisms and Ironmongery	Face operated espagnolette bolts locate panels securely in position. Escutcheon finished in SAA to face of alternate panels. Recessed D ring handle finished in SAA on lead panel which usually acts as a Full Height Door
Jamb Details	65mm wall posts at either end of system to match panels.
Head Fixing and Acoustic Baffling	For the Top-hung systems, Head Track is typically suspended from a structural steel I-Beam or concrete soffit with galvanised steel rods at 450mm - 600mm centres similar to the Series 100 system featured opposite. Can also be fitted directly to the soffit. For the Bottom-rolling system, a 'top guide track' is necessary to maintain the wall in a vertical position. Any acoustic baffling to ceiling and/or floor voids is designed to maintain the acoustic performance of the wall system
Panel Construction	Double skin 12mm high density chipboard clad to twist-resistant aluminum frame with internal layers of sound-reducing materials to achieve the sound insulation rating required. Continuous contact sweep seals at top and bottom of panels to minimise sound transfer
Panel Finishes (including but not limited to)	Melamine, Laminate, Wood Veneer, Drywipe, Magnetic Drywipe, factory-applied paint, MDF Primed (ready for decoration by others), Steel facing, pin board and Mirrors. Vision Panels manufactured to customer's requirements can be also be incorporated.
Standard Edge Profiles / Vertical Joints	Semi-concealed edge profiles finished in SAA or powder-coated to any RAL or BS colour. Profiles include hinges and bulb seals for acoustic integrity
Access Doors	Leading element can act as Full-height Pass Door complete with recessed D handle finished in SAA (with optional lock)
Intersection of Multiple Systems	Specification can include walls meeting to form corner junctions or 'T' or 'L' shape systems.



Bottom-rolling Details

Top Guide Track

Bottom-rolling Floor Track

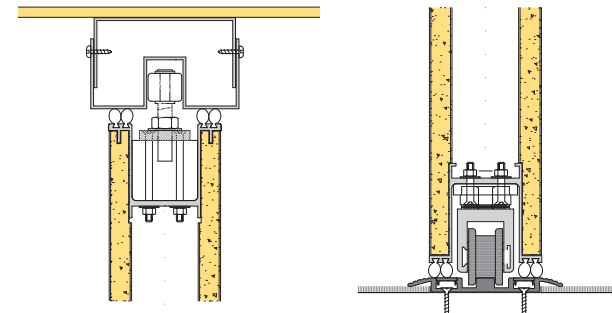

Stacking Options (other options also available)

Figure 1: Single wing - End Folding

Figure 2: Bi-parting - End Folding

Figure 3: Single wing - Centre Folding

Figure 4: Bi-parting - Centre Folding

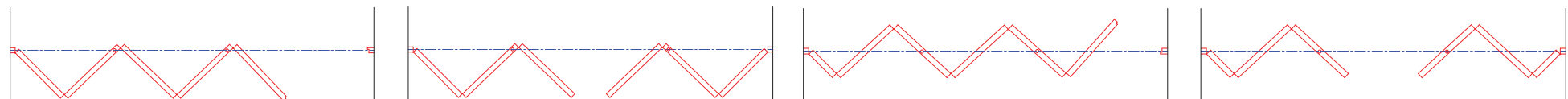

# Series 50

Vinyl Concertina Partitions  
Economical Concertina in heavy-duty, fabric-backed vinyl on a steel pantograph frame

<b>Acoustic Performance</b>	Rw15dB – Rw35dB
<b>Panel Weight</b>	8kg/m <sup>2</sup> - 22 kg/m <sup>2</sup> (dependent upon acoustic rating)
<b>Maximum Opening Width</b>	Unlimited – may contain 'floating' units
<b>Maximum Opening Height</b>	6000mm
<b>Panel Width</b>	n/a – system is a concertina type
<b>Partition Stack Depth</b>	Two options available with stacked depths of either 410mm (Wideline) or 255mm (Slimline)
<b>Fire Rating</b>	n/a but complies with Class 1 or Class 0 Surface Spread of Flame
<b>Head Track System and Configurations</b>	Ceiling track is heavy-duty aluminium 34mm x 34mm finished in SAA as standard. See diagrams
<b>Mechanisms and Ironmongery</b>	The partition is an internal pantograph framework of electro-galvanised 6mm diameter steel rods and steel hinges at 1m centres Easy and smooth to open and close. There are no floor tracks or guides Handle finished in SAA with magnetic latching unit Key-operated locking mechanism available as an option
<b>Jamb Details</b>	Male (45mm) and Female (55mm), finished in SAA as standard
<b>Head Fixing</b>	Installation is to a prepared timber-lined opening (by others)
<b>Construction</b>	Steel pantograph framework (with added infill to attain required acoustic rating)
<b>Finishes</b>	Fabric-backed vinyl covering is durable, light-fast, flame-retardant and rot-proof. It will not crack or craze and water-based inks make it odourless. Washable and stain resistant, resisting the growth of mildew, mould, fungi and bacteria. Bottom sweep seals may be used according to acoustic requirement.
<b>Standard Edge Profiles</b>	Satin Anodised Aluminium (SAA)
<b>Access Doors</b>	A magnetic closure is incorporated in leading edge (optional lock)
<b>Intersection of Multiple Systems</b>	See diagram below

**Stacking Options** (other options also available)

Figure 1: Single wing Partition

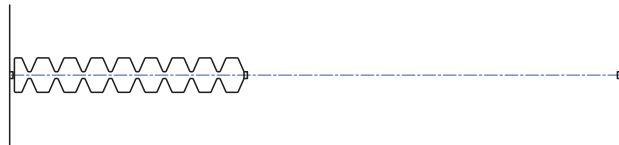

Figure 2: Bi-parting Partition

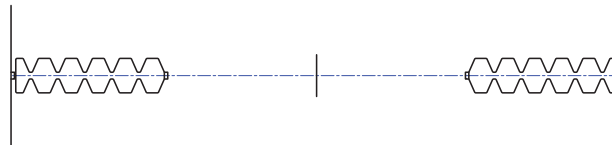

Figure 3: Floating Partition

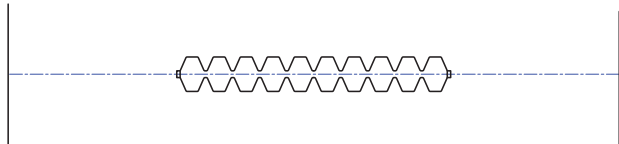
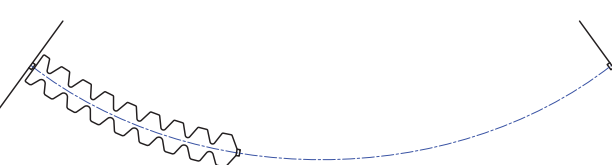
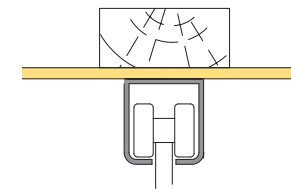

Figure 4: Curved Partition



Head Fixing Details

Exposed Track



Concealed Track

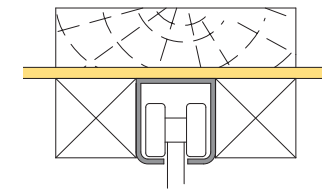
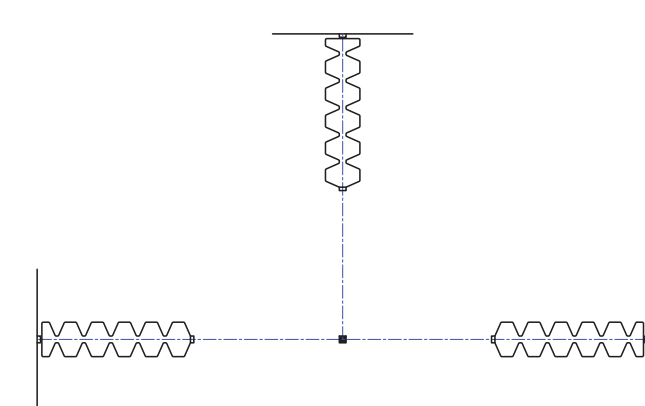

Figure 5: Multi-partition (up to 4 way)



## TECHNICAL SPECIFICATION

# Series 10

**Frameless Sliding Glass Walls**  
A flexible solution comprising frameless panels offering a minimalist work-place environment suffused with light

<b>Acoustic Performance</b>	Non Acoustic
<b>Panel Weight</b>	28 kg/m <sup>2</sup>
<b>Maximum Opening Width</b>	Unlimited
<b>Maximum Panel Height</b>	3600mm
<b>Panel Width</b>	500mm – 1200mm
<b>Panel Thickness</b>	10/12mm toughened safety glass
<b>Fire Rating</b>	n/a
<b>Head Track System and Configurations</b>	Ceiling track is heavy-duty aluminium with integral ceiling support trim, powder-coated as standard to RAL 9010 but can be finished in any RAL colour M1 - Single point Suspension (120mm x 75mm) M2-M6 - Two point Suspension (120mm x 90mm) } See diagrams opposite
<b>Mechanisms and Ironmongery</b>	Panels are secured in position by means of a foot-operated shoot bolt mechanism located into recessed floor sockets
<b>Jamb Details</b>	No requirement, panels are fixed at the head and floor only
<b>Head Fixing and Acoustic Baffling</b>	Head Track is typically suspended from a structural steel I-Beam or concrete soffit with galvanised steel rods at 450mm - 600mm centres (as shown in the Head Track Fixings diagrams). Can also be fitted directly to the soffit
<b>Panel Construction</b>	10mm toughened safety glass with 35mm wide x 100mm high SAA clamping profile to top and bottom See panel perspective diagram opposite.
<b>Panel Finishes</b>	Clear, Frosted, Tinted etc.
<b>Top and Bottom Profiles</b>	Bottom clamping profile incorporates foot pedal mechanism to activate shoot bolt which locates with floor sockets
<b>Access Doors</b>	Pass Doors are available. Can be fitted with optional lock
<b>Intersection of Multiple Systems</b>	Specification can include walls meeting to form 'T' or 'L' shape systems



Head Fixing Details

Steel I-Beam

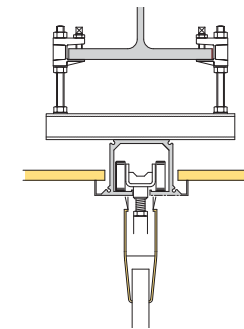

Concrete Soffit

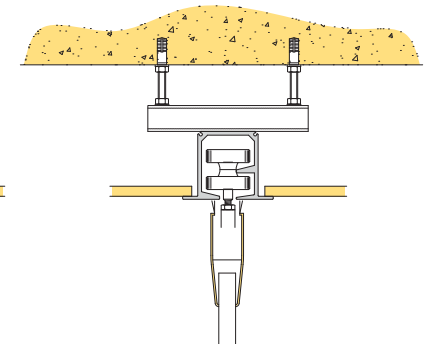

### Stacking Options (other options also available)

M1: Single point Centre Stacking



M2: Two point Offset Stacking



M3: Two point Remote Stacking



M4: Two point Remote Stacking



M5: Two point Remote Stacking (Dual Split)



M6: Two point Remote Stacking (Dual)

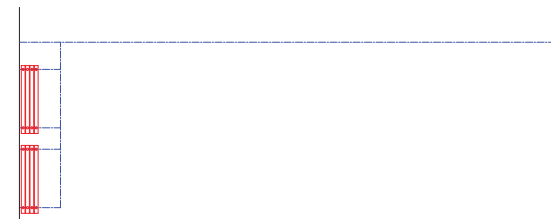

Panel Perspective







INVESTOR IN PEOPLE



028  
5382QMS001



### Service-satisfaction

Once we receive your enquiry you can rest assured that your order will be smoothly processed – one of our dedicated Contract Managers will be assigned to your project.

You can rely on superior back up and after-sales service.

We offer a full 12-month warranty on all products.

MONOWA holds all major contractor and Health & Safety accreditations  
Free site surveys and advice on all aspects of our work.

Log on to our website [www.monowa.co.uk](http://www.monowa.co.uk) Or call our friendly, knowledgeable sales team now on +44 (0) 1923 244258 to discuss your project needs.



**Head Office:** Acorn House, 2 Greenhill Crescent, Watford Business Park, Watford, WD18 8AH **Tel:** +44 (0) 1923 244258 **Fax:** +44 (0) 1923 630726

**Factory:** Goodall Street, Macclesfield, Cheshire SK11 7BD **Tel:** +44 (0) 1625 433666 **Fax:** +44 (0) 1625 433999

**Email:** [sales@monowa.co.uk](mailto:sales@monowa.co.uk)

**Web:** [www.monowa.co.uk](http://www.monowa.co.uk)



Find us on  
Facebook



Follow us on Twitter at:  
[Monowa\\_walls](https://twitter.com/Monowa_walls)