



Hydraulic operator for swing gates

400 Range

The 400 range offers 8 different types of operators designed to swing gates up to 7 metres in length.



Reliable. Affordable. Dependable.

FAAC

...Leading the way.



Excellence in Automation

400 Range

Powerful and Reliable

The 400 range offers 8 different operators, with or without hydraulic locking designed to automate swing gates up to 7 metres. The 455 D control board provides a slowdown feature at the end of the opening and closing cycles to lower noise and prolong the life of the gate system.

Our high strength hydraulic systems ensure that the gates are kept in a closed position. The exclusive hydraulic device ensuring maximum anti-crushing protection, features two highly sensitive by-pass valves. In case of a power failure, a customised release key makes it possible to operate the gate manually.

Quiet Efficiency

The motor unit is contained in a compact hydraulic enbloc housing: all components are oil-bath lubricated and continuously cooled, require very little maintenance, and are low on electrical power consumption.

Reliability is assured under any atmospheric conditions and at extreme temperatures in the range -40°C to + 55°C.

Installation layout

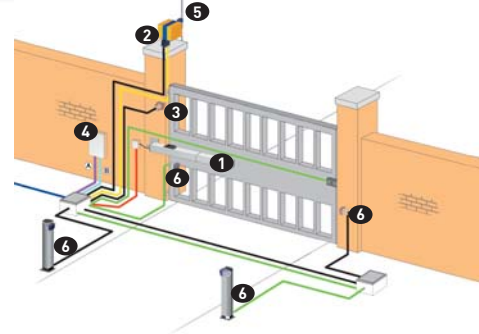

1. Hydraulic operator FAAC 400
2. FAAC LIGHT
3. Access control device
4. 452 MPS OR 455D control board
5. Radio Receiver
6. Photocells or photobeams

Low voltage cabling		Power cabling (230V)	
A	4 cables 3x 0.5	B	1 cable 3x1.5+T
	3 cables 2x 0.5		1 cable 2x1.5+T 1 cable 2x1.5
NB: Cable diameters in mm²			

Dimensions

Operator	Standard mm	Long mm
A. Total Length:	1031	1285
B. Distance between brackets:	700	822
C. Stroke:	260	380

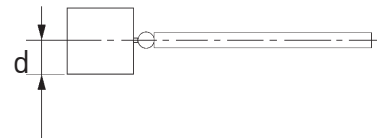
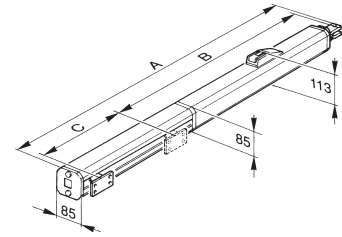

d = 0 - 80mm standard (max)
d = 0 - 150mm long (max)

400 Technical Specifications

Technical Specifications	400 CBC	400 CBA	400 CBAC	400 SB	400 SBS	400 CBACR	400 CBAC LN	400 SB LN
Power supply:	230 Vac (+6% - 10%) 50 (60) Hz							
Electric motor:	220 W							
Absorbed current:	1A							
Motor rotation speed:	1400 RPM							
Rod extension speed:		1 cm/s			0.75cm/s		1.5cm/s	
Pump flow rate:		1 l/min			0.75l/min		1.5l/min	
Traction and thrust force:		620 daN			775 daN		465 daN	
Operating ambient temperature:	120°C							
Protection class:	IP55							
Weight:	8.6kg						10kg	
Oil type:	FAAC HP Oil							
Single leaf max length (m)	2.2	2.2	2.2	4	7	2.2	2.2	2.5
No of leaves:	1							
Use frequency (cycles/hour):	48	48	48	48	36	72	49	49

