

Painting with the EPX-series

The MOTOMAN EPX-series are versatile, high-speed 6 axis robots offering superior performance in painting applications for car bodies, plastic components and work pieces of different sizes.

These robots feature a hollow wrist, which reduces cycle times and offers optimum accessibility.

Furthermore, whilst the working envelope is relatively large, the installation only requires little space.

In a smooth workflow even and smooth surfaces are produced with high speed and unique efficiency.



- *Versatile, fast and flexible*
- *Perfect accessibility*
- *Large working range*
- *Variable payload*
- *Unique efficiency*

MOTOMAN EPX-series

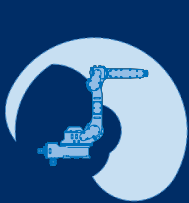

EPX1250

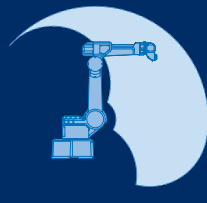

EPX2050

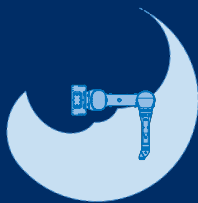

EPX2700

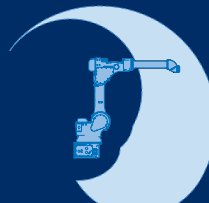

EPX2800

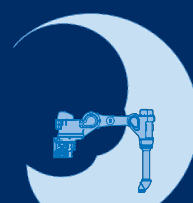

EPX2800R



EPX2900

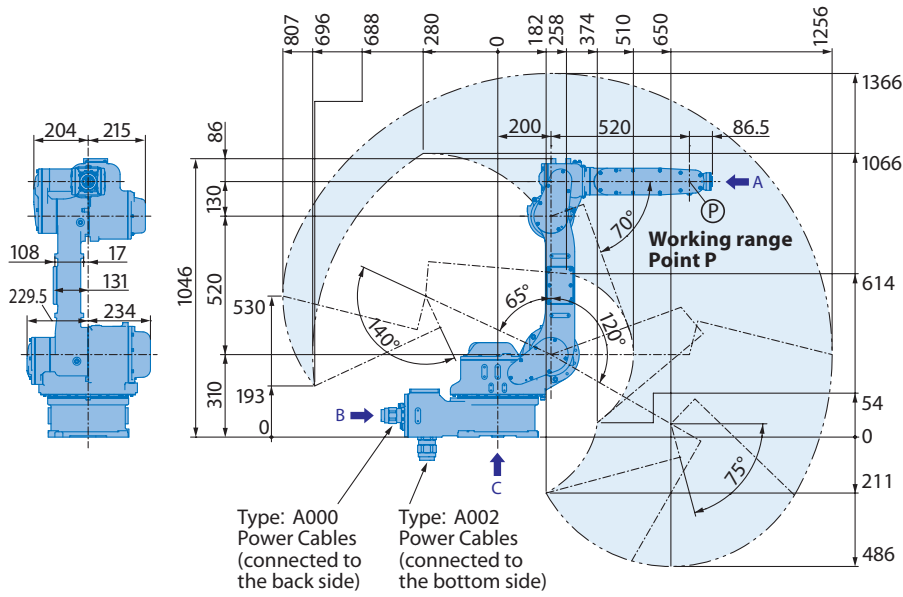

View A

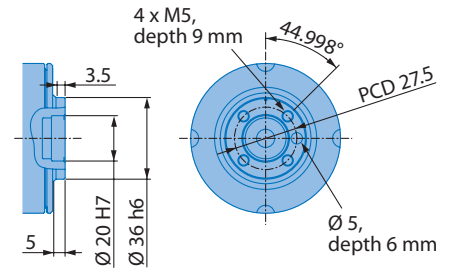

View B

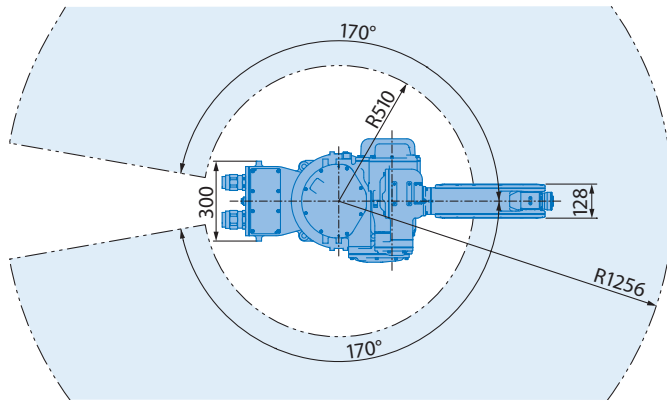
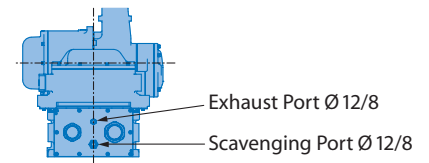

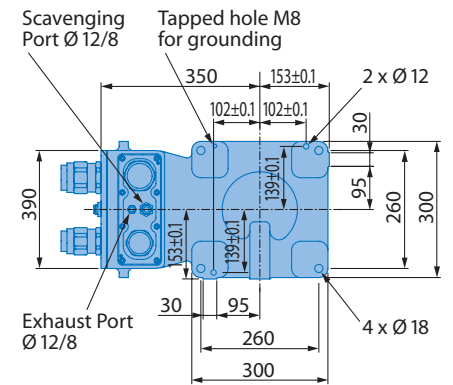

View C



Mounting option: Floor, ceiling, wall

All dimensions in mm | Technical data may be subject to change without previous notice | Please request detailed drawings at robotics@yaskawa.eu.com – B-07-2013, A-No. 156797



Protection level:
 II2G Ex px IIC T4 Gb
 II2D Ex p IIIC T135°C Db IP66

 0408

Specifications EPX1250

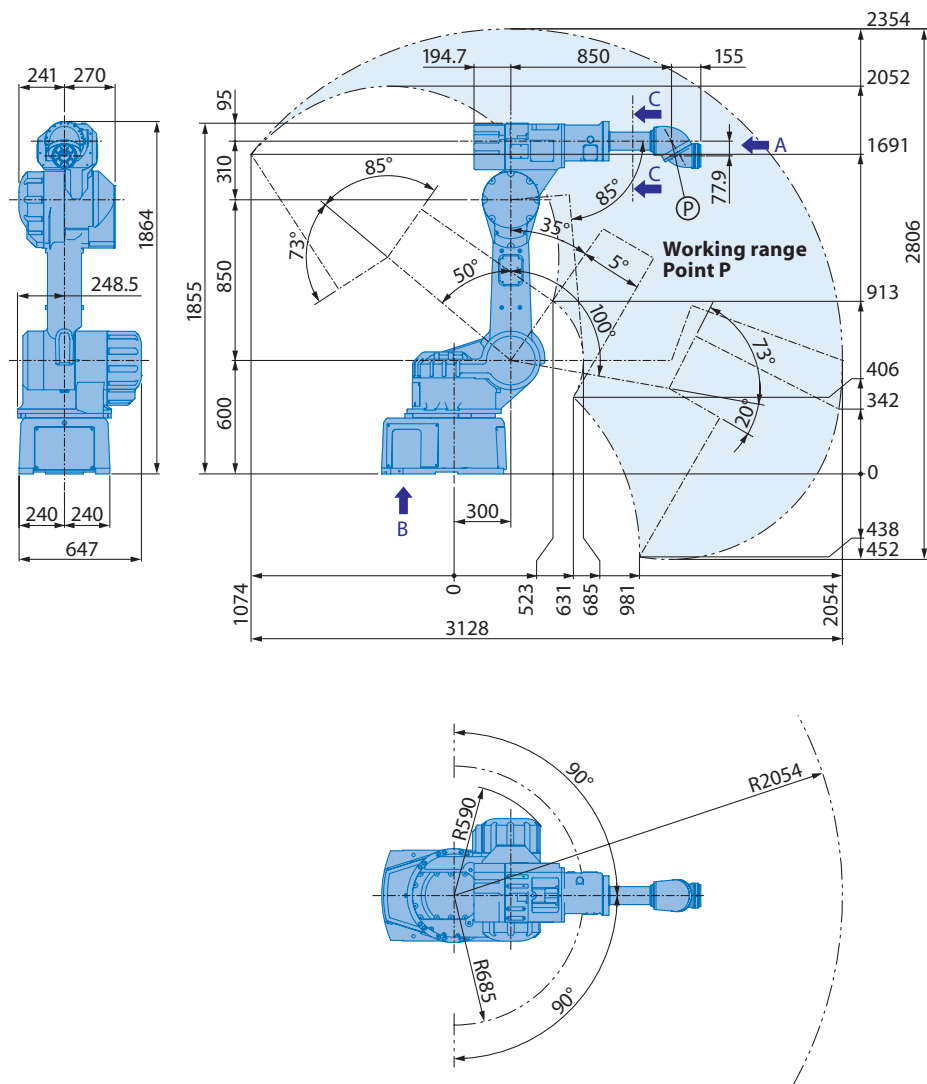
Axes	Maximum motion range [°]	Maximum speed [°/sec.]	Allowable moment [Nm]	Allowable moment of inertia [kg · m ²]	Controlled axes	
S	±170	185	-	-	Max. payload [kg]	6
L	+120/-65	185	-	-	Repeat. pos. accuracy [mm]	5
U	+205/-165	185	-	-	Max. working range [mm]	±0.15
R	±190	360	8	0.20	Temperature [°C]	R = 1256
B	±145	410	8	0.20	Humidity [%]	0 to +40
T	±360	500	3	0.07	Weight [kg]	20 – 80
					Power supply, average [KVA]	110
						1.5

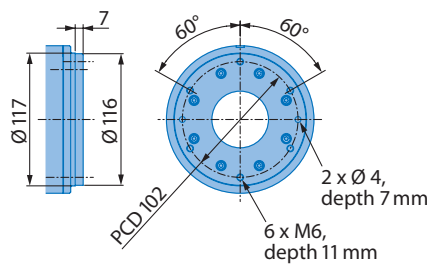

View A



View B

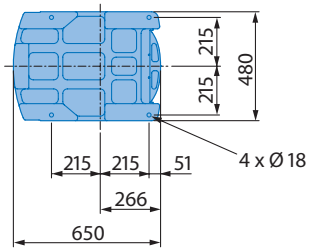

View C

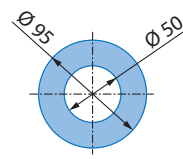

Mounting option: Floor

Protection level:
 Ex II 2G Ex px II T4
 II 2D Ex pD 21 IP66 Tmax 135°C
 CE 0408



All dimensions in mm | Technical data may be subject to change without previous notice | Please request detailed drawings at robotics@yaskawa.eu.com – B-07-2013, A-No. 156797

Specifications EPX2050

Axes	Maximum motion range [°]	Maximum speed [m/sec.]	Allowable moment [Nm]	Allowable moment of inertia [kg · m ²]	Controlled axes	
S	±90	2	-	-	Max. payload [kg]	6
L	+100/-50	is composite speed of all axis	-	-	Repeat. pos. accuracy [mm]	15
U	+5/-163		-	-	Max. working range [mm]	±0.5
R	±360	45.8	1.45	Temperature [°C]	R = 2054	
B	±360	33.8	0.79	Humidity [%]	0 to +45	
T	±360	10.8	0.10	Weight [kg]	20 – 80	
				Power supply, average [KVA]	540	
					5	

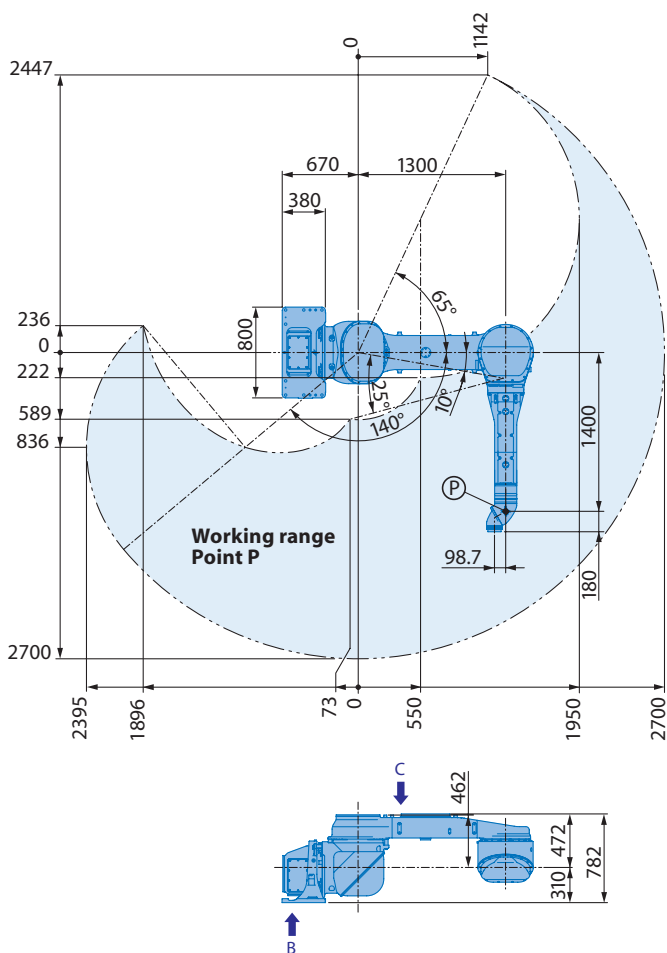

View A

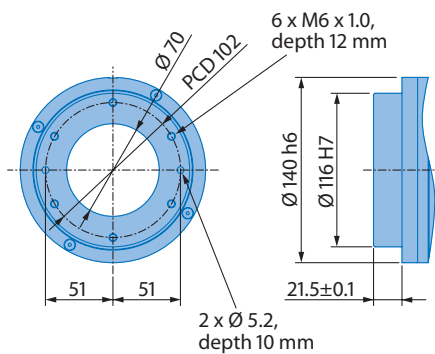

View B

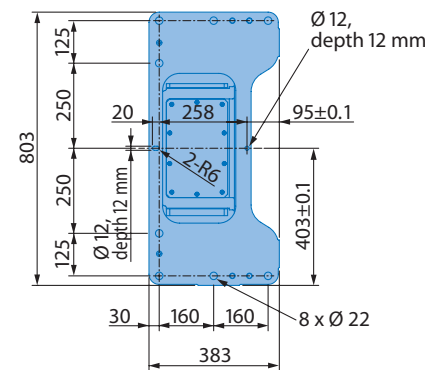

View C

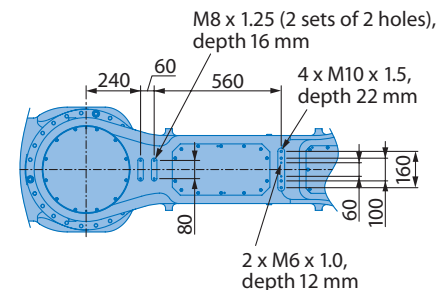

Mounting option: Wall

View D

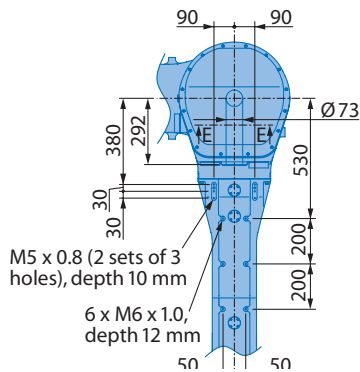

Protection level:

II2G Ex px IIC T4 Gb
II2D Ex p IIIC T135°C Db IP66



0408



All dimensions in mm | Technical data may be subject to change without previous notice | Please request detailed drawings at robotics@yaskawa.eu.com – B-07-2013, A-No. 156797

Specifications EPX2700

Axes	Maximum motion range [°]	Maximum speed [m/sec.]	Allowable moment [Nm]	Allowable moment of inertia [kg · m ²]	Controlled axes	
S	+125/-25	2	-	-	Max. payload [kg]	6
L	+140/-65	is composite speed of all axis	-	-	Repeat. pos. accuracy [mm]	15
U	+90/-65		-	-	Max. working range [mm]	±0.15
R	±720		45.8	1.45	Temperature [°C]	R = 2700
B	±720	33.8	0.79	Humidity [%]		0 to +40
T	±720	10.8	0.10	Weight [kg]		20 – 80
				Power supply, average [KVA]		590
						5

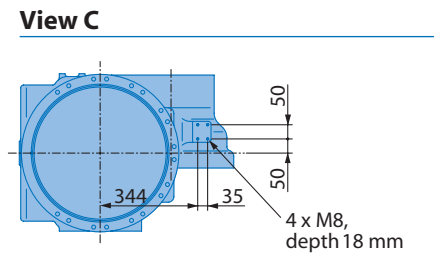
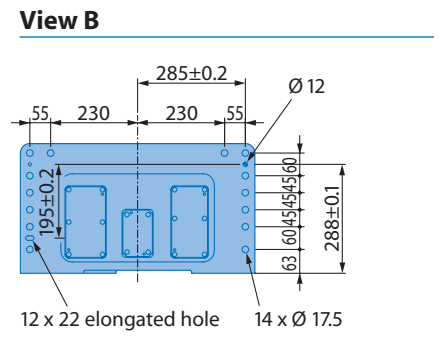
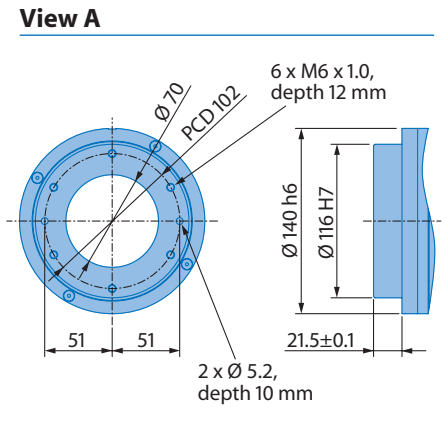
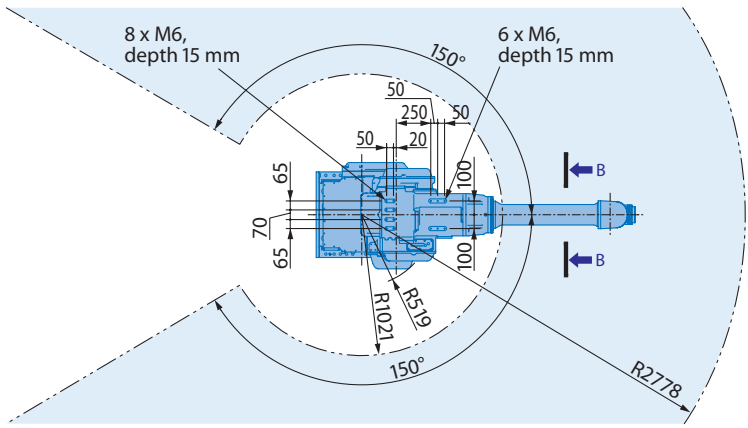
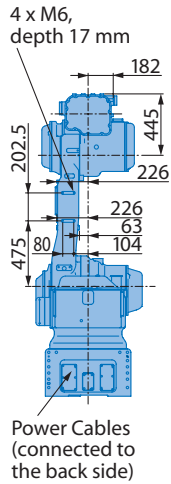
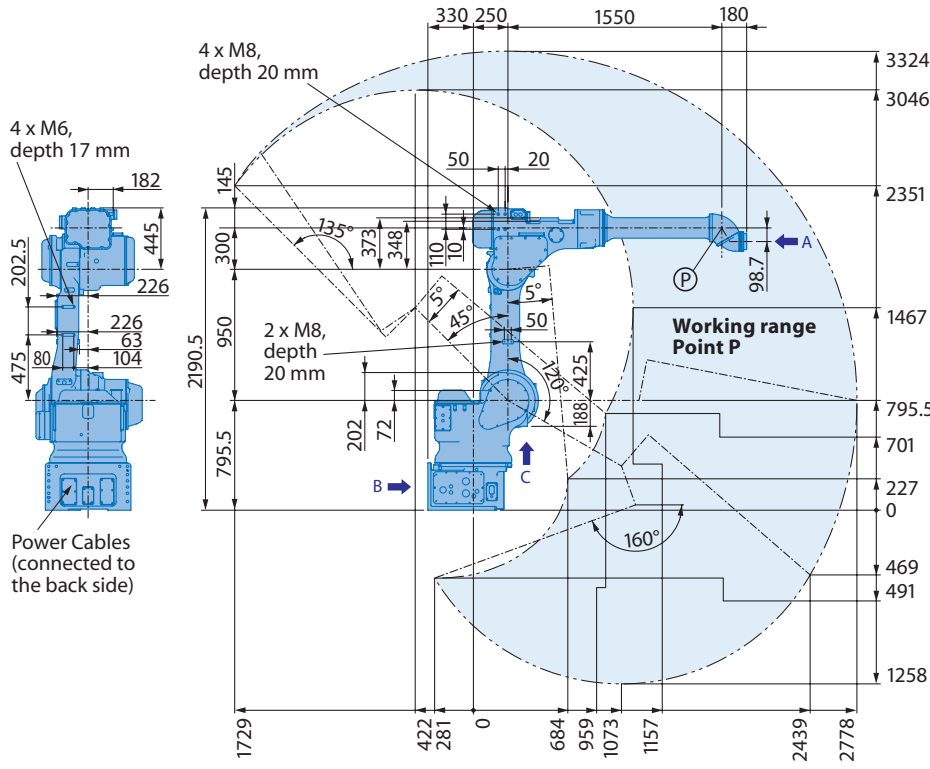

Mounting option: Floor



Protection level:
 Ex II2G Ex px IIC T4 Gb
 II2D Ex p IIIC T135°C Db IP66
 CE
 0408

All dimensions in mm | Technical data may be subject to change without previous notice | Please request detailed drawings at robotics@yaskawa.eu.com – B-07-2013, A-No. 156797

Specifications EPX2800

Axes	Maximum motion range [°]	Maximum speed [m/sec.]	Allowable moment [Nm]	Allowable moment of inertia [kg · m ²]	Controlled axes	
S	±150	2	-	-	Max. payload [kg]	6
L	+120/-45	is composite speed of all axis	-	-	Repeat. pos. accuracy [mm]	20
U	+90/-85		-	-	Max. working range [mm]	±0.5
R	±360		77.4	2.45	Temperature [°C]	R = 2778
B	±360	49.9	1.20	Humidity [%]	0 to +40	
T	±360	16.6	0.20	Weight [kg]	20 – 80	
				Power supply, average [KVA]	650	
					5	

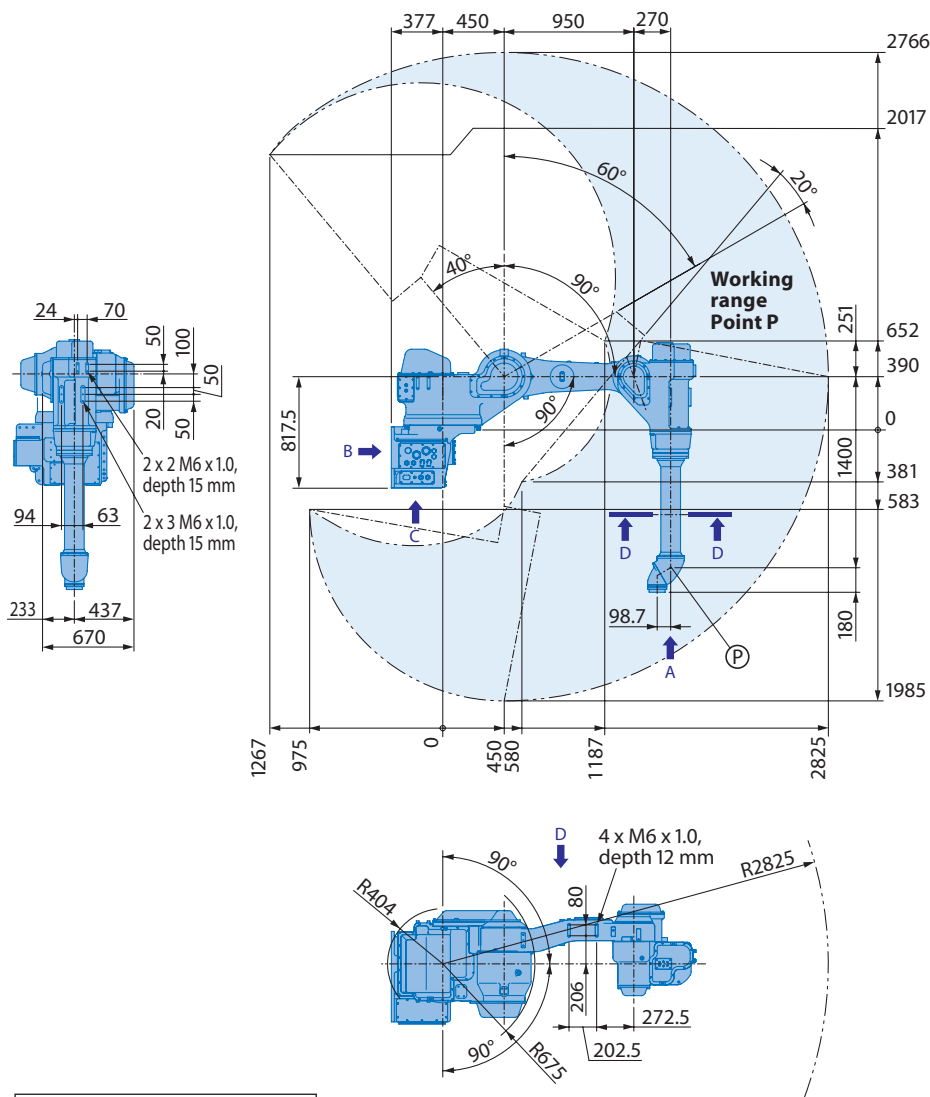

View A

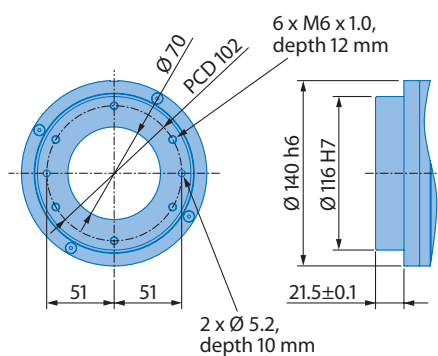

View B

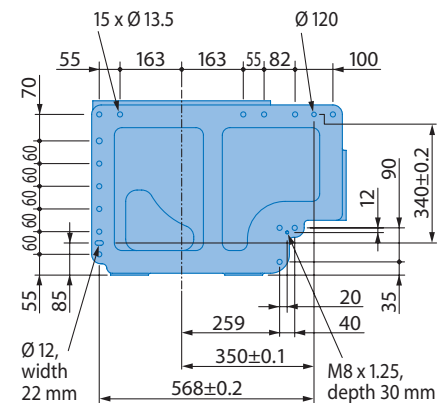

View C

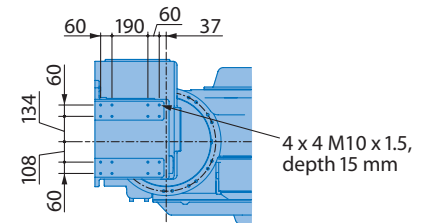

Mounting option: Wall

All dimensions in mm | Technical data may be subject to change without previous notice | Please request detailed drawings at robotics@yaskawa.eu.com - B-07-2013, A-No. 156797

Protection level:
 Ex II2G Ex px II T4
 II2D Ex pD 21 Tmax 135°C
 CE 0408



View D

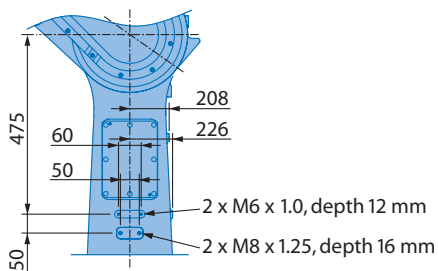

Specifications EPX2800R

Axes	Maximum motion range [°]	Maximum speed [m/sec.]	Allowable moment [Nm]	Allowable moment of inertia [kg · m ²]	Controlled axes	
S	±120	2	-	-	Max. payload [kg]	6
L	+90/-130	is composite speed of all axis	-	-	Repeat. pos. accuracy [mm]	15
U	+90/-70		-	-	Max. working range [mm]	±0.5
R	±360		45.8	1.45	Temperature [°C]	R = 2825
B	±360		33.8	0.79	Humidity [%]	0 to +45
T	±360		10.8	0.10	Weight [kg]	20 - 80
					Power supply, average [KVA]	820
						5

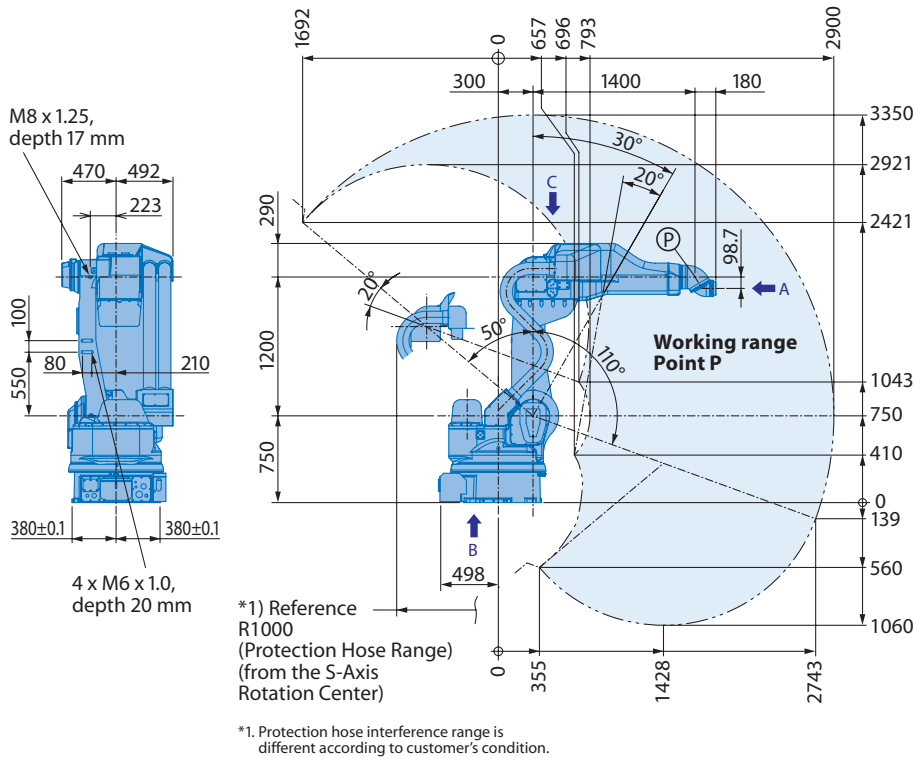

View A

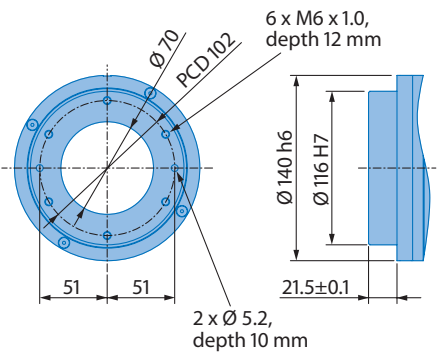

View B

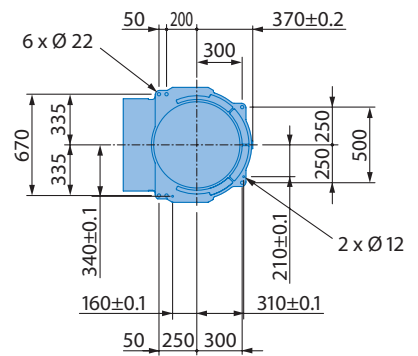

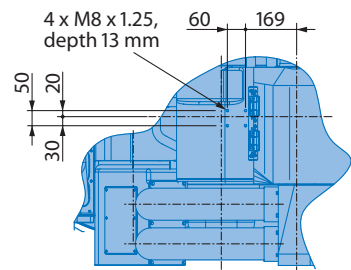

View C

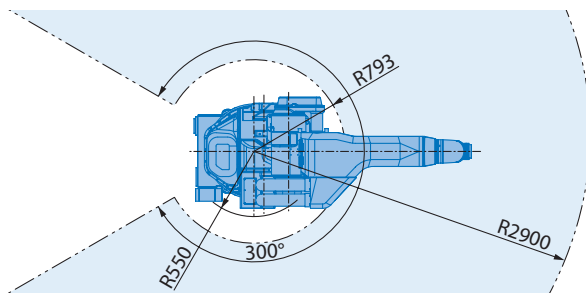

Mounting option: Floor



Protection level:
 II2G Ex px II T4
 II2D Ex pD 21 Tmax 135°C

 0408



All dimensions in mm | Technical data may be subject to change without previous notice | Please request detailed drawings at robotics@yaskawa.eu.com – B-07-2013, A-No. 156797

Specifications EPX2900

Axes	Maximum motion range [°]	Maximum speed [°/sec.]	Allowable moment [Nm]	Allowable moment of inertia [kg · m ²]	Controlled axes	
S	±150	155	-	-	Max. payload [kg]	6
L	+110/-50	125	-	-	Repeat. pos. accuracy [mm]	±0.5
U	+90/-70	155	-	-	Max. working range [mm]	R = 2900
R	±360	450	72.0	-	Temperature [°C]	0 to +45
B	±360	550	51.5	-	Humidity [%]	20 – 80
T	±360	650	19.6	-	Weight [kg]	1030
					Power supply, average [KVA]	5

YASKAWA Headquarters

YASKAWA Europe GmbH
Robotics Division
Yaskawastraße 1
D-85391 Allershausen
Tel. +49 (0) 8166/90-0
Fax +49 (0) 8166/90-103

YASKAWA Academy and sales office Frankfurt

YASKAWA Europe GmbH
Robotics Division
Hauptstraße 185
D-65760 Eschborn
Tel. +49 (0) 6196/77725-0
Fax +49 (0) 6196/77725-39

YASKAWA Group

- A YASKAWA Austria
Schwechat/Wien +43(0)1-707-9324-15
- CZ YASKAWA Czech s.r.o.
Rudná u Prahy +420-257-941-718
- E YASKAWA Ibérica, S.L.
Gavà/Barcelona +34-93-6303478
- F YASKAWA France SARL
Saint-Aignan-de-Grand-Lieu
+33-2-40131919
- FIN YASKAWA Finland Oy
Turku +358-(0)-403000600
- GB YASKAWA UK Ltd.
Banbury +44-1295-272755
- I YASKAWA Italia s.r.l.
Torino +39-011-9005833
- IL YASKAWA Europe Technology Ltd.
Rosh Ha'ayin +972-3-9004114
- NL YASKAWA Benelux B.V.
EB Son +31-40-2895500
- RUS YASKAWA Nordic AB
Moskva +46-480-417-800
- SE YASKAWA Nordic AB
Torsås +46-480-417-800
- SI YASKAWA Slovenia
Ribnica +386-1-8372-410
- TR YASKAWA Türkiye
Şerifali Mah. Barbaros Cad. No: 24
Ümraniye, İstanbul +90-216-5273450
- ZA YASKAWA Southern Africa (PTY) Ltd
Johannesburg +27-11-6083182

Distributors

- BG Kammarton Bulgaria Ltd.
Sofia +359-02-926-6060
- CH Messer Eutectic Castolin Switzerland S.A.
Dällikon +41-44-847-17-17
- DK Robotcenter Danmark
Løsning +45 7022 2477
- EE RKR Seadmed OÜ
Tallinn/Estonia +372-68-35-235
- GR Gizelis Robotics
Nea Kifissia +30-2106251455
- H Flexman Robotics Kft
Budapest +36-30-9510065
- LT Profibus UAB
Panevezys +370-45-518575
- N Optimove as
Lierstranda +47-32240600
- PL Integrator RHC Sp. z o.o.
Torun +48-56-6519710
- RO Sam Robotics srl
Timisoara +40-720-279-866



www.yaskawa.eu.com
robotics@yaskawa.eu.com

Technical data may be subject to change without previous notice.