

Marine Electrical Installations Ltd



[www.M-E-I.co.uk](http://www.M-E-I.co.uk)

## Marine and Offshore Electrical Services



Simple Selection  
of Essential  
Electrical Equipment

**SUMMER 2011**



2001 - 2011

**Flame Retardant Unarmoured**
**657TQ shipwiring cable to BS6883**

Part No	Cores	Conductor Size	Colour/reference	OD
ME-16245	1	6.0sqmm (class2)	Green/yellow	7.5mm
ME-10254	1	16sqmm (class2)	Green/yellow	10.1mm
ME-10187	2	1.5sqmm (class2)	Black	8.6mm
ME-10083	2	2.5sqmm (class2)	Black	9.8mm
ME-10063	3	1.5sqmm (class2)	Black	9.3mm
ME-10006	3	2.5sqmm (class2)	Black	10.4mm
ME-10126	3	4.0sqmm (class2)	Black	12.7mm
ME-10008	3	6.0sqmm (class2)	Black	13.9mm
ME-10160	3	10sqmm (class2)	Black	17.2mm
ME-10007	3	16sqmm (class2)	Black	19.5mm

**Conductors:** Tinned annealed stranded copper  
**Insulation:** EPR (Ethylene Propylene Rubber)  
**Conductor identification:** White cores with black numbers  
**Sheath/Jacket:** Low Smoke Zero Halogen (ZHAL),  
**Type:** SW4 **Voltage:** 600/1000v  
**Operating temperature:** Maximum 85°C, minimum bending -25°C

**Standards:**  
**BS6883:** Shipboard cable,  
**Application:** Fixed wiring in ships and on mobile and fixed offshore units

**Fire Resistant Unarmoured**
**657MG-TQ shipwiring cable to BS6883, BS7917, IEC60332 and IEC60331**

Part No	Cores	Conductor Size	Colour/reference	OD
ME-10084	2	1.5sqmm (class2)	Black	10.1mm
ME-10112	2	2.5sqmm (class2)	Black	10.9mm
ME-10100	3	1.5sqmm (class2)	Black	10.8mm
ME-10315	3	2.5sqmm (class2)	Black	11.6mm
ME-10015	3	6.0sqmm (class2)	Black	14.7mm
ME-10017	3	10sqmm (class2)	Black	16.7mm
ME-10021	3	16sqmm (class2)	Black	19.2mm

**Conductors:** Tinned annealed stranded copper  
**Insulation:** MGT (Mica Glass Tape) with EPR (Ethylene Propylene Rubber), white insulation with black numbers **Sheath/Jacket:** Low Smoke Zero Halogen (ZHAL),  
**Type:** SW4 **Colour:** Black **Voltage:** 600/1000v  
**Operating temperature:** Maximum 85°C, minimum bending -25°C

**Standards:**  
**BS7917:** fire resistant shipboard cable, **IEC60332-3-22:** flame retardancy, **IEC60754-1 and 2:** corrosivity, **IEC61034-2:** smoke density, **NEK 606:** oil & mud resistancy  
**Application:** for fixed installations in all areas and on open deck in ships and offshore units

**Flame Retardant Armoured**
**658TQ shipwiring cable to BS6883**

Part No	Cores	Conductor Size	Colour/reference	OD
ME-67343	2	1.5sqmm (class2)	Black	12.7mm
ME-67061	2	2.5sqmm (class2)	Black	13.9mm
ME-67401	3	1.5sqmm (class2)	Black	13.4mm
ME-67575	3	2.5sqmm (class2)	Black	14.7mm
ME-67576	3	4.0sqmm (class2)	Black	17.0mm
ME-67612	3	6.0sqmm (class2)	Black	18.4mm
ME-67605	3	10sqmm (class2)	Black	22.1mm
ME-67134	3	16sqmm (class2)	Black	24.6mm

**Conductors:** Tinned annealed stranded copper  
**Insulation:** EPR (Ethylene Propylene Rubber)  
**Conductor identification:** White cores with black numbers  
**Armour:** GSWB (Galvanized steel wire braid)  
**Sheath/Jacket:** Low Smoke Zero Halogen (ZHAL),  
**Type:** SW4 **Colour:** Black **Voltage:** 600/1000v  
**Operating temperature:** Maximum 85°C, minimum bending -25°C

**Standards:**  
**BS6883:** Shipboard cable **BSEN60228:2005 (previously BS6360):** Specification for electrical conductors in insulated cable, **BS7655-1.2 & BS7655-2.6:** specifications for cable insulation  
**Application:** For fixed installations in all areas and on open deck in ships and offshore units

**Fire Resistant Armoured**
**658MGTQ shipwiring cable to BS7917 and BS6883**

Part No	Cores	Conductor Size	Colour/reference	OD
ME-67629	2	1.5sqmm	Black	14.6mm
ME-67146	2	2.5sqmm	Black	15.4mm
ME-67400	3	1.5sqmm	Black	15.2mm
ME-67625	3	2.5sqmm	Black	16.3mm
ME-67626	3	4.0sqmm	Black UKOOA YD304	18.5mm
ME-67632	3	6.0sqmm	Black UKOOA YD306	19.6mm
ME-67624	3	10sqmm	Black UKOOA YD310	22.1mm
ME-67053	3	16sqmm	Black UKOOA YD316	24.7mm

**Conductors:** Tinned annealed stranded copper  
**Insulation:** IMGT (Mica Glass Tape) with EPR (Ethylene Propylene Rubber), white insulation with black numbers  
**Armour:** GSWB (Galvanized steel wire braid)  
**Sheath/Jacket:** Low Smoke Zero Halogen (ZHAL),  
**Type:** SW4 **Voltage:** 600/1000v **Colour:** Black  
**Operating temperature:** Maximum 85°C, minimum bending -25°C

**Standards:**  
**BS6883:** shipboard cable, **BS7917:** fire resistant shipboard cable, **IEC60332-3-22:** flame retardancy, **IEC60754-1 and 2:** corrosivity, **IEC61034-2:** smoke density, **NEK 606:** oil & mud resistancy

Other types and sizes available on request

**Contact us for best price: sales@m-e-i.co.uk / +44 (0) 141 776 2020**



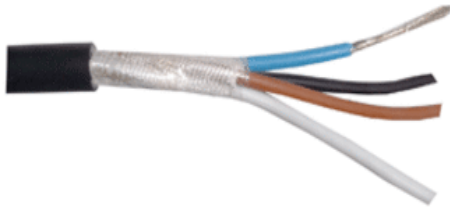

**Flame Retardant Unarmoured**

## XI marine power and control shipwiring cable

**Conductors:** Plain flexible compacted stranded Copper  
**Insulation:** XLPE (Crossed linked polyethylene)

**Core identification:** Single core black, 2 core black & Light blue, 3 core black, light blue & brown, 4 core black, light blue, brown & white, 5 core and above, white cores with black numbers. Earthing core (Green/Yellow) available in request

**Bedding:** 'FLAME-BAR' (Halogen free)

**Sheath/Jacket:** LSZH (Low smoke, zero halogen)

**Colour:** Black **Voltage:** 600/1000v

**Operating temperature:** Maximum 100°C, minimum bending -40°C

**Standards:**

**IEC60092-353:** power cables for electrical installation in ships **Ref:** XI cable

**Type approvals:** ABS, DNV, Bureau Veritas, Germanischer Lloyd, Lloyds Register, RINA, & Russian Maritime Register of Shipping



Part No	Cores	Conductor Size	Colour/reference	OD
ME-I4000	2	1.5sqmm (class2)	Black	8.2mm
ME-I4001	2	2.5sqmm (class2)	Black	9.0mm
ME-I4004	3	1.5sqmm (class2)	Black	8.7mm
ME-I4005	3	2.5sqmm (class2)	Black	9.6mm
ME-I4006	3	4.0sqmm (class2)	Black	11.2mm
ME-I4034	3	6.0sqmm (class2)	Black	12.4mm
ME-I4035	3	10sqmm (class2)	Black	14.6mm

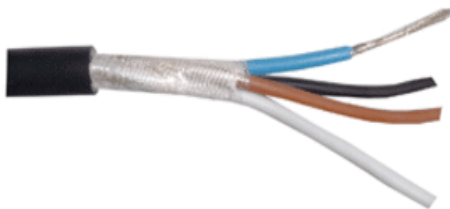

**Fire Resistant Unarmoured**

## XI 331 fire resistant power shipwiring cable to IEC60092-353 and IEC60331

**Conductor:** Plain flexible compacted copper IEC60228 Class 2

**Insulation:** mica tape plus XLPE compound insulated

**Bedding:** halogen free FLAMEBAR ® bedding

**Sheath:** halogen free LSZH sheath

**Design and Construction:** IEC60092-353

**Nominal Voltage Uo/U:** 0,6/1 kV **Maximum Voltage Umax:** 1,2 kV

**Flame Retardancy:** IEC 60332-1 IEC 60332-3 Cat A

**Fire Resistancy:** IEC 60331 **Corrosivity:** IEC 60754-1 IEC 60754-2

**Smoke Density:** IEC 61034-2

**Toxicity and Smoke Density:** IMO RESOLUTION MSC 41(64) and ATS 1000.001 tech. spec.

Cold bend and impact test (-40oC) CSA C22.2 No 38-95

**Cores Identification:** 1 core black, 2 core black & light blue

3 core black, brown & light blue, 4 core black, blue, brown & white, 5 core white and numbered. Earthing core (on request) green/yellow

**Sheath Colour:** Black **Ref:** XI 331 cable

**Operating temperature:** Maximum 100°C, minimum bending -40°C

**Standards:** IEC60092-353: power cables for electrical installation in ships

**Type approvals:** ABS, Bureau Veritas, DNV, Lloyd's Register & Russian Maritime Register of Shipping



Part No	Cores	Conductor Size	Colour/reference	OD
ME-I4162	2	1.5sqmm	Black	9.0mm
ME-I4130	2	2.5sqmm	Black	10.0mm
ME-I4116	3	1.5sqmm	Black	9.5mm
ME-I4115	3	2.5sqmm	Black	10.6mm
ME-I4186	3	16sqmm	Black	18.7mm



**Flame Retardant Armoured**

## XAI armoured power and control shipwiring cable to IEC60092-353

**Conductors:** Plain flexible compacted stranded copper

**Insulation:** XLPE (Crossed linked polyethylene)

**Core identification:** Single core black, 2 core black & Light blue, 3 core black, light blue & brown, 4 core black, light blue, brown & white, 5 core and above, white cores with black numbers. Earthing core (Green/Yellow) available in request

**Bedding:** 'FLAME-BAR' (Halogen free)

**Screen:** PCWB (Plain copper wire braid)

**Sheath/Jacket:** LSZH (Low smoke, zero halogen)

**Colour:** Black **Voltage:** 600/1000v

**Operating temperature:** Maximum 100°C, minimum bending -40°C

**Standards:**

**IEC60092-353:** power cables for electrical installation in ships,

**IEC60228:** electrical conductors of insulated cable,

**IEC60332:** flame retardancy, **IEC60754:** halogen free properties,

**IEC61034:** smoke density **Ref:** XAI cable

**Type Approvals:** ABS, Bureau Veritas, DNV, Germanischer Lloyd, Lloyd's Register, RINA & Russian Maritime Register of Shipping



Part No	Cores	Conductor Size	Colour/reference	OD
ME-I4011	2	1.5sqmm (class2)	Black	9.1mm
ME-I4012	2	2.5sqmm (class2)	Black	10.0mm
ME-I4014	3	1.5sqmm (class2)	Black	9.6mm
ME-I4015	3	2.5sqmm (class2)	Black	10.5mm
ME-I4016	3	4.0sqmm (class2)	Black	12.1mm
ME-I4017	3	6.0sqmm (class2)	Black	13.3mm
ME-I4018	3	10sqmm (class2)	Black	15.9mm
ME-I4019	3	16sqmm (class2)	Black	18.7mm

Other types and sizes available on request



**Fire Resistant Armoured**

## XAI 331 armoured fire resistant power shipwiring cable to IEC60092-353 and IEC60331

**Conductor:** plain flexible compacted copper IEC60228 Class 2 conductors

**Insulation:** mica tape plus XLPE based compound insulation

**Armour:** plain copper wire braid **Sheath:** Halogen free LSZH sheath.

**Design and Construction:** IEC60092-353

**Nominal Voltage U<sub>0</sub>/U:** 0,6/1 kV **Maximum Voltage U<sub>max</sub>:** 1,2 kV

**Flame Retardancy:** IEC 60332-1 IEC 60332-3 Cat A

**Fire Resistancy:** IEC 60331 **Corrosivity:** IEC 60754-1 IEC 60754-2

**Smoke Density:** IEC 61034-2

Toxicity and Smoke Density: IMO RESOLUTION MSC 41 (64) and ATS 1000.001 tech. spec. Cold bend and impact test (-40°C) CSA C22.2 No 38-95 **Cores Identification:** 1 core black, 2 core black & light blue

3 core black, brown & light blue, 4 core black, blue, brown & white, 5 core white and numbered Earthing core (on request) green/yellow

**Sheath Colour:** Black

**Type approvals:** ABS, Bureau Veritas, DNV, Lloyd's Register & Russian Maritime Register of Shipping



Part No	Cores	Conductor Size	Colour/reference	OD
ME-14064	2	1.5sqmm	Black	9.9mm
ME-14078	2	2.5sqmm	Black	11.2mm
ME-14065	3	1.5sqmm	Black	10.5mm
ME-14092	3	2.5sqmm	Black	11.8mm
ME-14113	3	4.0sqmm	Black	13.2mm
ME-14093	3	6.0sqmm	Black	15.1mm
ME-14063	3	10sqmm	Black	17.4mm
ME-14111	3	16sqmm	Black	20.2mm



**Flame Retardant Armoured**

## RFOU instrumentation cable, mud resistant to NEK606

**Conductors:** Tinned annealed stranded copper

**Core identification:** Single core: off-white 2 core: off-white & black, 3 core: off-white, black & red, 4 core: off-white, black, red & blue.

**Insulation:** Halogen free EPR (Ethylene Propylene Rubber),

**Screen:** TCWB (Tinned copper wire braid)

**Sheath/Jacket:** Type: SHF, thermoset dual compound, halogen free and mud resistant

**Sheath colours:** Black **Voltage:** 600/1000v

**Operating temperature:** Maximum 85°C, minimum bending -40°C

**Standards:**

**IEC60092-353:** electrical installation in ships, power cables, **NEK606:**

cables for offshore installation halogen-free or mud-resistant,

**IEC60092.375** shipboard telecommunications cable, **IEC60331:** fire

resistant, **IEC60332:** flame retardant, **IEC61031-1.2:** smoke density,

**IEC60754-1:** halogen free properties, **IEC60228:** electrical conductor

**Applications:** Mud resistant cable for control, lighting and power systems

**Type Approvals:** ABS, DNV & Lloyd's Register of Shipping



Part No	Cores	Conductor Size	Colour/reference	OD
ME-67914	2	1.5sqmm (class2)	Black	14.4mm
ME-67202	2	2.5sqmm (class2)	Black	15.5mm
ME-67080	3	1.5sqmm (class2)	Black	15.0mm
ME-67092	3	2.5sqmm (class2)	Black	16.1mm
ME-67101	3	4.0sqmm (class2)	Black	17.8mm
ME-67107	3	6.0sqmm (class2)	Black	19.1mm
ME-67117	3	10sqmm (class2)	Black	21.1mm
ME-67811	3	16sqmm (class2)	Black	23.6mm



**Fire Resistant Armoured**

## BFOU power cable, mud resistant to NEK606

**Conductors:** Tinned annealed stranded copper

**Core identification:** Single core: off-white 2 core: off-white & black, 3 core: off-white, black & red, 4 core: off-white, black, red & blue.

**Insulation:** MGT (Mica glass tape), halogen free EPR (Ethylene Propylene Rubber),

**Screen:** TCWB (Tinned copper wire braid)

**Sheath/Jacket:** Type: SHF, thermoset dual compound, halogen free and mud resistant

**Sheath colours:** Black & Grey **Voltage:** 600/1000v

**Operating temperature:** Maximum 85°C, minimum bending -40°C

**Standards:**

**IEC60092-353:** electrical installation in ships, power cables,

**NEK606:** cables for offshore installation halogen-free or mud-resistant,

**IEC60092.375** shipboard telecommunications cable,

**IEC60331:** fire resistant,

**IEC60332:** flame retardant,

**IEC61031-1.2:** smoke density,

**IEC60754-1,** halogen free properties,

**IEC60228:** electrical conductor

**Applications:** Mud resistant cables suitable for control, lighting and power systems

**Type Approvals:** ABS, DNV & Lloyd's Register of Shipping



Part No	Cores	Conductor Size	Colour/reference	OD
ME-67751	2	2.5sqmm (class2)	Black	16.5mm
ME-67236	3	1.5sqmm (class2)	Black	16.1mm
ME-67220	3	2.5sqmm (class2)	Black	17.2mm
ME-67444	3	4.0sqmm (class2)	Black	19.0mm
ME-67422	3	6.0sqmm (class2)	Black	20.7mm
ME-67672	3	10sqmm (class2)	Black	22.6mm
ME-67838	3	16sqmm (class2)	Black	25.5mm

Other types and sizes available on request

Contact us for best price: sales@m-e-i.co.uk / +44 (0) 141 776 2020

## 3753 FCF FEP control cable with overall copper screen and GL type approval

SKSES · D-VIERSEN · 37530715 7 x 1,5 mm<sup>2</sup> 04/10 C

### Construction:

Conductor: tinned copper strands acc. to IEC 60228, EN 60228, VDE 0295, class 5  
 Insulation: FEP  
 Colour code: black cores with consecutive numbers acc. to EN 50334  
 Stranding: in layers  
 Inner sheath: FEP  
 Screen: tinned copper braiding  
 Sheath material: FEP  
 Sheath colour: black (RAL 9005)

Part No	no. of cores x cross section n x mm <sup>2</sup>	outer- $\phi$ $\pm$ 0,3 mm mm	copper figure kg/km	cable weight $\approx$ kg/km
ME-37530207	2 x 0,75	5,6	32,1	59
ME-37530307	3 x 0,75	5,8	39,3	68
ME-37530507	5 x 0,75	6,9	59,6	101
ME-37530707	7 x 0,75	7,5	74,2	124
ME-37531207	12 x 0,75	10,0	134,3	209
ME-37531607	16 x 0,75	11,2	169,8	269
ME-37530215	2 x 1,50	6,4	48,6	84
ME-37530315	3 x 1,50	6,7	64,6	97
ME-37530515	5 x 1,50	8,0	98,2	146
ME-37530715	7 x 1,50	8,8	129,9	185

### Technical data:

Nominal voltage: U<sub>0</sub>/U 300/500 V  
 Testing voltage: 2000 V (AC)  
 Min. bending radius  
 fixed laying: 5 x d  
 flexible application: 7,5 x d  
 Radiation resistance: 1 x 107cJ/kg  
 Temperature range:  
 fixed laying: -100/+180 °C  
 flexible application: -55/+180 °C  
 Fire performance: flame retardant and self-extinguishing acc. to IEC 60332-1-2 + EN 60332-1-2 Oil the outer sheath has a good oil and diesel resistance  
 resistance:  
 Absence of harmful substances: acc. to RoHS-guideline 2002/95/EG as well as GefStoffV appendix IV-no. 24, see page N/14

### Outstanding features:

- flame retardant
- oil resistant
- good chemical resistant
- GL approval



## 6753 C FRNC halogen-free control cable with overall copper screen and DNV type approval

IEC 60032-376 150/250V (300V) IEC60332-3 A+C C 0

### Construction:

Conductor: tinned copper strands acc. to IEC 60228, EN 60228, VDE 0295, class 5  
 Insulation: special A  
 Colour code: black cores with consecutive numbers  
 Stranding: in layers  
 Wrapping: PETP foil  
 Screen: tinned copper braiding  
 Sheath material: special A  
 Sheath colour: black (RAL 9005)

Part No	no. of cores x cross section n x mm <sup>2</sup>	outer- $\phi$ $\pm$ 0,3 mm mm	copper figure kg/km	cable weight $\approx$ kg/km
ME-67530205	2 x 0,50	6,7	27,2	60
ME-67530207	2 x 0,75	7,3	34,0	70
ME-67530307	3 x 0,75	7,7	42,9	83
ME-67530507	5 x 0,75	9,1	62,2	122
ME-67530707	7 x 0,75	10,1	79,4	154
ME-67531207	12 x 0,75	13,5	146,	262
ME-67531607	16 x 0,75	15,2	212,	357
ME-67532007	20 x 0,75	16,8	242,4	429
ME-67530215	2 x 1,50	8,5	52,6	103
ME-67530315	3 x 1,50	9,1	69,4	119
ME-67530515	5 x 1,50	11,2	119,7	204
ME-67530715	7 x 1,50	12,3	155,1	256
ME-67530225	2 x 2,50	9,5	74,3	134

Marking for S6753 C FRNC 67532015:300V SAB BRÖCKSKES · D-VIERSEN · 67532015 90°C 20 x 1,5 mm<sup>2</sup>SABIX 6753 C FRNC IEC 60092-376 150/250V (300V) IEC60332-3 A+C C

### Technical data:

Nominal voltage: U<sub>0</sub>/U 150/250 V  
 Testing voltage U: conductor/conductor 3500 V (AC)  
 conductor/screen 1500V (AC)  
 Min. bending radius  
 fixed laying: 6 x d  
 during the installation: 9 x d  
 Radiation resistance: 2 x 108cJ/kg  
 Temperature range  
 fixed laying: -40/+110 °C  
 flexible application: -30/+110 °C  
 Halogen-free: acc. to DIN VDE 0472 part 815 and IEC 60754-1  
 Fire performance: no flame propagation acc. to IEC 60332 + EN 50266 cat. C resp. D.  
 Flame retardant and self-extinguishing acc. to IEC 60332-1-2 + EN 60332-1-2  
 Corrosiveness of conflagration gases: in compliance with IEC 60754-2 and EN 50267-2-2 + VDE 0482 part 267-2-2 - no development of corrosive conflagration gases  
 Smoke density: acc. to IEC 61034 + EN 61034  
 Absence of harmful substances: acc. to RoHS-guideline 2002/95/EG as well as GefStoffV appendix IV-no. 24, see page N/14

### Outstanding features:

- flame retardant
- halogen-free
- DNV approval



Other types and sizes available on request

Contact us for best price: sales@m-e-i.co.uk / +44 (0) 141 776 2020



## Black Standard Nylon Cable Ties

- Internal serrations for positive locking
- Head design guarantees high tensile strength and low insertion force
- UL Approved Nylon 66, 94V-2



Part No	Size (mm)	Pack Qty	Price	Part No	Size (mm)	Pack Qty	Price
ME-AM16	160 x 2.5	100	£1.36	ME-AH30	300 x 7.6	100	£8.46
ME-AM20	200 x 2.5	100	£1.60	ME-AH37	370 x 7.6	100	£9.14
ME-AN30	300 x 4.8	100	£2.96	ME-AE43	430 x 9.0	100	£13.92
ME-AN37	370 x 4.8	100	£3.86	ME-AE53	530 x 9.0	100	£16.88

## 316 Stainless Steel Cable Ties

- High quality stainless cable tie developed for highly corrosive applications
- Roller ball 316 grade Cable Ties can be used in applications of extreme temperature and hostile environments



Part No	Size (mm)	Pack Qty	Price
ME-A4STN30	300 x 4.5mm	100	£22.80
ME-A4STN37	370 x 4.5mm	100	£35.33
ME-A4STH30	300 x 7.9mm	100	£38.40
ME-A4STH37	370 x 7.9mm	100	£42.02

## LFPC Protective Profiles For Stainless Steel Cable Ties

- Recommended where the tightening is such that the cable insulation may be damaged by the tie
- Self-extinguishing
  - LFPC zero halogen channel



Part No	Width (mm)	Thickness (mm)	Reel Length (M)	Price
ME-LFPC70BK	7 (For Use With 4.5mm SS Ties)	1.1	25	£36.41
ME-LFPC103BK	10 (For Use With 7.9mm SS Ties)	1.1	25	£46.61

## Stainless Steel Cable Tie Tension Tool

- Automatic Stainless Steel Cable Tie Tensioning and cutting tool
- Will tension and cut Stainless Steel Cable Ties up to 7.9mm width
- Adjustable tension indicator



Part No	Price Each
ME-TGM5	£62.44

## Flexible Condit Pack

**FPAS** Black Nylon  
IP 66

### Construction

Standard weight, flame retardant nylon (PA6) corrugated flexible conduit

**Typical Applications:** All types of machinery

**Containing 10mtrs conduit + 10 connectors**



Part No	Outside Dia	Inside Dia	Price Per Pack
ME-CP21B	M20 21.2mm	16.7mm	£27.05
ME-CP25B	M25 25.0mm	19.1mm	£34.96

## Tri-Rated Panel Wiring



Approval - CSA, UL B BS6231  
**Supplied in 100mtr Reels**

Single core, flexible plain annealed copper wires, heat resistant PVC insulation. Maximum working temperature 105°C.

Conductor				Conductor					
Part No	Cores	Size	OD	Price	Part No	Cores	Size	OD	Price
ME-TR0.5	1	0.5mm	2.7mm	£8.64	ME-TR4.0	1	4.0mm	4.4mm	£43.76
ME-TR0.75	1	0.75mm	2.9mm	£10.88	ME-TR6.0	1	6.0mm	5.1mm	£64.81
ME-TR1.0	1	1.0mm	3.1mm	£13.16	ME-TR10.0	1	10.0mm	6.0mm	£118.40
ME-TR1.5	1	1.5mm	3.4mm	£19.60	ME-TR16.0	1	16.0mm	9.2mm	£205.12
ME-TR2.5	1	2.5mm	3.8mm	£30.87					

COLOURS: Red, Black, Blue, Yellow, Earth, Grey, Green, White, Orange, Brown, Pink, Violet

## Electrical tape



PVC flame retardant and waterproof electrical tape.

Part No	Description	Size	Price
ME-TP2-BLACK	Black PVC tape	19mm x33mtr	£0.98
ME-TP2-WHITE	White PVC tape	19mm x33mtr	£0.98
ME-TP2-GREY	Grey PVC tape	19mm x33mtr	£0.98
ME-TP2-BLUE	Blue PVC tape	19mm x33mtr	£0.98
ME-TP2-RED	Red PVC tape	19mm x33mtr	£0.98
ME-TP2-YELLOW	Yellow PVC tape	19mm x33mtr	£0.98
ME-TP2-BROWN	Brown PVC tape	19mm x33mtr	£0.98
ME-TP2-EARTH	Green/Yellow PVC tape	19mm x33mtr	£0.98

## Self Amalgamating

A very useful derivative of insulating tape which can be used for waterproofing connections. To use, the top protective layer is peeled off and the rubbery self-amalgamating tape underneath is wrapped tightly around the connection to be waterproofed



Part No	Description	Size	Price
ME-TP8	Self Amalgamating tape	19mm x 10mtr	£3.65

## Flexible Conduit



**LTPSS** Stainless Steel PVC coated Liquid Type  
IP66 IP67 IP68 IP69

**Construction:** Stainless steel (316), helically wound, flexible conduit with oil resistant and high temperature pvc smooth cover. Colour black.

**Typical Applications:** Machinery or outdoor applications where high corrosion resistance and liquid tight are a requirement

Part No	Description	Size	Price
ME-LTPSS20B	Flexible Conduit (25 mtr)	M20	£174.00
ME-LTPSS25B	Flexible Conduit (25 mtr)	M25	£232.00
ME-LTP20-M20-EXD	Flameproof Barrier Gland (10 pk)	M20	£176.00
ME-LTP25-M25-EXD	Flameproof Barrier Gland (10 pk)	M25	£221.00

**LFHU** Galvanised steel LFH coated IP54 P65

**Construction:** Galvanised steel, helically wound, flexible steel conduit with Low Fire Hazard (LFH) coating. Colour black.

**Typical Applications:** Machinery or outdoor applications



Part No	Description	Size	Price
ME-LFHU20B	Flexible Conduit (25 mtr)	M20	£117.00
ME-LFHU25B	Flexible Conduit (25 mtr)	M25	£164.00
ME-FSU20-M20-C-S	Swivel Connector (10 pk)	M20	£51.00
ME-FSU25-M25-C-S	Swivel Connector (10 pk)	M25	£80.00

## Roxtec S-frames, primed, mild steel

### Roxtec S-frames

for use with RM components.



Part No	Frame type	Packing space (mm)	External dimensions (D=60mm) HxW (mm)	Price
ME-S2-I	S2 x I	60 x 120	121 x 141	£18.99
ME-S4-I	S4 x I	120 x 120	180 x 141	£20.72
ME-S6-I	S6 x I	180 x 120	238 x 141	£22.56

### Roxtec RM Modules

Sealing Modules for use with Roxtec frames, removable layers for perfect adaptation to cable or pipe. When used with solid core, the module functions as a spare module for future capacity.



Part No	Module type	For Cable / pipe diameter Øa-Øb (mm)	External dim. (mm) HxW (D=60 mm)	Price
ME-RM15	RM 15	0+ 3.0-11.0	15 x 15	£3.05
ME-RM20	RM 20	0+ 4.0-14.5	20 x 20	£3.05
ME-RM30	RM 30	0+ 10.0-25.0	30 x 30	£4.59
ME-RM40	RM 40	0+ 21.5-34.5	40 x 40	£7.48
ME-RM60	RM 60	0+ 28.0-54.0	60 x 60	£18.55

### Roxtec Wedge

The Roxtec wedge is used in frames with a rectangular packing space without built-in compression. Compresses & seals the installation of cables, pipes, modules and stayplates.



Part No	Wedge type	External dimensions W (mm)	Price
ME-Wedge GV	Wedge 120 Galv	120	£45.56
ME-Wedge GV Kit	Wedge 120 Galv (Kit) *	120	£63.37
ME-Wedge SS	Wedge 120 Stainless Steel	120	£78.98
ME-Wedge SS Kit	Wedge 120 Stainless Steel (Kit)*	120	£120.98

\* The Wedge kit includes one Roxtec Wedge 120, five Stayplates, one Wedge Clip, one Lubricant and installation instructions.

### Roxtec Stayplates

Roxtec Stayplates are used for pull-out resistance against forces in cables and pipes. To be inserted between rows of modules in frames with a rectangular packing space and no built in compression.

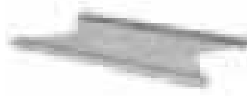

Part No	Stayplate Type	Fits Packing Space W (mm)	Price
ME-Plate GV	Stayplate 120 Galv	120	£3.36
ME-Plate SS	Stayplate 120 Stainless Steel	120	£7.92

## Geaquello E 950 Sealing System

Geaquello E950 Sealing System consists of :

R 312 or 380 Swell Modules

E 824 Impregnation Fluid

E 950 Sealing Compound

Geaquello E950 is a sealing system for making removable, fire-retardant, gas and watertight cable ducts for ships and offshore applications



Part No	Description	Size	Price
ME-4145486	Geaquello Compound E950	3Kg	£45.83
ME-4145524	Geaquello Compound E950	15Kg	£174.59
ME-4145152	Impregnation Fluid	1Kg	£10.21
ME-4145286	Impregnation Fluid	10Kg	£71.50
ME-4148142	Swell Modules Sticks (25 Sticks)	800 x 25 x 6mm	£156.00
ME-4148143	Swell Modules (360 Sticks)	120 x 25 x 6mm	£434.33

## RISE Materials

### Multi-Cable Transit Sealing System

FIWA is absolutely Hallogen free, furthermore FIWA has a low smoke index and a high oxygen index with low flame spread characteristics.

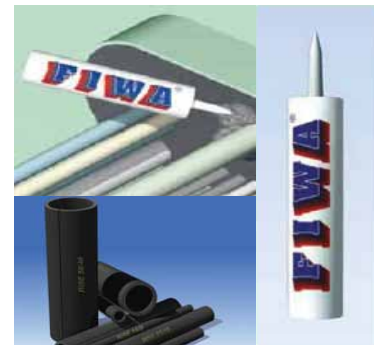

Part No	Description	Size	Price
ME-80.0900	Sealant	300ml cartridge	£29.16 each

Part No	Cable Sleeve	Cable Diameter (mm)	Sleeve Length (mm)	Price
ME-80.0200	12/6	5 - 7	210	£1.84
ME-80.0201	14/8	7 - 9	210	£2.19
ME-80.0202	16/10	9-11	210	£2.47
ME-80.0203	18/12	11-13	210	£2.96
ME-80.0204	20/14	13-15	210	£3.35
ME-80.0205	22/16	15-17	210	£3.75
ME-80.0206	27/19	17-21	210	£5.15
ME-80.0207	31/23	21-25	210	£7.11
ME-80.0208	35/27	25-29	210	£8.16
ME-80.0209	39/31	29-33	210	£9.08
ME-80.0210	46/36	33-39	210	£13.18
ME-80.0211	52/42	39-45	210	£15.26
ME-80.0212	58/48	45-51	210	£17.22
ME-80.0213	64/54	51-57	210	£19.09
ME-80.0214	70/60	57-63	210	£24.15

Note : Maximum continuous service temperature of RISE sleeves not to exceed 70°. For higher operating temperatures please contact us.

## Polyamide Dometop Cable Glands

### Metric POLYAMIDE PA6.6 Dometop Cable Glands & Lockring

Self-extinguishing class V2 (UL94)  
 Temperature Range -20°C to +90°C  
 Protection : IP 68  
 Available in Light Grey, Dark Grey & Black

Add to Part No. LG for Light Grey, G for Dark Grey, N for black  
 Sold in packs of 10

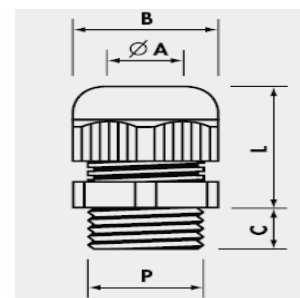

Part No.	Gland Size (P)	Fixing Hole Ø (mm)	ØA (mm) Min-Max	B (mm)	Thread Length C (MM)	L Min-Max (mm)	Price Per Pack
ME-I900.M16	M16 x 1.5	16.5	5 - 10	19	8	22 - 27	£2.80
ME-I900.M20	M20 x 1.5	20.5	7 - 13	25	9	24 - 30	£3.50
ME-I900.M25	M25 x 1.5	25.5	10 - 17	30	10	28 - 39	£5.40
ME-I900.M32	M32 x 1.5	32.5	13 - 21	36	10	33 - 44	£9.10
ME-I900.M40	M40 x 1.5	44.5	19 - 28	46	10	36 - 45	£15.30

## MCT MSR Glands

The MSR Gland is designed to seal upto 8 cables between 4 & 16mm diameter. Simply remove the centre core and minimize the number of rings to enable cables to pass through. When all cables are inserted into the gland simply tighten the four Hex Screws equally. Once completed the seal will provide an effective barrier against fire, water & dust.

Lloyds Certified to A60 Approval



Part No	Description	Hole size reqd dia. (mm)	Min cable dia. (mm)	Max cable dia. (mm)	No. of cables	Price
ME-MSR25-1	MSR 25 Type 1	25	4	12	1	£31.88
ME-MSR40-1	MSR 40 Type 1	40	11	24	1	£37.80
ME-MSR40-2	MSR 40 Type 2	40	6	15	2	£34.60
ME-MSR40-3	MSR 40 Type 3	40	6	12	4	£43.78
ME-MSR50-1	MSR 50 Type 1	51	5	10	5	£59.74
ME-MSR50-2	MSR 50 Type 2	51	4	16	3	£59.07
ME-MSR63-1	MSR 63 Type 1	64	4	16	4	£59.43
ME-MSR63-2	MSR 63 Type 2	64	5	10	8	£58.10

## Adhesive Heatshrink End Cap

Heatshrink adhesive lined end caps are used to seal the ends of plastic, rubber and paper insulated cables, from moisture, dirt and corrosion

Shrink Ratio:2.5:1  
 Material:Polyolefin



Part No	colour	range (mm)	Price
ME-CB09652	Black	8.0-4.0	£0.78
ME-CB09653	Black	17.0-8.0	£1.05
ME-CB09654	Black	30.0-17.0	£1.78
ME-CB09655	Black	45.0-30.0	£2.69

## Heatshrink Sleeving Kit

Shrink Ratio KIT 3:1  
 Colour:Black / Blue / Red / White / Yellow  
 Accessory Type:Sleeving  
 Dielectric Strength:15kV/mm  
 Operating Temperature Max:110°C  
 Operating Temperature Min:-55°C  
 Contains 180 heatshrinks



Part No	Description	Price
ME-CB10468	Heatshrink sleeving kit	£31.57

## Adhesive Lined Heatshrink



Shrink Ratio:4 : 1  
 Material:Polyolefin  
 Operating Temperature Max:125°C  
 Operating Temperature Min:-55°C

Part No	Colour	Range (mm)	Length (m)	Price
ME-HS403	Black	12.0 - 3.0	1.2	£4.58
ME-HS404	Black	16.0 - 4.0	1.2	£6.00
ME-HS405	Black	20.0 - 5.0	1.2	£7.18
ME-HS406	Black	24.0 - 6.0	1.2	£9.35
ME-HS407	Black	32.0 - 8.0	1.2	£15.14
ME-HS408	Black	52.0 - 13.0	1.2	£24.55



## Hazardous Area 501/453/UNIVERSAL

### Application

Outdoor or indoor use. For use with single wire armour 'W', wire braid 'X', steel tape elastomer and plastic insulated cables. For particular use with Cables that exhibit 'Cold Flow' characteristics. See technical section for installation rules and regulations.

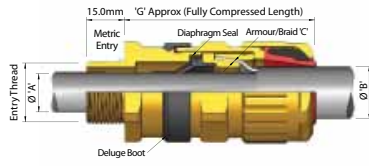

Part No	Metric	Inner Sheath		Outer Sheath 'B'		Price
		Min.	'A' Max.	Min.	Max.	
ME-501/453/Univ/M20 Os	M20	3.5	8.1	5.5	12.0	£11.21
ME-501/453/Univ/M20 O	M20	6.5	11.4	9.5	16.0	£11.21
ME-501/453/Univ/M20 A	M20	8.4	14.3	12.5	20.5	£13.20
ME-501/453/Univ/M25 B	M25	11.1	19.7	16.9	26.0	£19.97
ME-501/453/Univ/M32 C	M32	17.6	26.5	22.0	33.0	£29.80

## Hazardous Area 501/421

### Application

The 501/421 cable gland provides a seal on the outer cable sheath and is intended for use on non-armoured elastomer and plastic insulated cables. The cable is dual certified Exd and Exe and is suitable for installation in Zone 1 (21) and Zone 2 (22) hazardous areas.

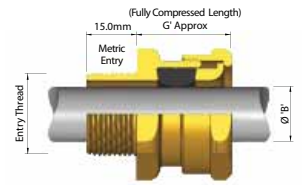

Part No	Entry Thread Size Metric	Cable Acceptance Details Outer Sheath 'B'				Price.
		Standard Seal Min.	Standard Seal Max.	Alternative Seal (S) Min.	Alternative Seal (S) Max.	
ME-501/421/M16 K	M16	3.0	8.0	-	-	£4.55
ME-501/421/M20 Os	M20	3.0	8.0	-	-	£4.55
ME-501/421/M20 O	M20	7.5	11.9	-	-	£4.55
ME-501/421/M20 A	M20	11.0	14.3	8.5	13.5	£5.42
ME-501/421/M25 B	M25	13.0	20.2	9.5	15.4	£8.67
ME-501/421/M32 C	M32	19.0	26.5	15.5	21.2	£15.78

## Industrial Area 153/UNIVERSAL

### Application

Outdoor or indoor use. For use with single wire armour 'W', wire braid 'X', aluminium strip armour 'Y', and steel tape armour 'Z' elastomer and plastic insulated cables. For particular use with:- Cables that exhibit 'Cold Flow' characteristics.

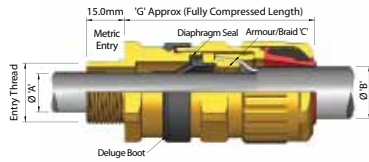

Part No	Metric	Inner Sheath		Outer Sheath 'B'		Price
		Min.	'A' Max.	Min.	Max.	
ME-153/Univ/M20 Os	M20	3.5	8.1	5.5	12.0	£8.81
ME-153/Univ/M20 O	M20	6.5	11.4	9.5	16.0	£8.81
ME-153/Univ/M20 A	M20	8.4	14.3	12.5	20.5	£10.39
ME-153/Univ/M25 B	M25	11.1	19.7	16.9	26.0	£15.71
ME-153/Univ/M32 C	M32	17.6	26.5	22.0	33.0	£23.45

## Industrial Area 121

### Application

Outdoor or indoor use. For use with non-armoured elastomer and plastic insulated cables.

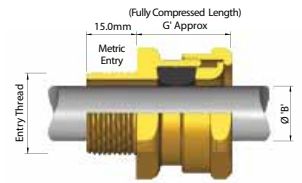

Part No	Entry Thread Size Metric	Cable Acceptance Details Outer Sheath 'B'				Price.
		Standard Seal Min.	Standard Seal Max.	Alternative Seal (S) Min.	Alternative Seal (S) Max.	
ME-121/M16 K	M16	3.0	8.0	-	-	£3.86
ME-121/M20 Os	M20	3.0	8.0	-	-	£3.86
ME-121/M20 O	M20	7.5	11.9	-	-	£3.86
ME-121/M20 A	M20	11.0	14.3	8.5	13.5	£4.61
ME-121/M25 B	M25	13.0	20.2	9.5	15.4	£7.38
ME-121/M32 C	M32	19.0	26.5	15.5	21.2	£11.05

## Accessories

All dimensions in millimetres (except \* where dimensions are in inches)

### Fibre Washer

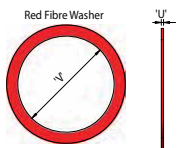

**Application** For use on cable gland entry threads.

**Features** To maintain ingress protection rating at the enclosure. Retaining 'Pips' make washer captive on metric cable gland entry thread.

Part No	Metric Gland Size 'V'	Price
ME-WWash/F/M20S	M20	£0.20
ME-WWash/F/M20	M20	£0.20
ME-WWash/F/M25	M25	£0.26
ME-WWash/F/M32	M32	£0.33

### Serrated Washer

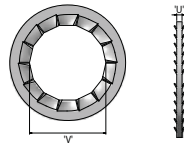

**Application** For use on cable gland entry threads.

**Features** To dampen vibrations of the cable gland / equipment assembly which may loosen the cable gland or locknut. Manufactured in Stainless Steel (standard).

Part No	Metric Gland Size 'V'	Price
ME-WWash/Serr/Galv/M20S	M20	£0.64
ME-WWash/Serr/Galv/M20	M20	£1.16
ME-WWash/Serr/Galv/M25	M25	£1.65
ME-WWash/Serr/Galv/M32	M32	£2.89

### Earth Tags

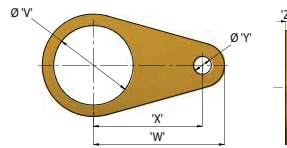

**Application** Provides an earth bond attachment for a cable gland.

**Features** Manufactured in Brass (standard). Stainless Steel earthtags are available, but dimensions may differ slightly to those stated below.

Part No	Metric Gland Size 'V'	'Y'	'W'	'X'	'Z'	Price
ME-Etag/M20	M20	6.75	39.6	33.1	1.6	£0.32
ME-Etag/M25	M25	6.85	45.5	36.5	1.6	£0.36
ME-Etag/M32	M32	12.6	52.0	40.9	1.6	£0.55

### Brass Locknut

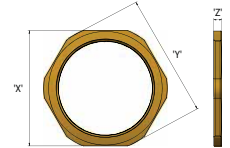

**Application** Secures a cable gland in position at the equipment.

**Features** Heavy duty locknuts manufactured in Brass (standard). Stainless Steel locknuts are available, but dimensions differ slightly to those stated below.

Part No	Metric Gland Size	Metric x 1.5mm Pitch			Price
		Across Flats 'X'	Across Corners 'Y'	'Z'	
ME-Lnut/M16	M16	19.0	21.9	3.2	£0.40
ME-Lnut/M20	M20	24.0	26.9	4.0	£0.40
ME-Lnut/M25	M25	30.0	33.6	4.0	£0.46
ME-Lnut/M32	M32	46.0	53.1	4.0	£0.86

## Crimp Insulated Red Ring

High quality, pre-insulated copper crimp terminals. EN 60352-2, 1:2003. Use with ratchet crimping tool. Product contents Bag of 100  
Specifications Cable size: 0.5-1.5mm<sup>2</sup>. I<sub>max</sub> - 19A

Part No	Hole size	Price Per Bag
ME-CN-11349	3.2mm	£1.86
ME-CN-11350	3.7mm	£1.99
ME-CN-11351	4mm	£2.11
ME-CN-11352	5mm	£2.24
ME-CN-11353	6mm	£2.99
ME-CN-11354	8mm	£3.24
ME-CN-11355	10mm	£3.61



## Crimp Insulated Blue Ring

High quality, pre-insulated copper crimp terminals. EN 60352-2, 1:2003. Use with ratchet crimping tool. Product contents Bag of 100  
Specifications Cable size: 1.5-2.5mm<sup>2</sup>. I<sub>max</sub> - 27A

Part No	Hole size	Price Per Bag
ME-CN-11356	3.2mm	£2.11
ME-CN-11357	3.7mm	£2.24
ME-CN-11358	4mm	£2.24
ME-CN-11359	5mm	£2.36
ME-CN-11360	6mm	£3.24
ME-CN-11361	8mm	£3.24
ME-CN-11362	10mm	£3.61



## Crimp Insulated Yellow Ring

High quality, pre-insulated copper crimp terminals. EN 60352-2, 1:2003. Use with ratchet crimping tool. Product contents Bag of 100  
Specifications Cable size: 4.0-6.0mm<sup>2</sup>. I<sub>max</sub> - 48A

Part No	Hole size	Price Per Bag
ME-CN-11365	3.7mm	£3.61
ME-CN-11366	4mm	£3.86
ME-CN-11367	6mm	£6.24
ME-CN-11368	8mm	£6.24



## Crimp Insulated Butt Splice

High quality, pre-insulated copper crimp terminals. EN 60352-2, 1:2003. Use with ratchet crimping tool. Product contents Bag of 100

Part No	Crimp size	Price
ME-CN-11406	1.5mm Red	£2.74
ME-CN-11407	2.5mm Blue	£3.11
ME-CN-11408	6.0mm Yellow	£4.99



## Copper Tube Crimp Terminals

Part No	Cable size	Hole size	Price Per Pack
ME-CT6-6	6mm	6mm	£1.05
ME-CT6-8	6mm	8mm	£1.13
ME-CT10-5	10mm	5mm	£1.33
ME-CT10-6	10mm	6mm	£1.33
ME-CT10-8	10mm	8mm	£1.33
ME-CT10-10	10mm	10mm	£1.54
ME-CT10-12	10mm	12mm	£1.78
ME-CT16-6	16mm	6mm	£1.48
ME-CT16-8	16mm	8mm	£1.48
ME-CT16-10	16mm	10mm	£1.93
ME-CT16-12	16mm	12mm	£2.08
ME-CT25-6	25mm	6mm	£2.21
ME-CT25-8	25mm	8mm	£2.21
ME-CT25-10	25mm	10mm	£2.21
ME-CT25-12	25mm	12mm	£2.21
ME-CT35-6	35mm	6mm	£3.19
ME-CT35-8	35mm	8mm	£3.19
ME-CT35-10	35mm	10mm	£3.34
ME-CT35-12	35mm	12mm	£3.34
ME-CT50-6	50mm	6mm	£4.08
ME-CT50-8	50mm	8mm	£4.08
ME-CT50-10	50mm	10mm	£4.36
ME-CT50-12	50mm	12mm	£4.36
ME-CT70-8	70mm	8mm	£6.29
ME-CT70-10	70mm	10mm	£6.59
ME-CT70-12	70mm	12mm	£6.59
ME-CT70-14	70mm	14mm	£6.59



High quality, non-insulated copper crimp terminals. Use with ratchet crimping tool.

Product contents Pack of 10

Specifications Cable size: As selected

## Ratchet Crimping Tool

Automatic release for perfect crimp everytime. Product contents: 1 x Crimping tool.

Part No	Description
ME-TCR1	Pre Ins. Terminals 0.5 - 6.0mm
ME-TCR2	Bootlace crimping tool 0.5 - 6.0mm
ME-TCR3	Bootlace crimping tool 4.0 - 16.0mm
ME-TCR5	Copper tube crimping tool 1.5 - 6.0mm
ME-TCR6	Copper tube crimping tool 10 & 16.0mm



PRICE £29.38

## Bootlace Ferrules

High quality, cord end bootlace ferrules. Use with ratchet crimping tool. Product contents 100 x bootlace ferrules

Part No	Cable size	Colour	Price
ME-CE05	0.5mm	White	£1.33
ME-CE075	0.75mm	Blue	£1.33
ME-CE10	1.0mm	Red	£1.33
ME-CE15	1.5mm	Black	£1.33
ME-CE25	2.5mm	Grey	£1.56
ME-CE40	4.0mm	Orange	£2.49
ME-CE60	6.0mm	Green	£4.00



## Terminals and Accessories

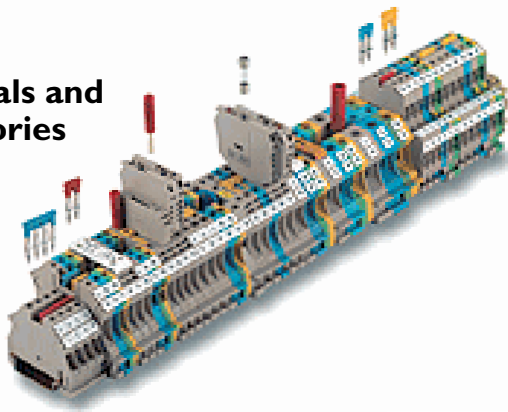

## Weidmuller W Series Din Rail Components

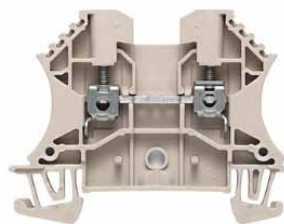

Part No	Description	Price Each
ME-WDU2.5	2.5mm Feed Through Terminal	£0.38
ME-WDU4	4.0mm Feed Through Terminal	£0.42
ME-WDU6	6.0mm Feed Through Terminal	£0.55
ME-WDU10	10.0mm Feed Through Terminal	£0.66
ME-WDU16	16.0mm Feed Through Terminal	£0.96

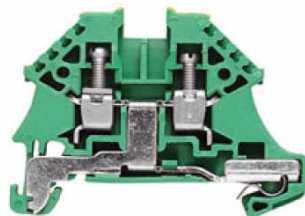

Part No	Description	Price Each
ME-WPE2.5	2.5mm Feed Through Earth Terminal	£1.52
ME-WPE4	4.0mm Feed Through Earth Terminal	£1.56
ME-WPE6	6.0mm Feed Through Earth Terminal	£1.63
ME-WPE10	10.0mm Feed Through Earth Terminal	£1.78
ME-WPE16	16.0mm Feed Through Earth Terminal	£2.44



Part No	Description	Price Each
ME-WSI6	Fuse terminal for 20mm x 5mm 6.3Amp Max Fuses	£1.85
ME-WSI25/1	Single Fuse terminal for 38mm x 10mm 32Amp Max Fuses	£4.45
ME-WSI25/2	Double Fuse terminal for 38mm x 10mm 32Amp Max Fuses	£8.90
ME-WSI25/3	Triple Pole Fuse terminal for 38mm x 10mm 32Amp Max Fuses	£13.33



Part No	Description	Price Each
ME-WAP2.5	Terminal End Cap	£0.18
ME-ZEW	End Bracket	£2.75
ME-TS35	Din Rail 35mm Solid Top Hat 2mtr Length	£2.75
ME-TS35SL	Din Rail 35mm Slotted Top Hat 2mtr Length	£2.90

## Polycarbonate Junction Boxes

Abox Junction Box - IP65



Part No	Colour	Width	Height	Depth	Price Each
ME-490902	Grey	80mm	80mm	52mm	£5.24
ME-491902	Black	80mm	80mm	52mm	£5.27
ME-490904	Grey	93mm	93mm	55mm	£7.34
ME-491904	Black	93mm	93mm	55mm	£7.39
ME-490906	Grey	110mm	110mm	67mm	£8.57
ME-491906	Black	110mm	110mm	67mm	£8.63
ME-490910	Grey	140mm	140mm	79mm	£11.46
ME-491910	Black	140mm	140mm	79mm	£11.59
ME-490916	Grey	180mm	180mm	91mm	£18.37
ME-491916	Black	180mm	180mm	91mm	£21.50

## Glass Reinforced Polyester Junction Boxes

Each enclosure comes pre-drilled with four M20 tapped cable entries and is supplied with EEx'e' certified blanking plugs. The BPGA range of enclosures are also ATEX certified EEx'e' and are suitable for use in Category 2/Zone 1 and Category 3/ Zone 2 areas according to EN 60079-14 with a working ambient temperature of between -20°C and +40°C (-4°F to 104°F).



	Available Sizes (mm)			Price Each
	Width	Height	Depth	
ME-BPGA120	122	90	120	£36.85
ME-BPGA125	122	90	125	£35.76
ME-BPGA160	160	90	160	£58.68



## Telemecanique Contactors

LC1 series 3 Pole AC Contactor is suitable for use in circuits of rated voltage to 660V AC 50HZ or 60HZ, rated current up to 95A, for making & breaking, frequently starting & controlling the AC motor. Combined with the auxiliary contact block, time delay & machine- interlocking contactor, star-delta starter. With the thermal relay, it is combined into the electromagnetic starter. Auxillary contact configuration one N/O, one N/C. The Contactor is produced according to IEC 60947-4.



Add Coil Voltage to part number

B7 - 24VAC M7 - 220VAC  
 E7 - 48VAC P7 - 230 VAC  
 F7 - 110VAC V7 - 400 VAC  
 N7 - 415 VAC

Part No	Rated current Ue ≤ 440V (A)	AC3 Switching Power (Kw)	Height (mm)	Width (mm)	Depth (mm)	Price Each
ME-LC1-D09	9	4	77	45	86	£22.55
ME-LC1-D12	12	5.5	77	45	86	£26.92
ME-LC1-D18	18	9	77	45	86	£33.32
ME-LC1-D25	25	11	85	45	92	£46.37
ME-LC1-D32	32	15	85	45	92	£68.77
ME-LC1-D38	38	18.5	85	45	92	£76.67
ME-LC1-D40	40	22	127	75	119	£82.75
ME-LC1-D50	50	25	127	75	119	£106.09
ME-LC1-D65	65	37	127	75	119	£143.22

## Telemecanique 3 Pole Thermal Overload Relays

Three pole thermal overload relays designed to protect ac circuits against overloads, phase failure, long starting times and prolonged stalling of the motor. Auxillary contact configuration I/N/O & I/N/C.



Part No.	Relay setting range (A)		Fuses to be used with selected relay			For use with Contactor LC1	Price Each
	Am (A)	Gg (A)	BS88 (A)				
ME-LRD 01	0.10 - 0.16	0.25	2	-	-	D09...D38	£23.86
ME-LRD 02	0.16 - 0.25	0.5	2	-	-	D09...D38	£23.86
ME-LRD 03	0.25 - 0.40	1	2	-	-	D09...D38	£25.32
ME-LRD 04	0.40 - 0.63	1	2	-	-	D09...D38	£25.32
ME-LRD 05	0.63 - 1	2	4	-	-	D09...D38	£25.32
ME-LRD 06	1 - 1.6	2	4	6	-	D09...D38	£25.32
ME-LRD 07	1.6 - 2.5	4	6	10	-	D09...D38	£25.32
ME-LRD 08	2.5 - 4	6	10	16	-	D09...D38	£25.32
ME-LRD 10	4 - 6	8	16	16	-	D09...D38	£25.32
ME-LRD 12	5.5 - 8	12	20	20	-	D09...D38	£25.32
ME-LRD 14	7 - 10	12	20	20	-	D09...D38	£35.16
ME-LRD 16	9 - 13	16	25	25	-	D12...D38	£26.65
ME-LRD 21	12 - 18	20	35	32	-	D18...D38	£30.52
ME-LRD 22	16 - 24	25	50	50	-	D25...D38	£33.91
ME-LRD 32	23 - 32	40	63	63	-	D25...D38	£33.91
ME-LRD 35	30 - 38	40	80	80	-	D32 and D38	£44.60

## Telemecanique 3 Pole Thermal Overload Relays (continued)

For Connection by Everlink BTR screw connectors (3)

Part No	Rated current (A)	AC3 Power (Kw)	Height (mm)	Width (mm)	Depth (mm)	Price Each
ME-LRD 313	9 - 13	16	25	25	D40A...D65A	£42.23
ME-LRD 318	12 - 18	20	32	35	D40A...D65A	£44.29
ME-LRD 325	17 - 25	25	50	50	D40A...D65A	£45.32
ME-LRD 332	23 - 32	40	63	63	D40A...D65A	£46.35
ME-LRD 340	30 - 40	40	80	80	D40A...D65A	£47.38
ME-LRD 350	37 - 50	63	100	100	D40A...D65A	£55.62
ME-LRD 365	48 - 65	63	100	100	D50 and 65A	£58.71

## Telemecanique Auxillary Contacts



Part No	Description	Price Each
ME-LADN01	Front contact block NC	£5.96
ME-LADN02	2 NC Front mount contact block	£6.10
ME-LADN11	1 NO 1 NC front mount contact block	£6.10
ME-LADN11G	Front contact block 1NO + 1NC	£5.99
ME-LADN13	1NO + 3NC, front mount contact block	£10.82
ME-LADN20	2NO, front mount contact block	£6.10
ME-LADN22	2NO 2NC, front mount contact block	£10.82
ME-LADN31	3NO 1NC, front mount contact block	£10.82

## Finder 55 Series Plug-in mount 4 pole relays

### Features

Lockable test button and mechanical flag indicator as standard  
 AC & DC Coils  
 Compatible with 94 Series Sockets  
 Compatible with 86 Series Timer accessories  
 Coil EMC suppression



Part No	Coil Voltage	Configuration	Contact Voltage	Contact Rating	Price Each
ME-55.34.8.024	24Vac	4 x CO(4PDT)	250Vac	7Amp	£6.18
ME-55.34.8.110	110Vac	4 x CO(4PDT)	250Vac	7Amp	£6.18
ME-55.34.8.230	230Vac	4 x CO(4PDT)	250Vac	7Amp	£6.68
ME-55.34.9.012	12Vdc	4 x CO(4PDT)	250Vac	7Amp	£5.62
ME-55.34.9.024	24Vdc	4 x CO(4PDT)	250Vac	7Amp	£6.18

### 94 Series Relay / Timer Base

Part No	Contact Voltage	Contact Rating	Price
ME.94.04	250Vac	10Amp	£3.97

## 86 Series Timer



Part No	Coil Voltage	Configuration	Time Range	Price Each
ME-86.30.0.024	12-24V ac/dc	Delay on/off	0.05s-100h	£17.86
ME-86.30.8.120	120Vac	Delay on/off	0.05s-100h	£20.05
ME-86.30.8.240	230-240Vac	Delay on/off	0.05s-100h	£20.05

## Schneider Electric C60H Circuit Breakers 10kV

C60H circuit protectors are designed to provide overcurrent protection for appliances or electrical equipment. Nominal current 1A to 63A, operating voltage up to 440 V ac also a large choice of breaking capacities and tripping curves B and C available. C Curve Utilisation - cables feeding conventional loads. D Curve Utilisation - loads with high inrush current (motors, transformers).



Type	Poles	Rating (A)	C Curve	Price	D Curve	Price
C60H	2	4	ME-C60HC204	£39.27	ME-C60HD204	£41.62
C60H	2	6	ME-C60HC206	£33.47	ME-C60HD206	£38.45
C60H	2	10	ME-C60HC210	£36.61	ME-C60HD210	£35.13
C60H	2	16	ME-C60HC216	£33.47	ME-C60HD216	£35.13
C60H	2	20	ME-C60HC220	£33.47	ME-C60HD220	£35.13
C60H	2	32	ME-C60HC232	£33.47	ME-C60HD232	£35.13
C60H	3	2	ME-C60HC302	£60.99	ME-C60HD302	£64.04
C60H	3	4	ME-C60HC304	£57.10	ME-C60HD304	£59.95
C60H	3	6	ME-C60HC306	£54.39	ME-C60HD306	£57.13
C60H	3	10	ME-C60HC310	£50.20	ME-C60HD310	£52.72
C60H	3	16	ME-C60HC316	£50.20	ME-C60HD316	£52.72
C60H	3	20	ME-C60HC320	£50.20	ME-C60HD320	£52.72
C60H	3	25	ME-C60HC325	£50.20	ME-C60HD325	£52.72
C60H	3	32	ME-C60HC332	£50.20	ME-C60HD332	£52.72

## Cavity Wall Boxes



Part No	Description	Diameter	Depth	Price
ME-920.035.01	Single Box	68mm	35mm	£1.32
ME-920.050.01	Single Box	68mm	50mm	£1.01
ME-923.050.01	Twin Box	2x68mm	50mm	£2.28

## Switches - 16Amp screw terminals



Part No	Description	Price
ME-3403	Double Pole 1 Way Switch Flush Mounted	£8.45
ME-4275	Double Pole 2 Way Switch Flush Mounted	£5.20
ME-5867	Double Pole 1 Way Switch Surface Mounted	£6.44
ME-5884	Double Pole 1 Way Switch Surface Mounted	£5.20

## Socket Outlets - 16Amp screw terminals



Part No	Description	Price
ME-6285	Single Socket Flush Mounted	£5.85
ME-5739	Twin Socket Flush Mounted	£5.17
ME-6234	Single Socket Surface Mounted	£13.10
ME-6240	Twin Socket Surface Mounted	£4.88
ME-4968	Single Socket Flush Mounted (no cover plate)	£10.84
ME-5511	Single USA Socket Flush Mounted	£24.57

## Miscellaneous



Part No	Description	Price
ME-5266	TV Point Flush Mounted	£27.30
ME-9667	25mm Single Surface Switch/Socket Box	£7.36
ME-9380	25mm Double Surface Switch/Socket Box	£12.82
ME-9671	35mm Double Surface Switch/Socket Box	£14.20
ME-9140	Single Coverplate	£1.79
ME-9141	Double Coverplate	£4.60

## Vigi Modules for C60 Circuit Breakers

The Vigi module incorporates the residual current relay and toroid in a case. Its earthleakage module is electro-mechanical. It functions with out an auxiliary power supply source and thus has a very wide operating range. The Vigi module protects the electrical installation against insulation faults and additional protection of persons against direct contact: high sensitivity (30 mA).



Part No	Type	Voltage (V)	Poles	Sensitivity (mA)	Price Each
ME-MGV630302	C60 (≤63A)	240 - 415	2	30	£77.21
ME-MGV633002	C60 (≤63A)	240 - 415	2	300	£84.91

## C60 Circuit Breakers Accessories

### MCB/RCD Padlock Attachment

Padlocking accessory Utilisation: Enables padlocking (in I or O position) of circuit-breakers or residual current devices. Padlock: Ø 4mm (not supplied)

**Sold in packs of 2**



Part No	Type	Suitable for C60H Circuit Breaker	Price Per Pack
ME-26970	C60	C60	£7.55

## HSS Metric Jobber Drill Bits

Precision hardened, flexible and super sharp, roll forged, HSS twist drills. Excellent quality.

Sold in packs of 10



Part Number	Drill Diameter Ø	Drill Length	Price Per Pack
ME-DR05	3.0 mm	61 mm	£3.23
ME-DR06	3.5 mm	70 mm	£4.03
ME-DR07	4.0 mm	75 mm	£4.14
ME-DR08	4.5 mm	80 mm	£5.40
ME-DR09	5.0 mm	86 mm	£5.75
ME-DR10	5.5 mm	93 mm	£7.48
ME-DR11	6.0 mm	93 mm	£7.70
ME-DR12	6.5 mm	101 mm	£9.78
ME-DR13	7.0 mm	109 mm	£10.46
ME-DR14	7.5 mm	109 mm	£12.30
ME-DR15	8.0 mm	117 mm	£13.45
ME-DR16	8.5 mm	117 mm	£14.73
ME-DR17	9.0 mm	125 mm	£16.68
ME-DR18	9.5 mm	125 mm	£18.63
ME-DR19	10.0 mm	133 mm	£19.44

## Cobalt Metric Twist Drill Bits

Particularly heat resistant. Excellent Drilling performance even in stainless and other hard steels. Precision ground flutes and diameter for excellent dimensional accuracy. 135 degree split point fully ground angle for precise centering.

Sold in packs of 10



Part Number	Drill Diameter Ø	Price Per Pack
ME-DRC05	3.0 mm	£3.66
ME-DRC06	3.5 mm	£3.90
ME-DRC07	4.0 mm	£4.63
ME-DRC08	4.5 mm	£5.04
ME-DRC09	5.0 mm	£5.46
ME-DRC10	5.5 mm	£6.36
ME-DRC11	6.0 mm	£6.73
ME-DRC12	6.5 mm	£8.34
ME-DRC13	7.0 mm	£9.60
ME-DRC14	7.5 mm	£10.93
ME-DRC15	8.0 mm	£11.94
ME-DRC16	8.5 mm	£12.90
ME-DRC17	9.0 mm	£13.80
ME-DRC18	9.5 mm	£15.54
ME-DRC19	10.0 mm	£17.04

## HSS Bimetal Holesaws

High quality and will suit most applications such as steel, iron, cast iron, pipes, non-ferrous metal, plastics, wood & sandwich type material. All Holesaws have a 32mm cutting depth.



Part Number	Size (mm)	Price	Part Number	Size (mm)	Price
ME-HLE02	16	£3.26	ME-HLE11	32	£4.56
ME-HLE04	19	£3.26	ME-HLE13	38	£5.35
ME-HLE05	20	£3.26	ME-HLE14	40	£5.35
ME-HLE06	22	£3.26	ME-HLE16	51	£5.75
ME-HLE08	25	£4.10	ME-HLE17	57	£6.71
ME-HLE10	30	£4.41	ME-HLE18	64	£6.99
			ME-HLE68	68	£11.44

ME-HLE01 To ME-HLE10  
To Suit 1/2" x 20 Drive Adaptors

ME-HLE11 To ME-HLE23  
To Suit 5/8" x 18 Hex Arbor

## Drive Adaptor

Drive Adaptors come complete with HSS Pilot Bit Suitable for Holesaws 14mm to 30mm

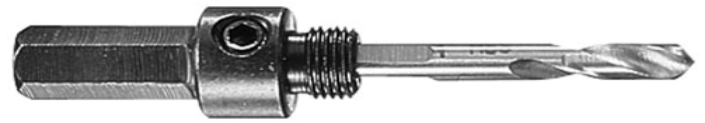

Part Number	Size	Price Each
ME-HLEA01	1/2" x 20 Drive Adaptor (9.5mm Hex)	£4.63

## Hex Arbor

Pin Drive Hex Arbor comes complete with HSS Pilot Bit. Suitable for Holesaws 32mm to 152mm



Part Number	Size	Price Each
ME-HLEA03	5/8" x 18 Hex Arbor (11mm Hex)	£7.83

## HSS Pilot Bit

For use with Drive Adaptors and Hex Arbor



Part Number	Drill Diameter Ø	Drill Length	Price Each
ME-HLEA08	6.5mm (1/4")	75mm	£1.96



## Grommets

**Rutaseal Grommet** Sold in pack of 50

Part No	Size	Price Per Pack
ME-RS0509M16	M16	£8.00
ME-RS0813M20	M20	£9.00
ME-RS1117M25	M25	£12.25



**Wiring Grommet** Sold in pack of 100

Part No	Size	Price Per Pack
ME-GRI6W	M16	£2.56
ME-GR20W	M20	£2.69
ME-GR25W	M25	£4.25



**Blanking Grommet** Sold in pack of 100

Part No	Size	Price Per Pack
ME-GRI6B	M16	£2.95
ME-GR20B	M20	£3.13
ME-GR25B	M25	£4.81



## Wolf Torches

Wolf Ex certified safety torch.



Requires 4 x AA Batteries (not included)

Part No	Description	Price Each
ME-TR24	Yellow zone I + 2	£24.50
ME-TR40	LED Yellow zone I + 2	£64.31
ME-TR45	LED Black zone 0	£77.19



## Connector Strip

Manufactured from clear Polyethylene  
Supplied in strips of 12. 10 strips per pack

Part No	Current Rating	Price Per Pack
ME-CS5	5 Amp	£3.69
ME-CS15	15 Amp	£6.19
ME-CS30	30 Amp	£10.13
ME-CS60	60 Amp	£37.38

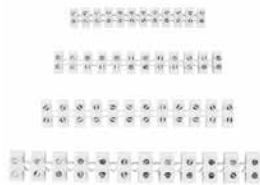

## Batteries

Non-rechargeable batteries.

Part No	Description	Price Per Pack
ME-DB1	AAA Batteries 4 pk	£2.98
ME-DB2	AA Batteries 4 pk	£2.98
ME-DB3	C Batteries 2 pk	£2.48
ME-DB4	D Batteries 2 pk	£3.20
ME-DB5	PP3 Batteries 1 pk	£3.08



## Fluorescent Tubes

Sold in packs of 25



**Guide to colour temperature**

Temperature	3000K	3500K	4000K	6500K
Description	Warm White	White	Cool White	Daylight
Effect	Cosy, Welcoming	Neutral	Clean, Professional	Sterile, Cold
Typical Applications	Reception/ Rest Areas	General Purpose	Office / Production Areas	Toilets, Kitchens

Part No	Description	Colour	Power	Length	Pack Per Price
ME-L823	T5 Flu Tube	White	835	8w	300mm £0.85
ME-1500	T8 Flu Tube	Cool White	840	18w	604mm £1.43
ME-1501	T8 Flu Tube	Warm White	830	18w	604mm £1.43
ME-1502	T8 Flu Tube	DayLight	865	18w	604mm £1.43
ME-580	T8 Flu Tube	White	835	18w	604mm £1.53
ME-1510	T8 Flu Tube	Cool White	840	36w	1213.6mm £1.53
ME-1511	T8 Flu Tube	Warm White	830	36w	1213.6mm £1.53
ME-1512	T8 Flu Tube	DayLight	865	36w	1213.6mm £1.53
ME-578	T8 Flu Tube	White	835	36w	1213.6mm £1.53

## Danfoss KP Pressure Switches

KP pressure controls are for use in refrigeration and air conditioning systems to give protection against excessively low suction pressure or excessively high discharge pressure. The controls are also used for starting and stopping refrigeration compressors and fans on air-cooled condensers. KP pressure controls are available in IP 30 and IP 44 enclosures.



**KP Pressure Control, Low Pressure**

Part No	Conn. Type	Reg. Range	Diff. (bar)	Contact Function	Price Each
ME-060-110166	Flare	-0.20 - 7.50 bar	0.70 - 4.00 bar	SPDT	£33.37
ME-060-110366	Flare	-0.90 - 7.00 bar	0.70 bar	SPDT	£42.38

**Dual KP Pressure Control**

Part No	Conn. Type	Reg. left (bar) Pe	Reg. right (bar) Pe	Diff. left side (bar)	Diff. right side (bar)	Price Each
ME-060-000766	Flare Nut	-0.20 - 7.50 bar	8.0 - 32.0 bar	0.70 - 4.00 bar	4.00 bar	£148.06
ME-060-001066	Solder, ODF	-0.20 - 7.50 bar	8.0 - 32.0 bar	0.70 - 4.00 bar	4.00 bar	£103.50

**KP Spare Parts & Accessories**

Part No	Description	Price Each
ME-060-008666	Front Cover For Single Control	£11.121
ME-060-011366	Front Cover For Dual Control	£16.06
ME-060-109766	Top Cover For Single Control	£6.31
ME-060-109866	Top Cover For Dual Control	£8.19
ME-060-003166	Protective Cap For Single Control	£3.51
ME-060-003266	Protective Cap For Dual Control	£4.42
ME-060-033066	IP55 Enclosure From Single Control	£11.90
ME-060-035066	IP55 Enclosure For Dual Control	£16.06



**Marine Electrical Installations Limited**  
Unit 25 Whitegates Business Park, Lenzie Road,  
Kirkintilloch, Glasgow G66 3BQ  
Fax: +44 (0) 141 776 2092 e-mail: sales@m-e-i.co.uk

**Tel: +44 (0) 141 776 2020**  
**www.m-e-i.co.uk**

### **M-E-I Services Offered**

Electrical Design and Class Approval Service  
Electrical Installation Both New and Retrofit  
Thermographic Surveys      Commissioning  
Electrical Surveys      Project Management  
Fault Diagnosis      CAD Drawing Service  
Emergency Repair

### **Experience**

Generators      CCTV Systems  
Lighting & Power Systems      Nav Aids & Comms Systems  
Fire & Gas Detection Systems      Data Networks  
Public Address Systems      Engine Wiring  
Motor Control Systems      Safety/ Monitoring Systems  
Refrigeration Systems      Contolled Entry Systems  
Hvac Systems      Battery/ UPS Systems

### **Panel Equipment & Design/ Construction**

Transformers      Control Panels  
Distribution Boards      Bespoke Alarm/ System Panels  
Motor Starters



All prices are net basis and subject to minimum order quantities shown and do not include VAT.

Offers valid while stocks last.

Registered in Scotland No226588