

# RECORD Traction

## SPEED INDICATORS



- Three standard sizes.
- Accuracy to  $\pm 1.5\%$  (class 1.5).
- Long scale 240° Presentation.
- Dial marking to customer requirements.
- Strong construction.
- Toughened glass window.
- Robust pivot & jewel movement.
- Illuminated scales.



The **Traction** range of speed indicating instruments has been designed to meet the requirements of transit units worldwide.

In the operational areas of passenger transport & industrial rail freight great demands are placed on instrumentation systems due to the severe shock and vibration that can be experienced during service.

In many of these applications RECORD Traction Speed instruments are chosen because of their robust design and reliability.

Many of the world's railways are now run by operating companies with long-term franchises. Trains themselves usually last between 30 and 40 years and because of these factors operators and manufacturers look for long term reliability and availability to support the working life of the transit system.

The Twinset internal movement pointer indicates the actual track speed of the vehicle, and the outer pointer controlled by additional equipment shows the max allowable track speed for the particular line.

As interiors of the passenger compartments change to meet requirements of fashion and passenger safety. The driver's cabin has become more spacious and designed with driver comfort in mind.

One item, the speed indicator, has remained relatively unchanged. This is due to the need to maintain familiarity between drivers around the world and the engineering acceptance that this product has gained over many years.

### OPTIONAL FEATURES

The 4TA & 6TA instruments can be supplied with digital displays to indicate variables such as hours run. Servo motors can be utilised to give additional indication.

The Traction range utilises the 240° "Premier" movement system. This proven system has been manufactured using the very best precision components and automated production facility. These factors give the movement its inherent reliability, linearity and accuracy.

### THERE ARE 3 STANDARD SIZES AVAILABLE

3.25TA, 4TA & 6TA. All instruments have square bezels with 4 point corner fixing. This allows easy front mounting. A slotted cover allows

light to illuminate the dial and pointer. The scale is engraved into the acrylic dial and protected by a toughened glass window. Instruments are fitted with a rear zero adjuster and are designed to operate from either A.C. or D.C. signals with accuracy to  $\pm 1.5\%$ .

### OPTIONAL FEATURES

**Internal Illumination:** Longlife filament lamps or LED's can be fitted into the rear of the case to illuminate a translucent dial. Illumination power with 12V d.c. or 24V d.c. as standard.

**Round Bezel:** Instrument can be fitted with round bezel and rear clamp fixing.

Mechanical Specs & Dimensions non-reflective glass window

**Special Features:** Contact RECORD Sales and discuss your special requirements. Existing optional features have been developed from our customer's needs

**Manufactured to BS 89/BR563 under the control of the ISO 9001 Quality System.**

### Mechanical Specs & Dimensions

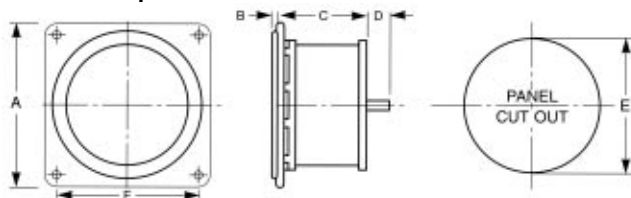

Type	Dimensions (units)								
	A max (mm)	B max (mm)	C max (mm)	D max (mm)	E min (mm)	F Fixing holes (mm)		Scale Length (mm)	Weight (Approx) (Kgs)
3.25TA	100	5	54	10	92	SQ 81	DIA 7	140	0.5
4TA	128	5	67	-	114	103	7	140	0.75
6TA	175	5	86	-	163	142	6.2	190	1.4
TWINSET	175	5	86	18	163	142	6.2	190	1.6

Sealed to IP 54 with rear zero adjuster.  
 Finish - Semi gloss black  
 Operating temperature range - 25 °C to +50 °C