

WESTSIDE SUPPLIES



DC Power Jacks



INTRODUCTION

WESTSIDE SUPPLIES (01243) 860626

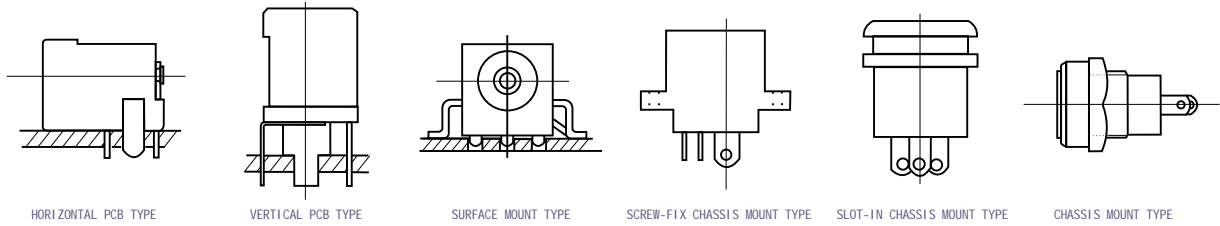

EIAJ RC-5320A SPECIFICATIONS

VOLTAGE CLASSIFICATION	RATED VOLTAGE DC NOMINAL VALUE (V)	RATED VOLTAGE (V)	RATED CURRENT (A)
1	$V \leq 3.15$	3.15	2
2	$3.15 < V \leq 6.3$	6.3	2
3	$6.3 < V \leq 10.5$	10.5	2
4	$10.5 < V \leq 13.5$	13.5	2
5	$13.5 < V \leq 18.0$	18.0	2

This catalogue provides a designer's reference for all DC connector needs. The comprehensive coverage includes all popular types & new innovations, together with some basic information to help select the appropriate version for a specific application.

With such a vast selection, some of the items will be available from stock, often without large minimum order quantities. However, if you do not see an item to meet your exact requirements, please contact the sales office for assistance.

EIAJ RC-5320A STANDARD MATING PLUG DIMENSIONS

VOLTAGE CLASSIFICATION	RATED VOLTAGE DC NOMINAL VALUE (V)	Diagram
1	$V \leq 3.15$	
2	$3.15 < V \leq 6.3$	
3	$6.3 < V \leq 10.5$	
4	$10.5 < V \leq 13.5$	
5	$13.5 < V \leq 18.0$	

DC POWER JACKS STANDARD MATING PLUG DIMENSIONS

	TYPE A PLUG
<p>Complying to: EIAJ RC-6705</p>	TYPE B PLUG
<p>Complying to IEC Publication 150-10</p>	TYPE C PLUG
	TYPE D PLUG
	TYPE E PLUG

EIAJ RC-5320A VOLTAGE CLASSIFICATION 1

WESTSIDE SUPPLIES (01243) 860626



HEC 4306-010010

h=2.2mm

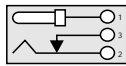
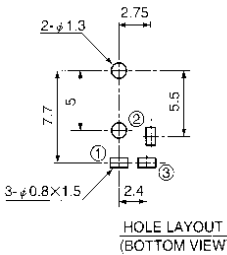
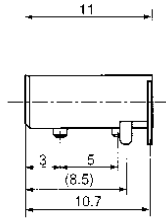
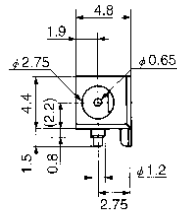
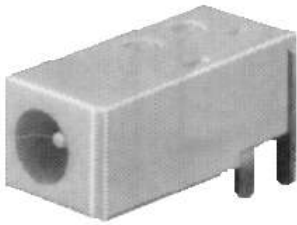

VOLTAGE CLASSIFICATION 1

HORIZONTAL
PCB MOUNT

HEC 3300-01-__10

h=3mm

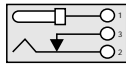
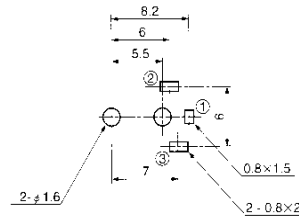
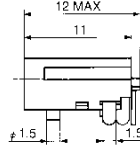
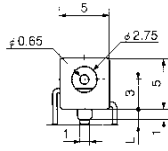

L=	PART NO
1.6mm	HEC 3300-01-010
2.5mm	HEC 3300-010110

VOLTAGE CLASSIFICATION 1

HORIZONTAL
PCB MOUNT

HEC 3301-010110

h=3mm

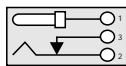
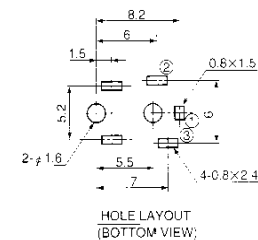
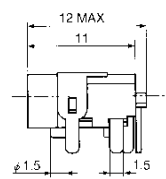
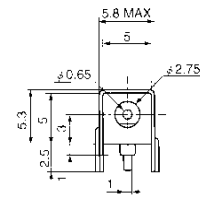
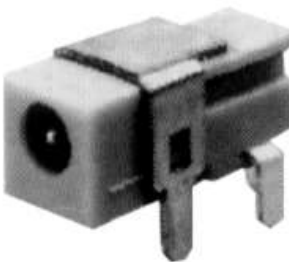

VOLTAGE CLASSIFICATION 1

HORIZONTAL
PCB MOUNT

HEC 3350-01_110

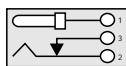
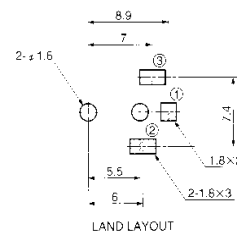
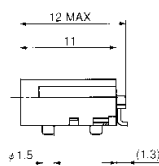
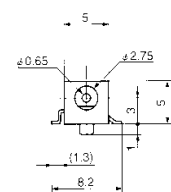
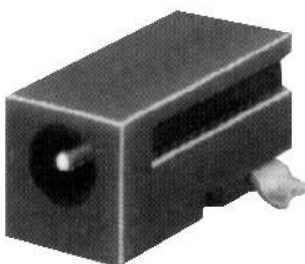

AVAILABLE TAPED & REELED

PACK	PART NO
BULK (hand soldering only)	HEC 3350-010110
TAPED (reflow soldering)	HEC 3350-012110

VOLTAGE CLASSIFICATION 1

SURFACE
MOUNT



EIAJ RC-5320A VOLTAGE CLASSIFICATION 1 & 2

WESTSIDE SUPPLIES (01243) 860626

CHASSIS MOUNT

MJ-16

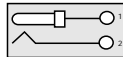
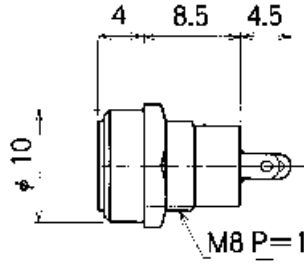

VOLTAGE CLASSIFICATION 1

HORIZONTAL PCB MOUNT

HEC 3604-010110

h=2.2mm

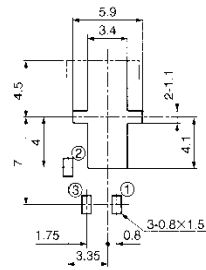
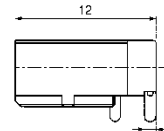
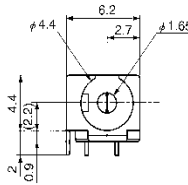

HOLE LAYOUT (BOTTOM VIEW)

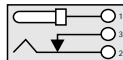

VOLTAGE CLASSIFICATION 2

HORIZONTAL PCB MOUNT

HEC 3600-010_10

h=3mm

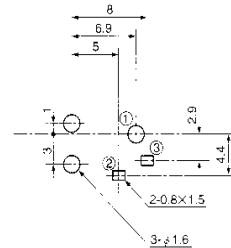
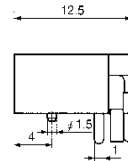
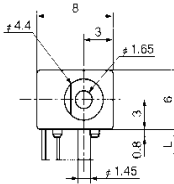
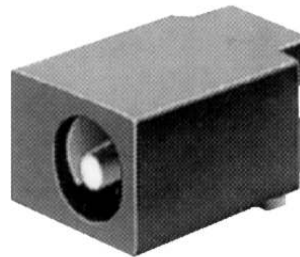

L=	PART NO
1.5mm	HEC 3600-010010
2.5mm	HEC 3600-010510
3.0mm	HEC 3600-010110

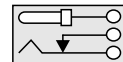

VOLTAGE CLASSIFICATION 2

HORIZONTAL PCB MOUNT

3

HEC 3690-010210

h=3mm

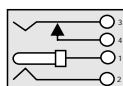
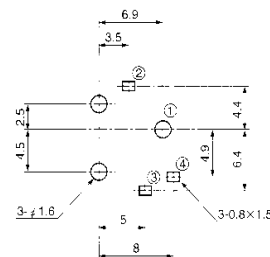
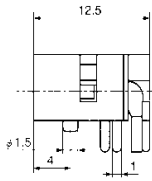
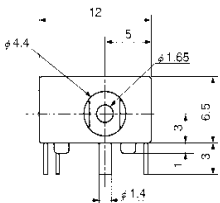
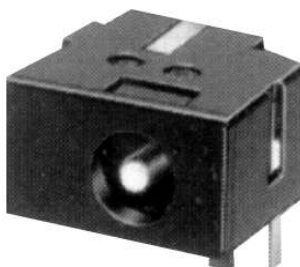

VOLTAGE CLASSIFICATION 2

EIAJ RC-5320A VOLTAGE CLASSIFICATION 2

WESTSIDE SUPPLIES (01243) 860626



HEC 3610-010010

h=6.5mm

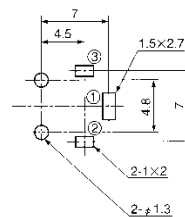
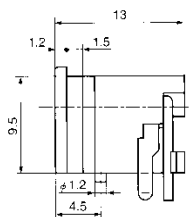
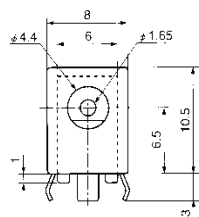
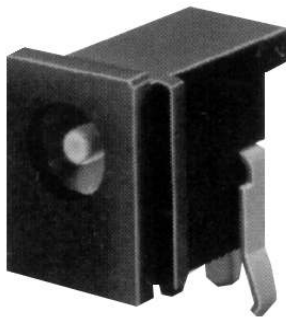

HOLE LAYOUT (BOTTOM VIEW)

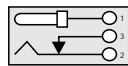

VOLTAGE CLASSIFICATION 2

HORIZONTAL PCB MOUNT

HEC 3680-010010

h=6.5mm

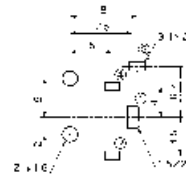
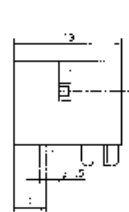
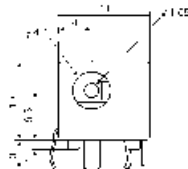
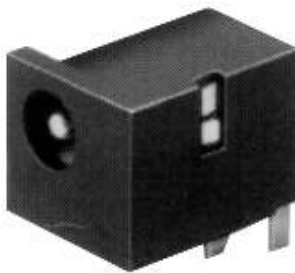

HOLE LAYOUT (BOTTOM VIEW)

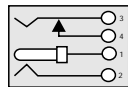

VOLTAGE CLASSIFICATION 2

HORIZONTAL PCB MOUNT

HEC 3650-01_010

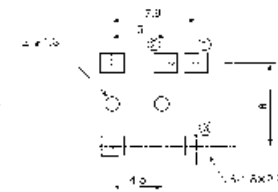
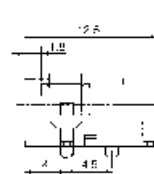
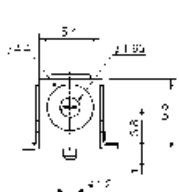
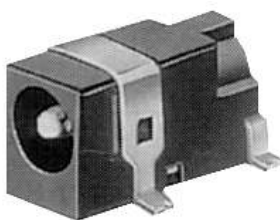

HOLE LAYOUT

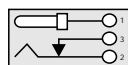

AVAILABLE TAPED & REELED

PACK	PART NO
BULK (reflow soldering only)	HEC 3650-010010
TAPED (reflow soldering)	HEC 3650-012010

VOLTAGE CLASSIFICATION 2

SURFACE MOUNT

HEC 4670-010010

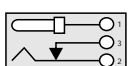
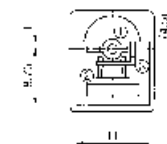
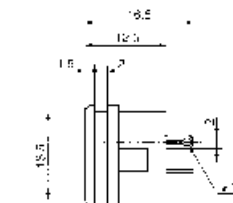
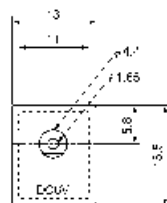

VOLTAGE CLASSIFICATION 2

SLOT IN CHASSIS MOUNT



EIAJ RC-5320A VOLTAGE CLASSIFICATION 2 & 3
WESTSIDE SUPPLIES (01243) 860626

CHASSIS
MOUNT

MJ-12

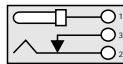
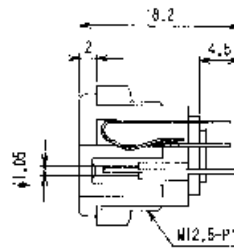
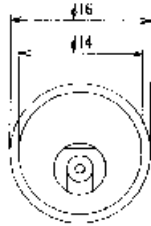

VOLTAGE CLASSIFICATION 2

CHASSIS
MOUNT

MJ-17

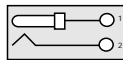
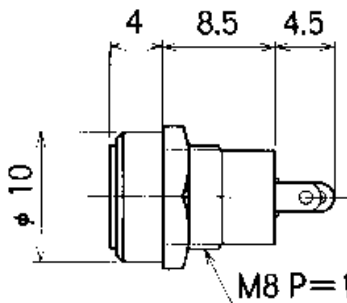

VOLTAGE CLASSIFICATION 2

HORIZONTAL
PCB MOUNT

HEC 3110-01-010

h=3mm

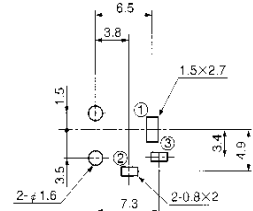
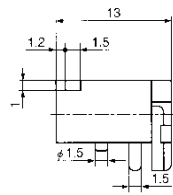
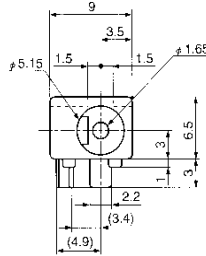
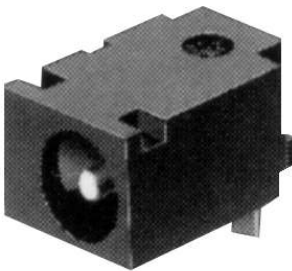

HOLE LAYOUT
(BOTTOM VIEW)

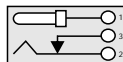

VOLTAGE CLASSIFICATION 3

HORIZONTAL
PCB MOUNT

HEC 4100-01-010

h=3mm

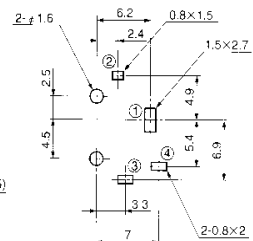
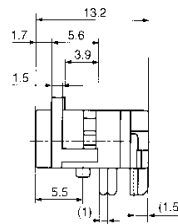
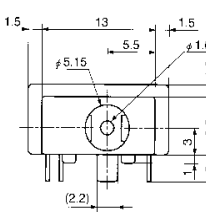
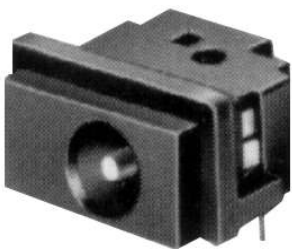

HOLE LAYOUT
(BOTTOM VIEW)

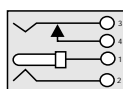

VOLTAGE CLASSIFICATION 3



EIAJ RC-5320A VOLTAGE CLASSIFICATION 3 & 4

WESTSIDE SUPPLIES (01243) 860626

CHASSIS MOUNT

MJ-13

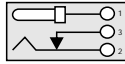
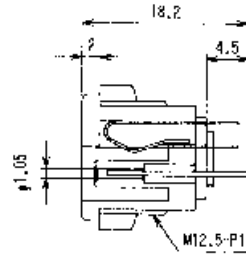
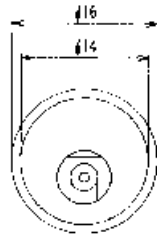

VOLTAGE CLASSIFICATION 3

CHASSIS MOUNT

MJ-18

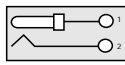
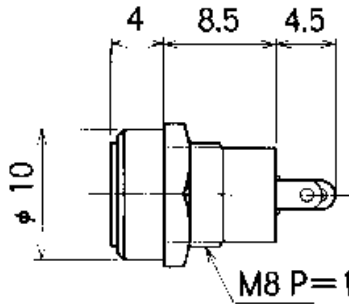

VOLTAGE CLASSIFICATION 3

HORIZONTAL PCB MOUNT

HEC 4801-010010

h=4mm

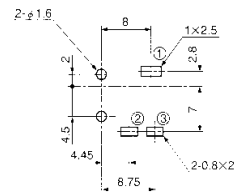
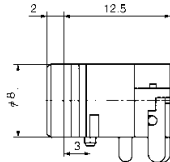
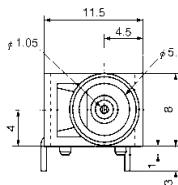
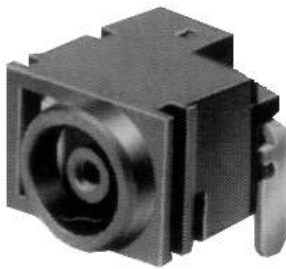

HOLE LAYOUT (BOTTOM VIEW)

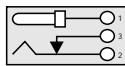

VOLTAGE CLASSIFICATION 4

HORIZONTAL PCB MOUNT
7

HEC 3800-01-010

h=6.5mm

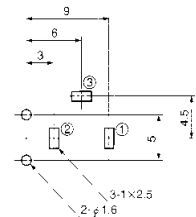
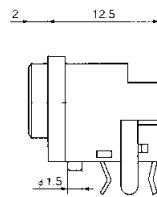
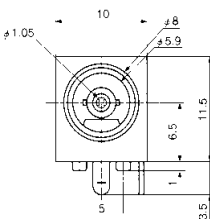
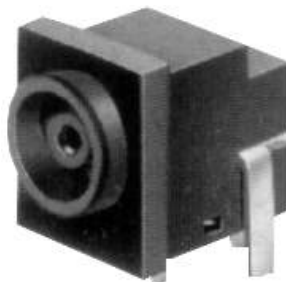

HOLE LAYOUT (BOTTOM VIEW)

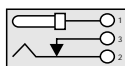

VOLTAGE CLASSIFICATION 4

EIAJ RC-5320A VOLTAGE CLASSIFICATION 4 & 5

WESTSIDE SUPPLIES (01243) 860626

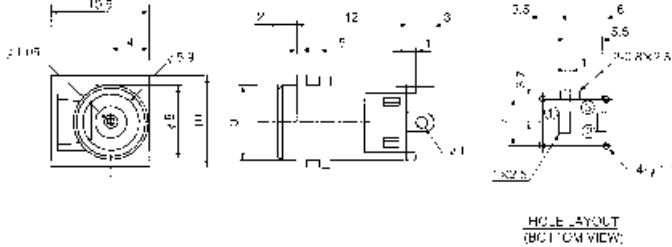

HEC 3830-010010

HOLE LAYOUT (BOTTOM VIEW)

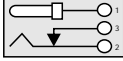

VOLTAGE CLASSIFICATION 4

VERTICAL PCB MOUNT

HEC 3850-01_010



SMD

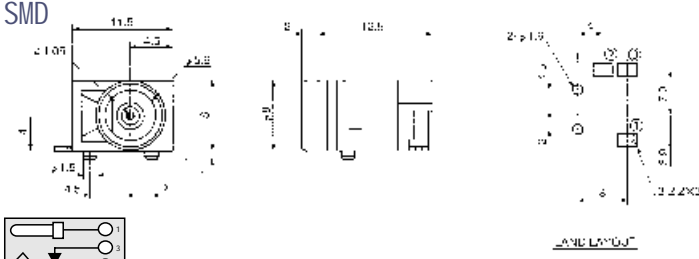

HOLE LAYOUT

PACK	PART NO
BULK (hand soldering only)	HEC 3850-010010
TAPED (reflow soldering)	HEC 3850-012010

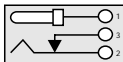

VOLTAGE CLASSIFICATION 4

SURFACE MOUNT

MJ-19

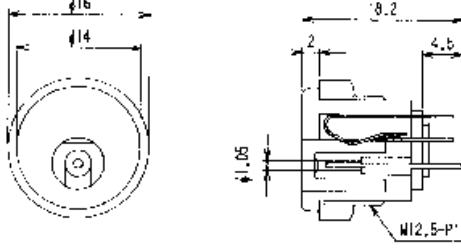
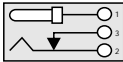



VOLTAGE CLASSIFICATION 4

CHASSIS MOUNT

HEC 3900-010110

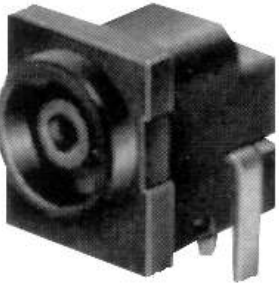
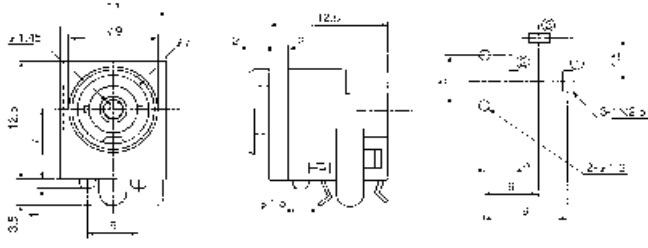
h=7mm

HOLE LAYOUT (BOTTOM VIEW)

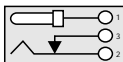

VOLTAGE CLASSIFICATION 5

HORIZONTAL PCB MOUNT



EIAJ RC-5320A VOLTAGE CLASSIFICATION 5

WESTSIDE SUPPLIES (01243) 860626

VERTICAL
PCB MOUNT

HEC 3930-010010

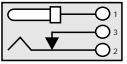
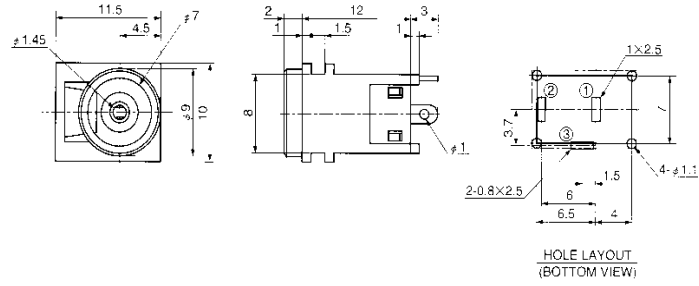

VOLTAGE CLASSIFICATION 5

CHASSIS
MOUNT

MJ-20

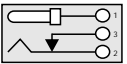
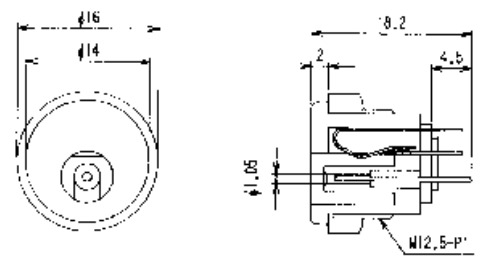

VOLTAGE CLASSIFICATION 5

DC POWER JACKS FOR USE WITH MATING PLUG A

HORIZONTAL
PCB MOUNT

AJ206_

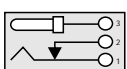
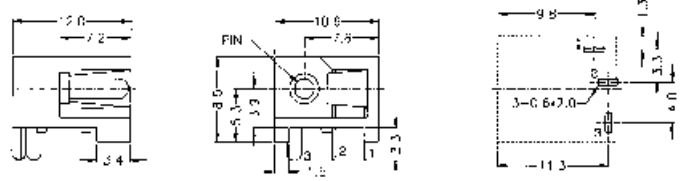

PIN DIA.	PART NO
2.00mm	AJ206A
2.50mm	AJ206B

MATING PLUG A

HORIZONTAL
PCB MOUNT

HTJ-020-04_

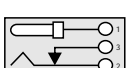
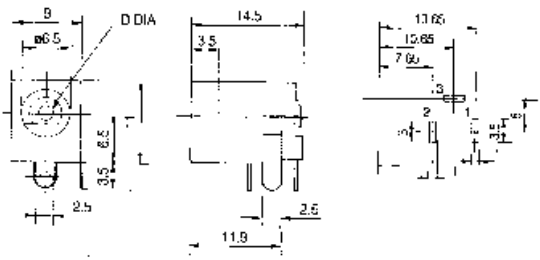

PIN DIA.	PART NO
2.00mm	HTJ-020-04A
2.35mm	HTJ-020-04B

MATING PLUG A

DC POWER JACKS FOR USE WITH MATING PLUG A

WESTSIDE SUPPLIES (01243) 860626



HTJ-020-05_

PIN DIA.	PART NO
2.00mm	HTJ-020-05A
2.35mm	HTJ-020-05B

MATING PLUG A

HORIZONTAL
PCB MOUNT

HEC 0779-010030 D=2mm

HOLE LAYOUT (BOTTOM VIEW)

MATING PLUG A

HORIZONTAL
PCB MOUNT

HEC 0721-01-020 D=2mm

HOLE LAYOUT (BOTTOM VIEW)

MATING PLUG A

HORIZONTAL
PCB MOUNT

HEC 0486-01-0_0

D=	PART NO
2.00mm	HEC0486-01-010
2.35mm	HEC0486-01-030

MATING PLUG A

VERTICAL
PCB MOUNT

10

DC POWER JACKS FOR USE WITH MATING PLUG A

WESTSIDE SUPPLIES (01243) 860626



DJ552_-05

PIN DIA.	PART NO
2.00mm	DJ5521-05
2.35mm	DJ5525-05

MATING PLUG A

SCREW THREAD
CHASSIS MOUNT

AJ230_

PIN DIA.	PART NO
2.00mm	AJ230A
2.50mm	AJ230B

MATING PLUG A

SCREW THREAD
CHASSIS MOUNT

MJ-10/MJ-11

PIN DIA.	PART NO
2.00mm	MJ-10
2.35mm	MJ-11

MATING PLUG A

CHASSIS
MOUNT

MJ-14/MJ-15

PIN DIA.	PART NO
2.00mm	MJ-14
2.35mm	MJ-15

MATING PLUG A

CHASSIS
MOUNT



DC POWER JACKS FOR USE WITH MATING PLUG B & C

WESTSIDE SUPPLIES (01243) 860626

HORIZONTAL
PCB MOUNT

HEC 0739-01-010

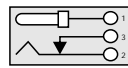
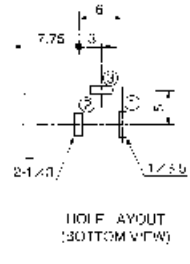
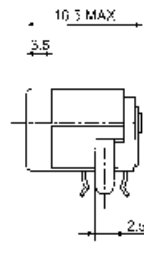
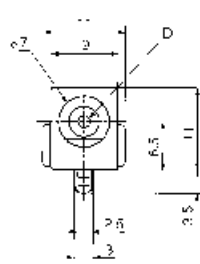

D=1.87mm

MATING PLUG B

SCREW FIT
CHASSIS MOUNT

HEC 0756-010010

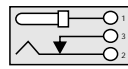
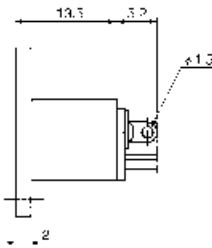
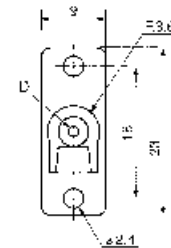

D=1.87mm

MATING PLUG B

SLOT IN
CHASSIS MOUNT

HEC 0003-010010

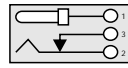
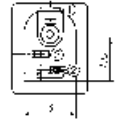
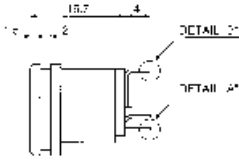
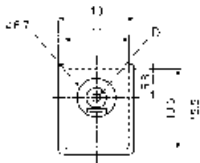

D=1.87mm

MATING PLUG B

HORIZONTAL
PCB MOUNT

AJ218_C

AJ218_



PCB RETAINING LEGS

STRAIGHT LEGS

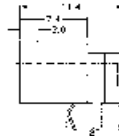
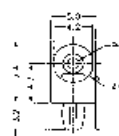

	PIN DIA.	PART NO
STRAIGHT LEGS	1.00mm	AJ-218A
PCB RET. LEGS	1.00mm	AJ-218AC
STRAIGHT LEGS	1.30mm	AJ-218B
PCB RET. LEGS	1.30mm	AJ-218BC

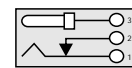

MATING PLUG C

DC POWER JACKS FOR USE WITH MATING PLUG C & D

WESTSIDE SUPPLIES (01243) 860626



AJ219_

STRAIGHT LEGS

AJ219_C

PCB RETAINING LEGS

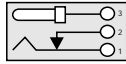
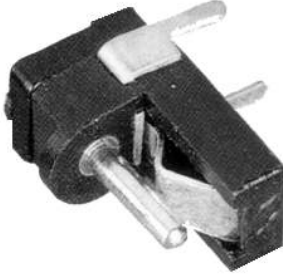

	PIN DIA.	PART NO
STRAIGHT LEGS	1.00mm	AJ-219A
PCB RET. LEGS	1.00mm	AJ-219AC
STRAIGHT LEGS	1.30mm	AJ-219B
PCB RET. LEGS	1.30mm	AJ-219BC

MATING PLUG C

HORIZONTAL
PCB MOUNT

AJ220_

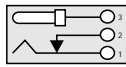
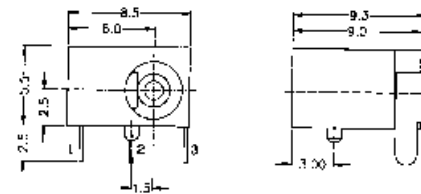

PIN DIA.	PART NO
1.00mm	AJ220A
1.30mm	AJ220B

MATING PLUG C

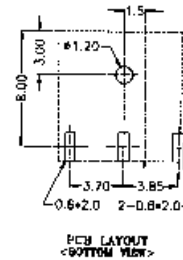

HORIZONTAL
PCB MOUNT

AJ224

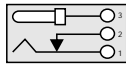
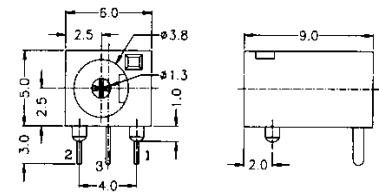

MATING PLUG C

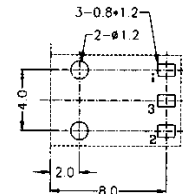

HORIZONTAL
PCB MOUNT

HEC 0740-010618

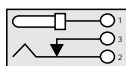
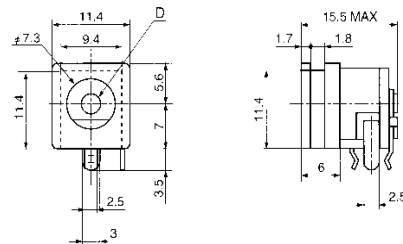

D=2.95mm

MATING PLUG D

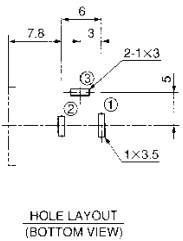

SLOT IN PCB
HORIZONTAL



DC POWER JACKS FOR USE WITH MATING PLUG D & E

WESTSIDE SUPPLIES (01243) 860626

SLOT IN PCB
VERTICAL

HEC 0780-010010

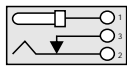
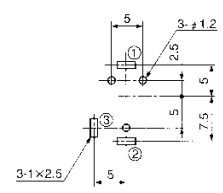
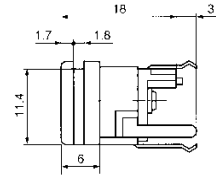
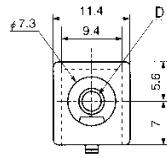

D=2.95mm

MATING PLUG D

SLOT IN
CHASSIS MOUNT

HEC 0738-010010

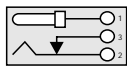
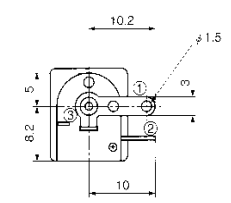
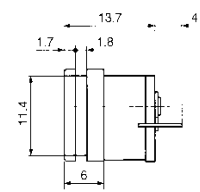
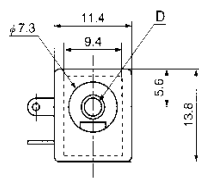
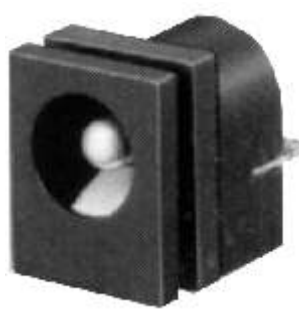

D=2.95mm

MATING PLUG D

HORIZONTAL
PCB MOUNT

HEC 2711-01-20

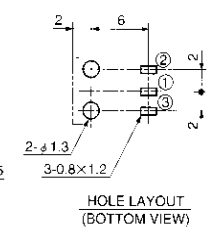
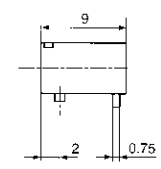
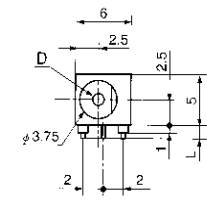

D=1.3mm

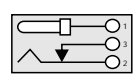

L=	PART NO
1.50mm	HEC 2711-01-020
3.00mm	HEC 2711-01-620

MATING PLUG E

HORIZONTAL
PCB MOUNT

HEC 2712-01-20

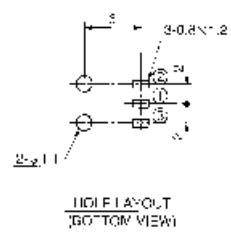
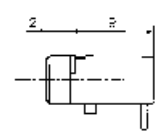
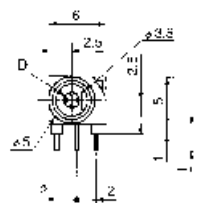

D=1.3mm

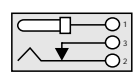

L=	PART NO
1.50mm	HEC 2712-010120
3.00mm	HEC 2712-01-620

MATING PLUG E

DC POWER JACKS FOR USE WITH MATING PLUG E

WESTSIDE SUPPLIES (01243) 860626



HEC 2751-01-620

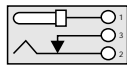
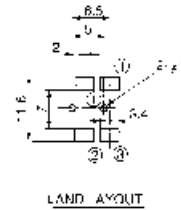
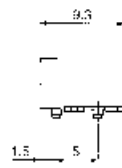
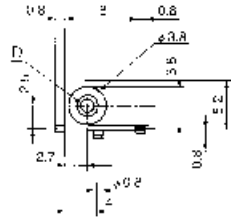

D=1.3mm

MATING PLUG E

SURFACE MOUNT

CABLE MOUNT IN LINE SOCKETS

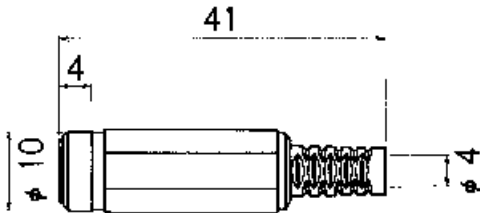

PART NUMBERS TO MATE WITH:

MATING PLUG TYPE:

- A MJ-077N (5.5 x 2.1)
- A MJ-078N (5.5 x 2.5)
- E MJ-099N

EIAJ RC-5320A VOLTAGE CLASSIFICATION:

- 1 MJ-095N
- 2 MJ-096N
- 3 MJ-097N

MOULDED LEAD ASSEMBLIES



We can supply a version of all the DC jack plugs shown within this catalogue, moulded onto your own specification and length of cable.

Styles and shapes vary and those shown here represent only a small selection.

Please contact the sales office for further information, pricing and details of MOQ (if applicable).



REWIREABLE EIAJ RC-5320A PLUGS

WESTSIDE SUPPLIES (01243) 860626

VOLTAGE CLASSIFICATION 1

MP-201 STRAIGHT WITH STRAIN RELIEF



MP-201L RIGHT ANGLE

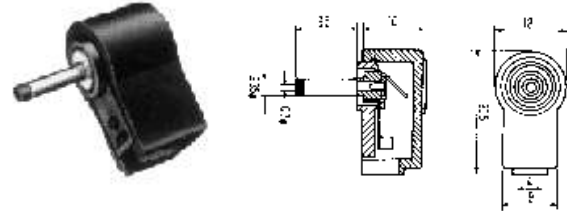

VOLTAGE CLASSIFICATION 2

MP-202 STRAIGHT WITH STRAIN RELIEF



MP-202L RIGHT ANGLE

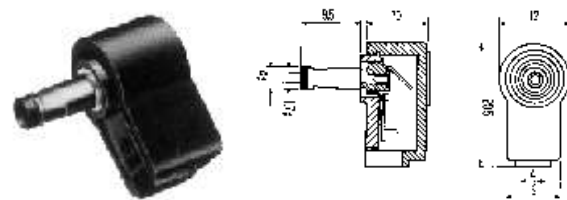

VOLTAGE CLASSIFICATION 3

MP-203 STRAIGHT WITH STRAIN RELIEF



MP-203L RIGHT ANGLE

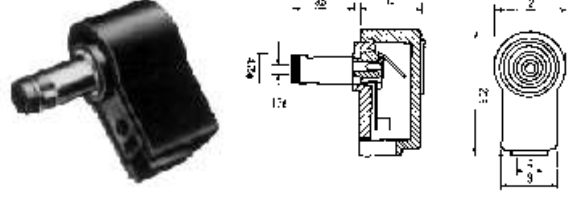

VOLTAGE CLASSIFICATION 4

MP-204 STRAIGHT WITH STRAIN RELIEF



MP-204L RIGHT ANGLE

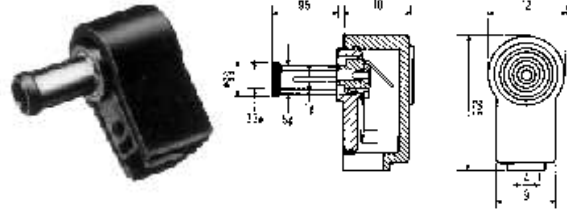

VOLTAGE CLASSIFICATION 5

MP-205 STRAIGHT WITH STRAIN RELIEF



The WSL extensive product range includes:

- Audio Connectors & Terminations
- Battery Connectors & Holders
- BNC Connectors
- DC Power Jacks
- DIN Connectors
- Equipment Feet
- Mains Cables & Connectors
- RF Connectors
- Screw Terminals
- Switches & Potentiometers
- Telephone & Communication Jacks
- Terminal Blocks
- Transistor Holders & Bushings
- Custom moulded leads & rewireable plugs/sockets (including BNC, D, DC & audio jacks, din, mini-din & phono types)

We are also able to offer a custom design & specific sourcing service for all your connector requirements.



**WESTSIDE
SUPPLIES
LIMITED**

**'WESTSIDE'
SHRIPNEY ROAD
BOGNOR REGIS
WEST SUSSEX
UNITED KINGDOM
PO22 9NX**

TEL: +44 (0) 1243 860626

FAX: +44 (0) 1243 866626

EMAIL: sales@westside-supplies.co.uk

WEB: www.westside-supplies.co.uk