

# WESTSIDE SUPPLIES



Battery Contacts & Holders



# Battery Connectors & Holders

A range of holders, from manufacturers such as Ace Sound, Chitose and Ishikawa, for every battery size and popular configurations; all available with or without flying leads. Add to this, a vast selection of battery springs and dimples in tin plated steel or beryllium copper, as well as battery snaps & crocodile clips, and WSL offers an extensive collection. However, customised parts or individually designed and manufactured items, subject to minimum quantities, are also available to meet unusual needs.

## CONTENTS

<b>Contacts for AAA Cells</b>	<b>2-8</b>
<b>Contacts for AA Cells</b>	<b>9-20</b>
<b>Contacts for C Cells</b>	<b>21-23</b>
<b>Contacts for D Cells</b>	<b>24-28</b>
<b>Holders for AAA &amp; N Cells</b>	<b>29</b>
<b>Holders for N &amp; AA Cells</b>	<b>30-31</b>
<b>Holders for AA, 1/2AA &amp; PP3 Cells</b>	<b>32</b>
<b>Holders for C Cells</b>	<b>33</b>
<b>Holders for D Cells</b>	<b>34</b>
<b>Contacts for Coin Cells &amp; PP3 Snaps</b>	<b>35</b>
<b>Holders for Coin Cells</b>	<b>36</b>
<b>Crocodile clips</b>	<b>37-38</b>
<b>Battery clips</b>	<b>39</b>
<b>Custom designs</b>	<b>40</b>

## NOTATION IN BROCHURE

<b>Semi-Shear</b>	
<b>Springs</b>	
<b>Dimples</b>	

# Contacts for AAA cells



**30326**

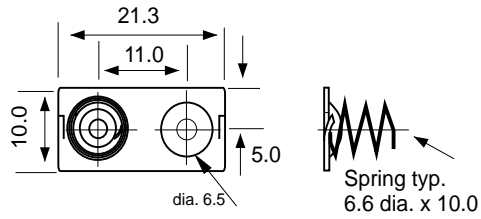

DOUBLE PLATE  
SPRING & DIMPLE

**30316**

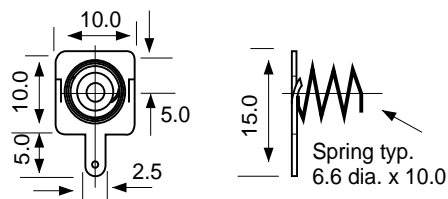

**30306**

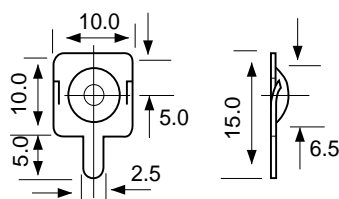

SINGLE PLATE  
SPRING & DIMPLE  
WITH SOLDER TAG

**71093**

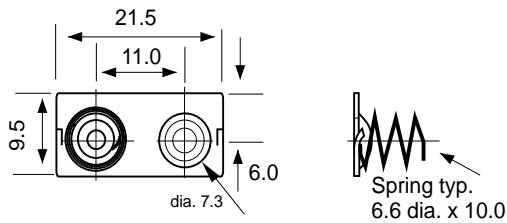

DOUBLE PLATE  
SPRING & DIMPLE

**71092**

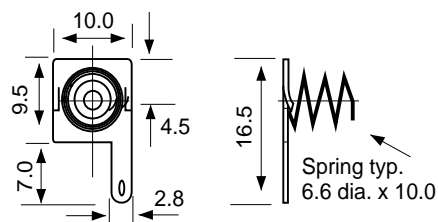

**71091**

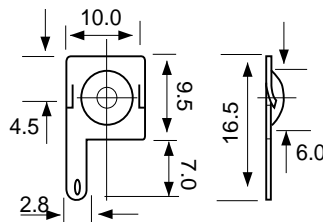

SINGLE PLATE  
SPRING & DIMPLE  
WITH SOLDER TAG

**70995**

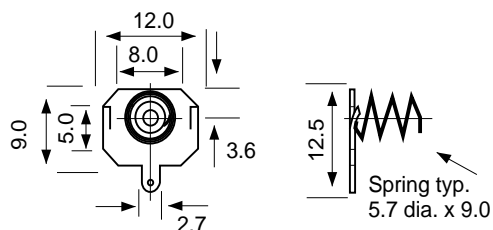

**70993**

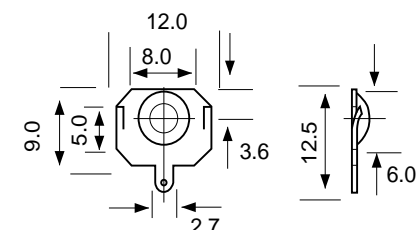

SINGLE PLATE  
SPRING & DIMPLE  
WITH SOLDER TAG



# Contacts for AAA cells

SINGLE PLATE  
SPRING & DIMPLE

**71083**

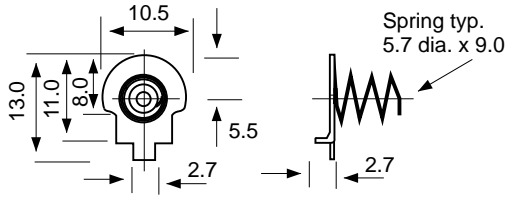

**71082**

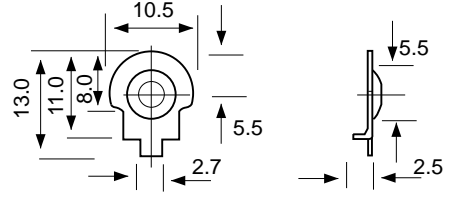

DOUBLE PLATE  
SPRING & DIMPLE

**71173**

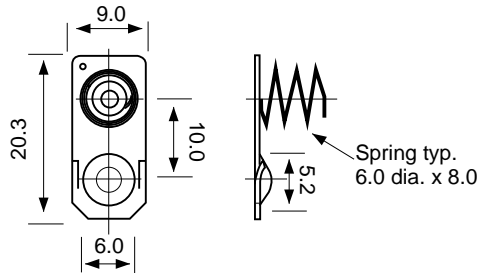

**70969**

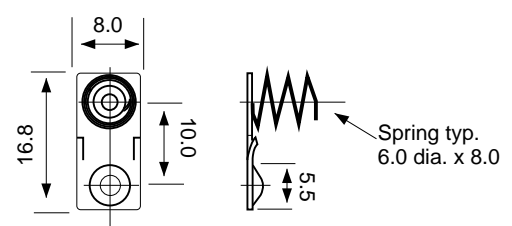

DOUBLE PLATE  
SPRING & DIMPLE

**70980**

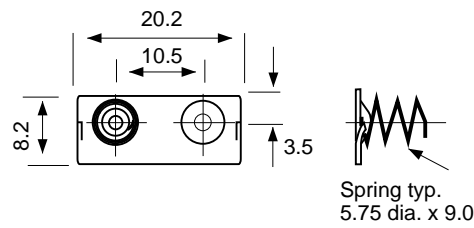

SINGLE PLATE  
SPRING & DIMPLE  
WITH SOLDER TAG

**70979**

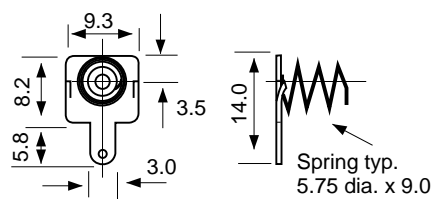

**70978**

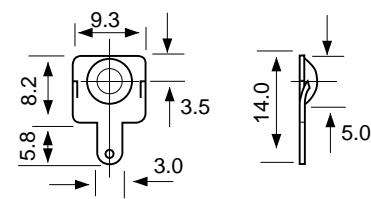

SINGLE PLATE  
SPRING & DIMPLE  
WITH SOLDER TAG

**71112**

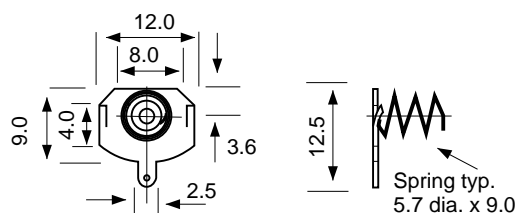

**71111**

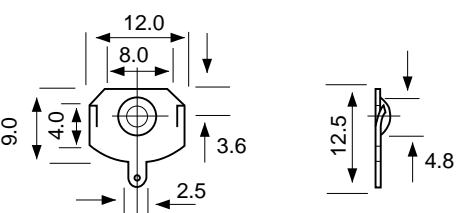

# Contacts for AAA cells



**40423**

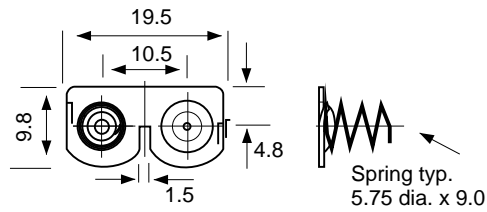

DOUBLE PLATE  
SPRING & DIMPLE

**40413**

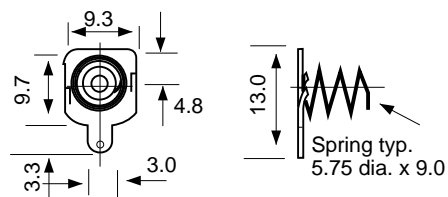

**40403**

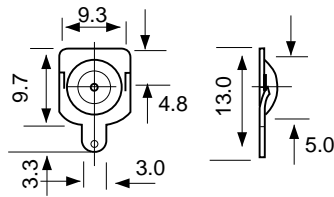

SINGLE PLATE  
SPRING & DIMPLE  
WITH SOLDER TAG

**70933**

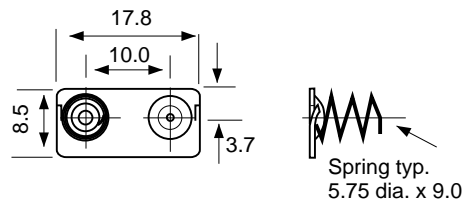

DOUBLE PLATE  
SPRING & DIMPLE

**70932**

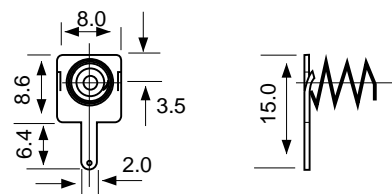

**70931**

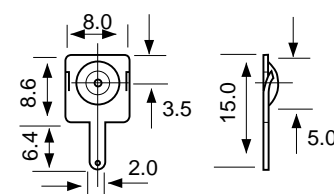

SINGLE PLATE  
SPRING & DIMPLE  
WITH SOLDER TAG

**71125**

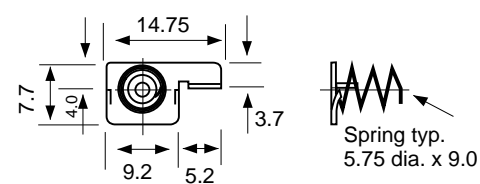

**71123**

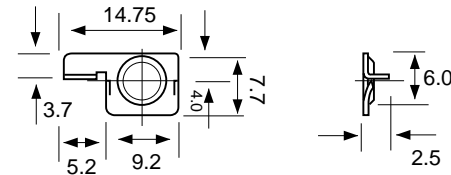

SINGLE PLATE  
SPRING & DIMPLE  
FOR PCB EDGE MOUNT

for all your battery contact requirements.



# Contacts for AAA cells

DOUBLE PLATE  
SPRING & DIMPLE  
WITH SOLDER TAG

**71102**

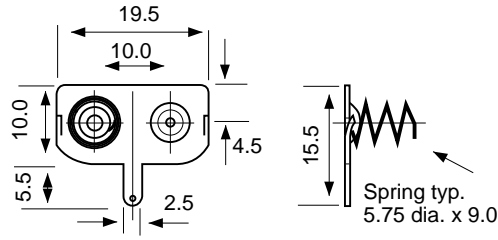

SINGLE PLATE  
SPRING & DIMPLE  
WITH SOLDER TAG

**71201**

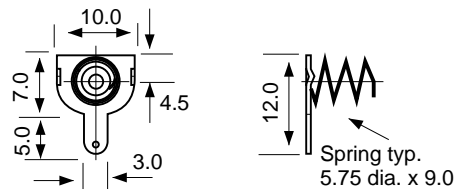

**71200**

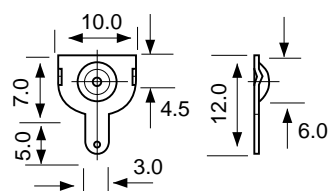

SINGLE PLATE  
SPRING & DIMPLE  
FOR PCB EDGE MOUNT

**71122**

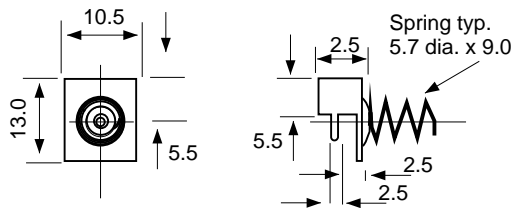

**71121**

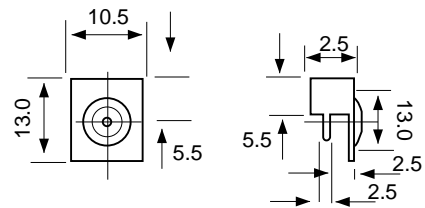

SINGLE PLATE  
LEAF & DIMPLE  
FOR PCB EDGE MOUNT

**40402**

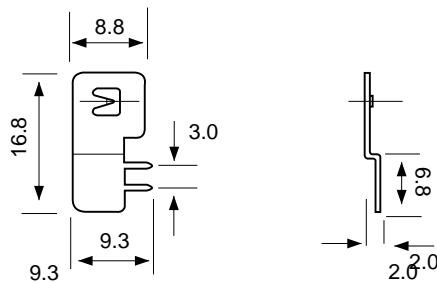

**40412**

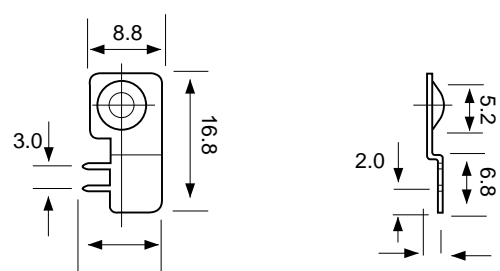

SINGLE PLATE  
LEAF & DIMPLE  
FOR PCB EDGE MOUNT

**00665**

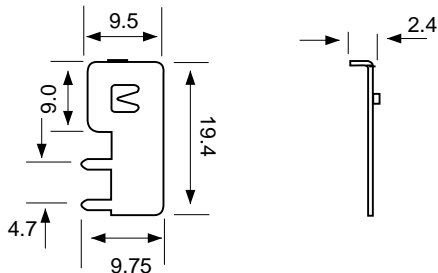

**00663**

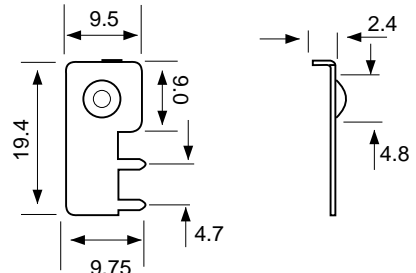

# Contacts for AAA cells



**01242**

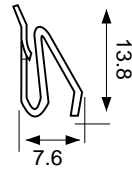
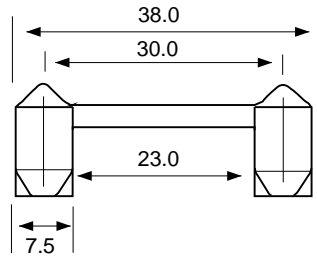

**01243**

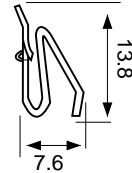
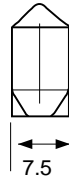

DOUBLE PLATE LEAF  
SINGLE PLATE LEAF

**71109**

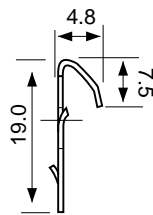
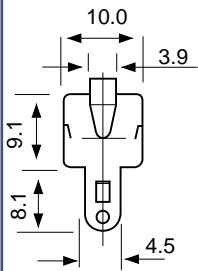

**00822**

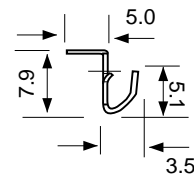
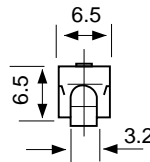

SINGLE PLATE  
LEAF WITH SOLDER TAG  
SINGLE PLATE  
LEAF

**71200**

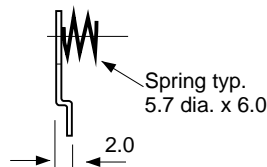
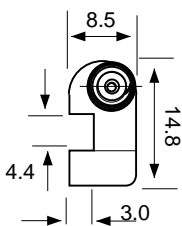

**71201**

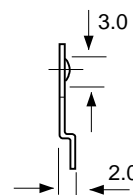
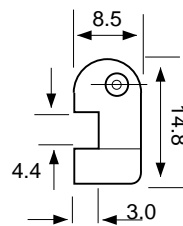

SINGLE PLATE  
SPRING & DIMPLE

**71260**

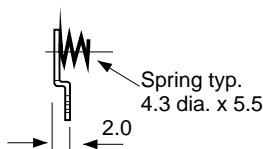
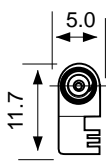

**71259**

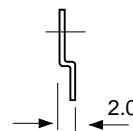
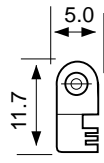

SINGLE PLATE  
SPRING & DIMPLE  
FOR PCB EDGE MOUNT

**00555-1**

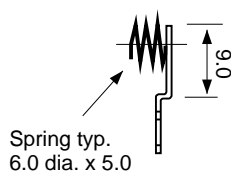
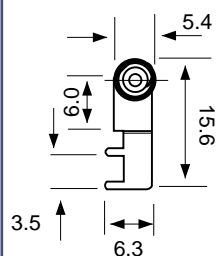

**00553**

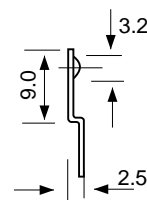
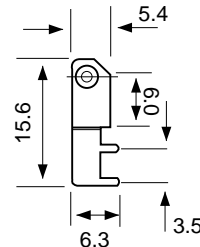

SINGLE PLATE  
SPRING & DIMPLE  
FOR PCB EDGE MOUNT

for all your battery contact requirements.



# Contacts for AAA cells

SINGLE PLATE  
DIMPLE LEFT & RIGHT  
FOR PCB EDGE MOUNT

**00478**

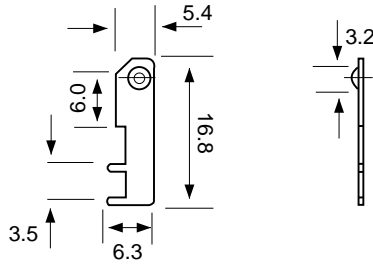

**00479**

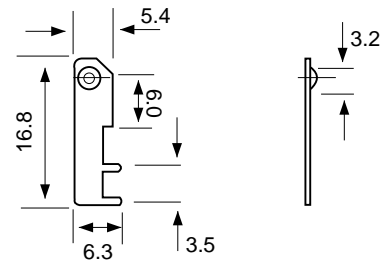

DOUBLE PLATE LEAF  
WITH SOLDER TAG  
SINGLE PLATE LEAF  
WITH SOLDER TAG

**71070**

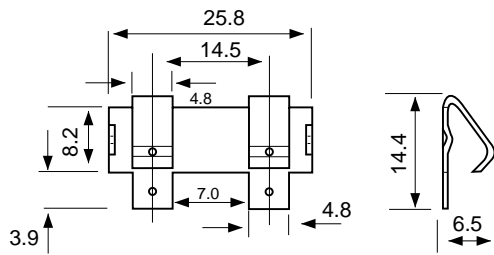

**71069**

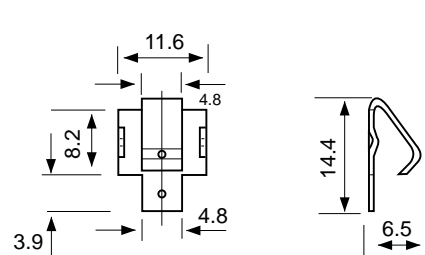

DOUBLE PLATE LEAF &  
DIMPLE WITH  
SOLDER TAG  
SINGLE PLATE DIMPLE  
WITH SOLDER TAG

**01141**

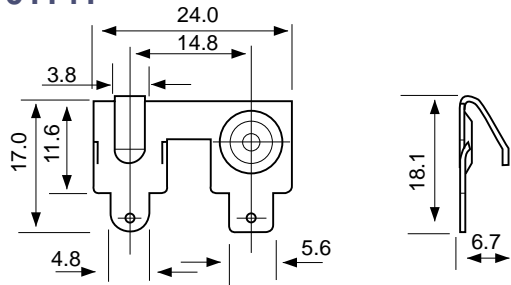

**01139**

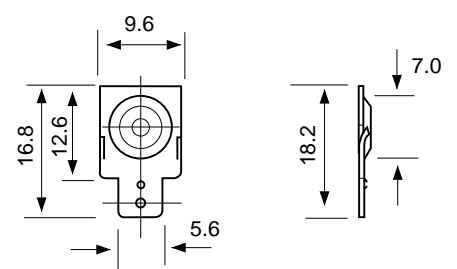

DOUBLE PLATE LEAF  
SINGLE PLATE LEAF

**01277**

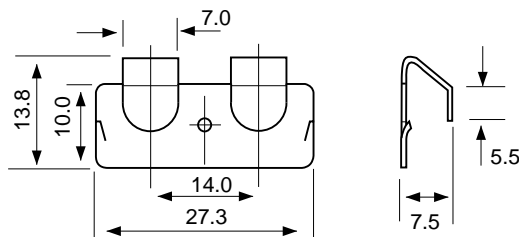

**00609**

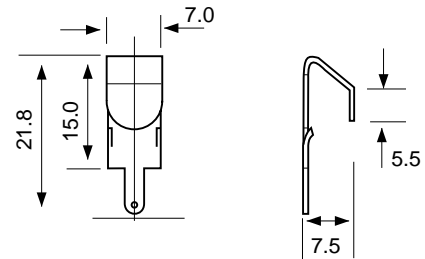

DOUBLE PLATE LEAF &  
DIMPLE WITH  
SOLDER TAG  
SINGLE PLATE LEAF  
WITH SOLDER TAG

**01142**

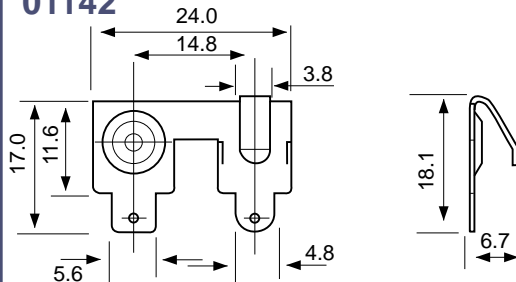

**01140**

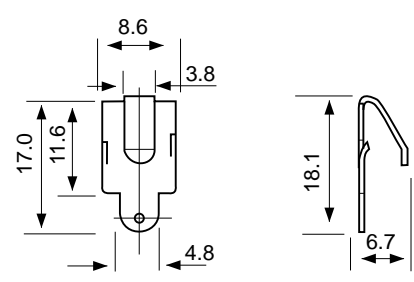



# Contacts for AAA cells



**01249**

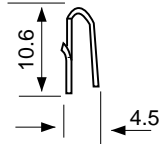
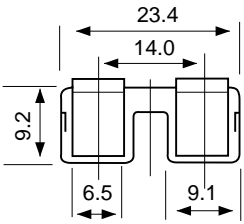

**01253**

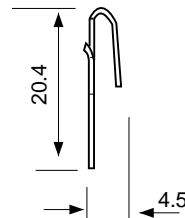
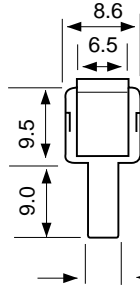

DOUBLE PLATE LEAF

SINGLE PLATE LEAF

**71109**

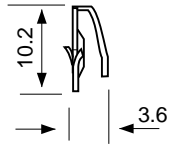
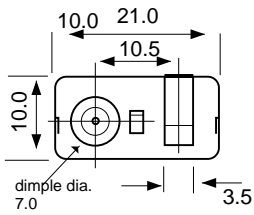

**00822**

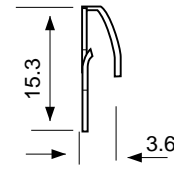
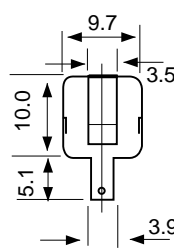

DOUBLE PLATE  
DIMPLE & LEAF

SINGLE PLATE LEAF  
WITH SOLDER TAG

**70906**

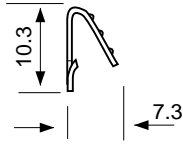
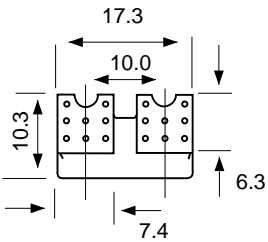

**70905**

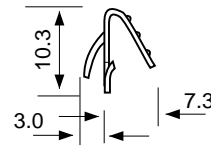
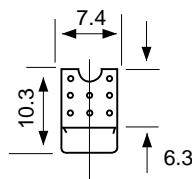

DOUBLE PLATE LEAF

SINGLE PLATE LEAF

**01011**

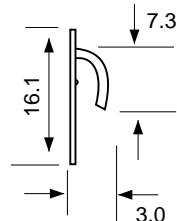
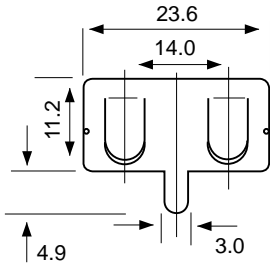

**01010**

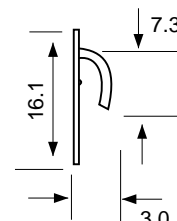
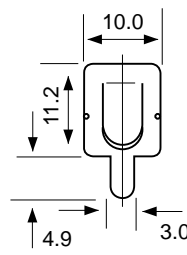

DOUBLE PLATE LEAF  
WITH SOLDER TAG

SINGLE PLATE LEAF  
WITH SOLDER TAG



# Contacts for AA cells

DOUBLE PLATE  
SPRING & DIMPLE  
WITH SOLDER TAG

**71043**

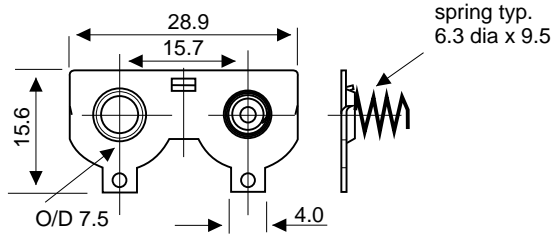

SINGLE PLATE SPRING  
WITH SOLDER TAG  
SINGLE PLATE DIMPLE  
WITH SOLDER TAG

**71041**

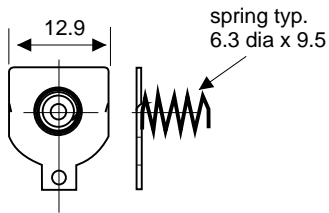

**71040**

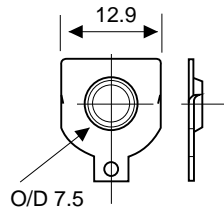

DOUBLE PLATE  
DIMPLE & SPRING

**30338**

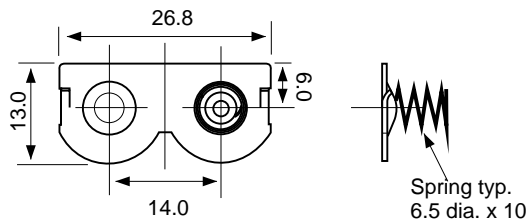

SINGLE PLATE SPRING  
WITH SOLDER TAG  
SINGLE PLATE DIMPLE  
WITH SOLDER TAG

**30318**

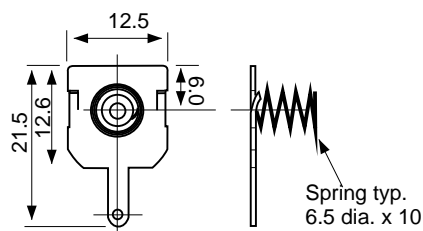

**30308**

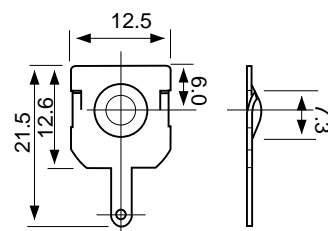

DOUBLE PLATE  
SPRING & DIMPLE  
WITH SOLDER TAGS

**71242**

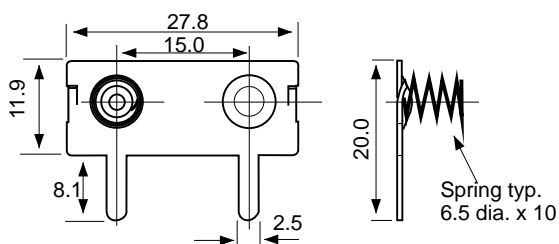

# Contacts for AA cells



**71228**

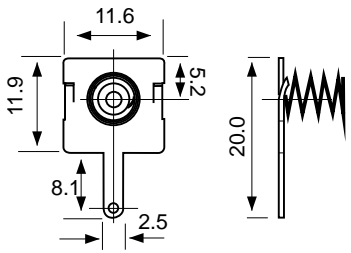

**71209**

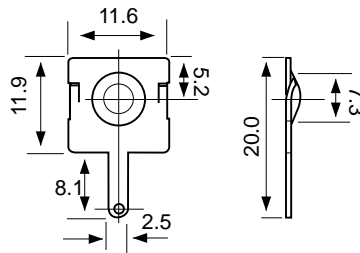

SINGLE PLATE SPRING WITH SOLDER TAG  
SINGLE PLATE DIMPLE WITH SOLDER TAG

**30353**

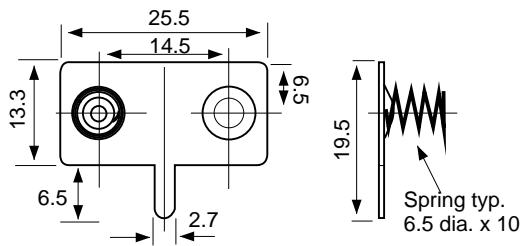

DOUBLE PLATE SPRING & DIMPLE WITH SOLDER TAG

**30320**

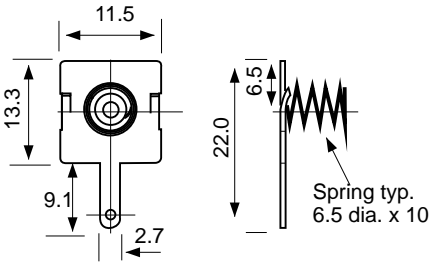

**30310**

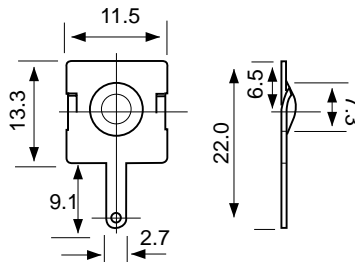

SINGLE PLATE SPRING WITH SOLDER TAG  
SINGLE PLATE DIMPLE WITH SOLDER TAG

**30323**

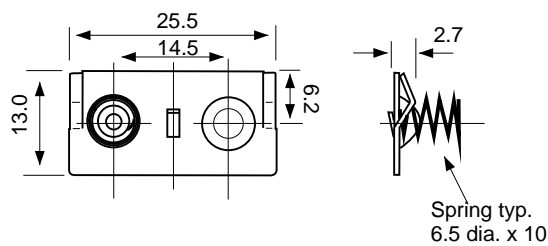

DOUBLE PLATE SPRING & DIMPLE WITH SOLDER TAG

**30313**

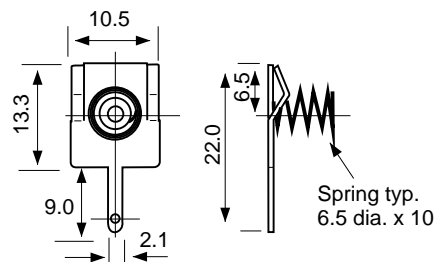

**30303**

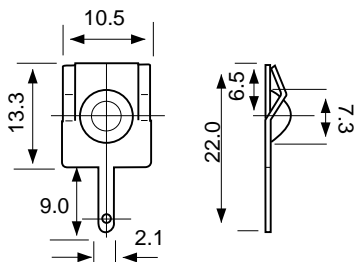

SINGLE PLATE SPRING WITH SOLDER TAG  
SINGLE PLATE DIMPLE WITH SOLDER TAG

for all your battery contact requirements.



# Contacts for AA cells

**DOUBLE PLATE  
SPRING & DIMPLE  
WITH SOLDER TAG**

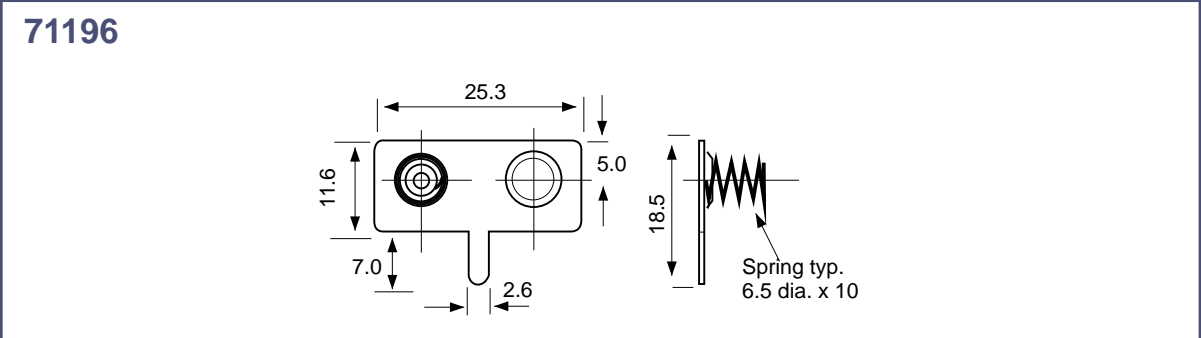

**SINGLE PLATE SPRING  
WITH SOLDER TAG**  
**SINGLE PLATE DIMPLE  
WITH SOLDER TAG**

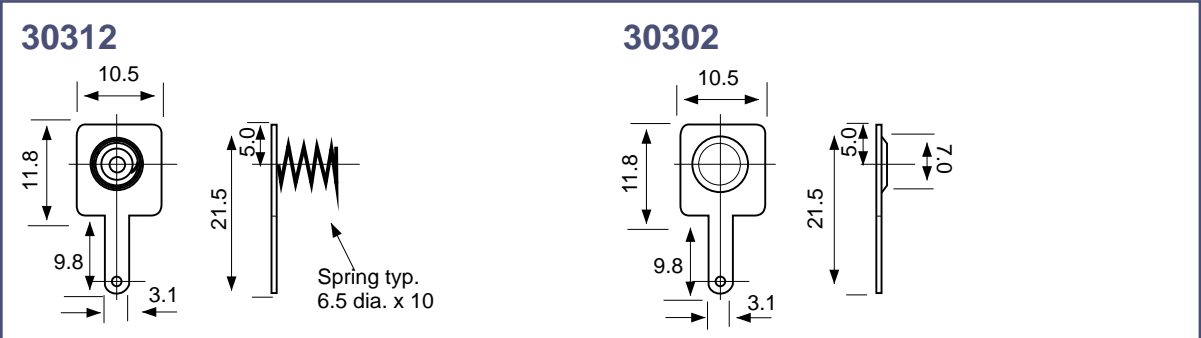

**DOUBLE PLATE  
SPRING & DIMPLE**

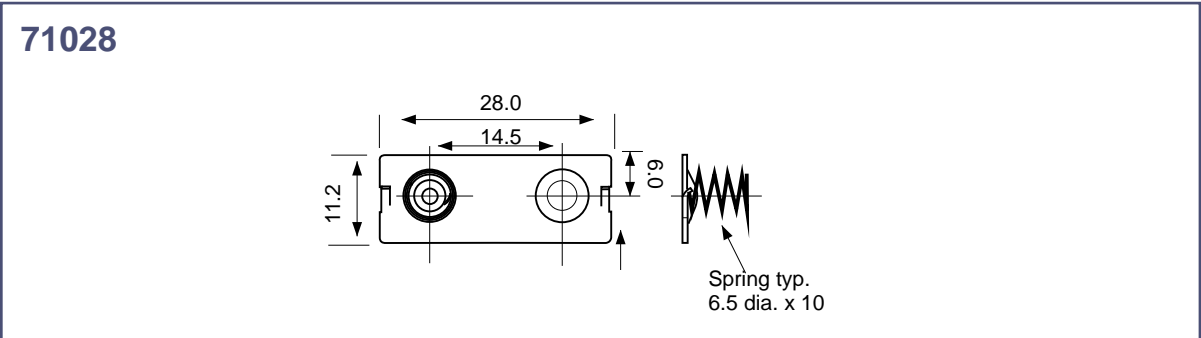

**SINGLE PLATE SPRING**  
**SINGLE PLATE DIMPLE**

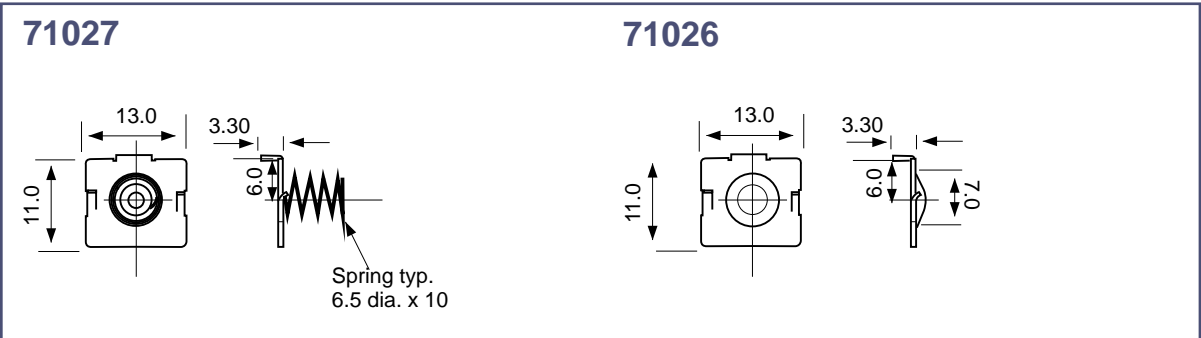

**DOUBLE PLATE  
SPRING & DIMPLE**

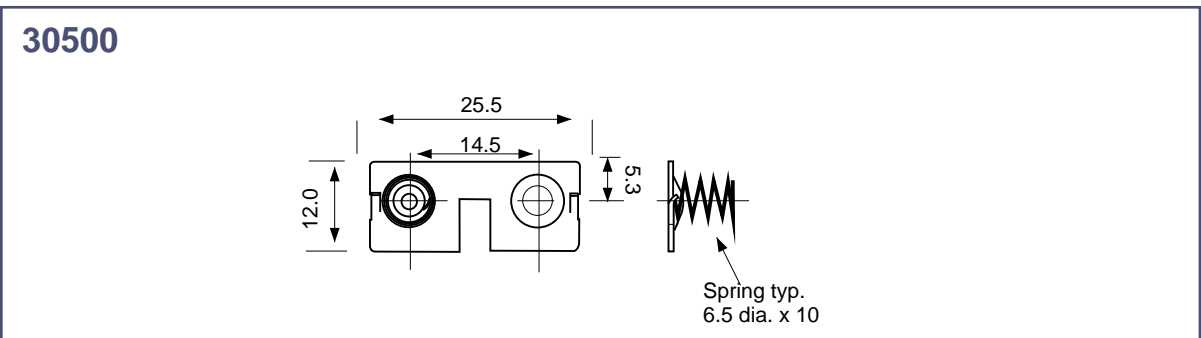

# Contacts for AA cells



**30400**

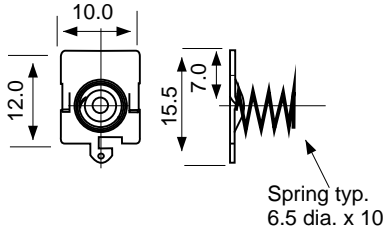

**30300**

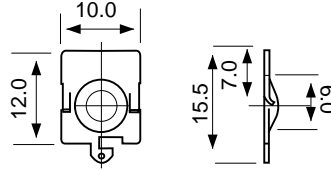

SINGLE PLATE SPRING  
WITH SOLDER TAG  
SINGLE PLATE DIMPLE  
WITH SOLDER TAG

**71009**

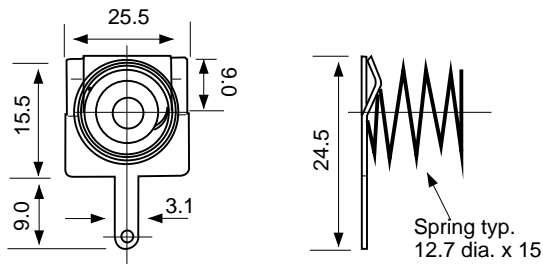

**71008**

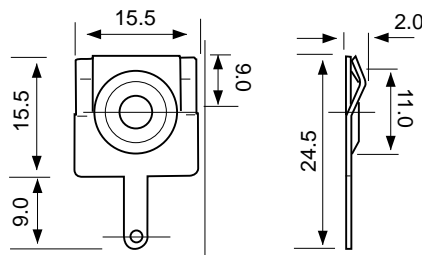

SINGLE PLATE SPRING  
WITH SOLDER TAG  
SINGLE PLATE DIMPLE  
WITH SOLDER TAG

**30337**

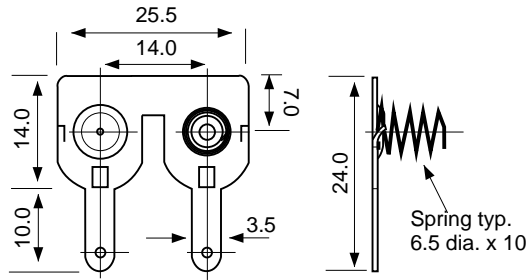

DOUBLE PLATE  
DIMPLE & SPRING  
WITH SOLDER TAGS

**30317**

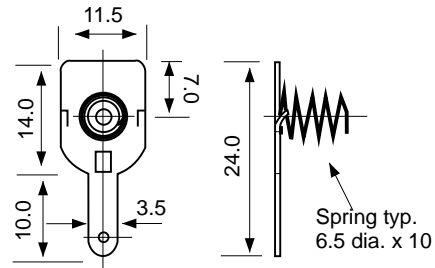

**30307**

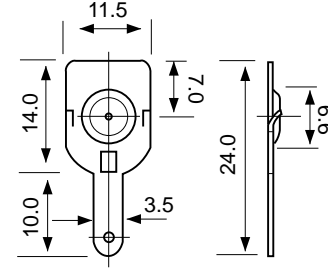

SINGLE PLATE SPRING  
WITH SOLDER TAG  
SINGLE PLATE DIMPLE  
WITH SOLDER TAG

**71067**

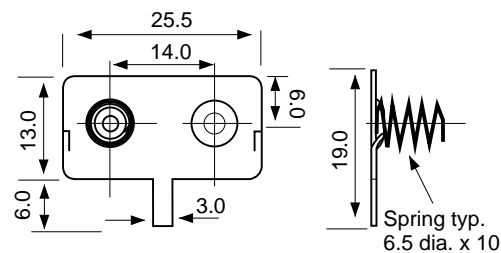

DOUBLE PLATE  
DIMPLE & DIMPLE  
SPRING & DIMPLE  
WITH SOLDER TAG

for all your battery contact requirements.



# Contacts for AA cells

SINGLE PLATE SPRING WITH SOLDER TAG  
SINGLE PLATE DIMPLE WITH SOLDER TAG

**71066**

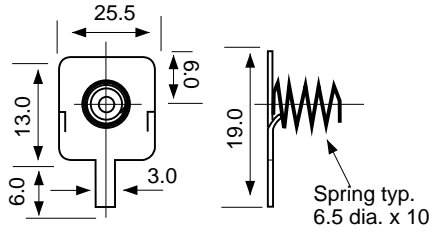

**71065**

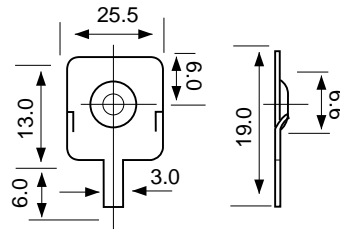

DOUBLE PLATE SPRING & DIMPLE

**70998**

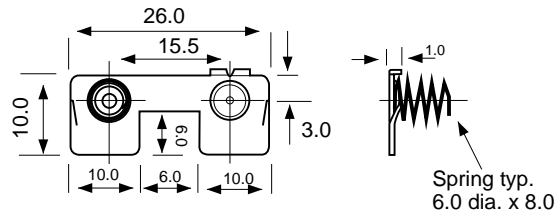

SINGLE PLATE SPRING  
SINGLE PLATE DIMPLE

**70996-1**

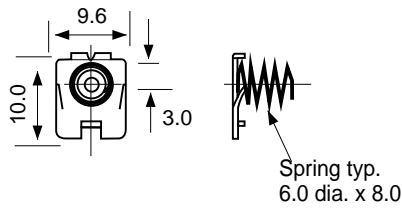

**70996**

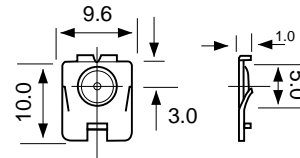

DOUBLE PLATE DIMPLE & SPRING WITH SOLDER TAG

**70963**

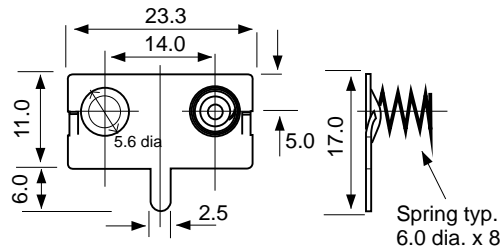

SINGLE PLATE SPRING WITH SOLDER TAG  
SINGLE PLATE DIMPLE WITH SOLDER TAG

**70961**

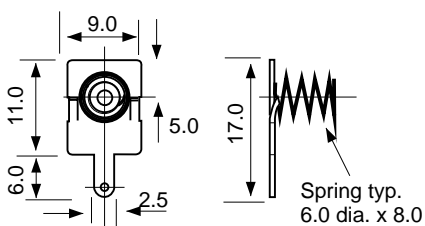

**70960**

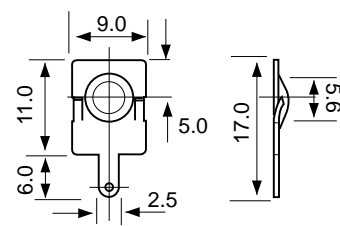

# Contacts for AA cells



**70990**

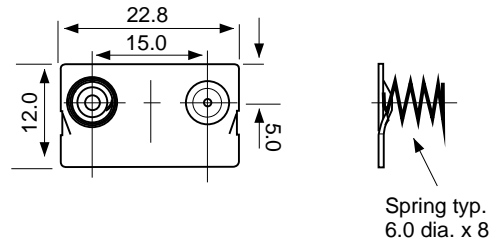

DOUBLE PLATE  
SPRING & DIMPLE

**70989**

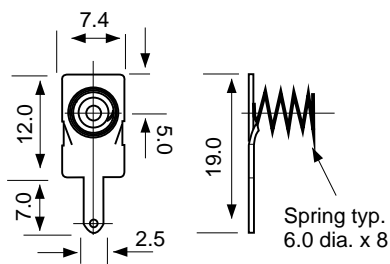

**70988**

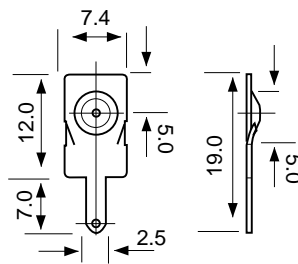

SINGLE PLATE SPRING  
WITH SOLDER TAG  
SINGLE PLATE DIMPLE  
WITH SOLDER TAG

**71212**

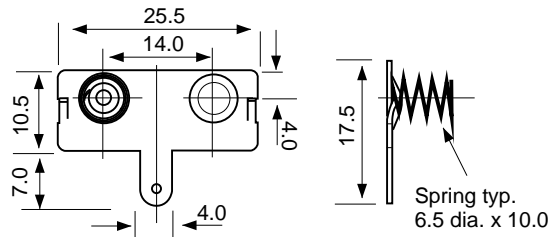

DOUBLE PLATE  
SPRING & DIMPLE  
WITH SOLDER TAG

**71211**

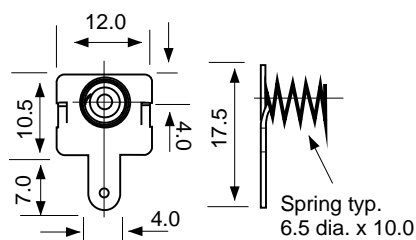

**71210**

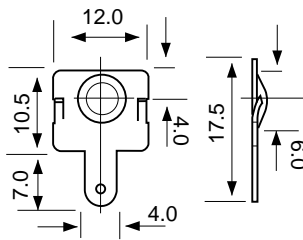

SINGLE PLATE SPRING  
WITH SOLDER TAG  
SINGLE PLATE DIMPLE  
WITH SOLDER TAG

**71137**

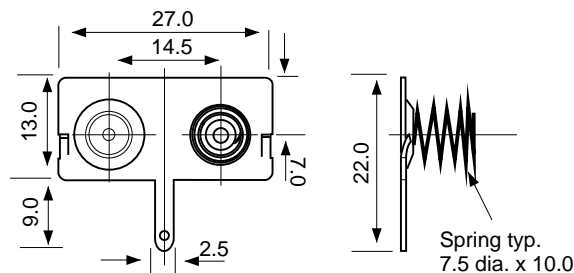

DOUBLE PLATE  
DIMPLE & SPRING  
WITH SOLDER TAG

for all your battery contact requirements.



# Contacts for AA cells

SINGLE PLATE SPRING WITH SOLDER TAG  
SINGLE PLATE DIMPLE WITH SOLDER TAG

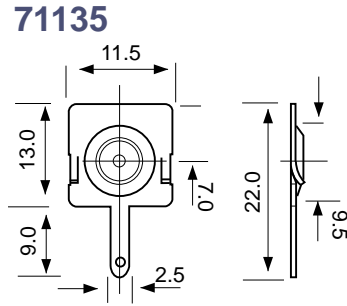
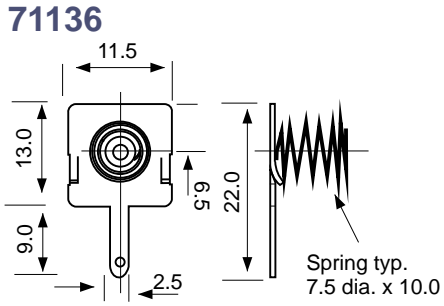

SINGLE PLATE SPRING  
SINGLE PLATE DIMPLE

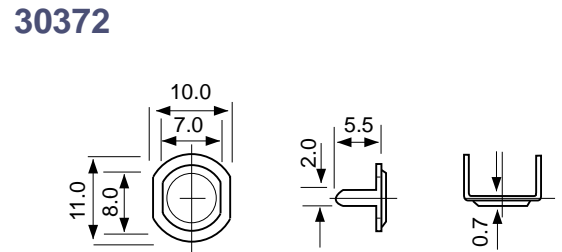
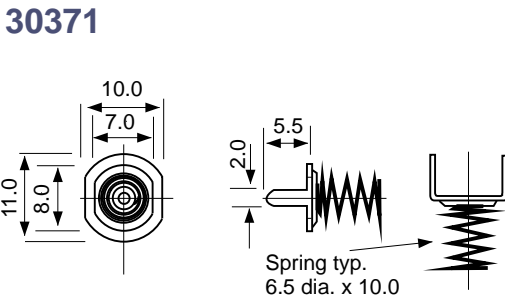

DOUBLE PLATE DIMPLE & SPRING

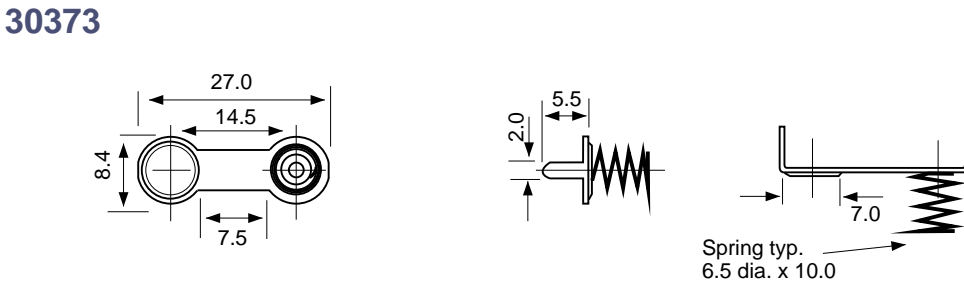

DOUBLE PLATE SPRING & DIMPLE

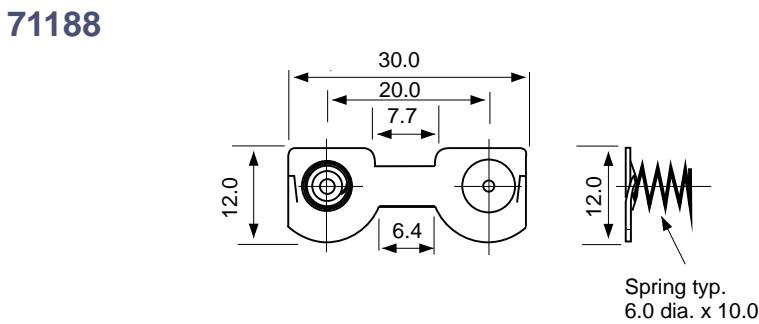

SINGLE PLATE SPRING WITH SOLDER TAG  
SINGLE PLATE DIMPLE WITH SOLDER TAG

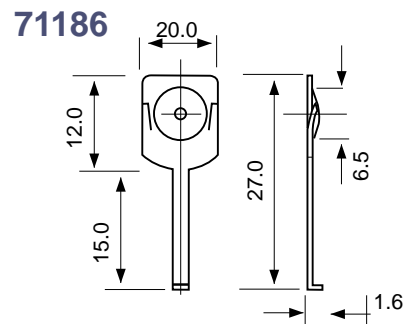
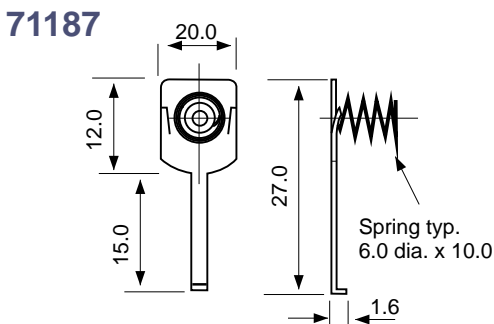



# Contacts for AA cells



**70970**

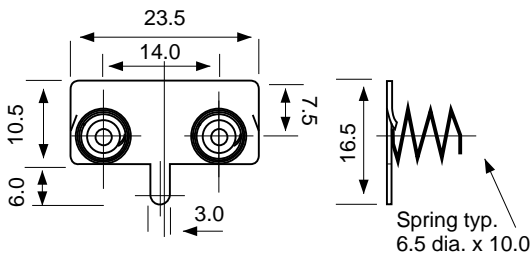

**70971**

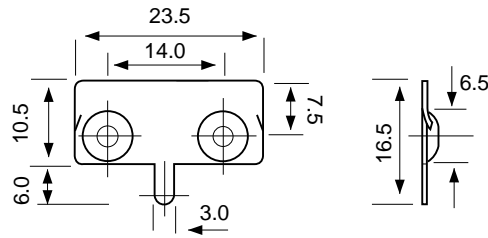

DOUBLE PLATE SPRING  
WITH SOLDER TAG

DOUBLE PLATE DIMPLE  
WITH SOLDER TAG

**30342**

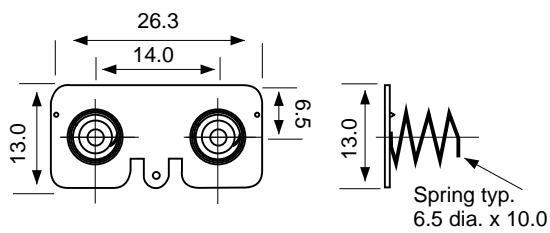

**30341**

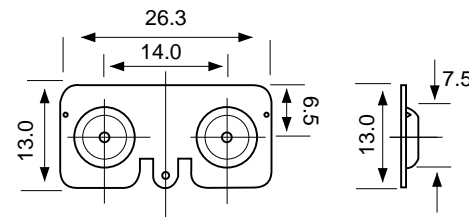

DOUBLE PLATE SPRING  
WITH SOLDER TAG

DOUBLE PLATE DIMPLE  
WITH SOLDER TAG

**71025**

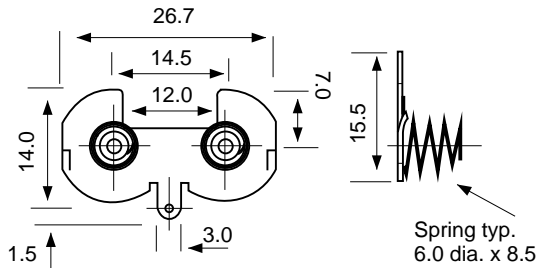

**71023**

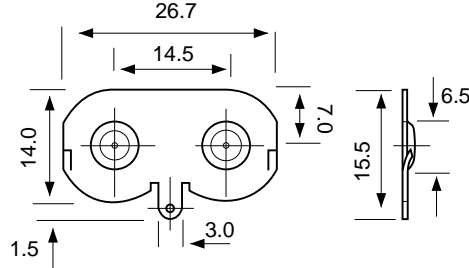

DOUBLE PLATE SPRING  
WITH SOLDER TAG

DOUBLE PLATE DIMPLE  
WITH SOLDER TAG

**70953**

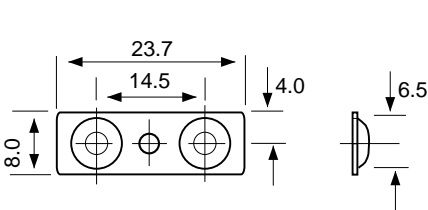

**70908**

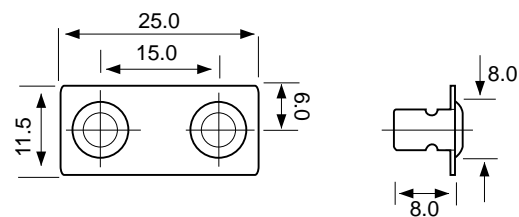

DOUBLE PLATE DIMPLE

DOUBLE PLATE DIMPLE

**70910**

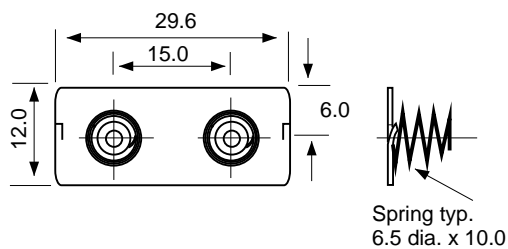

**71245**

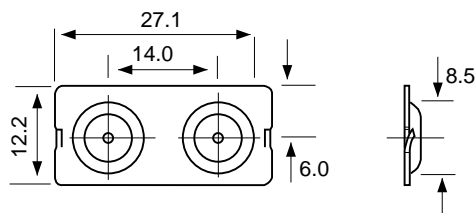

DOUBLE PLATE SPRING

DOUBLE PLATE DIMPLE

for all your battery contact requirements.



# Contacts for AA cells

DOUBLE PLATE  
SPRING & DIMPLE  
WITH SOLDER TAG

**30330**

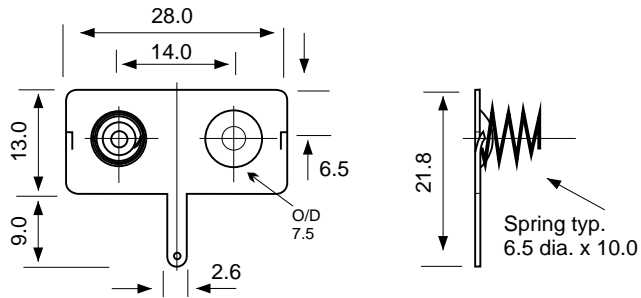

DOUBLE PLATE  
SPRING & DIMPLE  
WITH SOLDER TAG

**71048**

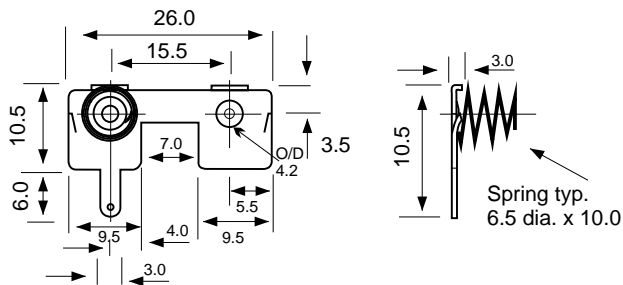

DOUBLE PLATE  
SPRING & DIMPLE  
WITH SOLDER TAG

**71146**

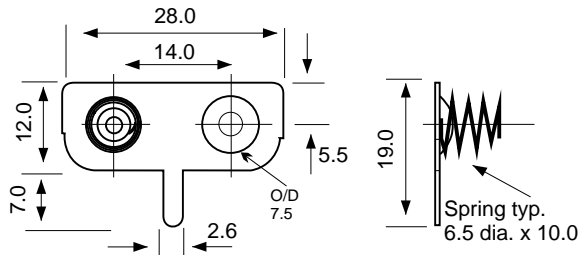

SINGLE PLATE SPRING  
WITH SOLDER TAG  
SINGLE PLATE DIMPLE  
WITH SOLDER TAG

**30336**

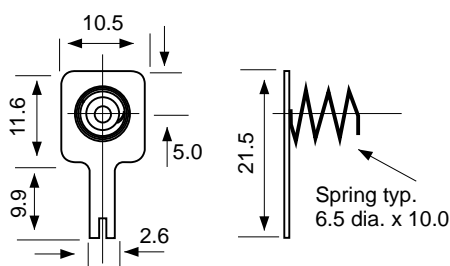

**30335**

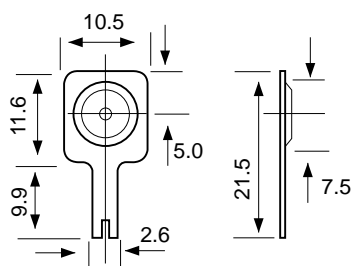

DOUBLE PLATE  
DIMPLE & SPRING

**30382**

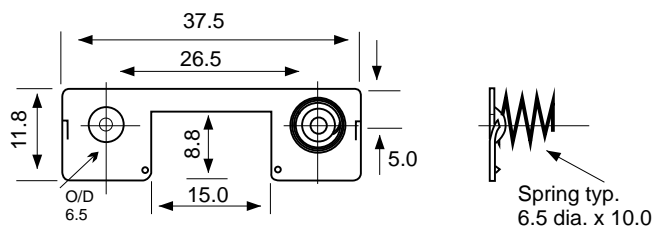

# Contacts for AA cells



**30334**

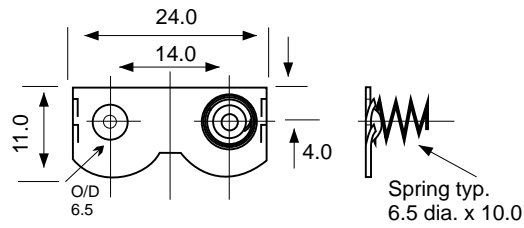

DOUBLE PLATE  
DIMPLE & SPRING

**71195**

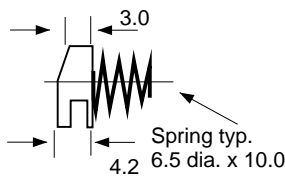
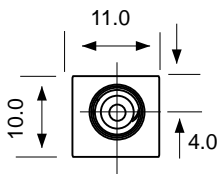

**71193**

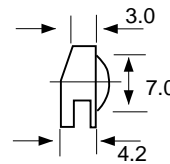
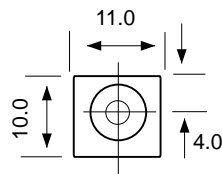

SINGLE PLATE SPRING  
SINGLE PLATE DIMPLE

**71050**

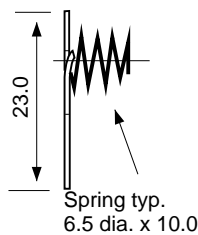
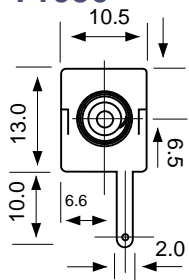

**71049**

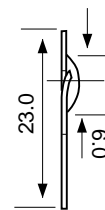
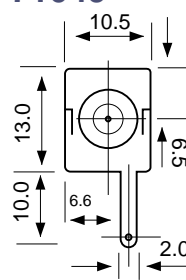

SINGLE PLATE SPRING  
WITH SOLDER TAG  
SINGLE PLATE DIMPLE  
WITH SOLDER TAG

**30349**

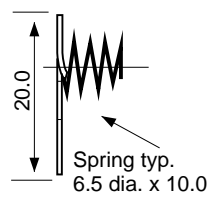
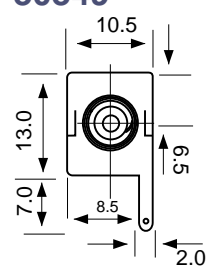

**30348**

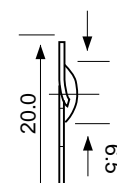
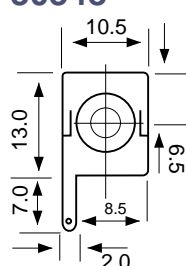

SINGLE PLATE SPRING  
WITH SOLDER TAG  
SINGLE PLATE DIMPLE  
WITH SOLDER TAG

**71096**

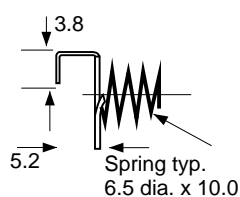
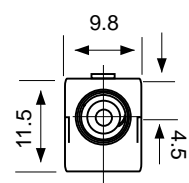

**71095**

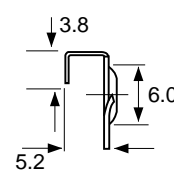
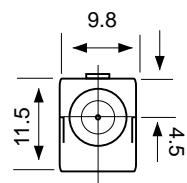

SINGLE PLATE SPRING  
SINGLE PLATE DIMPLE

for all your battery contact requirements.



# Contacts for AA cells

SINGLE PLATE SPRING  
WITH SOLDER TAG  
SINGLE PLATE DIMPLE  
WITH SOLDER TAG

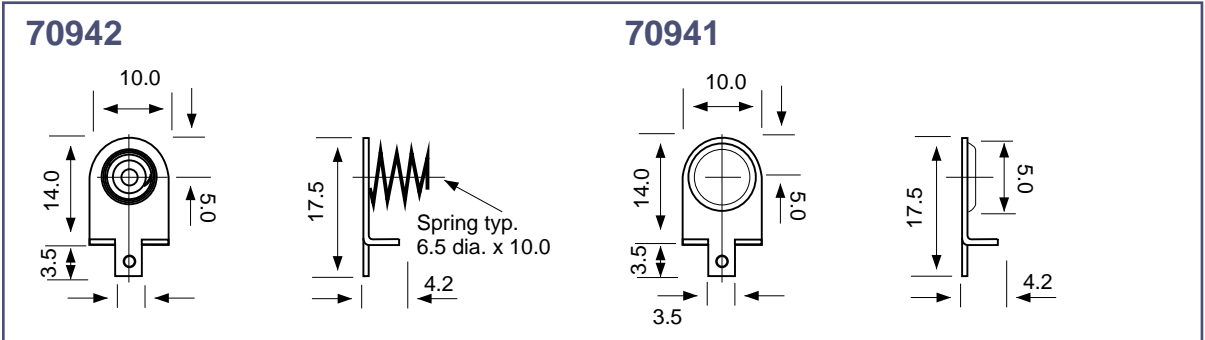

SINGLE PLATE SPRING  
SINGLE PLATE DIMPLE

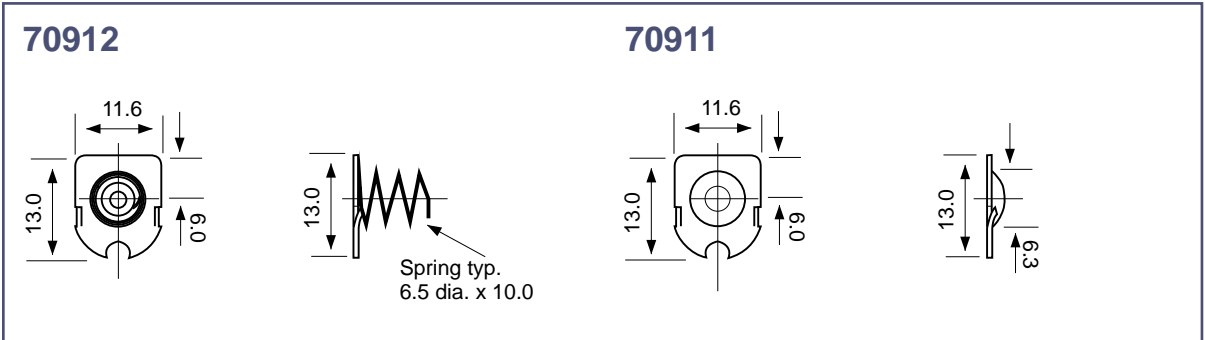

SINGLE PLATE SPRING  
SINGLE PLATE DIMPLE

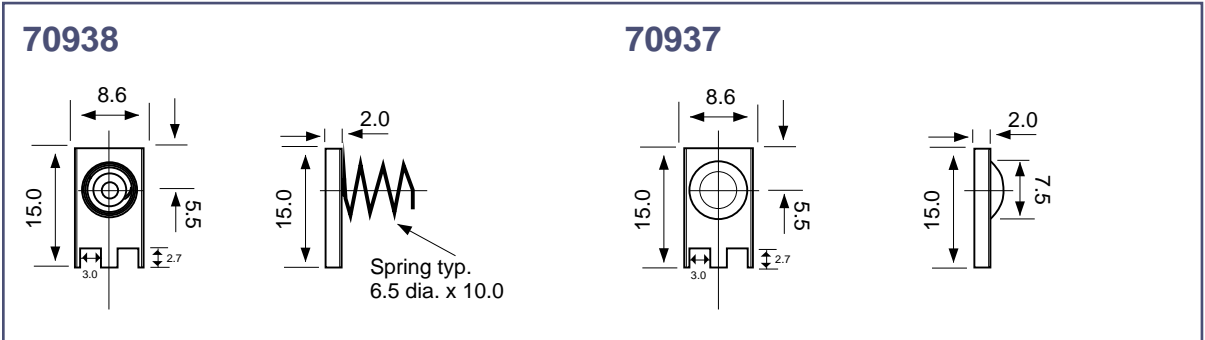

SINGLE PLATE SPRING  
WITH SOLDER TAG  
SINGLE PLATE DIMPLE  
WITH SOLDER TAG

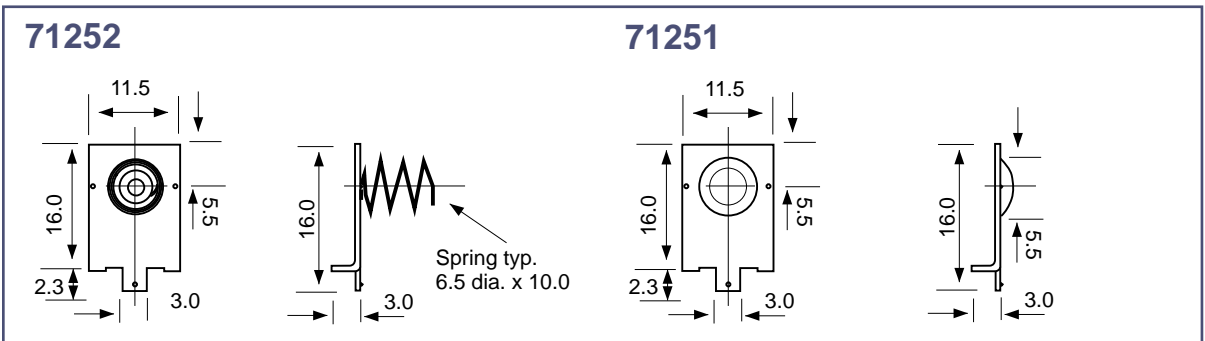

SINGLE PLATE SPRING  
SINGLE PLATE DIMPLE

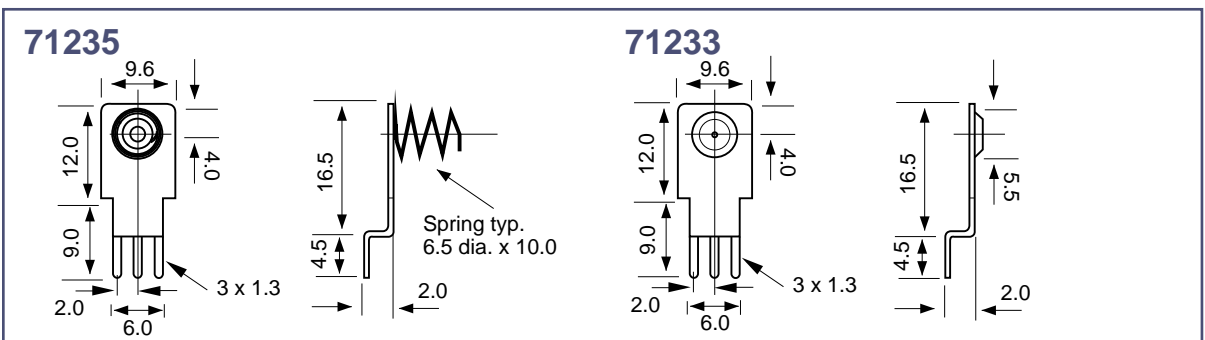

# Contacts for AA cells



**70922**

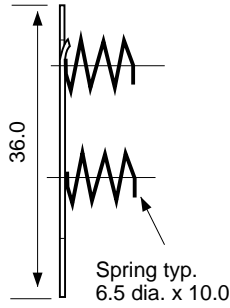
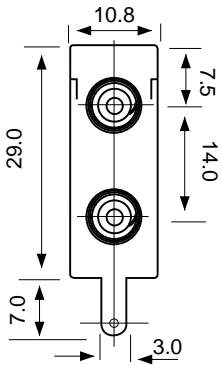

**70921**

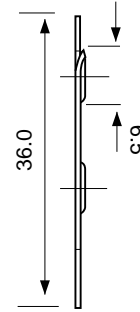
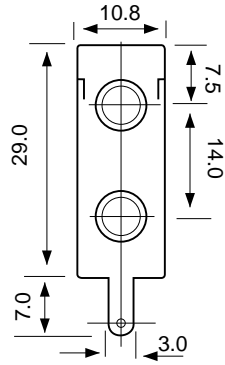

DOUBLE PLATE SPRINGS  
WITH SOLDER TAG

DOUBLE PLATE DIMPLES  
WITH SOLDER TAG

**71130**

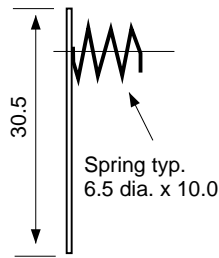
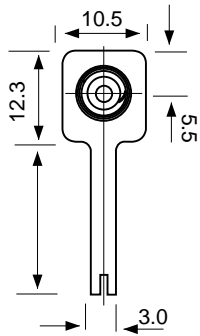

**71129**

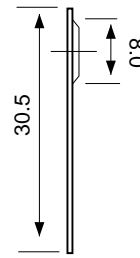
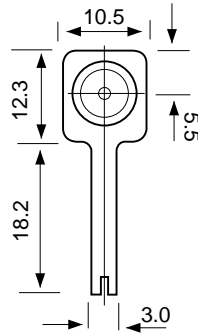

SINGLE PLATE SPRING  
WITH SOLDER TAG

SINGLE PLATE DIMPLE  
WITH SOLDER TAG

**71077**

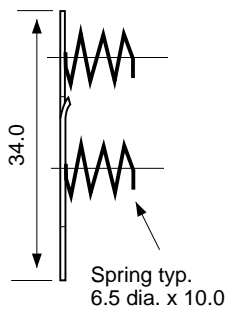
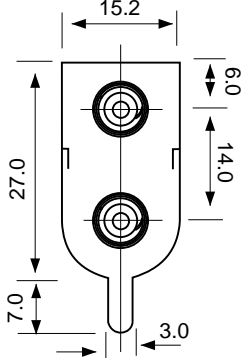

**70952**

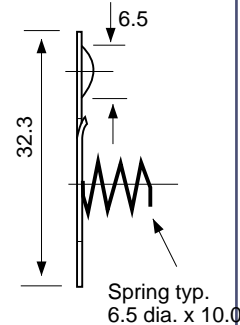
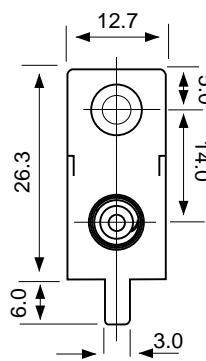

DOUBLE PLATE SPRINGS  
WITH SOLDER TAG

DOUBLE PLATE  
SPRING & DIMPLE  
WITH SOLDER TAG

**71178**

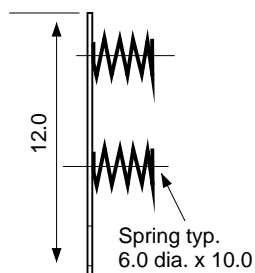
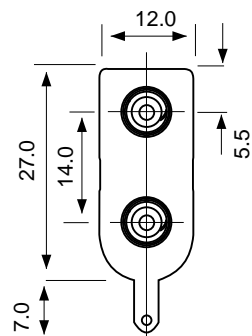

**71177**

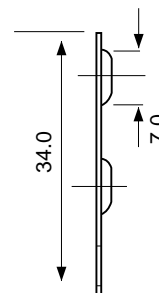
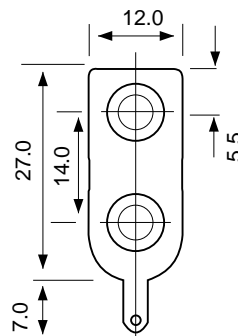

DOUBLE PLATE SPRINGS  
WITH SOLDER TAG

DOUBLE PLATE DIMPLES  
WITH SOLDER TAG

for all your battery contact requirements.



# Contacts for C cells

SINGLE PLATE SPRING WITH SOLDER TAG  
SINGLE PLATE DIMPLE WITH SOLDER TAG

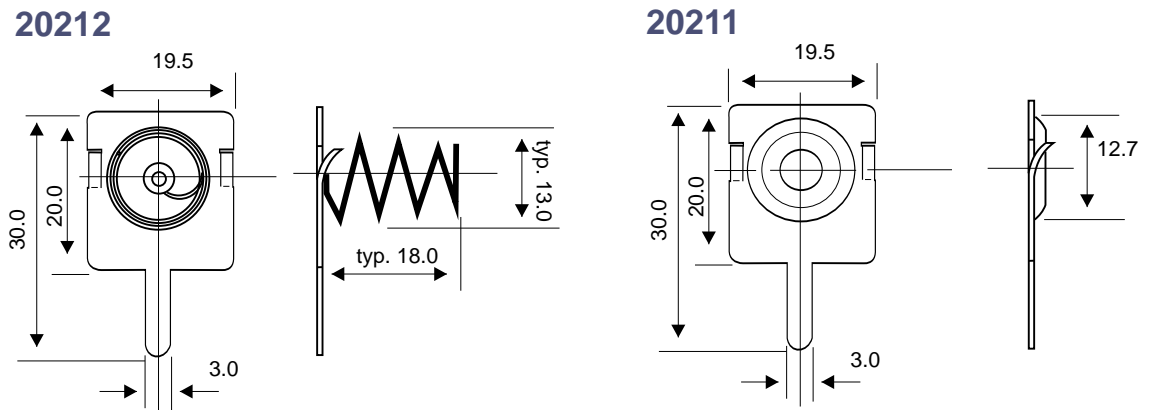

DOUBLE PLATE SPRING & DIMPLE WITH SOLDER TAGS

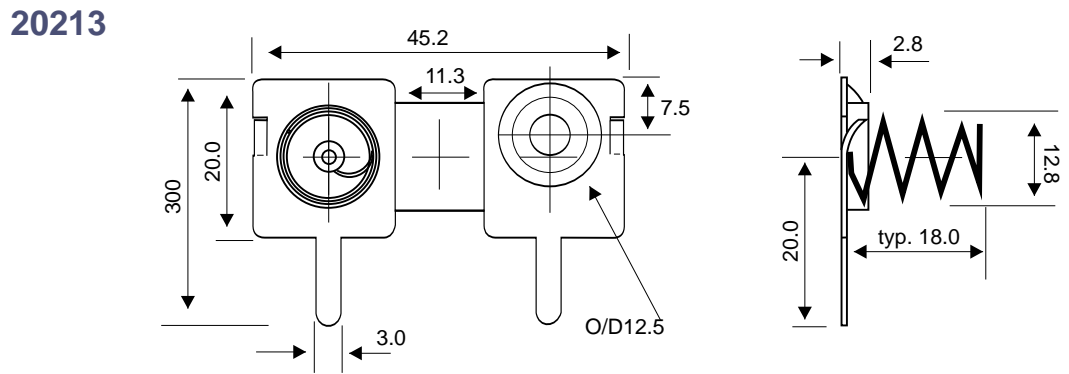

SINGLE PLATE SPRING WITH SOLDER TAG  
SINGLE PLATE DIMPLE WITH SOLDER TAG

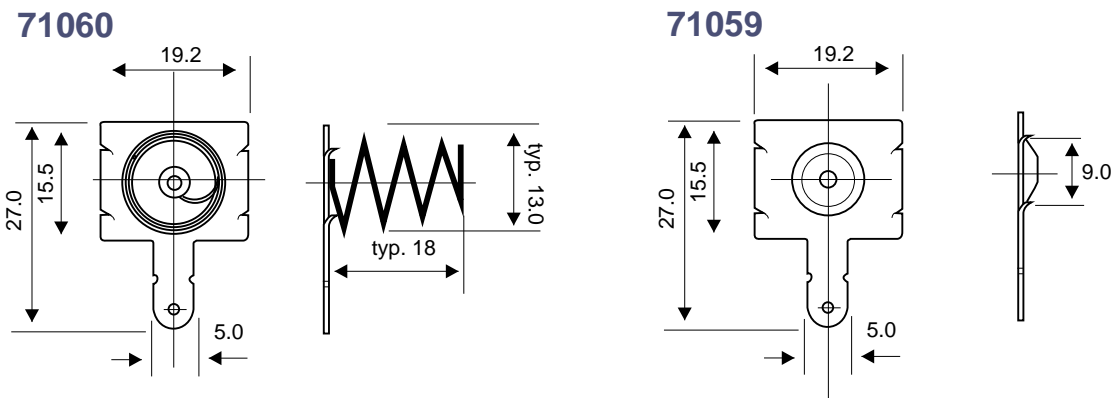

DOUBLE PLATE DIMPLE & SPRING WITH SOLDER TAGS

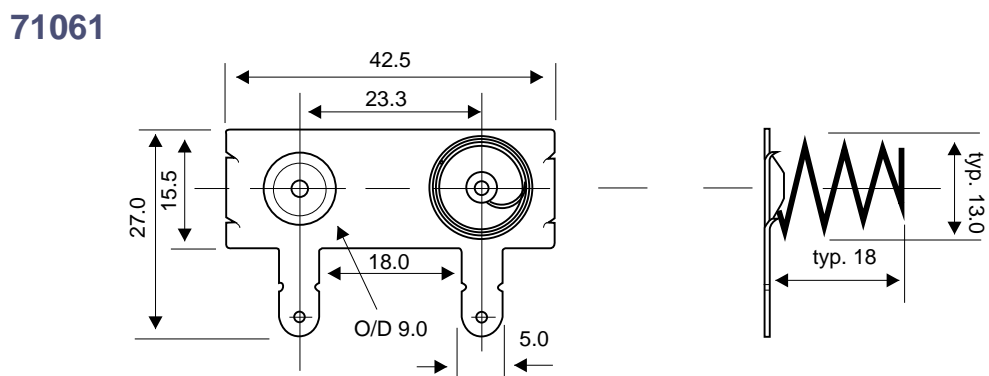

# Contacts for C cells



**20232**

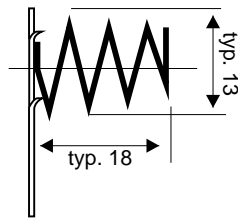
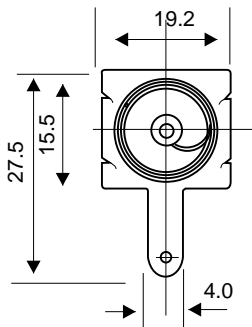

**20231**

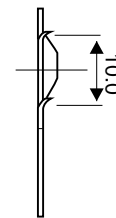
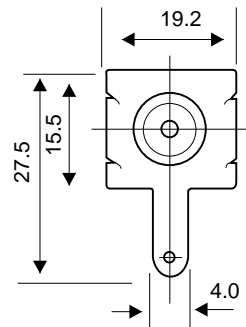

SINGLE PLATE SPRING  
WITH SOLDER TAG  
SINGLE PLATE DIMPLE  
WITH SOLDER TAG

**20233**

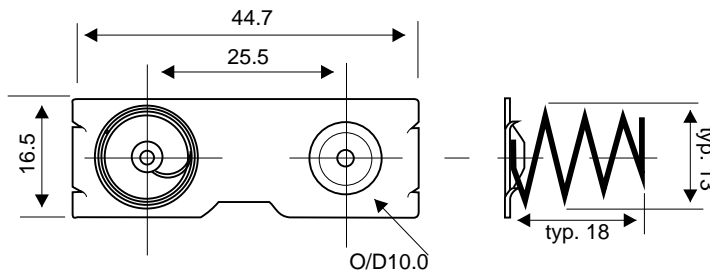

DOUBLE PLATE  
SPRING & DIMPLE

**20221**

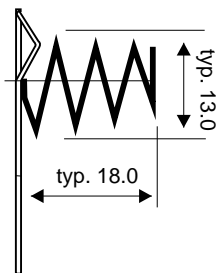
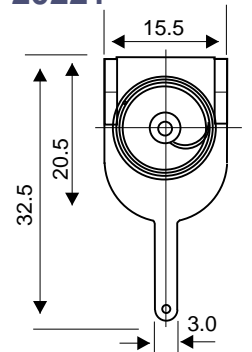

**20222**

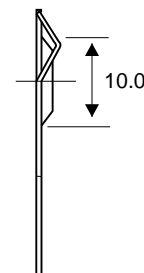
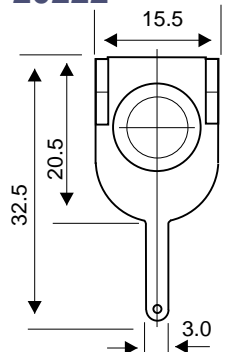

SINGLE PLATE SPRING  
WITH SOLDER TAG  
SINGLE PLATE DIMPLE  
WITH SOLDER TAG

**10106**

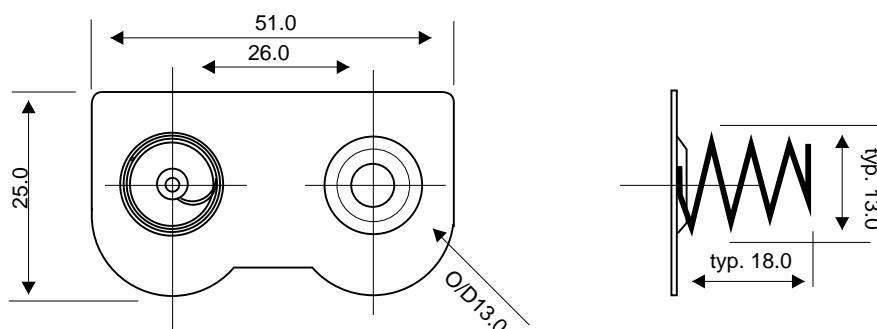

DOUBLE PLATE  
SPRING & DIMPLE

for all your battery contact requirements.



# Contacts for C cells

SINGLE PLATE SPRING WITH SOLDER TAG  
SINGLE PLATE DIMPLE WITH SOLDER TAG

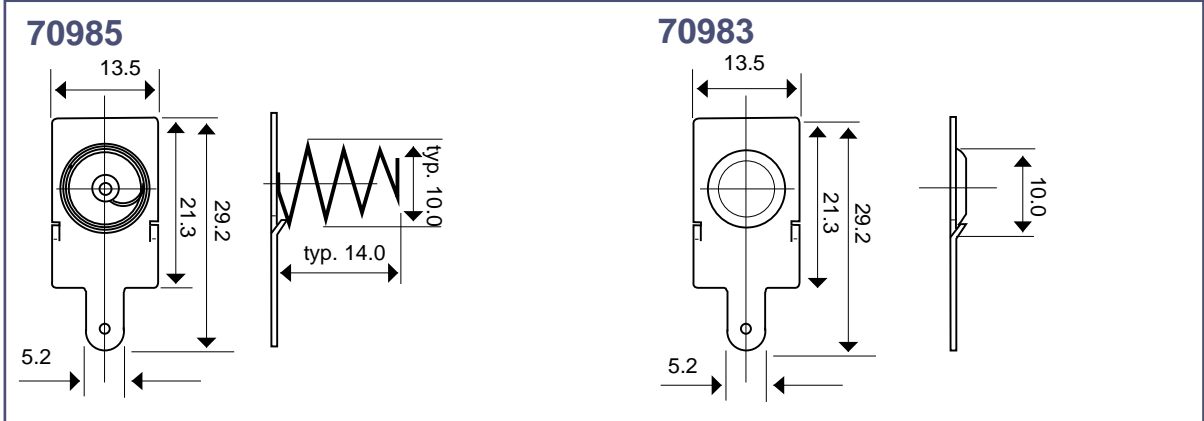

DOUBLE PLATE SPRING & DIMPLE WITH SOLDER TAGS

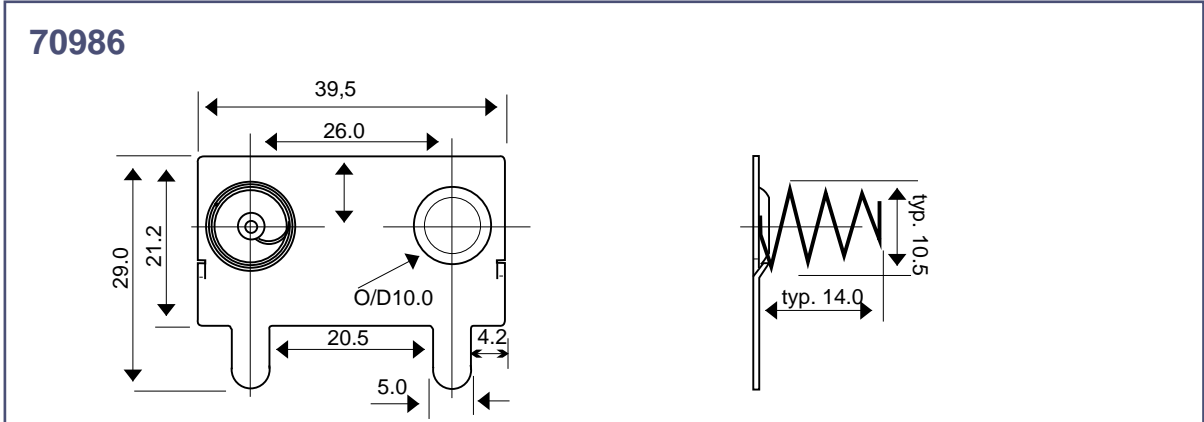

SINGLE PLATE SPRING  
SINGLE PLATE DIMPLE

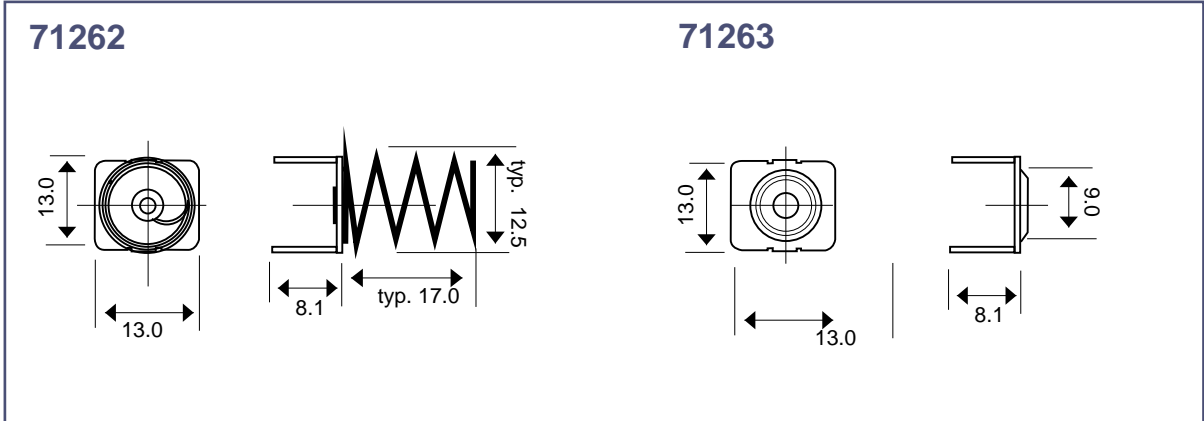

DOUBLE PLATE SPRING & DIMPLE

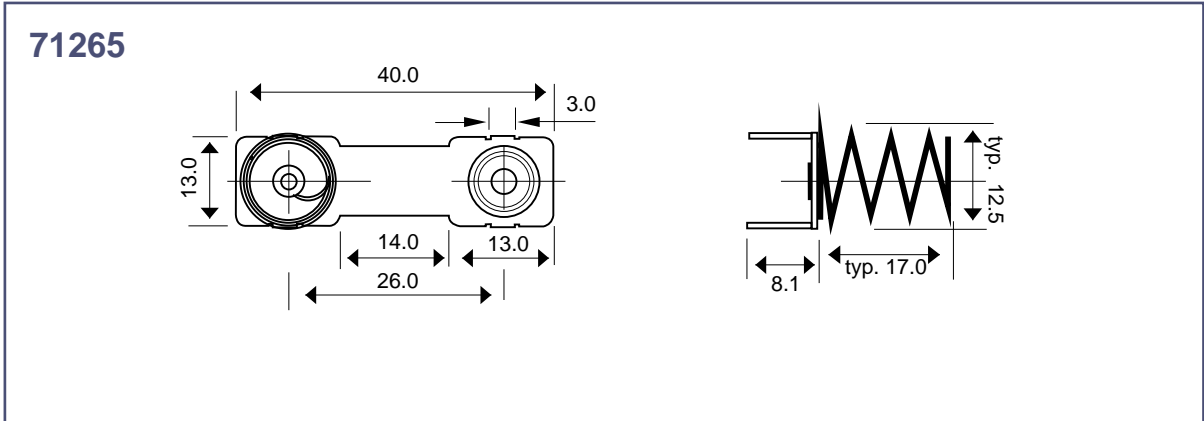



# Contacts for D cells



71056

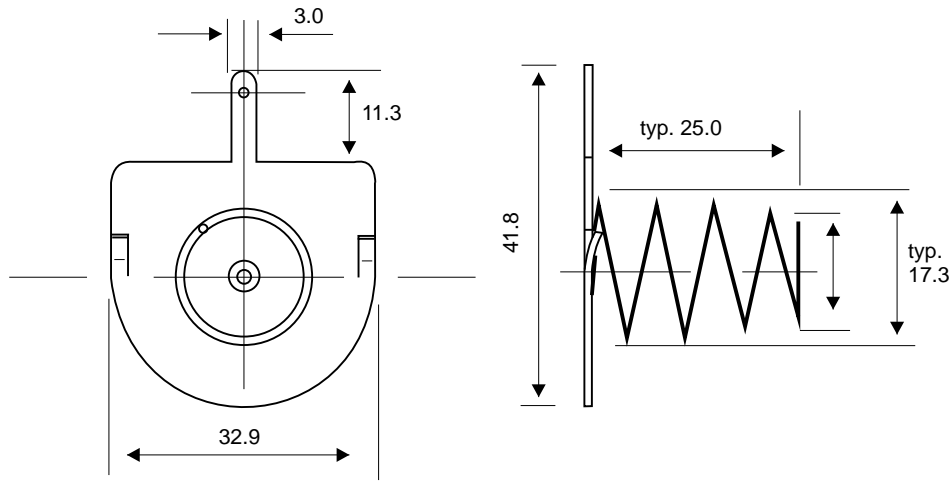

SINGLE PLATE SPRING  
WITH SOLDER TAG

71055

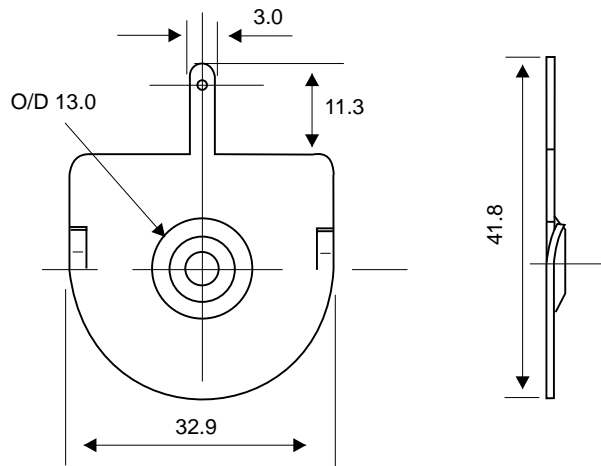

SINGLE PLATE DIMPLE  
WITH SOLDER TAG

71058

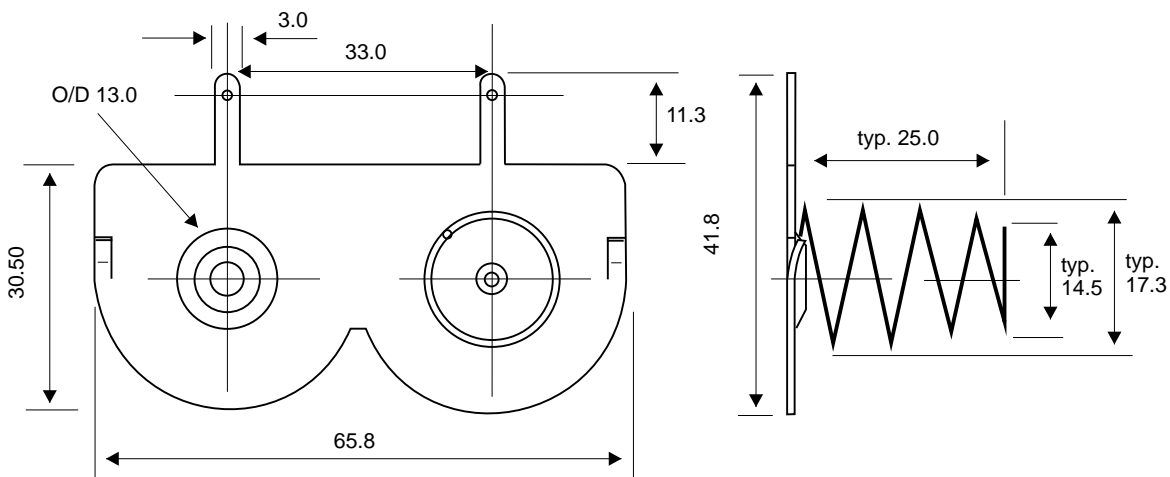

DOUBLE PLATE  
SPRING & DIMPLE  
WITH SOLDER TAGS

for all your battery contact requirements.



# Contacts for D cells

SINGLE PLATE SPRING WITH SOLDER TAG

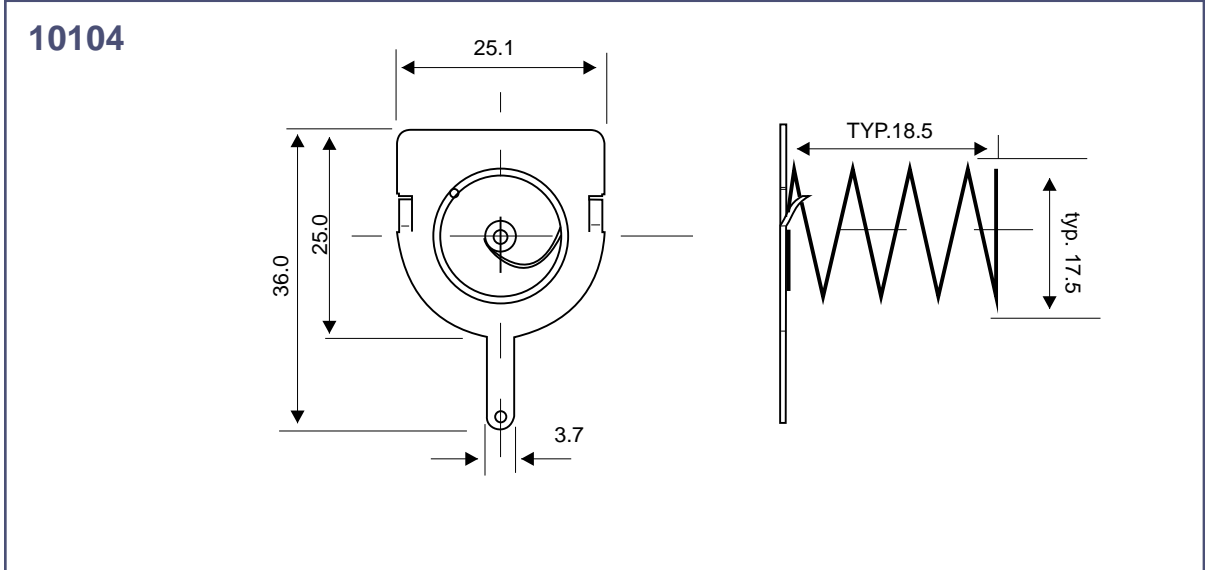

SINGLE PLATE DIMPLE WITH SOLDER TAG

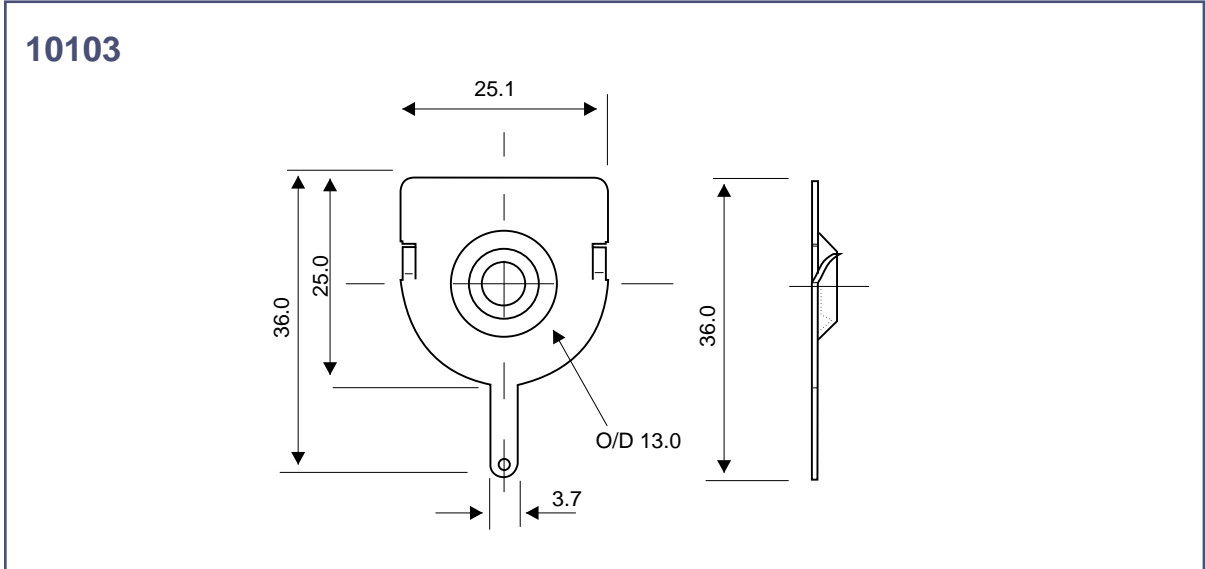

DOUBLE PLATE SPRING & DIMPLE

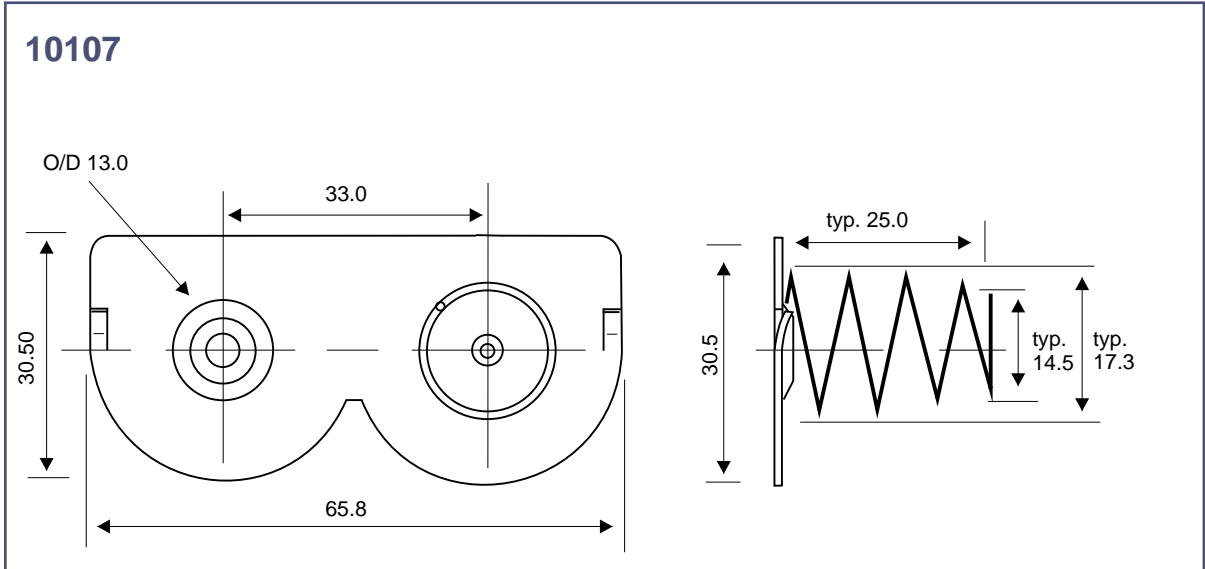

# Contacts for D cells



71001

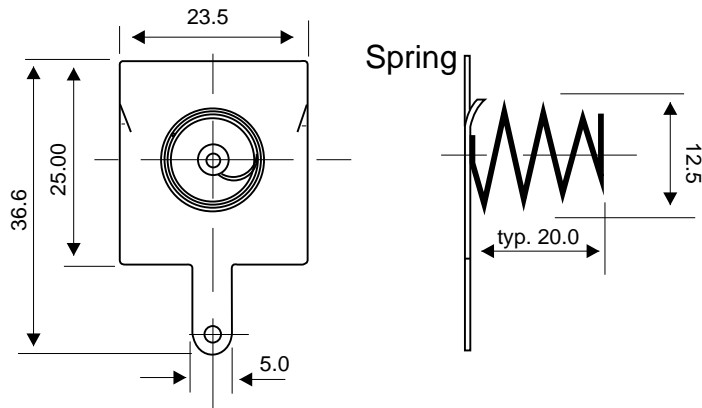

SINGLE PLATE SPRING  
WITH SOLDER TAG

71000

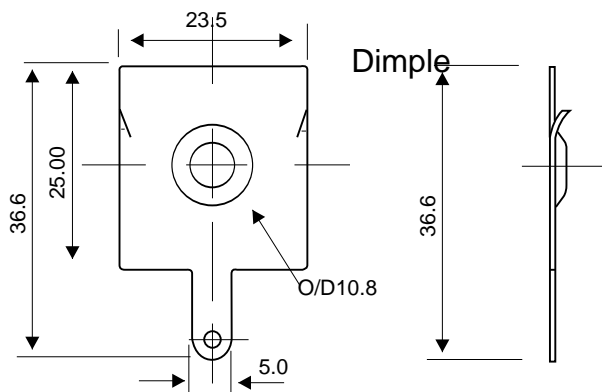

SINGLE PLATE DIMPLE  
WITH SOLDER TAG

71055

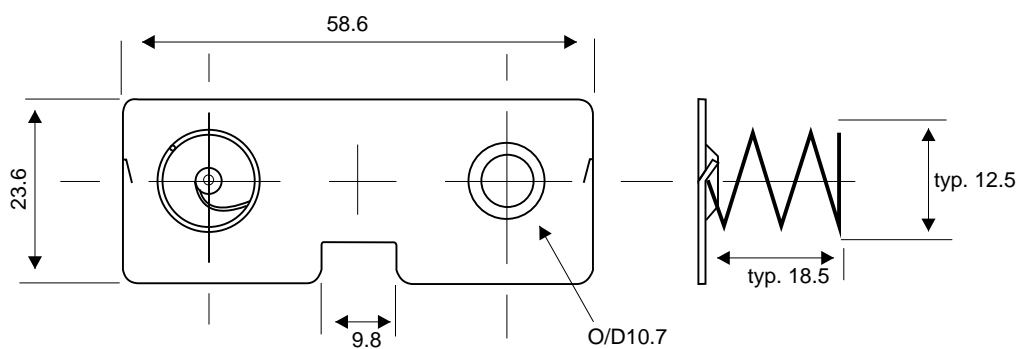

DOUBLE PLATE  
SPRING & DIMPLE

for all your battery contact requirements.



# Contacts for D cells

SINGLE PLATE SPRING  
WITH SOLDER TAG

70957

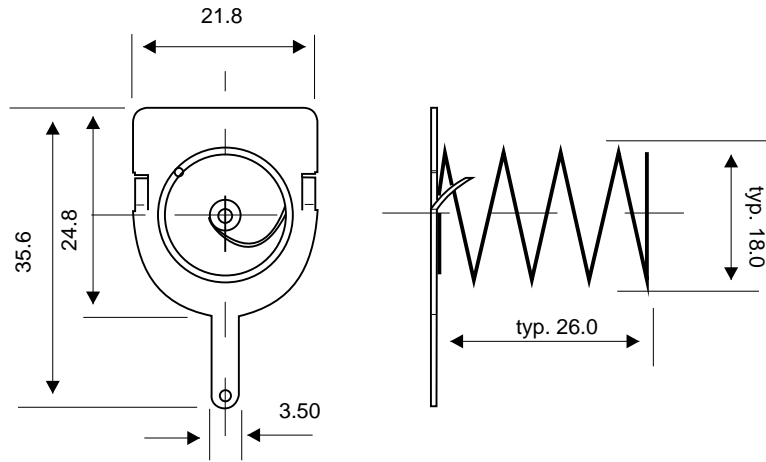

SINGLE PLATE DIMPLE  
WITH SOLDER TAG

70967

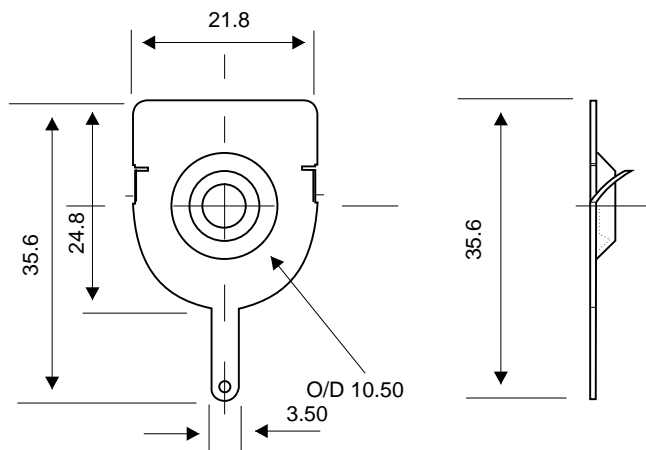

DOUBLE PLATE  
SPRING & DIMPLE

71002

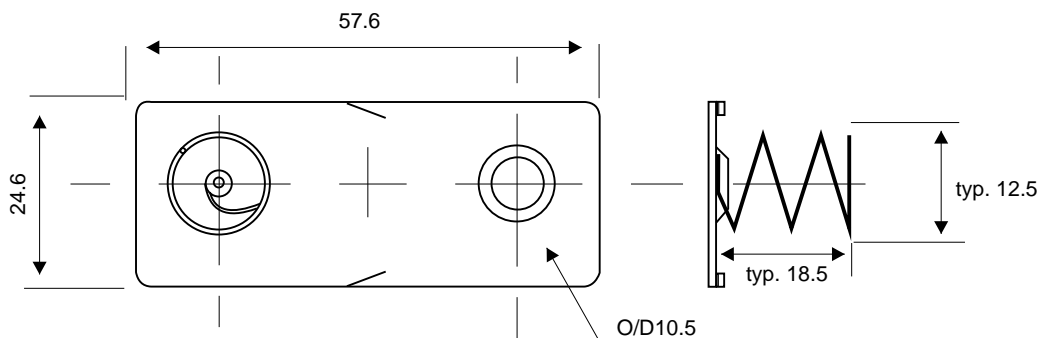

# Contacts for D cells



71237

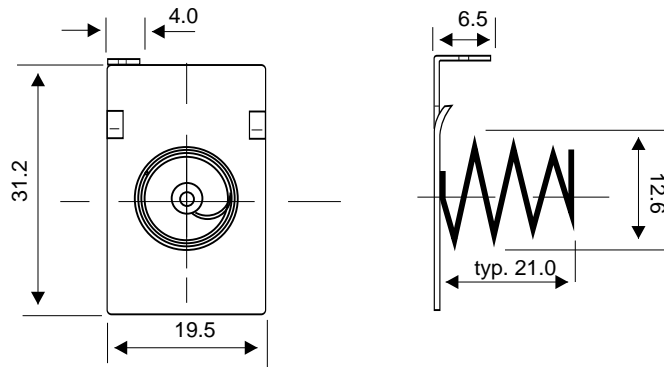

SINGLE PLATE SPRING

71236

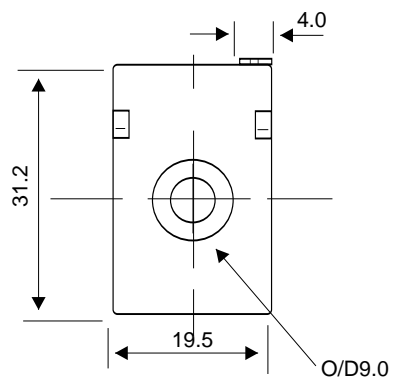

SINGLE PLATE DIMPLE

71238

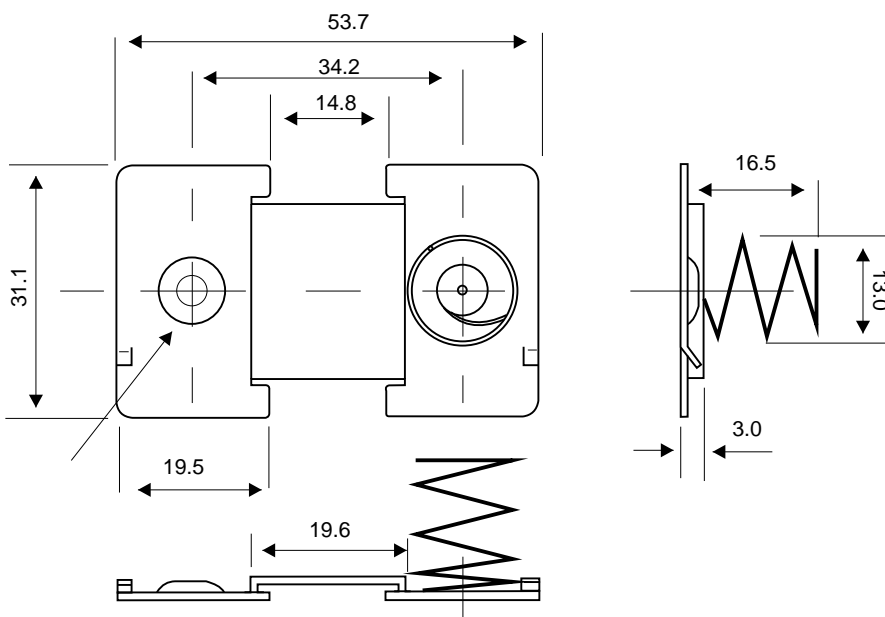

DOUBLE PLATE  
SPRING & DIMPLE

for all your battery contact requirements.



# Holders for AAA & N cells

FOR 1 x AAA CELL  
 FOR 2 x AAA CELLS  
 FOR 2 x AAA CELLS



FOR 2 x AAA CELLS  
 FOR 2 x AAA CELLS  
 FOR 3 x AAA CELLS



FOR 4 x AAA CELLS



FOR 6 x AAA CELLS  
 FOR 8 x AAA CELLS  
 FOR 1 x N CELL



# Holders for N & AA cells



**BH521**

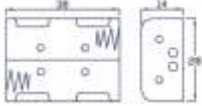

**BH522**

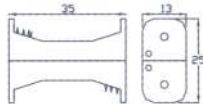

**BH543**

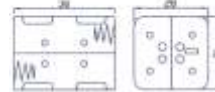

FOR 2 x N CELLS  
FOR 2 x N CELLS  
FOR 4 x N CELLS

**BH311**

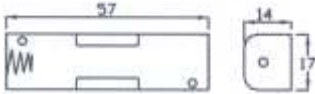

**BH311-3A**

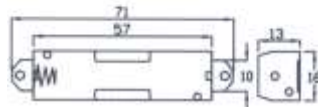

**BH321**

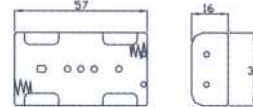

FOR 1 x AA CELL  
FOR 1 x AA CELL  
FOR 2 x AA CELLS

**BH321-4A**

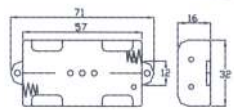

**BH322**

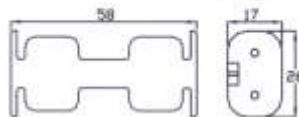

**BH325**

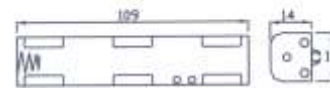

FOR 2 x AA CELLS  
FOR 2 x AA CELLS  
FOR 3 x AA CELLS

**BH331**

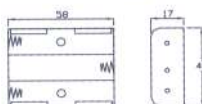

**BH332**



**BH333**

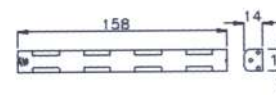

FOR 3 x AA CELLS  
FOR 3 x AA CELLS  
FOR 4 x AA CELLS

for all your battery holder requirements.



# Holders for AA cells

FOR 4 x AA CELLS



FOR 4 x AA CELLS  
 FOR 5 x AA CELLS  
 FOR 6 x AA CELLS



FOR 6 x AA CELLS



FOR 8 x AA CELLS





# Holders for AA, 1/2AA & PP3 cells



**BH521**



**BH522**



**BH1/2AA-2A**



FOR 10 x AA CELLS  
FOR 10 x AA CELLS  
FOR 1 x 1/2AA CELL

**BH1/2AA-3A**

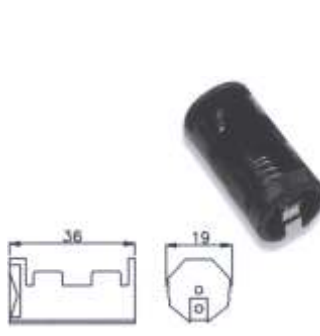

**BH9VA**



**BH9V-1A**



FOR 1 x 1/2AA CELL  
FOR 1 x PP3 CELL  
FOR 1 x PP3 CELL

**BH9V-2**

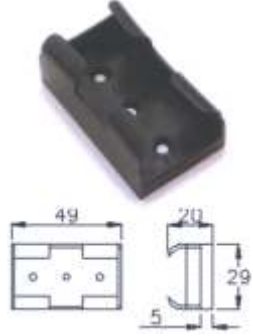

**BH322**



**BH325**



FOR 1 x PP3 CELL

**BH331**

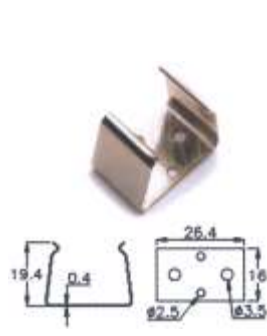

**BH332**



**BH333**



FOR 1 x PP3 CELL

for all your battery holder requirements.



# Holders for C cells

FOR 1 x C CELL  
 FOR 2 x C CELLS  
 FOR 3 x C CELLS



FOR 3 x C CELLS  
 FOR 4 x C CELLS  
 FOR 4 x C CELLS



FOR 4 x C CELLS  
 FOR 4 x C CELLS  
 FOR 6 x C CELLS



FOR 8 x C CELLS



# Holders for D cells



**BH111**

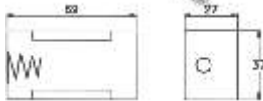

**BH121**

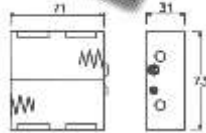

**BH125**



FOR 1 x D CELL  
FOR 2 x D CELLS  
FOR 2 x D CELLS

**BH131**

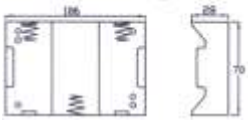

**BH141**

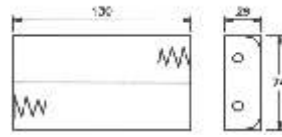

**BH142**

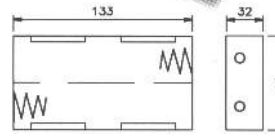

FOR 3 x D CELLS  
FOR 4 x D CELLS  
FOR 4 x D CELLS

**BH143**

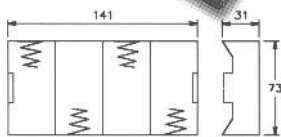
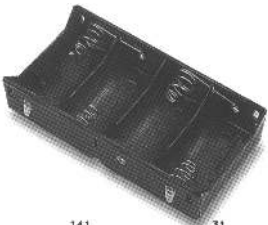

**BH144**

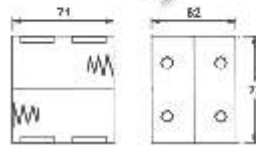

**BH161**

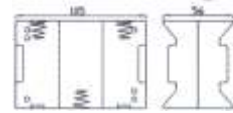

FOR 4 x D CELLS  
FOR 4 x D CELLS  
FOR 6 x D CELLS

**BH162**



**BH181**

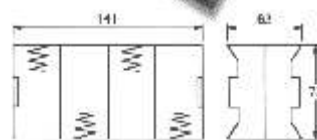

FOR 6 x D CELLS  
FOR 8 x D CELLS

for all your battery holder requirements.



# Contacts for Coin cells & Snaps

FOR Cr2032  
COIN CELL

**BC-2001**



**BC-2002**



SOLDERED SNAPS

**BS-1**



**BS-E**



**BS-T**



**BS-P**



CRIMPED SNAPS  
WITH PVC COVER

**BS-IC**



**BS-EC**



**BS-TC**



**BS-PC**



CRIMPED SNAPS  
WITH ABS COVER

**BS-IR**



**BS-ER**



**BS-TR**



CRIMPED SNAPS  
WITH SAFETY COVER

**SBS-IR-1**



**BS-ER-1**



# Holders for Coin cells



**CH23-1220**



**CH23-1225**



**CH25-2032**



FOR CR1220 COIN CELL  
FOR CR1225 COIN CELL  
FOR CR2032 COIN CELL

**CH26-2032**



**CH28-2032**

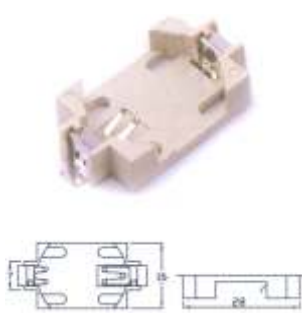

**CH74-2032**

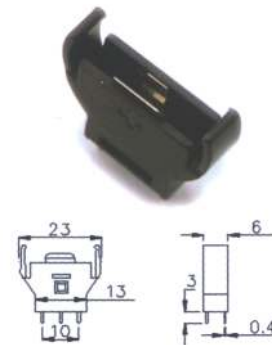

FOR CR2032 COIN CELL

**CH005-2032**



**CH224-2032**



**CH7410-2032**



FOR CR2032 COIN CELL

**CH7410-2032**



**CH25-2325**



**CH002-2425**



FOR CR2032 COIN CELL  
FOR CR2325 COIN CELL  
FOR CR2425 COIN CELL

for all your battery holder requirements.



# Crocodile Clips

SMALL CROCODILE CLIPS

A-100	A-100C

MEDIUM CROCODILE CLIPS

A-200	A-200C

LARGE CROCODILE CLIPS

A-800	A-800C

# Custom Products



Westside Supplies Limited specialise in the custom design of all battery contacts and other items within the battery range.

Whether it be the 6xAA quick release battery clip used by the military to the 6xAA battery holder with header connector and charging socket (left), you can be assured of our knowledge and expertise in getting your new project off the ground.

Our design team can develop new parts quickly and efficiently, and we consider our customers to be partners in any such venture. Custom parts can often be developed in modest quantities, and we offer support whilst volumes ramp up over a period of time.



Our battery contacts can be supplied with a variety of finishes whether you require standard nickel plating or a gold plated finish.

for all your custom battery requirements.

**The WSL extensive product range includes:**

- Audio Connectors & Terminations
- Battery Connectors & Holders
- BNC Connectors
- DC Power Jacks
- DIN Connectors
- Equipment Feet
- Mains Cables & Connectors
- RF Connectors
- Screw Terminals
- Switches & Potentiometers
- Telephone & Communication Jacks
- Terminal Blocks
- Transistor Holders & Bushings
- Custom moulded leads & rewireable plugs/sockets (including BNC, D, DC & audio jacks, din, mini-din & phono types)

**We are also able to offer a custom design & specific sourcing service for all your connector requirements.**



**WESTSIDE  
SUPPLIES  
LIMITED**

**'WESTSIDE'  
SHRIPNEY ROAD  
BOGNOR REGIS  
WEST SUSSEX  
UNITED KINGDOM  
Po22 9NX**

**TEL: +44 (0) 1243 860626**

**FAX: +44 (0) 1243 866626**

**EMAIL: [sales@westside-supplies.co.uk](mailto:sales@westside-supplies.co.uk)**

**WEB: [www.westside-supplies.co.uk](http://www.westside-supplies.co.uk)**