

88 SERIES, HIGH PRESSURE SCREW-ON COUPLING (CARBON STEEL) BALL VALVE

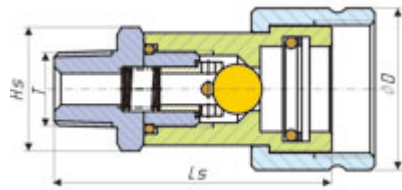

Art. No.	DN	Size	Ls	ØD	Hs	T
HFSFC8814	5.0	04SF	60.5	30	S22	1/4" NPTF
HFSFC8838	6.0	06SF	71.5	36	S24	3/8" NPTF

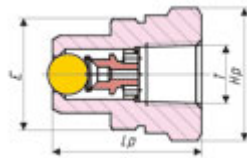

Art. No.	DN	Size	Lp	E	Hp	T
HFSFP8814	5.0	04PF	39	1-18UNS	S19	1/4" NPTF
HFSFP8838	6.0	06PF	40	1-3/16-16UN	S32	3/8" NPTF



ISO	Art. No.(Plug)	Art. No.(Cap)	Material
6.3	PVF	PVM	Steel

APPLICATIONS:

This Series couplings with their threaded union locking system and precision ball-type check valves, are designed for extreme high pressure applications such as found on portable hydraulic rams.



PERFORMANCE

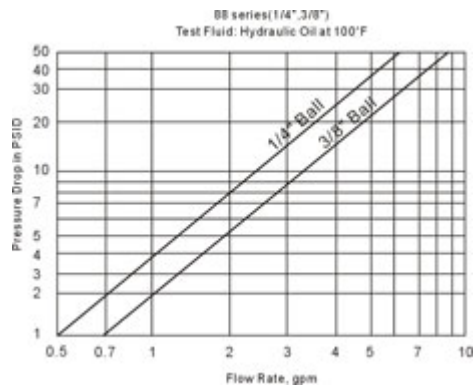

INTERCHANGE

HANSEN HP3 SERIES, PARKER 3000 SERIES,
FASTER PVVM SERIES, DNP PVS SERIES,
STUCCHI IVHP SERIES, SAFEWAY S30 SERIES



TEMPERATURE RANGE

-25°C+120°C/-13°F+250°F

With standard seals: Buna-N(Nitrile)

On request seals: Viton, Neoprene, EPDM or other seals.



MAX. WORKING PRESSURE: 10440PSI(720bar)



MATERIAL

MATERIAL

Coupler Body :STEEL, TRIVALENT PLATED

Valve :STEEL, BALL TYPE

Springs :C98

Locking O-Ring :C98

Balls :GCr15

Seals :Buna-N(Nitrile)

Back-Up Ring :PTFE

Surface treatment :Zinc plating and Cr 3+ Passivation



ACCESSORIES:

Dust caps and dust plugs



ATTENTION:

Only plug and socket with the same thread fit together.